



STATE OF NEW MEXICO  
ENERGY AND MINERALS DEPARTMENT  
OIL CONSERVATION DIVISION  
AZTEC DISTRICT OFFICE

1000 RIO BRAZOS ROAD  
AZTEC, NEW MEXICO 87410  
(505) 334-6178

OIL CONSERVATION DIVISION  
BOX 2088  
SANTA FE, NEW MEXICO 87501

DATE 7-3-85

RE: Proposed MC \_\_\_\_\_  
Proposed DHC \_\_\_\_\_  
Proposed NSL X \_\_\_\_\_  
Proposed SWD \_\_\_\_\_  
Proposed WFX \_\_\_\_\_  
Proposed PMX \_\_\_\_\_

Gentlemen:

I have examined the application dated 7-3-85  
for the Ameca G.C.U. #165E P-29-28N-12W  
Operator Lease and Well No. Unit, S-T-R

and my recommendations are as follows:

Approve  
\_\_\_\_\_  
\_\_\_\_\_  
\_\_\_\_\_  
\_\_\_\_\_

Yours truly,

E. G. Smith



STATE OF NEW MEXICO  
ENERGY AND MINERALS DEPARTMENT  
OIL CONSERVATION DIVISION  
AZTEC DISTRICT OFFICE

1000 RIO BRAZOS ROAD  
AZTEC, NEW MEXICO 87410  
(505) 334-6178

OIL CONSERVATION DIVISION  
BOX 2088  
SANTA FE, NEW MEXICO 87501

DATE 3-1-85

RE: Proposed MC \_\_\_\_\_  
Proposed DHC \_\_\_\_\_  
Proposed NSL X \_\_\_\_\_  
Proposed SWD \_\_\_\_\_  
Proposed WFX \_\_\_\_\_  
Proposed PMX \_\_\_\_\_

Gentlemen:

I have examined the application dated 2-14-85  
for the Amoco G.C.U. #165E P.29-28A-12W  
Operator Lease and Well No. Unit, S-T-R

and my recommendations are as follows:

Docket for hearing  
\_\_\_\_\_  
\_\_\_\_\_  
\_\_\_\_\_  
\_\_\_\_\_

Yours truly,

Tom Bussell

February 13, 1985

Mr. Gilbert Quintana  
New Mexico Oil Conservation Division  
P. O. Box 2088  
Santa Fe, NM 87501

File: DDL-190-400.1

Application for Unorthodox Location  
Gallegos Canyon Unit No. 165E  
Basin Dakota and Cha Cha Gallup Ext. Fields  
San Juan County, New Mexico

Amoco Production Company hereby requests approval of an unorthodox well location for the Gallegos Canyon Unit No. 165E. The proposed location is 820' FSL x 920' FEL of Section 29, T28N, R12W, San Juan County, New Mexico.

This well was staked in the unorthodox location indicated above in order to place the well in an orthodox window for the Basin Dakota Formation. After the application to drill was approved, it was decided to dual complete the well in the Cha Cha Gallup Extension Formation as well.

There are no offset lease holders of Cha Cha Gallup Extension wells as indicated on the attached nine - section plat

Sincerely,

Original Sign.  
W. J. Holcomb  
by DDL

KRI/ct

Attachments

✓cc: Mr. Ernie Bush  
New Mexico Oil Conservation Division  
1000 Rio Brazos Road  
Aztec, NM 87410

RECEIVED  
EEB 14 1985  
OIL CON. DIV.  
DIST. 3

AM18

RECEIVED  
FEB 1 1988  
U.S. DEPT. OF JUSTICE  
FBI  
WASHINGTON, D.C.

RECEIVED  
FEB 1 1988  
U.S. DEPT. OF JUSTICE  
FBI  
WASHINGTON, D.C.

All distances must be from the outer boundaries of the Section.

Operator <b>AMOCO PRODUCTION COMPANY</b>			Lease <b>GALLEGOS CANYON UNIT</b>		Well No. <b>165E</b>
Unit Letter <b>P</b>	Section <b>29</b>	Township <b>28N</b>	Range <b>12W</b>	County <b>San Juan</b>	
Actual Footage Location of Well: <b>820</b> feet from the <b>South</b> line and <b>920</b> feet from the <b>East</b> line					
Ground Level Elev: <b>5639</b>	Producing Formation <b>Dakota + Gallup</b>		Pool <b>Basin Dakota/Cha Cha Gallup Ext.</b>		Dedicated Acreage: <b>320/80</b> Acres

1. Outline the acreage dedicated to the subject well by colored pencil or hatchure marks on the plat below.
2. If more than one lease is dedicated to the well, outline each and identify the ownership thereof (both as to working interest and royalty).
3. If more than one lease of different ownership is dedicated to the well, have the interests of all owners been consolidated by communitization, unitization, force-pooling, etc?

☒ Yes ☐ No If answer is "yes," type of consolidation Unitized

If answer is "no," list the owners and tract descriptions which have actually been consolidated. (Use reverse side of this form if necessary.)

No allowable will be assigned to the well until all interests have been consolidated (by communitization, unitization, forced-pooling, or otherwise) or until a non-standard unit, eliminating such interests, has been approved by the Commission.

		<p align="center"><b>RECEIVED</b> JUN 06 1984 BUREAU OF LAND MANAGEMENT FARMINGTON RESOURCE AREA</p>	
		<p align="center">Sec. 29</p>	
<p align="center"><b>RECEIVED</b> FEB 14 1985 OIL CON. DIV.</p>		<p align="center">820'</p>	

Scale: 1"=1000'

**CERTIFICATION**

I hereby certify that the information contained herein is true and complete to the best of my knowledge and belief.

**Original Signed By**  
**B. D. Shaw**

Name  
**B. D. Shaw**  
Position  
**Adm. Supervisor**  
Company  
**Amoco Production Co.**  
Date  
**5/30/84**

I hereby certify that the well location shown on this plat was plotted from field notes of actual surveys made by me or under my supervision, and that the same is true and correct to the best of my knowledge and belief.

Date Surveyed  
**April 14, 1983**  
Registered Professional Engineer and Land Surveyor  
**Fred B. Kerr Jr.**  
Certificate No. **3950**

<p>GCU #185 19</p> <p>GCU #186E</p> <p>GCU #185E</p> <p>GCU #186</p> <p>GCU #132 SOUTH AND ROYALTY CO</p> <p>GCU #192E 30</p> <p>GCU #193</p> <p>GCU #193E</p> <p>GCU #192</p> <p>GCU #159</p> <p>GCU #177</p>	<p>GCU #227E</p> <p>GCU #227</p> <p>GCU #198</p> <p>GCU #174E</p> <p>GCU #184</p> <p>GCU #229E</p>
<p>GCU #241</p> <p>AMOCO</p> <p>GCU #165</p> <p>AMOCO</p> <p>GCU #174</p> <p>GCU #184E</p> <p>GCU #190 32</p> <p>GCU #195</p> <p>GCU #196E</p> <p>GCU #196</p>	<p>GCU #229</p> <p>GCU #174E</p> <p>GCU #184</p> <p>GCU #194</p> <p>GCU #195E</p>

▲ BASIN DAKOTA WELLS  
● CHA CHA GALLUP WELLS

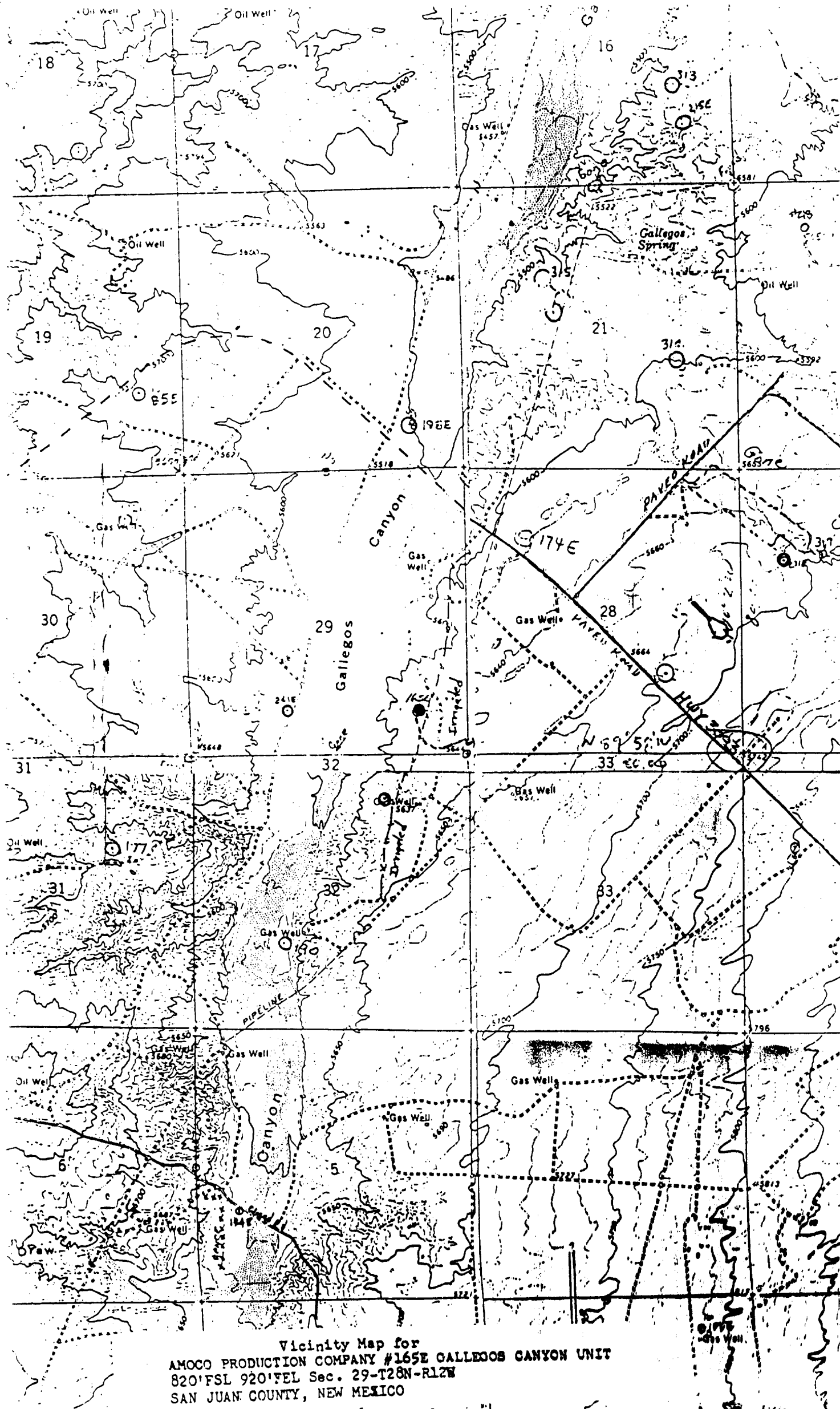

Vicinity Map for  
AMOCO PRODUCTION COMPANY #165E GALLEGOS CANYON UNIT  
820' FSL 920' FEL Sec. 29-T28N-R12W  
SAN JUAN COUNTY, NEW MEXICO