

UNITED STATES
DEPARTMENT OF THE INTERIOR
BUREAU OF LAND MANAGEMENT

SUBMIT IN TRIPLICATE*
(Other instructions on
reverse side)

3-015-28547
Form approved.
Budget Bureau No. 1004-0136
Expires August 31, 1985

RECEIVED
BLM

APPLICATION FOR PERMIT TO DRILL, DEEPEN, OR PLUG BACK

1a. TYPE OF WORK DRILL <input checked="" type="checkbox"/> DEEPEN <input type="checkbox"/> PLUG BACK <input type="checkbox"/>		5. LEASE DESIGNATION AND SERIAL NO. SF 078019	
b. TYPE OF WELL OIL WELL <input type="checkbox"/> GAS WELL <input checked="" type="checkbox"/> OTHER <input type="checkbox"/>		6. IF INDIAN, ALLOTTEE OR TRIBE NAME 019 FARMINGTON, N.M.	
2. NAME OF OPERATOR BHP Petroleum (Americas) Inc.		7. UNIT AGREEMENT NAME N.M.	
3. ADDRESS OF OPERATOR 5847 San Felipe Suite #3600 Houston, Texas 77057		8. FARM OR LEASE NAME E. H. Pipkin	
4. LOCATION OF WELL (Report location clearly and in accordance with any State requirements.)* At surface 995' FSL & 1635' FWL (SE SW) At proposed prod. zone		9. WELL NO. 29	
14. DISTANCE IN MILES AND DIRECTION FROM NEAREST TOWN OR POST OFFICE* Approximately 12 miles southeast of Farmington, NM.		10. FIELD AND POOL, OR WILDCAT Basin Fruitland Coal	
15. DISTANCE FROM PROPOSED* LOCATION TO NEAREST PROPERTY OR LEASE LINE, FT. (Also to nearest drlg. unit line, if any) 995'		11. SEC., T., R., M., OR BLK. AND SURVEY OR AREA N Sec. 35 T 28N R11W	
16. NO. OF ACRES IN LEASE 2560.96		12. COUNTY OR PARISH San Juan	
17. NO. OF ACRES ASSIGNED TO THIS WELL W/320		13. STATE NM	
18. DISTANCE FROM PROPOSED LOCATION* TO NEAREST WELL, DRILLING, COMPLETED, OR APPLIED FOR, ON THIS LEASE, FT. Approx. 275'		19. PROPOSED DEPTH 2000'	
20. ROTARY OR CABLE TOOLS Rotary		21. APPROX. DATE WORK WILL START* As soon as approved	
22. ELEVATIONS (Show whether DF, RT, GR, etc.) 5905' GR		23. PROPOSED CASING AND CEMENTING PROGRAM This action is subject to technical and procedural review pursuant to 43 CFR 3155.3 and appeal pursuant to 43 CFR 3155.4.	

SIZE OF HOLE	SIZE OF CASING	WEIGHT PER FOOT	SETTING DEPTH	GENERAL QUANTITY OF CEMENT
8 3/4"	7"	20#	± 120'	50 sx
6 1/4"	4 1/2"	10.5#	±2000'	230 sx

Item 6.D addresses the use of off lease roads crossing BLM managed surface via a Right of Way.

RECEIVED
MAY 20 1991
OIL CON. DIV.
DIST. 3

IN ABOVE SPACE DESCRIBE PROPOSED PROGRAM: If proposal is to deepen or plug back, give data on present productive zone and proposed new productive zone. If proposal is to drill or deepen directionally, give pertinent data on subsurface locations and measured and true vertical depths. Give blowout preventer program, if any.

24. SIGNED Chuck Williams TITLE Field Services Administrator DATE April 4, 1991
(This space for Federal or State office use)

PERMIT NO. _____ APPROVAL DATE _____

APPROVED BY _____ TITLE _____
CONDITIONS OF APPROVAL, IF ANY:

APPROVED
AS AMENDED
MAY 15 1991
AREA MANAGER

NMCOO

*See Instructions On Reverse Side

Submit to Appropriate
District Office
State Leases - 4 copies
Fee Leases - 3 copies

State of New Mexico
Energy, Minerals and Natural Resources Department

Form C-102
Revised 1-1-88

OIL CONSERVATION DIVISION

P.O. Box 2088
Santa Fe, New Mexico 87504-2088

RECEIVED
BLM

91 APR -8 PM 3:05

DISTRICT I
P.O. Box 1980, Hobbs, NM 88240

DISTRICT II
P.O. Drawer DD, Artesia, NM 88210

DISTRICT III
1000 Rio Brazos Rd., Aztec, NM 87410

WELL LOCATION AND ACREAGE DEDICATION PLAT

All Distances must be from the outer boundaries of the section.

019 FARMINGTON, N.M.

Operator BHP PETROLEUM (AMERICAS) INC.		Lease E.H. PIPKIN		Well No. 29
Unit Letter N	Section 35	Township 28 N	Range 11 W	County San Juan
Actual Footage Location of Well: 995 feet from the South line and 1635 feet from the West line				
Ground level Elev. 5905	Producing Formation Fruitland Coal	Pool Basin Fruitland Coal	Dedicated Acreage: 320 Acres	
<p>1. Outline the acreage dedicated to the subject well by colored pencil or hatchure marks on the plat below.</p> <p>2. If more than one lease is dedicated to the well, outline each and identify the ownership thereof (both as to working interest and royalty).</p> <p>3. If more than one lease of different ownership is dedicated to the well, have the interest of all owners been consolidated by communitization, unitization, force-pooling, etc.? <input type="checkbox"/> Yes <input type="checkbox"/> No If answer is "yes" type of consolidation _____</p> <p>If answer is "no" list the owners and tract descriptions which have actually been consolidated. (Use reverse side of this form if necessary.)</p> <p>No allowable will be assigned to the well until all interests have been consolidated (by communitization, unitization, forced-pooling, or otherwise) or until a non-standard unit, eliminating such interest, has been approved by the Division.</p>				

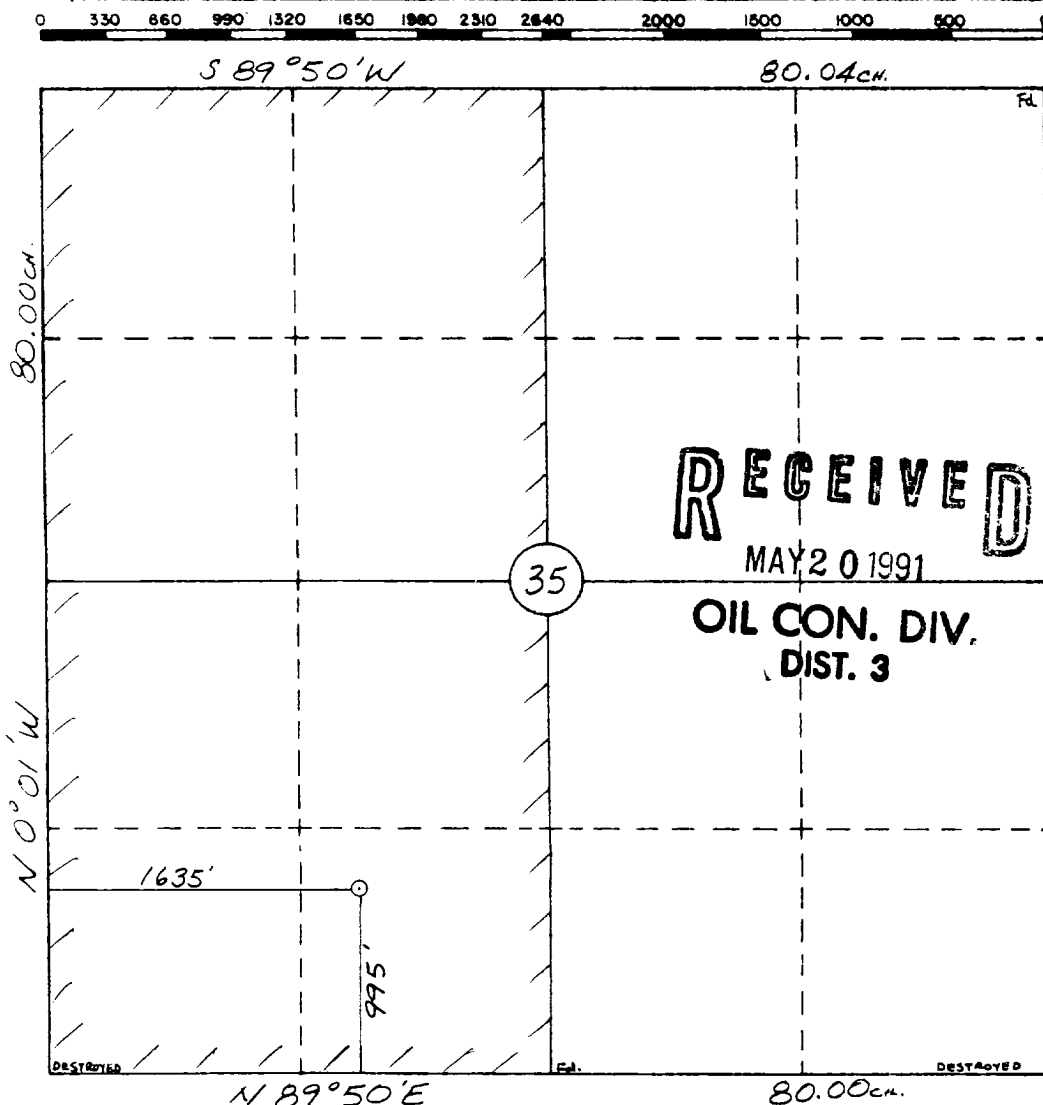

OPERATOR CERTIFICATION

I hereby certify that the information contained herein is true and complete to the best of my knowledge and belief.

Signature
Chuck Williams
Printed Name
Chuck Williams
Position
Field Services Administra
Company
BHP Petroleum (Americas)
Date
April 1, 1991

SURVEYOR CERTIFICATION

I hereby certify that the well location shown on this plat was plotted from field notes of actual surveys made by me or under my supervision, and that the same is true and correct to the best of my knowledge and belief.

3-18-91

Date Surveyed
William E. Manke II
Signature & Seal of
Professional Surveyor
#8466
Certificate No. 8466
NEW MEXICO
PROFESSIONAL LAND SURVEYOR

INDIAN POST QUADRANGLE UNITED STATES
MEXICO-SAN JUAN CO. DEPARTMENT OF THE INTERIOR
SERIES (TOPOGRAPHIC) GEOLOGICAL SURVEY

