

UNITED STATES
DEPARTMENT OF THE INTERIOR
BUREAU OF LAND MANAGEMENTRECEIVED
BLM

APPLICATION FOR PERMIT TO DRILL OR DEEPEN

1a. TYPE OF WORK

DRILL ☒DEEPEN ☐

b. TYPE OF WELL

OIL
WELL ☐GAS
WELL ☒

OTHER

SINGLE
ZONE ☒MULTIPLE
ZONES ☐

2. NAME OF OPERATOR

Robert L. Bayless

3. ADDRESS AND TELEPHONE NO.

P O Box 168 Farmington, NM 87499 505-326-2659

4. LOCATION OF WELL (Report location clearly and in accordance with any State requirements.)*

At surface

1190' FNL & 1055' FWL

At proposed prod. zone

same

14. DISTANCE IN MILES AND DIRECTION FROM NEAREST TOWN OR POST OFFICE*

2 miles south of Bloomfield

15. DISTANCE FROM PROPOSED*

LOCATION TO NEAREST
PROPERTY OR LEASE LINE, FT.

(Also to nearest drlg. unit line, if any) 1055

18. DISTANCE FROM PROPOSED LOCATION*

TO NEAREST WELL, DRILLING, COMPLETED,
OR APPLIED FOR, ON THIS LEASE, FT.

16. NO. OF ACRES IN LEASE

160

19. PROPOSED DEPTH

1700

17. NO. OF ACRES ASSIGNED
TO THIS WELL

160

20. ROTARY OR CABLE TOOLS

Rotary

21. ELEVATIONS (Show whether DF, RT, GR, etc.)

5550 KB/

22. APPROX. DATE WORK WILL START*

ASAP

23.

PROPOSED CASING AND CEMENTING PROGRAM

SIZE OF HOLE	GRADE, SIZE OF CASING	WEIGHT PER FOOT	SETTING DEPTH	QUANTITY OF CEMENT
12 1/4	7"	23.0	120	75 sx (88.5 CF)
6 1/4	4 1/2"	10.5	1700	150 sx (227.5 CF)

Will drill 12 1/4" hole to 120 ft. and set 120 ft. 7" 23#/ft. J-55 used casing. Will cement with 75 sx (88.5 CF) Class B cement, circulated to surface. Will drill 6 1/4" hole to 1700 ft. and set 1700 ft. 4 1/2" 10.5#/ft. J-55 new casing. Will cement with 150 sx (227.5 CF) cement, circulated to surface. Circulating medium will be clear water, natural mud, and water loss additives. No abnormal temperature or pressure is anticipated. Induction and density logs will be run. Blowout preventer schematic is attached. The gas from this well is not dedicated.

Estimated Tops

Ojo Alamo 340
Kirtland 500
Fruitland 1260
Pictured Cliffs 1547

RECEIVED
JUL 21 1995

OIL CON. DIV.

DIST. 3

IN ABOVE SPACE DESCRIBE PROPOSED PROGRAM: If proposal is to deepen, give data on present productive zone and proposed new productive zone. If proposal is to drill or deepen directionally, give pertinent data on subsurface locations and measured and true vertical depths. Give blowout preventer program, if any.

24.

SIGNED

TITLE Petroleum EngineerDATE 5-19-95

(This space for Federal or State office use)

PERMIT NO. _____

APPROVAL DATE _____

Application approval does not warrant or certify that the applicant holds legal or equitable title to those rights in the subject lease which would be necessary to conduct operations thereon.

CONDITIONS OF APPROVAL, IF ANY:

APPROVED BY

TITLE

NMOCD

*See Instructions On Reverse Side

Title 18 U.S.C. Section 1001, makes it a crime for any person knowingly and willfully to make to any department or agency of the United States any false, fictitious or fraudulent statements or representations as to any matter within its jurisdiction.

5. LEASE DESIGNATION AND SERIAL NO.

NM-020498-A

6. IF INDIAN, ALLOTTEE OR TRIBE NAME

7. UNIT AGREEMENT NAME

8. FARM OR LEASE NAME, WELL NO.

Horn Canyon #1 17302

9. API WELL NO.

30-045-29266

10. FIELD AND POOL, OR WILDCAT

Fulcher Kutz PC 77200

11. SEC., T., R., M., OR BLK.
AND SURVEY OR AREA

D Sec. 15-T28N-R11W

12. COUNTY OR PARISH

San Juan

13. STATE

NM

District I
PO Box 1980, Hobbs, NM 88241-1980
District II
PO Drawer DD, Artesia, NM 88211-0719
District III
1000 Rio Brazos Rd., Aztec, NM 87410
District IV
PO Box 2088, Santa Fe, NM 87504-2088

State of New Mexico
Energy, Minerals & Natural Resources Department

Form C-102
Revised February 21, 1994
Instructions on back
Submit to Appropriate District Office
State Lease - 4 Copies
Fee Lease - 3 Copies

OIL CONSERVATION DIVISION
PO Box 2088
Santa Fe, NM 87504-2088

RECEIVED
BLM
JUL 23 PM 2:34

☐ AMENDED REPORT

WELL LOCATION AND ACREAGE DEDICATION PLAT

1 API Number 30-045-29266		2 Pool Code 77200		3 Pool Name Fulcher Kutz PC	
4 Property Code 17302		5 Property Name HORN CANYON			6 Well Number 1
7 OGRID No. 19418		8 Operator Name ROBERT L. BAYLESS			9 Elevation 5545

10 Surface Location

UL or lot no.	Section	Township	Range	Lot Idn	Feet from the	North/South line	Feet from the	East/West line	County
D	15	28 N	11 W		1190	North	1055	West	San Juan

11 Bottom Hole Location If Different From Surface

UL or lot no.	Section	Township	Range	Lot Idn	Feet from the	North/South line	Feet from the	East/West line	County

12 Dedicated Acres	13 Joint or Infill	14 Consolidation Code	15 Order No.

NO ALLOWABLE WILL BE ASSIGNED TO THIS COMPLETION UNTIL ALL INTERESTS HAVE BEEN CONSOLIDATED
OR A NON-STANDARD UNIT HAS BEEN APPROVED BY THE DIVISION

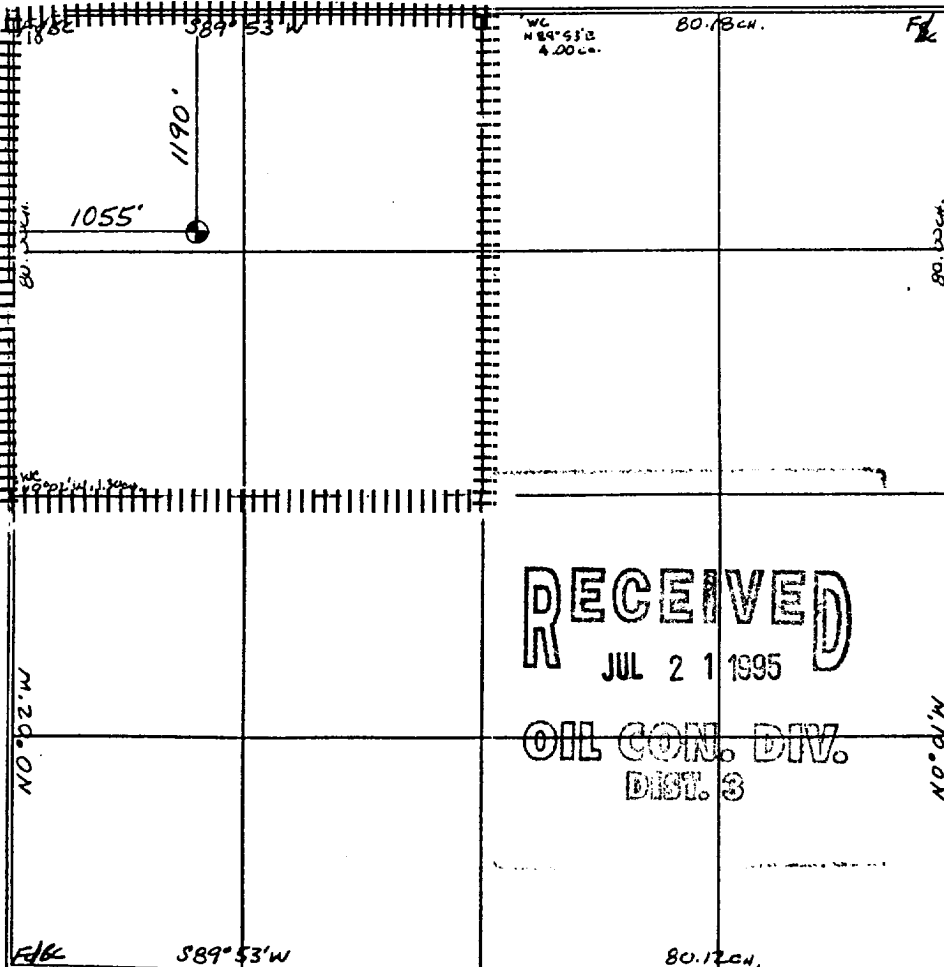
	<p>17 OPERATOR CERTIFICATION</p> <p>I hereby certify that the information contained herein is true and complete to the best of my knowledge and belief</p> <p><i>[Signature]</i> Signature Price M. Bayless Printed Name Petroleum Engineer Title 5-19-95 Date</p>
	<p>18 SURVEYOR CERTIFICATION</p> <p>I hereby certify that the well location shown on this plat was plotted from field notes of actual surveys made by me or under my supervision, and that the same is true and correct to the best of my belief.</p> <p><i>[Signature]</i> Date of Survey Signature and Seal of Professional Surveyor #8466 William E. Mahnke II Certificate Number 8466</p>

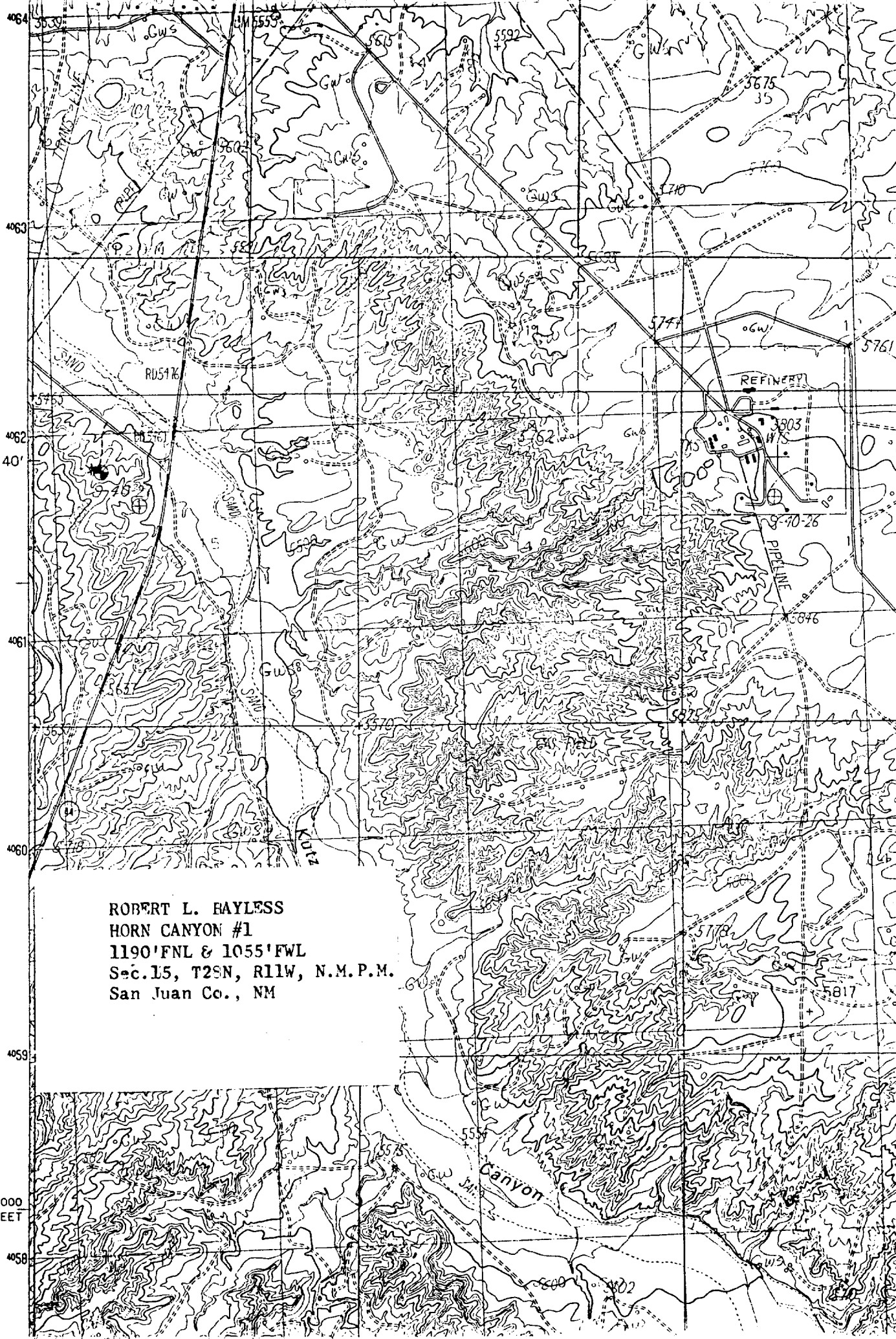

ROBERT L. HAYLESS
HORN CANYON #1
1190' FNL & 1055' FWL
Sec. 15, T29N, R11W, N.M.P.M.
San Juan Co., NM