

Submit 3 Copies  
to Appropriate  
District Office

State of New Mexico  
Energy, Minerals and Natural Resources Department

Form C-103  
Revised 1-1-89

**DISTRICT I**

P.O. Box 1980, Hobbs NM 88241-1980

**DISTRICT II**

P.O. Drawer DD, Artesia, NM 88210

**DISTRICT III**

1000 Rio Brazos Rd., Aztec, NM 87410

**OIL CONSERVATION DIVISION**

2040 Pacheco St.  
Santa Fe, NM 87505

WELL API NO. 30-039-07471	
5. Indicate Type of Lease STATE <input type="checkbox"/> FEE <input checked="" type="checkbox"/>	
6. State Oil & Gas Lease No.	
7. Lease Name or Unit Agreement Name San Juan 29-6 Unit 009257	
8. Well No. SJ 29-6 Unit #16	
9. Pool name or Wildcat Blanco Mesaverde 72319	
10. Elevation (Show whether DF, RKB, RT, GR, etc.)	

SUNDRY NOTICES AND REPORTS ON WELLS (DO NOT USE THIS FORM FOR PROPOSALS TO DRILL OR TO DEEPEN OR PLUG BACK TO A DIFFERENT RESERVOIR. USE "APPLICATION FOR PERMIT (FORM C-101) FOR SUCH PROPOSALS.)	
1. Type of Well: OIL WELL <input type="checkbox"/> GAS WELL <input checked="" type="checkbox"/> OTHER <input type="checkbox"/>	
2. Name of Operator Phillips Petroleum Company	
3. Address of Operator 5525 Highway 64, NBU 3004, Farmington NM 87401	
4. Well Location Unit Letter <u>N</u> <u>900</u> Feet From The <u>South</u> Line and <u>1650</u> Feet From The <u>West</u> Line Section <u>32</u> Township <u>29N</u> Range <u>6W</u> NMPM Rio Arriba County	
10. Elevation (Show whether DF, RKB, RT, GR, etc.)	

11. Check Appropriate Box to Indicate Nature of Notice, Report, or Other Data	
<b>NOTICE OF INTENTION TO:</b>	<b>SUBSEQUENT REPORT OF:</b>
PERFORM REMEDIAL WORK <input type="checkbox"/>	REMEDIAL WORK <input type="checkbox"/>
TEMPORARILY ABANDON <input type="checkbox"/>	ALTERING CASING <input type="checkbox"/>
PULL OR ALTER CASING <input type="checkbox"/>	COMMENCE DRILLING OPNS. <input type="checkbox"/>
OTHER: <u>Add Lewis pay to MV &amp; PC pay &amp; commingle</u> <input checked="" type="checkbox"/>	PLUG AND ABANDONMENT <input type="checkbox"/>
	CASING TEST AND CEMENT JOB <input type="checkbox"/>
	OTHER: <input type="checkbox"/>

12. Describe Proposed or Completed Operations (Clearly state all pertinent details, and give pertinent dates, including estimated date of starting any proposed work) SEE RULE 1103.

Plans are to add pay & stimulate the Lewis Shale within the exiting Mesaverde interval and then add PC pay and stimulate. Production will be commingled after completion and DHC order application submitted per Order R-11187. The individual well commingling application will be filed and approval received before actual commingling occurs. Brief details of the procedure we will use are as follow:

MIRU. COOH w/tubing. Cleanout to PBTD. Run GR/CCL/CBL to select perms. If records or logs indicate no cement across zones of interest, it may be necessary to shoot squeeze holes in casing and pump sufficient volumes of cement to cover & isolate these intervals. Isolate existing MV perms w/CIBP. Add Lewis Shale pay and stimulate. Flow back. RIH w/CIBP & isolate all MV intervals, then perforate and stimulate the PC interval. Cleanout to CIBP & drill out. RIH w/tubing and flow test the Pictured Cliffs for several months till pressures stablize. Once pressure from the Pictured Cliffs is below initial Mesaverde pressure, RIH & drillout remaining CIBP & cleanout to PBTD. Run tubing and commingle production.

I hereby certify that the information above is true and complete to the best of my knowledge and belief.

SIGNATURE Patsy Clugston TITLE Regulatory Assistant DATE 10/14/99  
TYPE OR PRINT NAME Patsy Clugston TELEPHONE NO. 505-599-3454

(This space for State Use)

ORIGINAL SIGNED BY ERNIE BUSCH

APPROVED BY \_\_\_\_\_ TITLE DEPUTY OIL & GAS INSPECTOR, DIST. #1 DATE OCT 21 1999

CONDITIONS OF APPROVAL, IF ANY:

District I  
PO Box 1980, Hobbs, NM 88241-1980

District II

811 South First, Artesia, NM 88210

District III

1000 Rio Brazos Rd., Aztec, NM 87410

District IV

2040 South Pacheco, Santa Fe, NM 87505

State of New Mexico  
Energy, Minerals & Natural Resources Department

OIL CONSERVATION DIVISION  
2040 South Pacheco  
Santa Fe, NM 87505

Form C-102

Revised October 18, 1994

Instructions on back

Submit to Appropriate District Office

State Lease - 4 Copies

Fee Lease - 3 Copies

☐ AMENDED REPORT

WELL LOCATION AND ACREAGE DEDICATION PLAT

<sup>1</sup> API Number 30-039-07471	<sup>2</sup> Pool Code 72439	<sup>3</sup> Pool Name S. Blanco Pictured Cliffs, Ext.
<sup>4</sup> Property Code 009257	<sup>5</sup> Property Name San Juan 29-6 Unit	<sup>6</sup> Well Number 16
<sup>7</sup> OGRID No. 017654	<sup>8</sup> Operator Name Phillips Petroleum Company	<sup>9</sup> Elevation 6752'

<sup>10</sup> Surface Location

UL or lot no.	Section	Township	Range	Lot Ida	Feet from the	North/South line	Feet from the	East/West line	County
N	32	29N	6W		900	South	1650	West	Rio Arriba

<sup>11</sup> Bottom Hole Location If Different From Surface

UL or lot no.	Section	Township	Range	Lot Ida	Feet from the	North/South line	Feet from the	East/West line	County
N									

<sup>12</sup> Dedicated Acres 160 ac SW/4	<sup>13</sup> Joint or Infill J	<sup>14</sup> Consolidation Code U	<sup>15</sup> Order No.
---	------------------------------------	---------------------------------------	-------------------------

NO ALLOWABLE WILL BE ASSIGNED TO THIS COMPLETION UNTIL ALL INTERESTS HAVE BEEN CONSOLIDATED  
OR A NON-STANDARD UNIT HAS BEEN APPROVED BY THE DIVISION

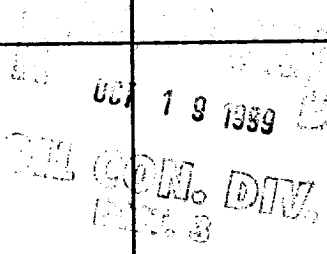
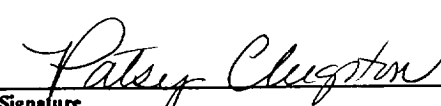
16	Section 32	Fee 6382.92 acres	1650'	900'		<b><sup>17</sup> OPERATOR CERTIFICATION</b> I hereby certify that the information contained herein is true and complete to the best of my knowledge and belief   Signature Patsy Clugston Printed Name Regulatory Assistant Title 10-15-99 Date
						<b><sup>18</sup> SURVEYOR CERTIFICATION</b> I hereby certify that the well location shown on this plat was plotted from field notes of actual surveys made by me or under my supervision, and that the same is true and correct to the best of my belief. May 6, 1955 Date of Survey Signature and Seal of Professional Surveyer: See Plat signed by James P. Leese 1463 Certificate Number

PKQ

REC'D MAY 9 1955

Copies sent to  
Aibg. 5-9-55  
ll

Company PACIFIC NORTHWEST PIPELINE CORPORATION

Lease ..... Well No. ....

Sec. # 32, T. 29 N, R. 6 W, N.M.P.M.

Location 900' from the South line and 1650' from the West line.

Elevation 6752 Ungraded ground.

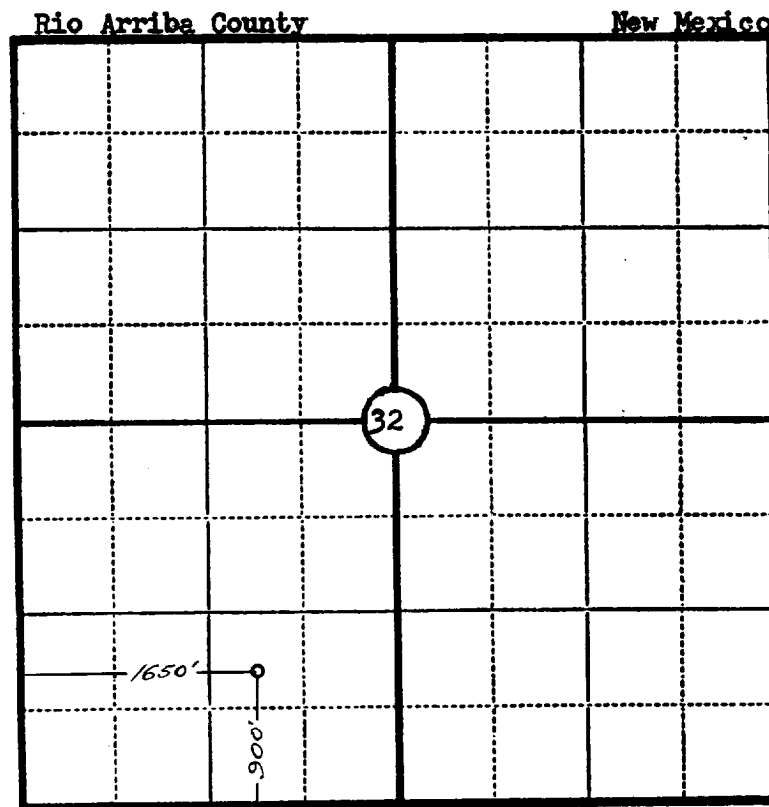

RECEIVED  
OCT 19 1955  
OIL CON. DIV.  
FILE 8

Scale—4 inches equal 1 mile.

This is to certify that the above plat was prepared from field notes of actual surveys made by me or under my supervision and that the same are true and correct to the best of my knowledge and belief.

Seal:

*James P. Leese*  
Registered ~~Surveyor~~ Land Surveyor.

James P. Leese  
N. Mex. Reg. No. 1463

Surveyed 6 May, 1955

SAN JUAN ENGINEERING CO.  
P. O. Box 752  
FARMINGTON, N. M.

Submit 3 Copies  
to Appropriate  
District Office

State of New Mexico  
Energy, Minerals and Natural Resources Department

Form C-103  
Revised 1-1-89

**DISTRICT I**

P.O. Box 1980, Hobbs NM 88241-1980

**DISTRICT II**

P.O. Drawer DD, Artesia, NM 88210

**DISTRICT III**

1000 Rio Brazos Rd., Aztec, NM 87410

**OIL CONSERVATION DIVISION**

2040 Pacheco St.  
Santa Fe, NM 87505

WELL API NO.  
30-039-07471

Indicate Type of Lease  
STATE ☐ FEE ☒

State Oil & Gas Lease No.

SUNDRY NOTICES AND REPORTS ON WELLS (DO NOT USE THIS FORM FOR PROPOSALS TO DRILL OR TO DEEPEN OR PLUG BACK TO A DIFFERENT RESERVOIR. USE "APPLICATION FOR PERMIT" (FORM C-101) FOR SUCH PROPOSALS.)	
1. Type of Well: OIL WELL <input type="checkbox"/> GAS WELL <input checked="" type="checkbox"/> OTHER _____ 505-599-3454	7. Lease Name or Unit Agreement Name San Juan 29-6 Unit 009257
2. Name of Operator Phillips Petroleum Company	8. Well No. SJ 29-6 Unit #16
3. Address of Operator 5525 Highway 64, NBU 3004, Farmington NM 87401	9. Pool name or Wildcat Blanco MV-72319; S Blanco PC-72439
4. Well Location Unit Letter <u>N</u> <u>900</u> Feet From The <u>South</u> Line and <u>1650</u> Feet From The <u>West</u> Line Section <u>32</u> Township <u>29N</u> Range <u>6W</u> NMPM Rio Arriba County	
10. Elevation (Show whether DF, RKB, RT, GR, etc.)	

11. Check Appropriate Box to Indicate Nature of Notice, Report, or Other Data

**NOTICE OF INTENTION TO:**

PERFORM REMEDIAL WORK ☐ PLUG AND ABANDON ☐  
TEMPORARILY ABANDON ☐ CHANGE PLANS ☐  
PULL OR ALTER CASING ☐  
OTHER: \_\_\_\_\_ ☐

**SUBSEQUENT REPORT OF:**

REMEDIAL WORK ☐ ALTERING CASING ☐  
COMMENCE DRILLING OPNS. ☐ PLUG AND ABANDONMENT ☐  
CASING TEST AND CEMENT JOB ☐  
OTHER: Add Lewis to MV; then add PC & commingle ☒

12. Describe Proposed or Completed Operations (Clearly state all pertinent details, and give pertinent dates, including estimated date of starting any proposed work) SEE RULE 1103.

See attached for the procedure used to add pay & stimulate the Lewis Shale interval within the existing Mesaverde formation. After this was completed, a CIBP was set to isolate the Mesaverde intervals and then we moved uphole and added pay and stimulated the S. Blanco Pictured Cliffs, Ext.

Plans are to flow the Pictured Cliff interval until the pressure from the Pictured Cliff interval is below the initial Mesaverde pressure. We will then drill out the remaining CIPB(s) and cleanout to PBTD. Rerun tubing and then commingle production from both pools. The individual well commingling application will be filed and approved before actual commingling occurs. Commingling from both pools will be done per Order R-11187.

I hereby certify that the information above is true and complete to the best of my knowledge and belief.

SIGNATURE Patsy Clugston TITLE Regulatory Assistant DATE \_\_\_\_\_

TYPE OR PRINT NAME Patsy Clugston TELEPHONE NO. 505-599-3454

(This space for State Use)

ORIGINAL SIGNED BY CHARLIE T. PERRIN

DEPUTY OIL & GAS INSPECTOR, DIST. DEC - 3 1999

APPROVED BY \_\_\_\_\_ TITLE \_\_\_\_\_ DATE \_\_\_\_\_

CONDITIONS OF APPROVAL, IF ANY:

**San Juan 29-6 Unit #16**  
**Fee; Unit N, 900' FSL & 1650' FWL**  
**Section 32, T29N, R6W; Rio Arriba County, NM**

Procedure used to add more pay & stimulate the Lewis Shale interval within the existing Mesaverde interval, then added the Picture Cliffs pay. This well will commingled once pressures are stabilized.

11/5/99

MIRU Key Energy #29. ND WH & NU BOPs. PT - OK. COOH w/2-3/8" tubing. RIH w/7" bit & scraper to 5310'. COOH. RIH w/4-3/4" bit & cleaned out fill. COOH. RIH w/7" CIBP & set @ 5300'. Load casing w/2% KCL H2O & PT plug, casing & rams to 600 psi - 30 minutes. OK. POOH. RU Blue Jet & ran GR/CCL/CBL from 5309' to surface. TOC @ 4652'. Perforated 2 squeeze holes @ 4220'. RIH w/7" cement retainer & set @ 4190'. PT - OK. Established injection rate into squeeze holes. Pumped 50 sx Class H Neat cement @ 15.8 ppg, displaced @ 1 bpm. Stung out of retainer w/450 psi squeeze pressure. Reversed out 9 sx of good cement to surface. POOH.

RIH w/6-1/8" bit & tagged up @ 4190'. Drilled out cement retainer @ 4190' to 4193'. Drilled cement from 4193' - 4221'. Circ. hole clean. PT squeeze holes to 600 psi - held 20 minutes OK. COOH w/bit. RU Blue Jet & perforated Lewis @ 1 spf .38" holes as follows:

4919' - 4921' (3');	4860' - 4862' (3');	4828' - 4830' (3');	4754' - 4756' (3');
4742' - 4744' (3');	4629' - 4631' (3');	4608' - 4610' (3');	4602' - 4604' (3');
4406' - 4408' (3');	4350' - 4352' (3');	4340' - 4342' (3');	4330' - 4332' (3')l Total 36 holes

RIH w/7" packer & set @ 4788'. RU BJ to acidize. Pumped 1000 gal of 15% HCL & ballsealers. Unset packer & knocked balls off. RU to frac. RIH w/7" packer & set @ 4150'. PT - OK. Pumped 69,317 gal of 60 Quality N2 foam consisting on 31,340 gal of 30# X-link gel & 840,000 scf N2 gas. A 4200 gal from pad followed by 65,117 gal of foam containing 199,880 # 20/40 Brady sands. Flushed w/2730 gal of 2% KCL H2O. ATR - 44 bpm, ATP - 2350 psi. Flowed back on 1/4" and 1/2" chokes for approximately 35 hours.

RD flowback equipment. RIH w/CIPB @ set @ 3800'. Shoot squeeze holes @ 3780' (4 holes) & 3320' (2 holes). RIH w/cement retainer & set @ 3748', then established injection rate. Pumped 120 sx CI H cement w/2% CaCl2. Displaced. Pulled up & reversed out 30 bbls H2O to pit, no cement. Pressured up on casing to 500 psi. Upper holes taking fluid. Mixed and spotted 30 sx CI H cement from 3330' - 3168'. Pulled up & reversed out 25 bbls. SI casing and squeezed 2 bbls cement into perfs @ 3320'. SI tubing w/600 psi squeeze pressure. POOH. RIH w/6-1/8" bit & tagged up @ 3300'. Drilled hard cement from 3300' to 3340'. Circ. hole clean. PT squeeze to 500 psi - OK. POOH. RU Blue Jet & ran GR/CCL/CBL from 3736' - 3200'. TOC @ 3370'. No cement across upper squeeze holes. Perforated PC formation @ 1 spf .31" holes as follows:

3647' - 3652', 3636' - 3641'; 3607' - 3612' 3626' - 3528'; 3616' - 3618'; 3593' - 3595';  
3585' - 3587'; 3622' and 3623'. Total 33 holes

RIH & set 7" packer @ 3403'. RU BJ to acidize PC perfs. Pumped 750 gal of 15% HCL & ballsealers. Unseat packer & knocked off balls. POOH w/packer. RIH w/packer & set @ 3382'. RU to frac. Pumped 44,650 gal 70 Quality N2 foam consisting of 17,934 gal of 20# Linear gel & 669,000 scf N2 gas. Pumped a 882 gal foam pad followed by 17,052 gal of foam containing 105,640 # 20/40 Brady sand. Flushed w/2310 gal of foam. ATR - 48 bpm & ATP - 2910. ISDP - 1900 psi. Flowed back on 1/4" & 1/2" chokes for approx. 35 hours. RD flowback equipment. Unset FB packer & COOH. RIH w/bit & tagged up on fill @ 3600'. Cleaned out to PBTD @ 3748'. Ran 2-3/8" tubing & set @ 3603' w/"F" nipple set @ 3592'. ND BOP & NU WH. Pumped off. RD & released rig 11/29/99. Turned well over to production department.