

NEW MEXICO
OIL CONSERVATION COMMISSION

Form C-128

Well Location and/or Gas Proration Plat

Date July 18, 1956

Operator Pacific Northwest Pipeline Corporation Lease Block 2046

Well No. 3-22 Section 31 Township 29 North Range 6 West NMPM

Located 790 Feet From North Line, 1730 Feet From East Line,

Rio Arriba County, New Mexico. G. L. Elevation 6428

Name of Producing Formation San Juan Pool San Juan Dedicated Acreage 3.00

(Note: All distances must be from outer boundaries of Section)

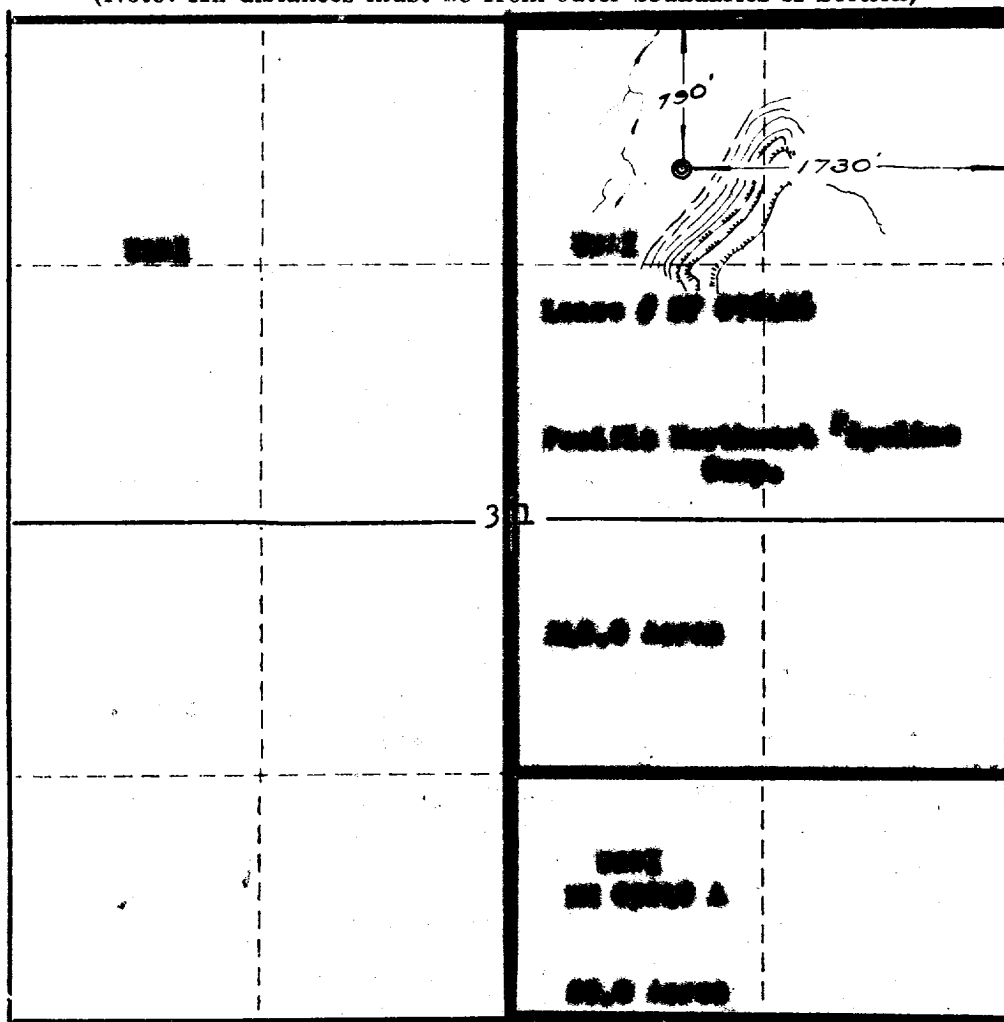

NOTE

This section of form is to be used for gas wells only.

1. Is this Well a Dual Comp. ? Yes ☒ No ☐
2. If the answer to Question 1 is yes, are there any other dually completed wells within the dedicated acreage?
Yes ☐ No ☐

Name Original signed by T. A. Dugan
Position Surveyor
Representing Pacific Northwest Pipeline Corp.
Address _____

This is to certify that the above plat was prepared from field notes of actual surveys made by me or under my supervision and that the same are true and correct to the best of my knowledge and belief.

Date Surveyed July 18, 1956

Ernest V. Echoshawk

Ernest V. Echoshawk
Reg. Land Surveyor, N. Mex., Reg. No. 1545