

UNITED STATES  
DEPARTMENT OF THE INTERIOR  
BUREAU OF LAND MANAGEMENT

FORM APPROVED  
Budget Bureau No. 1004-0135  
Expires: March 31, 1993

SUNDRY NOTICES AND REPORTS ON WELLS

Do not use this form for proposals to drill or to deepen or reentry to a different reservoir.  
Use "APPLICATION FOR PERMIT -" for such proposals.

SUBMIT IN TRIPLICATE

070 FARMINGTON, NM

1. Type of Well  
☐ Oil Well ☒ Gas Well ☐ Other

2. Name of Operator  
Phillips Petroleum Company

3. Address and Telephone No.  
5525 Highway 64, NBU 3004, Farmington, NM 87401

4. Location of Well (Footage, Sec., T., R., M., or Survey Description)  
Unit N, 790' FSL & 1800' FWL  
Section 27, T29N, R6W

5. Lease Designation and Serial No.

NM-03040-A

6. If Indian, Allottee or Tribe Name

7. If Unit or CA, Agreement Designation

San Juan 29-6 Unit

8. Well Name and No.

SJ 29-6 Unit #86

9. API Well No.

30-039-07516

10. Field and Pool, or exploratory Area

Basin Dakota

11. County or Parish, State

Rio Arriba, NM

RECEIVED  
NOV 18 1993  
OIL CON. DIV.  
DIST. 3

12. CHECK APPROPRIATE BOX(s) TO INDICATE NATURE OF NOTICE, REPORT, OR OTHER DATA

TYPE OF SUBMISSION

- ☒ Notice of Intent  
☐ Subsequent Report  
☐ Final Abandonment Notice

TYPE OF ACTION

- ☐ Abandonment  
☐ Recompletion  
☐ Plugging Back  
☐ Casing Repair  
☐ Altering Casing  
☒ Other Add MV to DK well & commngl  
☐ Change of Plans  
☐ New Construction  
☐ Non-Routine Fracturing  
☐ Water Shut-Off  
☐ Conversion to Injection  
☐ Dispose Water

(Note: Report results of multiple completion on Well Completion or Recompletion Report and Log form.)

13. Describe Proposed or Completed Operations (Clearly state all pertinent details, and give pertinent dates, including estimated date of starting any proposed work. If well is directionally drilled, give subsurface locations and measured and true vertical depths for all markers and zones pertinent to this work.)\*

The subject well was completed as a DK well in 3/65. Plans are now to add perfs & stimulate the Pt. Lookout, Menefee, Cliff House and Lewis Shale intervals within the MV formation. Flow test the MV interval and once the pressure stabilizes, PPCo plans on commingling production from DK & MV intervals per DHC Order No: R-11187. The individual well commingling application will be filed and approval received before actual commingle occurs. Brief details we will be using to complete the mentioned work are as follows:

MIRU. COOH w/tubing. Cleanout to PBTD. RIH w/CIBP & isolate DK interval from MV zones. If records or logs indicate no cement across the zones of interest, it may be necessary to shoot squeeze holes in casing and pump sufficient volumes of cement to cover and isolate those intervals. Perf and stimulate the Pt. Lookout, Menefee, Cliff House & Lewis Shale. Flow back until cleaned out to CIBP. RIH w/tubing and land. Place well on Mesaverde production only for approximately 6 months or until pressures stabilize. Once pressure stabilizes. Pull tubing and then drill out CIBP between the DK & MV intervals and cleanout to PBTD. Rerun tubing and then commingle production from both zones if DHC application approved.

14. I hereby certify that the foregoing is true and correct

Signed Toby Clugston Title Regulatory Assistant

Date 11/1/99

(This space for Federal or State office use)

Approved by /s/ Joe Hewitt Title Team Lead, Petroleum Management

Conditions of approval, if any:

Date NOV 16 1999

Title 18 U.S.C. Section 1001, makes it a crime for any person knowingly and willfully to make to any department or agency of the United States any false, fictitious or fraudulent statements or representations as to any matter within its jurisdiction.

\* See Instruction on Reverse Side

NMOCD

District I  
PO Box 1980, Hobbs, NM 88241-1980

District II

811 South First, Artesia, NM 88210

District III

1800 Rio Brazos Rd., Aztec, NM 87410

District IV

2040 South Pacheco, Santa Fe, NM 87505

State of New Mexico  
Energy, Minerals & Natural Resources Department

OIL CONSERVATION DIVISION  
2040 South Pacheco  
Santa Fe, NM 87505

RECEIVED  
BLM

Form C-102

Revised October 18, 1994

Instructions on back

Submit to Appropriate District Office

State Lease - 4 Copies

Fee Lease - 3 Copies

99 NOV -1 PM 3:34

☐ AMENDED REPORT

WELL LOCATION AND ACREAGE DEDICATION PLAT

API Number 30-039-07516		Pool Code 72319	Pool Name Blanco Mesaverde	
Property Code 009257	Property Name San Juan 29-6 Unit			Well Number #86
OGRID No. 017654	Operator Name Phillips Petroleum Company			Elevation 6317'

10 Surface Location

UL or lot no.	Section	Township	Range	Lot Idn	Feet from the	North/South line	Feet from the	East/West line	County
N	27	29N	6W		790	South	1800	West	Rio Arriba

11 Bottom Hole Location If Different From Surface

UL or lot no.	Section	Township	Range	Lot Idn	Feet from the	North/South line	Feet from the	East/West line	County
N									
Dedicated Acres 320 W/2		Joint or Infill I		Consolidation Code U		Order No.			

NO ALLOWABLE WILL BE ASSIGNED TO THIS COMPLETION UNTIL ALL INTERESTS HAVE BEEN CONSOLIDATED  
OR A NON-STANDARD UNIT HAS BEEN APPROVED BY THE DIVISION

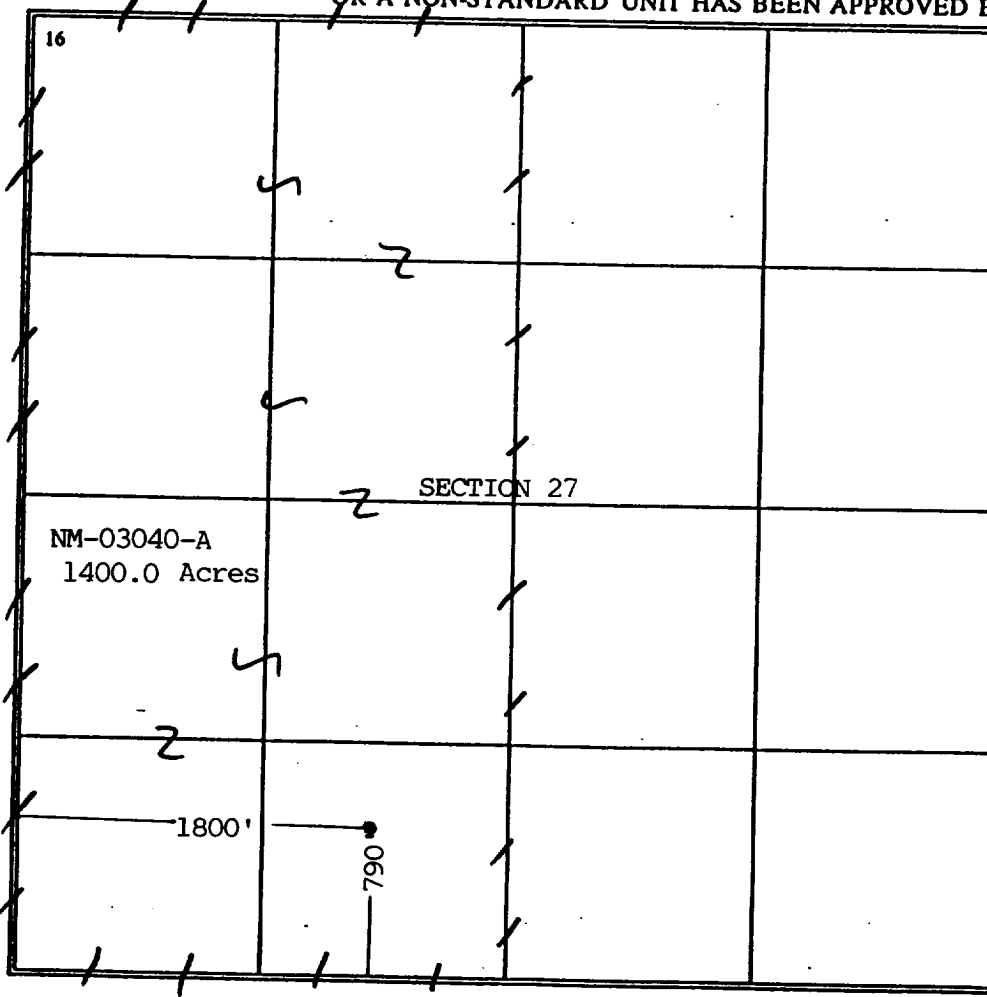

17 OPERATOR CERTIFICATION

I hereby certify that the information contained herein is true and complete to the best of my knowledge and belief

*Patsy Clugston*  
Signature

Patsy Clugston  
Printed Name

Regulatory Assistant  
Title

October 29, 1999  
Date

18 SURVEYOR CERTIFICATION

I hereby certify that the well location shown on this plat was plotted from field notes of actual surveys made by me or under my supervision, and that the same is true and correct to the best of my belief.

9/22/64  
Date of Survey

Signature and Seal of Professional Surveyor:

See plat signed by  
James P. Leese

Reg. No. 1463  
Certificate Number

OK

## Well Location and Acreage Dedication Plat

SAN JUAN INTEREST FILL

## Section A.

RECEIVED  
BLMDate October 2, 1964Operator BETA DEVELOPMENT COMPANY

San Juan 29-6 Unit

Well No. 86 Unit Letter N Township 27 99 NOV - 1 PM 3:34 Range 29 NORTH Section 6 WEST NMPMLocated 790 Feet From SOUTH Line 1800 LineCounty SAN JUAN G. L. Dakota 6317.0 070 FARMINGTON, NM W/320 Acres

Name of Producing Formation \_\_\_\_\_

1. Is the Operator the only owner in the dedicated acreage outlined on the plat attached?  
 Yes ☒ No ☐
2. If the answer to question one is "no", have the interests of all the owners been consolidated by communitization agreement or otherwise? Yes \_\_\_\_\_ No \_\_\_\_\_. If answer is "yes", Type of Consolidation \_\_\_\_\_
3. If the answer to question two is "no", list all the owners and their respective interests below:

OwnerLand Description

## Section B.

This is to certify that the information in Section A above is true and complete to the best of my knowledge and belief.

**Beta Development Co.**

Original signed by:

**JOHN T. HAMPTON, Manager**

(Representative)

**234 Petr. Club Plaza**

(Address)

**Farmington, New Mexico**

Note: All distances must be from outer boundaries of section.

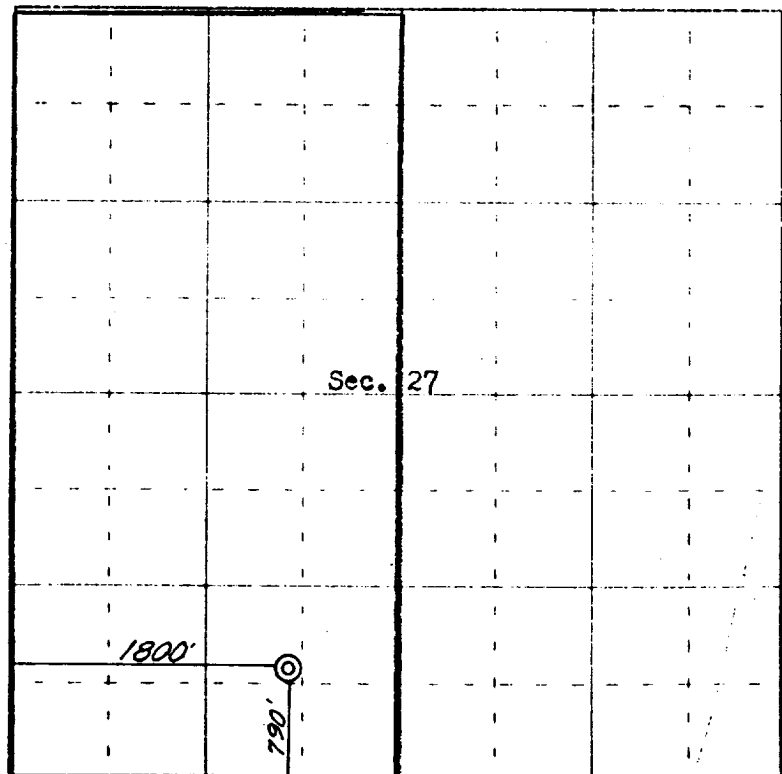

0 320 640 960 1280 1600 1920 2240 2560 2880 3200 3520 3840 4160 4480 4800 5120 5440 5760 6080 6400

Scale 4 inches equal 1 mile

Ref: GLO plat dated 19 July 1915



(Seal)

Farmington, New Mexico

This is to certify that the above plat was prepared from field notes of actual surveys made by me or under my supervision and that the same are true and correct to the best of my knowledge and belief.

Date Surveyed September 22, 1964

*James P. Leese*  
 Registered Professional Engineer and/or Land Surveyor  
 James P. Leese, N. Mex. Reg. NO. 1463