

(SUBMIT IN TRIPLICATE)

UNITED STATES  
DEPARTMENT OF THE INTERIOR  
GEOLOGICAL SURVEY

Land Office

Lease No. 03040

Unit W/2 Sec. 21

RECEIVED

JAN 15 1953

SUNDRY NOTICES AND REPORTS ON WELLS  
GEOLOGICAL SURVEY  
FARMINGTON, N. M.

NOTICE OF INTENTION TO DRILL.....	<input checked="" type="checkbox"/>	SUBSEQUENT REPORT OF WATER SHUT-OFF.....	
NOTICE OF INTENTION TO CHANGE PLANS.....		SUBSEQUENT REPORT OF SHOOTING OR ACIDIZING.....	
NOTICE OF INTENTION TO TEST WATER SHUT-OFF.....		SUBSEQUENT REPORT OF ALTERING CASING.....	
NOTICE OF INTENTION TO RE-DRILL OR REPAIR WELL.....		SUBSEQUENT REPORT OF REDRILLING OR REPAIR.....	
NOTICE OF INTENTION TO SHOOT OR ACIDIZE.....		SUBSEQUENT REPORT OF ABANDONMENT.....	
NOTICE OF INTENTION TO PULL OR ALTER CASING.....		SUPPLEMENTARY WELL HISTORY.....	
NOTICE OF INTENTION TO ABANDON WELL.....			

(INDICATE ABOVE BY CHECK MARK NATURE OF REPORT, NOTICE, OR OTHER DATA)

January 14, 1953, 19

Turner-Lockhart

Well No. 1 is located 1,650 ft. from ~~XX~~ S line and 1,650 ft. from ~~XX~~ W line of sec. 21SW 1/4 Sec. 21  
(1/4 Sec. and Sec. No.)

29N

(Twp.)

6W

(Range)

N.M.P.M.

(Meridian)

Wildcat

(Field)

Rio Arriba

(County or Subdivision)

New Mexico

(State or Territory)

ungraded ground

The elevation of the ~~desired floor~~ above sea level is 6,405 ft.

## DETAILS OF WORK

(State names of and expected depths to objective sands; show sizes, weights, and lengths of proposed casings; indicate mudding jobs, cementing points, and all other important proposed work)

Propose to drill with rotary tools to the top of the Cliff House formation with conventional mud and water; and then to drill with gas to the bottom of the Point Lookout formation; and shoot with solidified nitro glycerin.

Casing program: 175 feet of 10-3/4" - 40.5# J. & L. 55 casing. Circulate cement to surface.

Set 7" - 23# J. & L. casing on top of the Cliff House formation - expected at about 5,800 feet - and cement with 250 sacks of regular cement.

Run 2-3/8" O.D. 4.70# tubing for production, as required.

I understand that this plan of work must receive approval in writing by the Geological Survey before operations may be commenced.

Company J. Glenn Turner

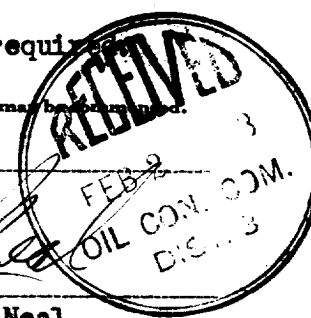
Address c/o San Juan Drilling Company  
Box 728 - Farmington, N. M.Home Office: 1711 Mercantile Bank Building  
Dallas 1, Texas.By   
C. Beeson Neal  
Title Agent in Farmington

10-10-1941

10-10-1941

10-10-1941

10-10-1941

10-10-1941

10-10-1941

10-10-1941

10-10-1941

10-10-1941

10-10-1941

10-10-1941

10-10-1941

10-10-1941

10-10-1941

10-10-1941

10-10-1941

10-10-1941

10-10-1941

10-10-1941

10-10-1941

10-10-1941

10-10-1941

10-10-1941

10-10-1941

10-10-1941

10-10-1941

10-10-1941

10-10-1941

10-10-1941

10-10-1941

10-10-1941

10-10-1941

10-10-1941

10-10-1941

10-10-1941

10-10-1941

10-10-1941

10-10-1941

RECEIVED

JAN 15 1953

U. S. GEOLOGICAL SURVEY  
FARMINGTON, N. M.

Company.....J. Glenn Turner.....

Lease.....Well No.....

Sec.....21....., T.....29 N....., R.....6 W., N.M.P.M.....

Location.....1650' from the South line and 1650' from the  
West line.

Elevation.....6405 Ungraded ground.

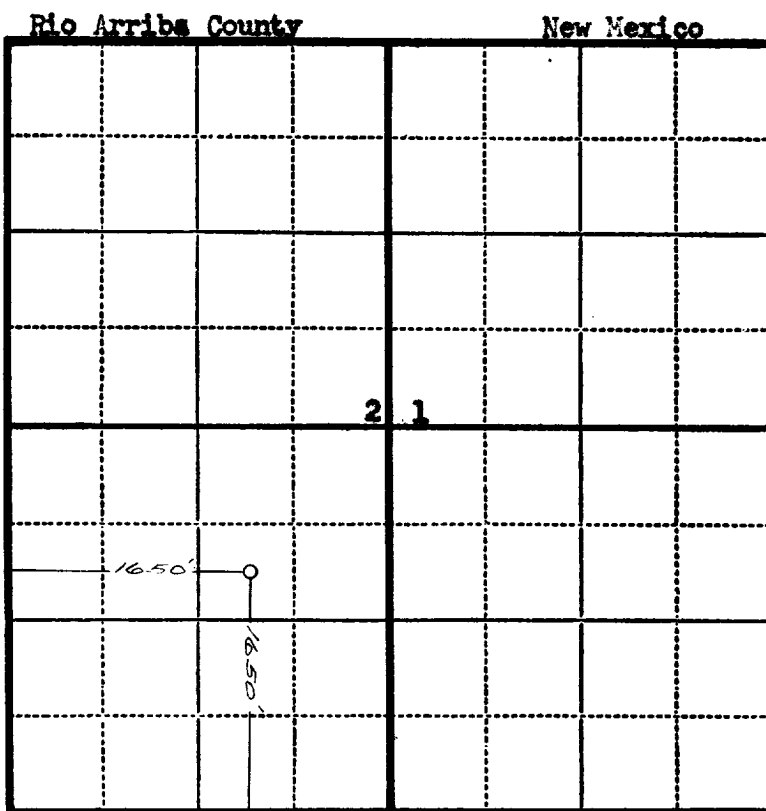

Scale—4 inches equal 1 mile.

This is to certify that the above plat was prepared from field notes of actual surveys made by me or under my supervision and that the same are true and correct to the best of my knowledge and belief.

*Charles J. Finklea*

Seal:

Registered Professional  
Engineer and Land Surveyor.

Charles J. Finklea  
N. Mex. Reg. No. 1302

Surveyed .....January 13....., 19...53.