

3 - USGS  
2 - ~~WDOCC~~  
1 - State Land Office  
1 - L. G. Truby 1 - File

Form 9-331a  
(Feb. 1951)

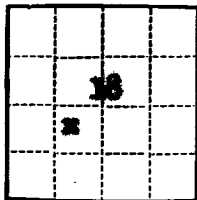

(SUBMIT IN TRIPLICATE)

UNITED STATES  
DEPARTMENT OF THE INTERIOR  
GEOLOGICAL SURVEY

Budget Bureau No. 42-R388.4.  
Approval expires 12-31-60.

Land Office Santa Fe  
Lease No. 87-978071  
Unit 14-02-001-437

SUNDRY NOTICES AND REPORTS ON WELLS

NOTICE OF INTENTION TO DRILL.....	<input checked="" type="checkbox"/>	SUBSEQUENT REPORT OF WATER SHUT-OFF.....	
NOTICE OF INTENTION TO CHANGE PLANS.....		SUBSEQUENT REPORT OF SHOOTING OR ACIDIZING.....	
NOTICE OF INTENTION TO TEST WATER SHUT-OFF.....		SUBSEQUENT REPORT OF ALTERING CASING.....	
NOTICE OF INTENTION TO RE-DRILL OR REPAIR WELL.....		SUBSEQUENT REPORT OF RE-DRILLING OR REPAIR.....	
NOTICE OF INTENTION TO SHOOT OR ACIDIZE.....		SUBSEQUENT REPORT OF ABANDONMENT.....	
NOTICE OF INTENTION TO PULL OR ALTER CASING.....		SUPPLEMENTARY WELL HISTORY.....	
NOTICE OF INTENTION TO ABANDON WELL.....			

(INDICATE ABOVE BY CHECK MARK NATURE OF REPORT, NOTICE, OR OTHER DATA)

April 23rd, 1958

S.J. 29-5 Unit  
Well No. 86-18 is located 1735 ft. from N line and 1730 ft. from E line of sec. 18  
NE/4 SW/4 Sec. 18 29 North 5 West N.M.P.M.  
( $\frac{1}{4}$  Sec. and Sec. No.) (Twp.) (Range) (Meridian)  
Blanco Mesa Verde Rio Arriba New Mexico  
(Field) (County or Subdivision) (State or Territory)

The elevation of the ground above sea level is 6981 ft.

DETAILS OF WORK

(State names of and expected depths to objective sands; show sizes, weights, and lengths of proposed casings; indicate mudding jobs, cementing points, and all other important proposed work)

Propose to drill to 200' and set 10-3/4" casing, cement to surface. Set 7-5/8" casing @ 3720', cement w/150 sz regular 8 1/2 gal and 50 sz mast. Set 5-1/2" liner from 3610' to 5900', cement w/200 sz regular.

Mesa Verde to be fractured thru perforations using approximately 150,000 gallons of water. Clean out to total depth, set tubing and complete well.

To be drilled with water or minimum mud to 7-5/8" casing point and gas to T.D.

The W/8 of Section 18, containing 300 acres, is dedicated to this well.

100% Pacific Northwest Pipeline Corp.

Contractor: Moran Brothers., Inc.

I understand that this plan of work must receive approval in writing by the Geological Survey before operations may be commenced.

Company PACIFIC NORTHWEST PIPELINE CORPORATION

Address 418 1/2 West Broadway  
Farmington, New Mexico

By Original signed by Geo. E. Pappin  
Title District Production Engineer

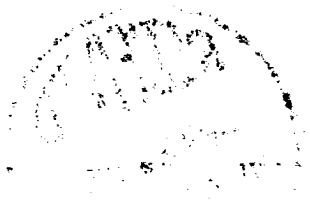

## NEW MEXICO OIL CONSERVATION COMMISSION

## Well Location and Acreage Dedication Plat

Section A.

Date **MARCH 28, 1958**

Operator **PACIFIC NORTHWEST PIPELINE CORPORATION** Lease **SAN JUAN 29-5 UNIT** SF **078277**  
 Well No. **26-18** Unit Letter **K** Section **18** Township **29-N** Range **5-W** NMPM  
 Located **1735** Feet From **SOUTH** Line, **1730** Feet From **WEST** Line  
 County **RIO ARriba** G. L. Elevation **6581** Dedicated Acreage **320** Acres  
 Name of Producing Formation **MESA VERDE** Pool **BLANCO MESA VERDE**

1. Is the Operator the only owner in the dedicated acreage outlined on the plat below?  
 Yes ☒ No ☐
2. If the answer to question one is "no", have the interests of all the owners been consolidated by communitization agreement or otherwise? Yes ☐ No ☐ If answer is "yes", Type of Consolidation.
3. If the answer to question two is "no", list all the owners and their respective interests below:

Owner

Land Description



Section B.

This is to certify that the information in Section A above is true and complete to the best of my knowledge and belief.

**PACIFIC NORTHWEST PIPELINE CORP.**

(Operator)

Original by **Geo. H. Peppin**

(Representative)

**418 1/2 West Broadway**

(Address)

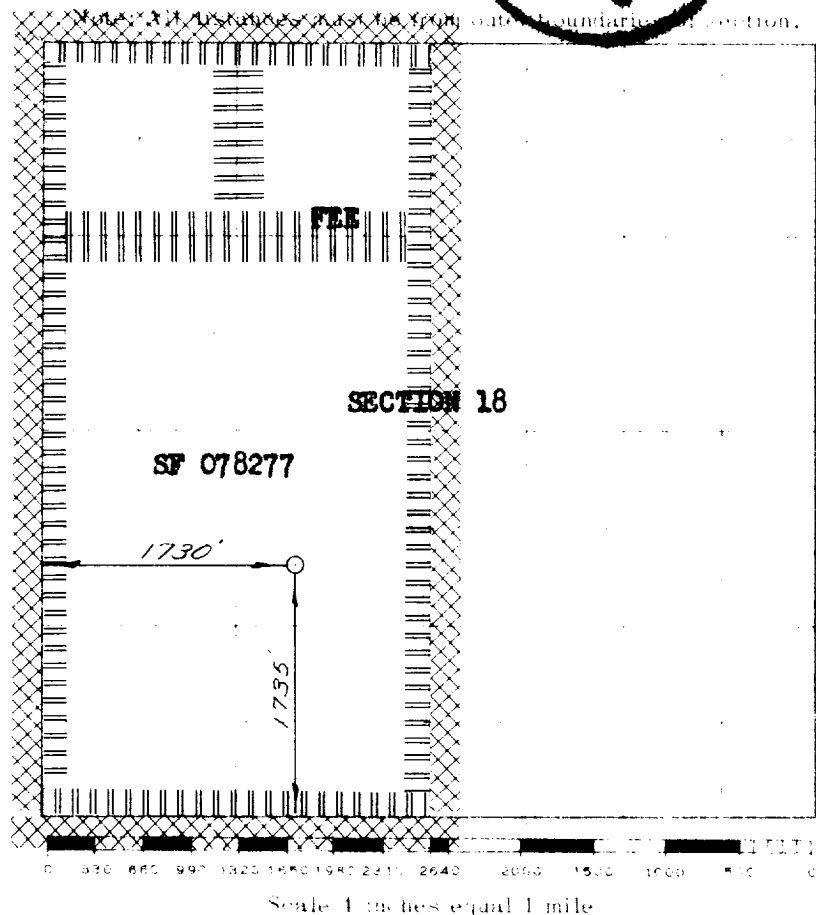
**Farmington, New Mexico**

Farmington, New Mexico

This is to certify that the above plat was prepared from field notes of actual surveys made by me or under my supervision and that the same are true and correct to the best of my knowledge and belief.

Date Surveyed **AUGUST 24, 1955**

*James P. Reese*  
 Registered Professional Engineer and/or Land Surveyor