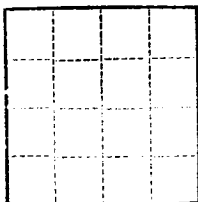

(SUBMIT IN TRIPLICATE)

UNITED STATES  
DEPARTMENT OF THE INTERIOR  
GEOLOGICAL SURVEYLand Office Santa Fe  
Lease No. 078281  
Unit 24-3  
11-03-001-437

## SUNDRY NOTICES AND REPORTS ON WELLS

|   |                                     |   |  |
|---|-------------------------------------|---|--|
| NOTICE OF INTENTION TO DRILL.....                   | <input checked="" type="checkbox"/> | SUBSEQUENT REPORT OF WATER SHUT-OFF.....        |  |
| NOTICE OF INTENTION TO CHANGE PLANS.....            |                                     | SUBSEQUENT REPORT OF SHOOTING OR ACIDIZING..... |  |
| NOTICE OF INTENTION TO TEST WATER SHUT-OFF.....     |                                     | SUBSEQUENT REPORT OF ALTERING CASING.....       |  |
| NOTICE OF INTENTION TO RE-DRILL OR REPAIR WELL..... |                                     | SUBSEQUENT REPORT OF RE-DRILLING OR REPAIR..... |  |
| NOTICE OF INTENTION TO SHOOT OR ACIDIZE.....        |                                     | SUBSEQUENT REPORT OF ABANDONMENT.....           |  |
| NOTICE OF INTENTION TO PULL OR ALTER CASING.....    |                                     | SUPPLEMENTARY WELL HISTORY.....                 |  |
| NOTICE OF INTENTION TO ABANDON WELL.....            |                                     |   |  |

(INDICATE ABOVE BY CHECK MARK NATURE OF REPORT, NOTICE, OR OTHER DATA)

January 11, 1956, 1956

Well No. 24-17 is located 990 ft. from N line and 1650 ft. from E line of sec. 171/4 (1/4 Sec. and Sec. No.) 24 (Twp.) 3 (Range) 11 (Meridian)Blanco (Field) 10 (County subdivision) New Mexico (State or Territory)The elevation of the ~~derrick floor~~ above sea level is 6591.70 ft.

## DETAILS OF WORK

(State names of and expected depths to objective sands; show sizes, weights, and lengths of proposed casings; indicate mudding jobs, cementing points, and all other important proposed work)

Propose to drill to 200'. Set 10-3/4" casing cemented w/125 ex 48 gal. Drill w/water or minimum mud to 3544'. Set 7-5/8" casing cemented w/190 ex and 50 ex neat. Drill to 5927' total depth. Run 5 1/2" casing cemented w/175 ex 24 gal. perf., and sand frac the Menefee, Ft. Lookout, Cliff House, separately each w/40,000 gallons water. w/approx. 1 1/2 ed gallon. Clean well to total depth run tubing and complete well.

320 acres or east half of sec. 17 dedicated to this well.

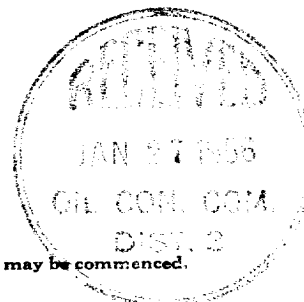

I understand that this plan of work must receive approval in writing by the Geological Survey before operations may be commenced.

Company W. A. JohnstonAddress 4131 East 4th StreetFarlington, New MexicoBy Original signed by T. A. DwyerTitle District Engineer

Company.....PACIFIC NORTHWEST PIPELINE CORPORATION

Lease.....Well No.....

Sec. 17....., T. 29 N....., R. 5 W., N.M.P.M.

Location.....990 FEET FROM THE NORTH LINE AND 1650  
FEET FROM THE EAST LINE.

Elevation.....6591.70 UNGRADED GROUND

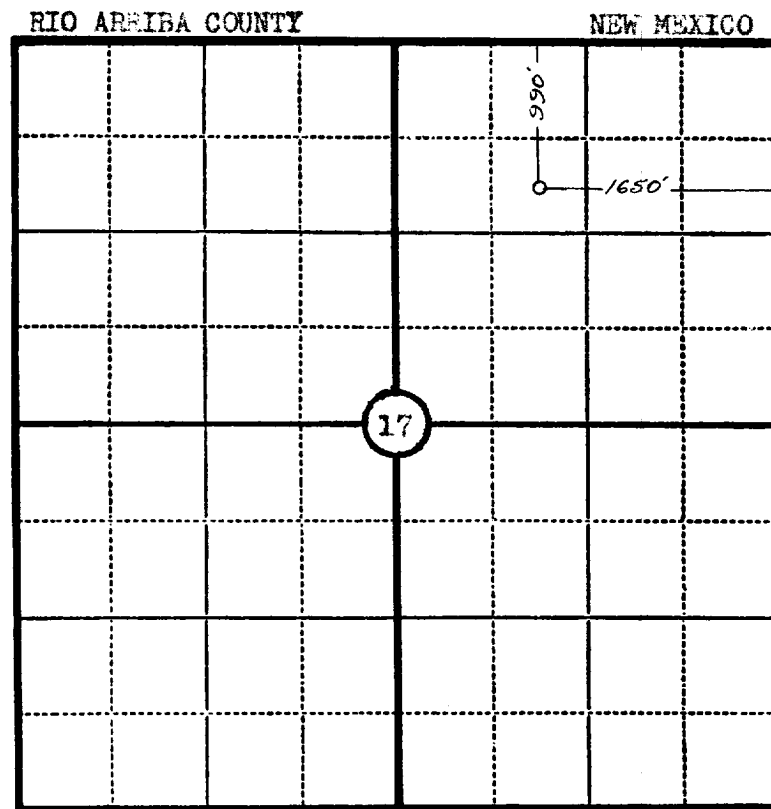

Scale—4 inches equal 1 mile.

This is to certify that the above plat was prepared from field notes of actual surveys made by me or under my supervision and that the same are true and correct to the best of my knowledge and belief.

Seal:

*James P. Leese*

Registered Land Surveyor.

JAMES P. LEESE

N. MEX. REG. NO. 1463

Surveyed.....AUGUST 25....., 1955

SAN JUAN ENGINEERING COMPANY, FARMINGTON, N. M.

