

(SUBMIT IN TRIPLICATE)

UNITED STATES  
DEPARTMENT OF THE INTERIOR  
GEOLOGICAL SURVEY

Land Office Santa Fe

Lease No. 080379

Unit San Juan Unit 29-6  
14-08-001-439

SUNDRY NOTICES AND REPORTS ON WELLS

NOTICE OF INTENTION TO DRILL	<input checked="" type="checkbox"/>	SUBSEQUENT REPORT OF WATER SHUT-OFF	
NOTICE OF INTENTION TO CHANGE PLANS		SUBSEQUENT REPORT OF SHOOTING OR ACIDIZING	
NOTICE OF INTENTION TO TEST WATER SHUT-OFF		SUBSEQUENT REPORT OF ALTERING CASING	
NOTICE OF INTENTION TO RE-DRILL OR REPAIR WELL		SUBSEQUENT REPORT OF RE-DRILLING OR REPAIR	
NOTICE OF INTENTION TO SHOOT OR ACIDIZE		SUBSEQUENT REPORT OF ABANDONMENT	
NOTICE OF INTENTION TO PULL OR ALTER CASING		SUPPLEMENTARY WELL HISTORY	
NOTICE OF INTENTION TO ABANDON WELL			

(INDICATE ABOVE BY CHECK MARK NATURE OF REPORT, NOTICE, OR OTHER DATA)

5-21, 1955

San Juan Unit 29-6 1660  
Well No. ~~Mon 20-8~~ located ~~450~~ ft. from N line and 1850 ft. from E line of sec. 8  
S line and W line of sec. 8

Sec. 8 (Sec. and Sec. No.) 29N (Twp.) 6W (Range) R.M.P.M. (Meridian)

Blanco (Field) Rio Arriba (County or Subdivision) New Mexico (State or Territory)

The elevation of the ~~datum~~ magrated ground above sea level is 6761.91 ft.

DETAILS OF WORK

(State names of and expected depths to objective sands; show sizes, weights, and lengths of proposed casings; indicate mudding jobs, cementing points, and all other important proposed work)

**Proposed:** Drill 15" hole to 200', set 10-3/4" csg. at that point and cement with 150 sacks 45 gal. cement. Drill with mud to approximately 3450', set 7" csg. and cement with 200 sacks 45 gal. cement. Drill Mon Verde Fm. with gas to approximately 6100', sand free Cliff House and Point Look-out section separately with 18,000 gal. treatments, clean out open hole, run tlg. and complete well.

The entire West half of Sec. 8 T29N6W is committed to Unit 29-6 Mon 20-8.

I understand that this plan of work must receive approval in writing by the Geological Survey before operations may be commenced.

Company PACIFIC NORTHWEST PIPELINE CORPORATION

Address 413-1/2 West Main  
Farmington, New Mexico

By L. H. Rye  
Title Engineer

Company PACIFIC NORTHWEST PIPELINE CORPORATION

Lease ..... Well No. ....

Sec. 8, T. 29 N., R. 6 W., N.M.P.M.

Location 1660' FROM THE SOUTH LINE AND 1850' FROM THE WEST LINE.

Elevation 6761.91 UNGRADED GROUND.

RECEIVED  
U.S. GEOLOGICAL SURVEY  
FARMINGTON, NEW MEXICO

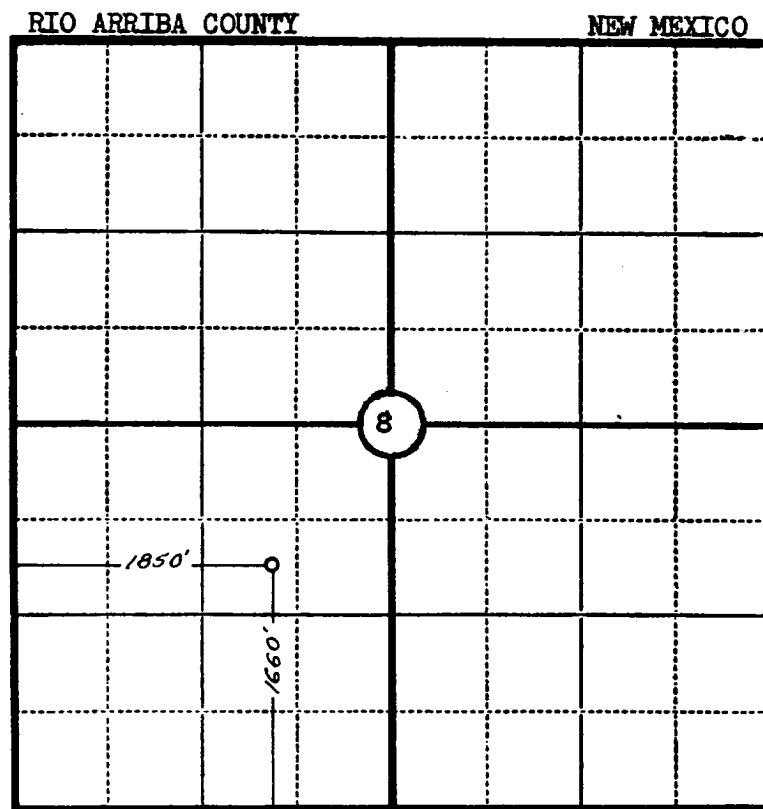

Scale—4 inches equal 1 mile.

This is to certify that the above plat was prepared from field notes of actual surveys made by me or under my supervision and that the same are true and correct to the best of my knowledge and belief.

Seal:

*James P. Leese*

Registered Land Surveyor.

JAMES P. LEESE  
N. MEX. REG. NO. 1463

Surveyed ..... 28 MAY 1955

SAN JUAN ENGINEERING CO.  
P. O. Box 752  
FARMINGTON, N. M.