

NOTICE OF INTENTION TO DRILL

Sept. 1, 1954

Date _____

in. ~~REDACTED~~

Lease

N

(E.) ~~Section~~ line of the above section.

(Give location from section lines. Cross out wrong directions.)

If state land the oil and gas lease is No. 67056 Assignment No. _____

If patented land the owner is.....

Address

If government land the permittee is.....

Address

The lessee is.....

Address

We propose to drill well with drilling equipment as follows: Drill W/rotary to casing at top of Mesa Verde, then drill W/gas to approx. 5950'.

The status of a bond for this well in conformance with Rule 101 of the General Rules and Regulations of the Commission is as follows: Not Bonded

We propose to use the following strings of casing and to land or cement them as indicated:

Size of Hole	Size of Casing	Weight Per Foot	New or Second Hand	Depth	Landed or Cemented	Sacks Cement
	10-3/4	32.75	New	175'	Cemented	200 SX
8-3/4	7"	20 & 23#	New	5350	Cemented	400 SX

If changes in the above plans become advisable we will notify you before cementing or landing casing. We estimate that the first productive oil or gas sand should occur at a depth of about 5350 feet.

Additional information: **Propose to sand frac Cliffhouse section with 15,000 gal. of diesel & 1 lb. sand per gal. Drill through Point Lookout and sand frac this section with 15,000 gal. of diesel w/ 1 lb. sand per gal., run 2-3/8" O. D. tbg. and shut in for test.**
E/2 Sec 2, 29N, 6W Rm 4116. Dedicated to this well.

Approved.

except as follows:

OIL CONSERVATION COMMISSION.

By Ernest K. Kumpf
Title Oil and Gas Inspector Dist. #3.

Phillips Pet. Co.
Company or Operator

Bv.

Page 1 of 1

Position.

Dist. Supt.

Send communications regarding well to:

Name.....**Earl Starn**

Address..... **P. O. Box 929**

Artec, New Mexico



Company PHILLIPS PETROLEUM COMPANY

Lease Well No.

Sec. 2, T. 29 N, R. 6 W, N.M.P.M.

Location 990' from the North line and 1850' from the East line.

Elevation 6443 Ungraded ground.

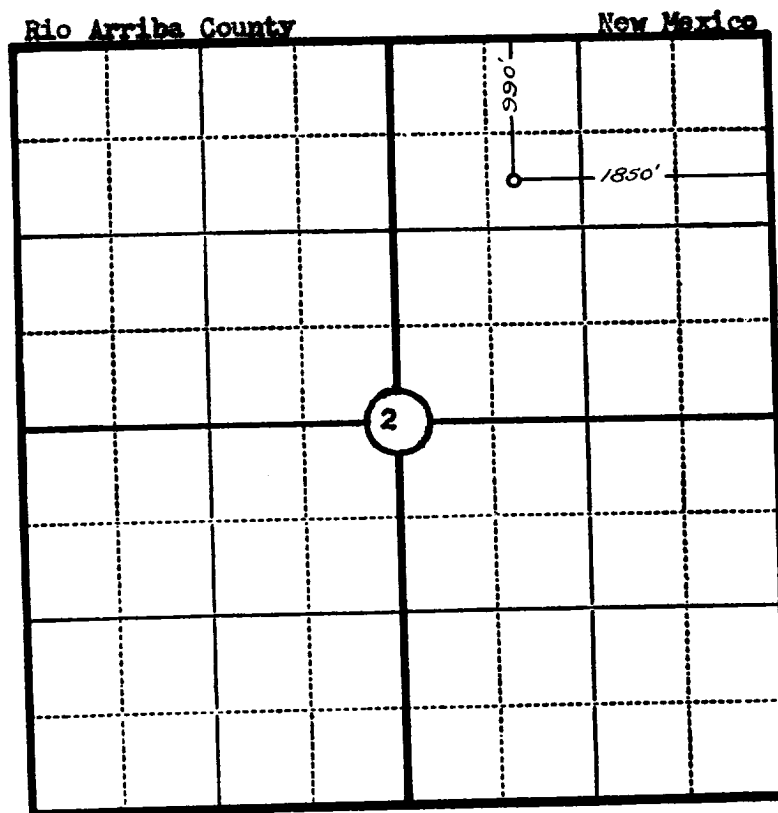

Scale—4 inches equal 1 mile.

This is to certify that the above plat was prepared from field notes of actual surveys made by me or under my supervision and that the same are true and correct to the best of my knowledge and belief.

Seal:

James P. Leese
Registered Professional
Engineer and Land Surveyor.

James P. Leese
N. Mex. Reg. No. 1463



Surveyed 27 August, 19 54

OIL CONSERVATION COMMISSION		
AZTEC DISTRICT OFFICE		
No. Copies Received <i>4</i>		
DISTRIBUTION		
	NO. FURNISHED	
Operator	<i>1</i>	
Santa Fe	<i>1</i>	
Proration Office		
State Land Office	<i>1</i>	
U. S. G. S.	<i>2</i>	
Transporter		
File	<i>1</i>	<i>✓</i>