

UNITED STATES  
DEPARTMENT OF THE INTERIOR  
GEOLOGICAL SURVEY

30-039-21086

5. LEASE DESIGNATION AND SERIAL NO.

NM 03040=A

6. IF INDIAN, ALLOTTEE OR TRIBE NAME

7. UNIT AGREEMENT NAME

San Juan 29-6 Unit

8. FARM OR LEASE NAME

San Juan 29-6 Unit

9. WELL NO.

53 A

10. FIELD AND POOL, OR WILDCAT

Blanco Mesa Verde

11. SEC., T., R., M., OR BLK.  
AND SURVEY OR AREA

Sec 31, T29N, R6W NMPM

12. COUNTY OR PARISH

13. STATE

Rio Arriba

New Mexico

## APPLICATION FOR PERMIT TO DRILL, DEEPEN, OR PLUG BACK

1a. TYPE OF WORK

DRILL ☒DEEPEN ☐PLUG BACK ☐

b. TYPE OF WELL

OIL  
WELL ☐GAS  
WELL ☒

OTHER

SINGLE  
ZONE ☒MULTIPLE  
ZONE ☐

2. NAME OF OPERATOR

Northwest Pipeline Corporation

3. ADDRESS OF OPERATOR

P.O. Box 90 Farmington, New Mexico 87401

4. LOCATION OF WELL (Report location clearly and in accordance with any State requirements.)\*

At surface

800' FSL &amp; 1570' FEL

At proposed prod. zone

14. DISTANCE IN MILES AND DIRECTION FROM NEAREST TOWN OR POST OFFICE\*

20 miles east Blanco, New Mexico

15. DISTANCE FROM PROPOSED\*

LOCATION TO NEAREST  
PROPERTY OR LEASE LINE, FT.  
(Also to nearest drg. unit line, if any)

16. NO. OF ACRES IN LEASE

17. NO. OF ACRES ASSIGNED  
TO THIS WELL

320

18. DISTANCE FROM PROPOSED LOCATION\*  
TO NEAREST WELL, DRILLING, COMPLETED,  
OR APPLIED FOR, ON THIS LEASE, FT.

19. PROPOSED DEPTH

6080

20. ROTARY OR CABLE TOOLS

Rotary

21. ELEVATIONS (Show whether DF, RT, GR, etc.)

6805' GR

22. APPROX. DATE WORK WILL START\*

23.

## PROPOSED CASING AND CEMENTING PROGRAM

SIZE OF HOLE	SIZE OF CASING	WEIGHT PER FOOT	SETTING DEPTH	QUANTITY OF CEMENT
13-3/4	9-5/8	32.3	200'	180 sx circ.
8-3/4	7	20	3990'	165 sx
6-1/4	4-1/2" liner	10.5	6080'	215 sx

Selectively perforate and stimulate the Mesa Verde formation.

A BOP will be installed after the surface casing is set and cemented.  
All subsequent work will be conducted through the BOP.

The E/2 of Section 31 is dedicated to this well.

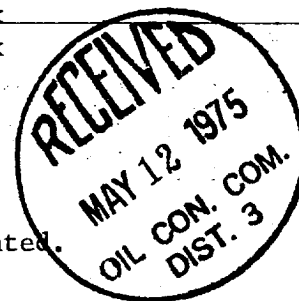

IN ABOVE SPACE DESCRIBE PROPOSED PROGRAM: If proposal is to deepen or plug back, give data on present productive zone and proposed new productive zone. If proposal is to drill or deepen directionally, give pertinent data on subsurface locations and measured and true vertical depths. Give blowout preventer program, if any.

24.

SIGNED

  
O.B. Whitenburg

TITLE

Sr. Drilling Engineer

DATE

5-7-75

(This space for Federal or State office use)

PERMIT NO.

APPROVAL DATE

APPROVED BY

TITLE

DATE

CONDITIONS OF APPROVAL, IF ANY:

**NEW MEXICO OIL CONSERVATION COMMISSION  
WELL LOCATION AND ACREAGE DEDICATION PLAT**

Form C-102  
Supersedes C-128  
Effective 1-1-65

All distances must be from the outer boundaries of the Section.

Operator <b>Northwest Pipeline Corporation</b>			Lease <b>San Juan 29-6 Unit</b>		Well No. <b>53A</b>
Unit Letter <b>0</b>	Section <b>31</b>	Township <b>29N</b>	Range <b>6W</b>	County <b>Rio Arriba</b>	
Actual Footage Location of Well:					
<b>800</b> feet from the <b>South</b> line and		<b>1570</b> feet from the <b>East</b> line			
Ground Level Elev. <b>6805</b>	Producing Formation <b>Mesa Verde</b>	Pool <b>Blanco Mesa Verde</b>		Dedicated Acreage: <b>320</b>	Actual Acreage:

1. Outline the acreage dedicated to the subject well by colored pencil or hachure marks on the plat below.
2. If more than one lease is dedicated to the well, outline each and identify the ownership thereof (as to working interest and royalty).
3. If more than one lease of different ownership is dedicated to the well, have the interests been consolidated by communitization, unitization, force-pooling, etc?

☐ Yes    ☒ No    If answer is "yes," type of consolidation \_\_\_\_\_

If answer is "no," list the owners and tract descriptions which have actually been consolidated. (Use reverse side of this form if necessary.) SW/4, SE/4 Sec 31, T29N, R6W

No allowable will be assigned to the well until all interests have been consolidated (by communitization, unitization, forced-pooling, or otherwise) or until a non-standard unit, eliminating such interests, has been approved by the Commission.

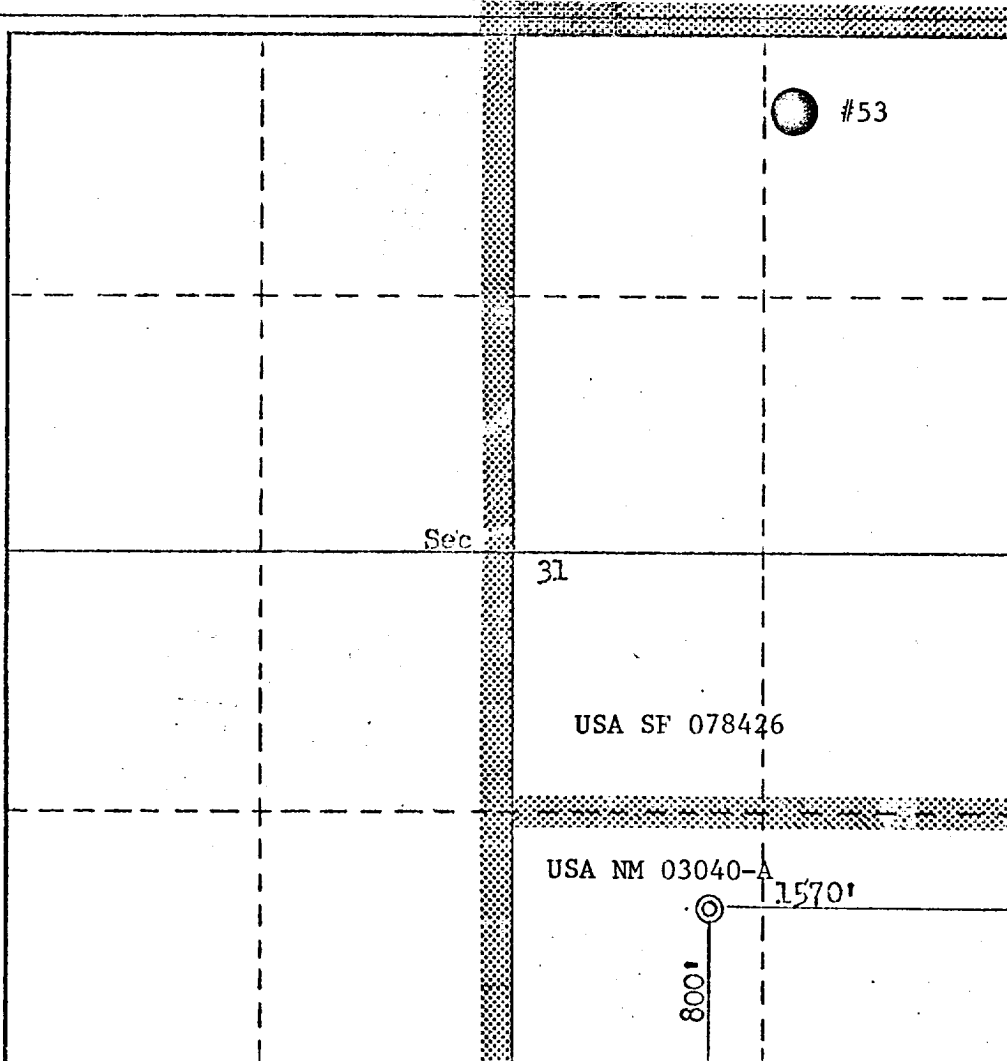
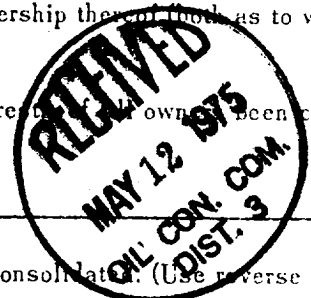

**CERTIFICATION**

I hereby certify that the information contained herein is true and complete to the best of my knowledge and belief.

*O.B. Whitenburg*  
Name  
**O.B. Whitenburg** js

Position  
**Sr. Drilling Engineer**

Company  
**Northwest Pipeline Corp.**

Date  
**May 7, 1975**

I hereby certify that the well location shown on this plat was plotted from field notes of actual surveys made by me or under my supervision, and that the same is true and correct to the best of my knowledge and belief.

Date Surveyed  
**April 18, 1975**

Registered Professional Engineer and/or Land Surveyor

*Fred B. Kerr*  
**Fred B. Kerr**

Certificate No.

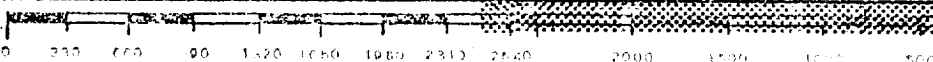

San Juan 29-6 Unit #53A

COULD PASS QUADRANGLE  
NEW MEXICO  
15 MINUTE SERIES (TOPOGRAPHIC)

IGOME 125

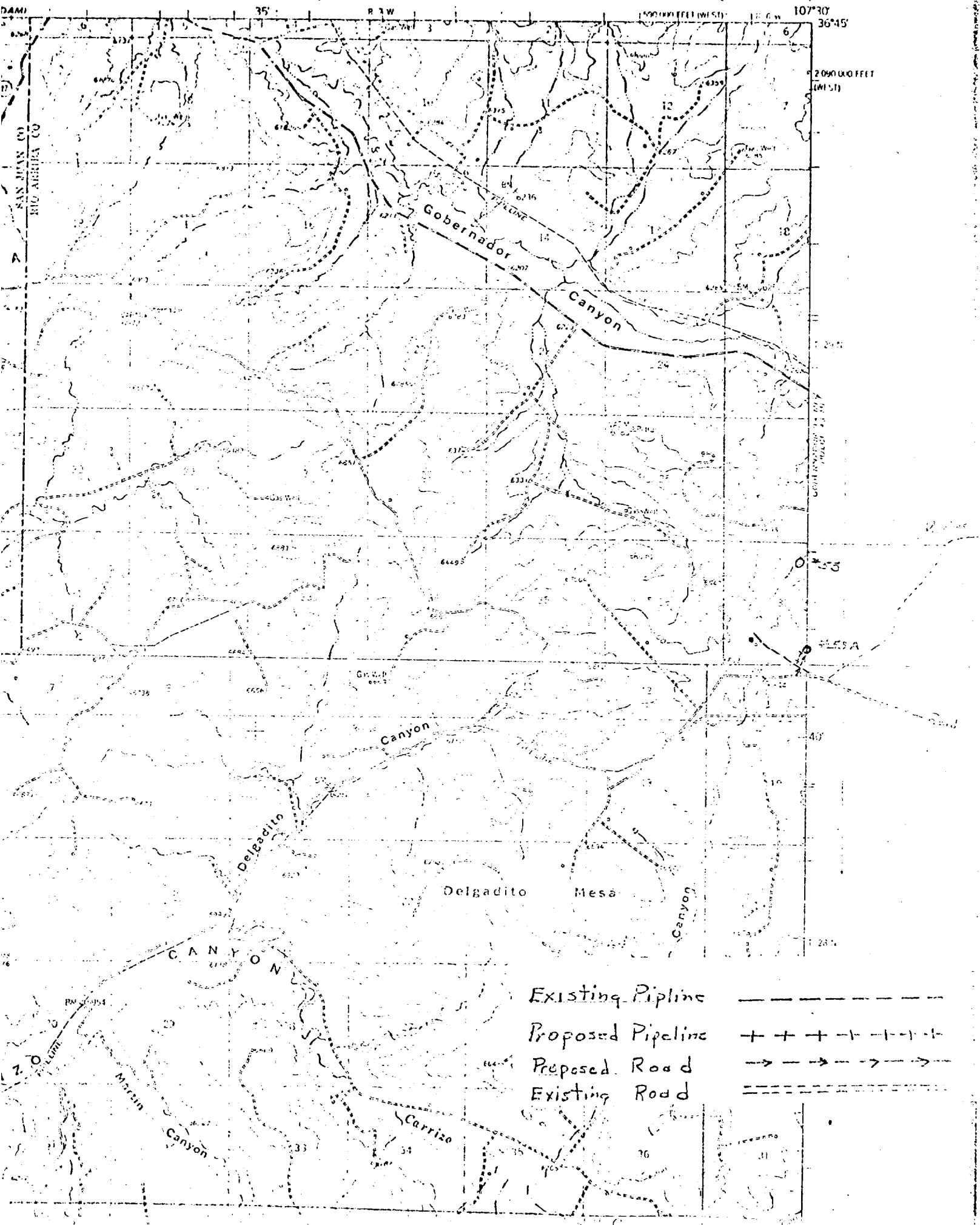

Northwest Pipeline Corporation



PRODUCTION & DRILLING  
P.O. BOX 90  
FARMINGTON, NEW MEXICO 87401

May 7, 1975

United States Geological Survey  
P.O. Box 1809  
Durango, Colorado 81301

Re: Application for "Permit to Drill"  
San Juan 29-6 Unit #53A  
SE/4 Sec 31, T29N, R6W  
Rio Arriba County, New Mexico

Gentlemen:

Information regarding existing roads, pipelines, flowlines, etc., relative to the above well location are included on the enclosed attachments.

Water for drilling and completion operations will be obtained from the San Juan 29-6 Water Well #1 located in the NW/4 SW/4 Sec 28, T29N, R6W.

Waste disposal will be in the burn pit, latrine or reserve pit. There will be no camp or airstrip associated with drilling this well. Upon completion or abandonment of this well the location will be cleaned, leveled and a dry hole marker placed if applicable.

Sincerely,

  
O.B. Whitenburg

Northwest Pipeline Corporation  
Senior Production & Drilling Engineer

OBW/js

LOCATION AND EQUIPMENT LAYOUT

Sanduan 29-6 Unit #53A

