

NO. OF COPIES RECEIVED	6
DISTRIBUTION	
SANTA FE	1
FILE	1
U.S.G.S.	2
LAND OFFICE	1
OPERATOR	1

NEW MEXICO OIL CONSERVATION COMMISSION

30-039-2120

Form C-101
Revised 1-1-65

5A. Indicate Type of Lease	
STATE <input checked="" type="checkbox"/>	FEE <input type="checkbox"/>
5. State Oil & Gas Lease No.	
E-289-36	

APPLICATION FOR PERMIT TO DRILL, DEEPEN, OR PLUG BACK

1a. Type of Work		7. Unit Agreement Name	
DRILL <input checked="" type="checkbox"/> DEEPEN <input type="checkbox"/> PLUG BACK <input type="checkbox"/>		San Juan 29-6 Unit	
b. Type of Well		8. Farm or Lease Name	
OIL WELL <input type="checkbox"/> GAS WELL <input checked="" type="checkbox"/> OTHER <input type="checkbox"/> SINGLE ZONE <input checked="" type="checkbox"/> MULTIPLE ZONE <input type="checkbox"/>		San Juan 29-6 Unit	
2. Name of Operator		9. Well No.	
Northwest Pipeline Corporation		15A	
3. Address of Operator		10. Field and Pool, or Wildcat	
P. O. Box 90 Farmington, New Mexico 87401		Blanco Mesa Verde	
4. Location of Well		12. County	
UNIT LETTER C LOCATED 1465 FEET FROM THE West LINE AND 1040 FEET FROM THE North LINE OF SEC. 2 TWP. 29N RGE. 6W NMPM		Rio Arriba	
19. Proposed Depth		19A. Formation	
5880'		Mesa Verde	
20. Rotary or C.T.		Rotary	
21. Elevations (Show whether DF, RT, etc.)		22. Approx. Date Work will start	
6441' GR		November 1, 1975	

23. PROPOSED CASING AND CEMENT PROGRAM

SIZE OF HOLE	SIZE OF CASING	WEIGHT PER FOOT	SETTING DEPTH	SACKS OF CEMENT	EST. TOP
13-3/4	9-5/8	36	200	180	Circ.
8-3/4	7	20	3750	165	2200
6-1/4	4-1/2 liner	10.5	5880	215	3600
					circ. liner

Selectively perforate and stimulate the Mesa Verde formation.

A BOP will be installed when the 9-5/8" surface casing is run and cemented.
All subsequent work will be conducted through the BOP.

The west half of section 2 is dedicated to this well.

APPROVAL VALID
FOR 90 DAYS AFTER
DRILLING COMMENCED,

EXPIRES 11-3-75

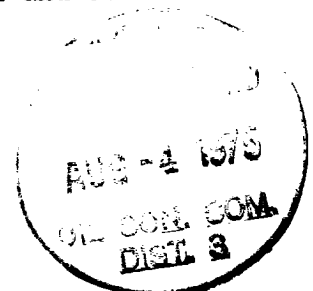

IN ABOVE SPACE DESCRIBE PROPOSED PROGRAM: IF PROPOSAL IS TO DEEPEN OR PLUG BACK, GIVE DATA ON PRESENT PRODUCTIVE ZONE AND PROPOSED NEW PRODUCTIVE ZONE. GIVE BLOWOUT PREVENTER PROGRAM, IF ANY.

I hereby certify that the information above is true and complete to the best of my knowledge and belief.

Signed O. B. Whitenburg Title Sr. Prod. & Drlg. Engr. Date July 25, 1975
(This space for State Use)

APPROVED BY AK Lendrick TITLE PETROLEUM ENGINEER DIST. NO. 3 DATE AUG 4 1975
CONDITIONS OF APPROVAL, IF ANY:

NEW MEXICO OIL CONSERVATION COMMISSION WELL LOCATION AND ACREAGE DEDICATION PLAT

Form C-102
Supersedes C-128
Effective 1-1-65

All distances must be from the outer boundaries of the Section.

Operator Northwest Pipeline Corporation			Lease San Juan 29-6 Unit		Well No. 15A
Unit Letter C	Section 2	Township 29N	Range 6W	County Rio Arriba	
Actual Footage Location of Well:					
1010 feet from the North		line and 1165 feet from the West		line	
Ground Level Elev. 6111	Producing Formation Mesa Verde	Pool Blanco Mesa Verde		Dedicated Acreage: 319.13 Acres	

- Outline the acreage dedicated to the subject well by colored pencil or hatchure marks on the plat below.
- If more than one lease is dedicated to the well, outline each and identify the ownership thereof (both as to working interest and royalty).
- If more than one lease of different ownership is dedicated to the well, have the interests of all owners been consolidated by communitization, unitization, force-pooling, etc?

☐ Yes ☒ No If answer is "yes," type of consolidation _____

If answer is "no," list the owners and tract descriptions which have actually been consolidated. (Use reverse side of this form if necessary.) NE/4 NW/4 Section 2, T29N, R6W

No allowable will be assigned to the well until all interests have been consolidated (by communitization, unitization, forced-pooling, or otherwise) or until a non-standard unit, eliminating such interests, has been approved by the Commission.

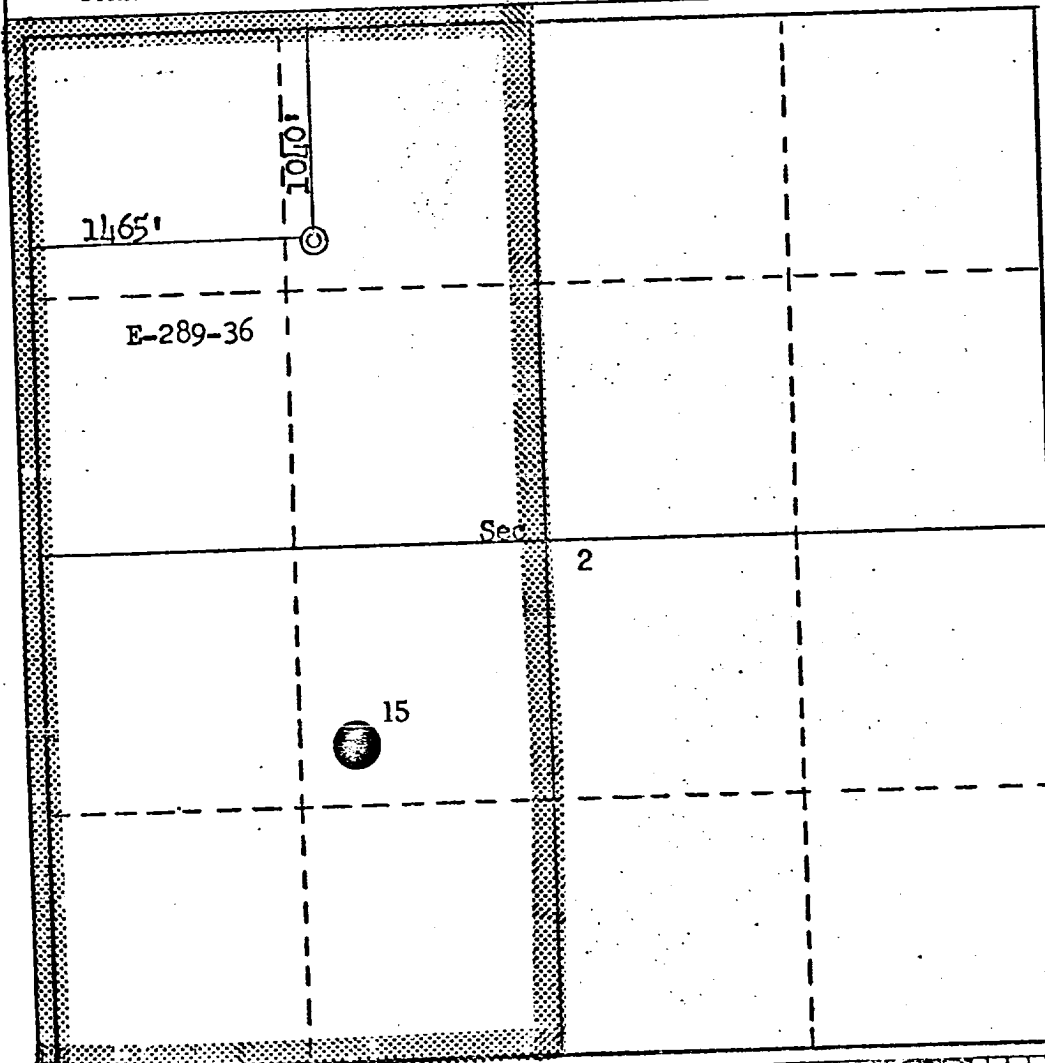

CERTIFICATION

I hereby certify that the information contained herein is true and complete to the best of my knowledge and belief.

O. B. Whitenburg
Name
O. B. Whitenburg
Position
Sr. Prod. & Drlg. Engr.
Company
Northwest Pipeline Corp.
Date
July 25, 1975

I hereby certify that the well location shown on this plat was plotted from field notes of actual surveys made by me or under my supervision, and that the same is true and correct to the best of my knowledge and belief.

Date Surveyed
April 19, 1975
Registered Professional Engineer and/or Land Surveyor
Fred B. Kepp
Fred B. Kepp
Certificate No.