

UNITED STATES
DEPARTMENT OF THE INTERIORGEOLOGICAL SURVEY *API 30-039 - 21252*

APPLICATION FOR PERMIT TO DRILL, DEEPEN, OR PLUG BACK

1a. TYPE OF WORK

DRILL ☒DEEPEN ☐PLUG BACK ☐

b. TYPE OF WELL

OIL
WELL ☐GAS
WELL ☒

OTHER

SINGLE
ZONE ☒MULTIPLE
ZONE ☐

2. NAME OF OPERATOR

Northwest Pipeline Corporation

3. ADDRESS OF OPERATOR

P.O. Box 90, Farmington, New Mexico 87401

4. LOCATION OF WELL (Report location clearly and in accordance with any State requirements.*)

At surface

1165' FSL & 1775' FEL

At proposed prod. zone

As above

14. DISTANCE IN MILES AND DIRECTION FROM NEAREST TOWN OR POST OFFICE*

15. DISTANCE FROM PROPOSED*

LOCATION TO NEAREST
PROPERTY OR LEASE LINE, FT.
(Also to nearest drlg. unit line, if any)18. DISTANCE FROM PROPOSED LOCATION*
TO NEAREST WELL, DRILLING, COMPLETED,
OR APPLIED FOR, ON THIS LEASE, FT.

21. ELEVATIONS (Show whether DF, RT, GR, etc.)

6315' GR

23.

PROPOSED CASING AND CEMENTING PROGRAM

SIZE OF HOLE	SIZE OF CASING	WEIGHT PER FOOT	SETTING DEPTH	QUANTITY OF CEMENT
13 3/4"	9 5/8"	36	200'	180 sxs
8 3/4"	7"	20	3584'	160 sxs
6 1/4"	4 1/2" Liner	10.5	3434'-5646'	215 sxs

Selectively perforate and stimulate the Mesa Verde formation.

A BOP will be installed after the 9 5/8" surface casing has been run and cemented.
All subsequent work will be conducted through the BOP.

The E/2 of Section 21 is dedicated to this well.

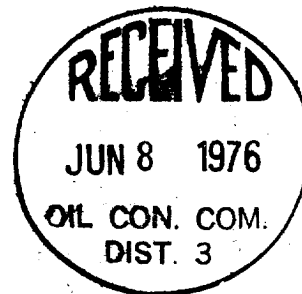

Gas is dedicated

IN ABOVE SPACE DESCRIBE PROPOSED PROGRAM: If proposal is to deepen or plug back, give data on present productive zone and proposed new productive zone. If proposal is to drill or deepen directionally, give pertinent data on subsurface locations and measured and true vertical depths. Give blowout preventer program, if any.

24.

SIGNED

D. H. Maroncelli

TITLE

Production Engineer

DATE June 1, 1976

(This space for Federal or State office use)

PERMIT NO.

APPROVAL DATE

APPROVED BY

TITLE

DATE

CONDITIONS OF APPROVAL, IF ANY:

Okaf

*See Instructions On Reverse Side

**NEW MEXICO OIL CONSERVATION COMMISSION
WELL LOCATION AND ACREAGE DEDICATION PLAT**

Form C-102
Supersedes C-128
Effective 1-1-65

All distances must be from the outer boundaries of the Section.

Operator Northwest Pipeline Corporation			Lease San Juan 29-6 Unit		Well No. 24A
Unit Letter 0	Section 21	Township 29N	Range 6W	County Rio Arriba	
Actual Footage Location of Well:					
1165 feet from the South line and		1775 feet from the East line			
Ground Level Elev. 6315	Producing Formation Mesa Verde	Pool Blanco	Dedicated Acreage: 320 Acres		

1. Outline the acreage dedicated to the subject well by colored pencil or hachure marks on the plat below.
2. If more than one lease is dedicated to the well, outline each and identify the ownership thereof (both as to working interest and royalty).
3. If more than one lease of different ownership is dedicated to the well, have the interests of all owners been consolidated by communitization, unitization, force-pooling, etc?

☐ Yes ☐ No If answer is "yes," type of consolidation _____

If answer is "no," list the owners and tract descriptions which have actually been consolidated. (Use reverse side of this form if necessary.) _____

No allowable will be assigned to the well until all interests have been consolidated (by communitization, unitization, forced-pooling, or otherwise) or until a non-standard unit, eliminating such interests, has been approved by the Commission.

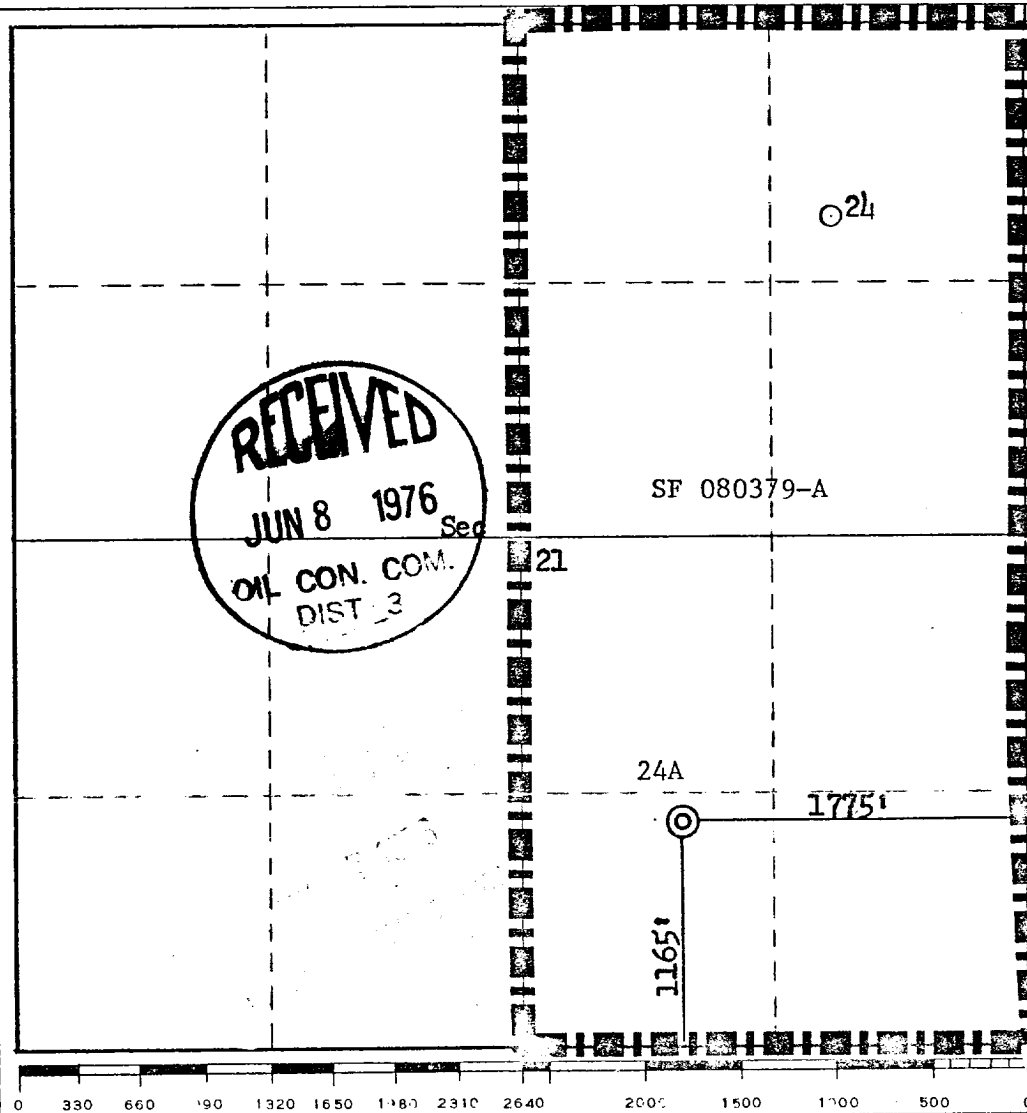

CERTIFICATION

I hereby certify that the information contained herein is true and complete to the best of my knowledge and belief.

D.H. Maroncelli
Name

D.H. Maroncelli
Position

Production Engineer
Company

Northwest Pipeline Corp.
Date

May 17, 1976

I hereby certify that the well location shown on this plat was plotted from field notes of actual surveys made by me or under my supervision, and that the same is true and correct to the best of my knowledge and belief.

Date Surveyed

May 13, 1976

Registered Professional Engineer
and/or Land Survey

Fred B. Kerr, Jr.
Certificate No.

3950

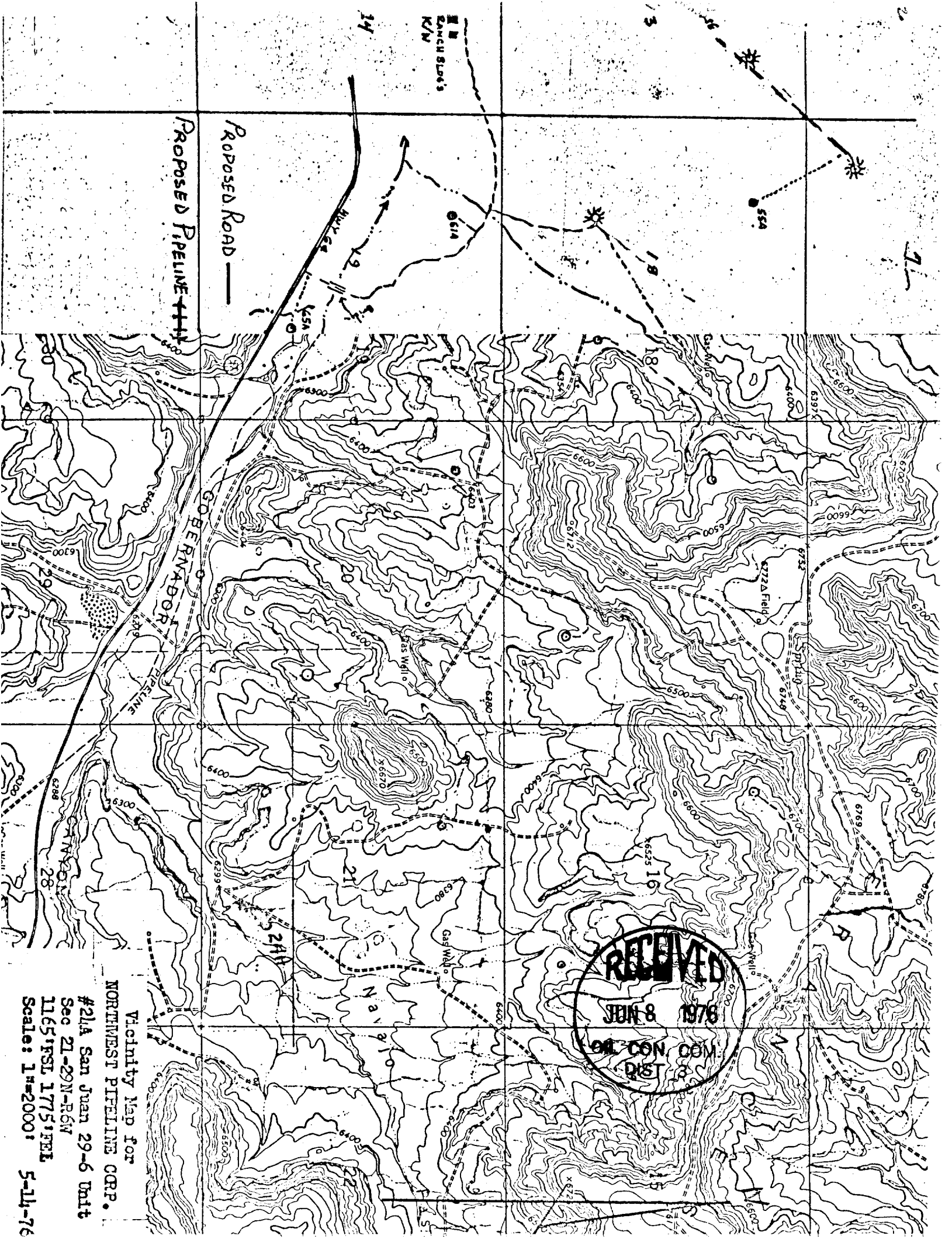

Proposed Road —

Proposed Pipeline + + + +

Vacinity Map for
NORTHWEST PIPELINE CORP.

#21A San Juan 29-6 Unit
Sec 21-29N-R6W
1165'FSL 1775'FEL
Scale: 1"=2000' 5-14-76

RECEIVED
JUN 8 1978
94 CON COM
DIST 3

LOCATION AND EQUIPMENT LAYOUT

SAN JUAN 29-6 UNIT #24A

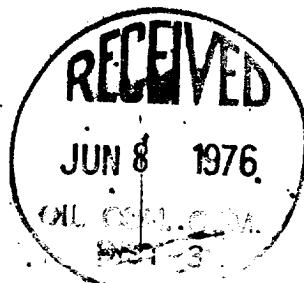
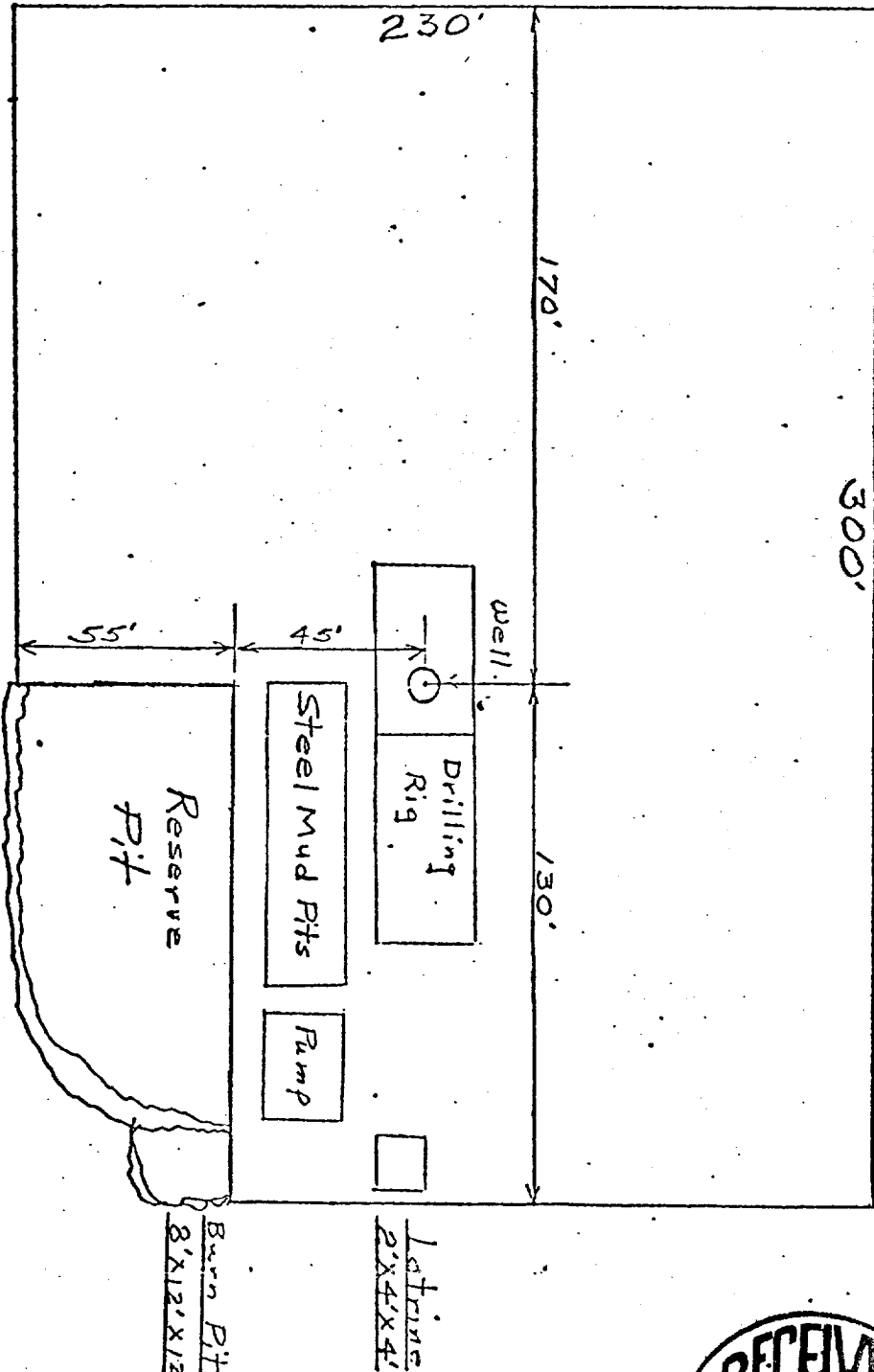

Northwest Pipeline Corporation



PRODUCTION & DRILLING
P. O. BOX 90
FARMINGTON, NEW MEXICO 87401
5113-26-76

June 1, 1976

United States Geological Survey
P.O. Box 1809
Durango, Colorado 81301

Re: Application for "Permit to Drill"
San Juan 29-6 Unit #24A
SE/4 Sec. 21, T29N, R6W
Rio Arriba County, New Mexico

Gentlemen:

Information regarding existing roads, pipelines, flowlines, etc., relative to the above well location are included on the enclosed attachments.

Water for drilling and completion operations will be obtained from the San Juan 29-6 Water Well #1, located in the NW/4 SW/4 Sec. 28, T29N, R6W.

Waste disposal will be in the burn pit, toilet, or reserve pit. There will be no camp or airstrip associated with drilling this well. Upon completion or abandonment of this well the location will be cleaned, leveled, and a dry hole marker placed if applicable.

Sincerely,

D. H. Maroncelli
Production Engineer
Northwest Pipeline Corporation

DH:rn

