

UNITED STATES  
DEPARTMENT OF THE INTERIOR  
GEOLOGICAL SURVEY

FOURTH EDITION

30-089-21412  
5. LEASE DENIMINATION AND SERIAL NO.

SF 078284

6. IF INDIAN, ALLOTTEE OR TRIBE NAME

APPLICATION FOR PERMIT TO DRILL, DEEPEN, OR PLUG BACK

1a. TYPE OF WORK

DRILL ☒

DEEPEN ☐

PLUG BACK ☐

b. TYPE OF WELL

OIL WELL ☐

GAS WELL ☒

OTHER

SINGLE ZONE ☐

MULTIPLE ZONE ☐

2. NAME OF OPERATOR

Northwest Pipeline Corporation

3. ADDRESS OF OPERATOR

P.O. Box 90, Farmington, New Mexico 87401

4. LOCATION OF WELL (Report location clearly and in accordance with any State requirement(s.))

At surface

C 1180' FNL & 1650' FWL

At proposed prod. zone

As above

14. DISTANCE IN MILES AND DIRECTION FROM NEAREST TOWN OR POST OFFICE\*

7. UNIT AGREEMENT NAME

San Juan 29-6 Unit

8. FARM OR LEASE NAME

San Juan 29-6 Unit

9. WELL NO.

27A

10. FIELD AND FOOT, OR WILDCAT

Blanco Mesa Verde

11. SEC., T., R., M., OR BLK. AND SURVEY OR AREA

Sec. 23, T29N, R6W

12. COUNTY OR PARISH 13. STATE

Rio Arriba

N.M.

15. DISTANCE FROM PROPOSED\*

LOCATION TO NEAREST PROPERTY OR LEASE LINE, FT. (Also to nearest drlg. unit line, if any)

1180'

16. NO. OF ACRES IN LEASE

17. NO. OF ACRES ASSIGNED TO THIS WELL

320

18. DISTANCE FROM PROPOSED LOCATION\*

TO NEAREST WELL, DRILLING COMPLETED, OR APPLIED FOR, ON THIS LEASE, FT.

1/2 Mile

19. PROPOSED DEPTH

5746'

20. ROTARY OR CABLE TOOLS

Rotary

21. ELEVATIONS (Show whether DF, RT, GR, etc.)

6448' GR

22. APPROX. DATE WORK WILL START\*

March 20, 1977

23.

PROPOSED CASING AND CEMENTING PROGRAM

SIZE OF HOLE	SIZE OF CASING	WEIGHT PER FOOT	SETTING DEPTH	QUANTITY OF CEMENT
12 1/4"	9 5/8"	36	200'	115 SXS.
8 3/4"	7"	20	3750'	150 SXS.
6 1/4"	4 1/2" Liner	10.5	3600' - T.D.	210 SXS.

Selectively perforate and stimulate the Mesa Verde formation.

A BOP will be installed after the 9 5/8" surface casing has been run and cemented. All subsequent work will be conducted through the BOP.

The W/2 of Section 23 is dedicated to this well.

Gas is dedicated.

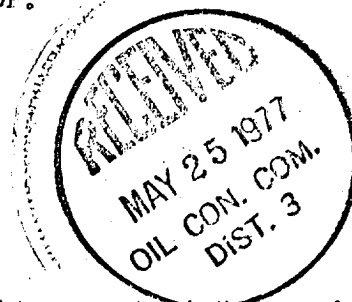

IN ABOVE SPACE DESCRIBE PROPOSED PROGRAM: If proposal is to deepen or plug back, give data on present productive zone and proposed new productive zone. If proposal is to drill or deepen directionally, give pertinent data on subsurface locations and measured and true vertical depths. Give blowout preventer program, if any.

24.

SIGNED

D. H. Maronecelli

TITLE

Production Engineer

DATE

2/3/77

(This space for Federal or State office use)

PERMIT NO.

APPROVAL DATE

APPROVED BY

TITLE

DATE

CONDITIONS OF APPROVAL, IF ANY:

*Abal*

\*See Instructions On Reverse Side

DHM/ks

## WELL LOCATION AND ACREAGE DEDICATION

SUPER  
Effective 1-1-65

All distances must be from the outer boundaries of the Section.

Operator <b>Northwest Pipeline Corporation</b>			Lease <b>San Juan 29-6 Unit</b>		Well No. <b>27A</b>
Unit Letter <b>C</b>	Section <b>23</b>	Township <b>29N</b>	Range <b>6W</b>	County <b>Rio Arriba</b>	
Actual Footage Location of Well: <b>1180</b> feet from the <b>North</b> line and <b>1650</b> feet from the <b>West</b> line					
Ground Level Elev. <b>6448</b>	Producing Formation <b>Mesa Verde</b>		Pool <b>Blanco</b>	Dedicated Acreage: <b>W/ 320</b> Acres	

1. Outline the acreage dedicated to the subject well by colored pencil or hatchure marks on the plat below.
2. If more than one lease is dedicated to the well, outline each and identify the ownership thereof (both as to working interest and royalty).
3. If more than one lease of different ownership is dedicated to the well, have the interests of all owners been consolidated by communitization, unitization, force-pooling, etc?

☐ Yes ☐ No If answer is "yes," type of consolidation \_\_\_\_\_

If answer is "no," list the owners and tract descriptions which have actually been consolidated. (Use reverse side of this form if necessary.) \_\_\_\_\_

No allowable will be assigned to the well until all interests have been consolidated (by communitization, unitization, forced-pooling, or otherwise) or until a non-standard unit, eliminating such interests, has been approved by the Commission.

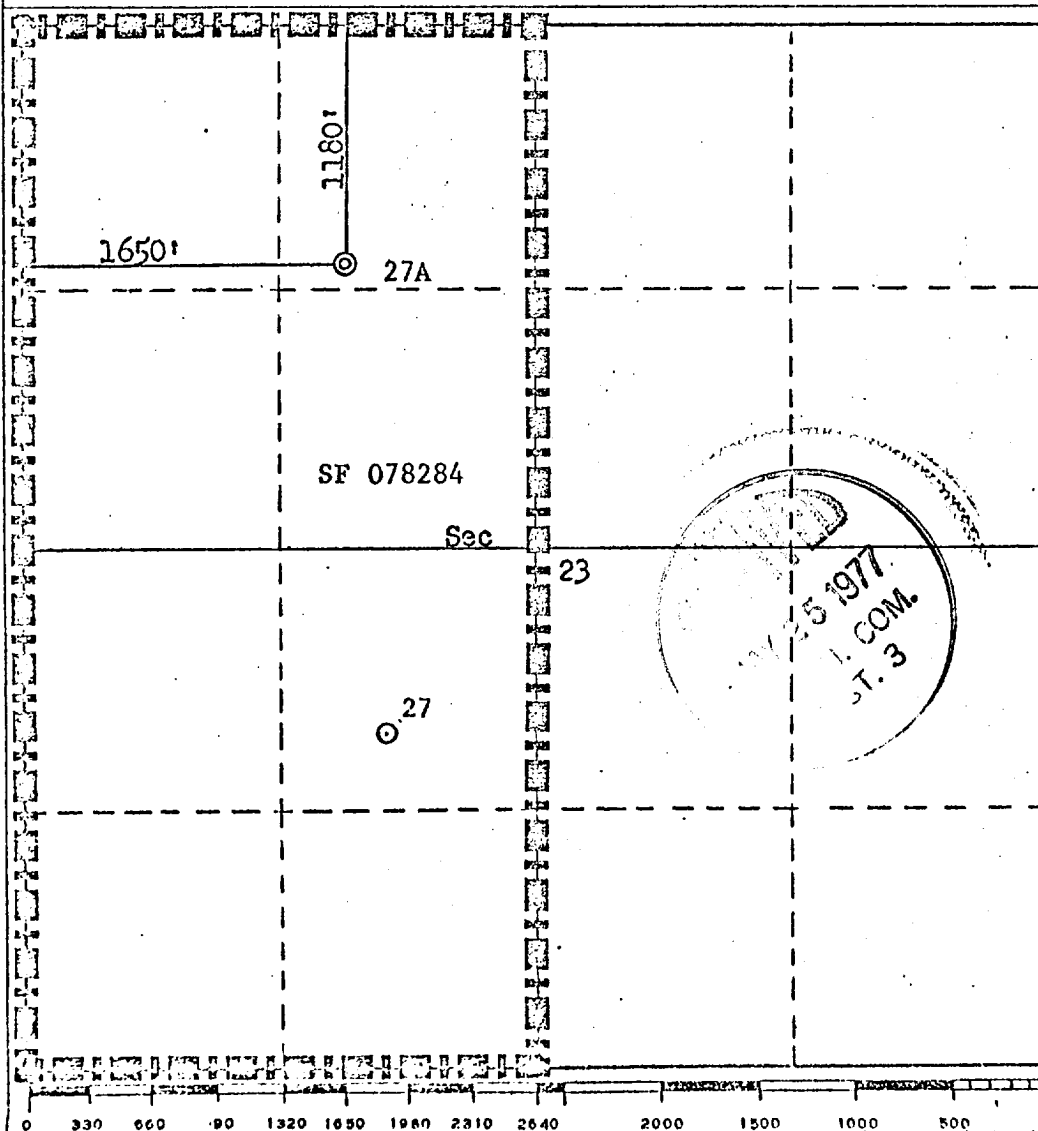

## CERTIFICATION

I hereby certify that the information contained herein is true and complete to the best of my knowledge and belief.

*D. H. Maroncelli*

Name

D.H. Maroncelli

Position

Production Engineer

Company

Northwest Pipeline Corp.

Date

January 31, 1977

I hereby certify that the well location shown on this plat was plotted from field notes of actual surveys made by me or under my supervision, and that the same is true and correct to the best of my knowledge and belief.

Date Surveyed

January 28, 1977

Registered Professional Engineer  
and/or Land Surveyor*Fred B. Kerr Jr.*  
Fred B. Kerr Jr.

Certificate No.

3950