

Submit to Appropriate
District Office
State Lease - 6 copies
Fee Lease - 5 copies

State of New Mexico
Energy, Minerals and Natural Resources Department

Form C-101
Revised 1-1-89

DISTRICT I
P.O. Box 1980, Hobbs, NM 88240

DISTRICT II
P.O. Drawer DD, Artesia, NM 88210

DISTRICT III
1000 Rio Brazos Rd., Aztec, NM 87410

OIL CONSERVATION DIVISION

P.O. Box 2088
Santa Fe, New Mexico 87504-2088

API NO. (assigned by OCD on New Wells) <u>30-039-24609</u>	
5. Indicate Type of Lease STATE <input type="checkbox"/> FEE <input checked="" type="checkbox"/>	
6. State Oil & Gas Lease No.	

APPLICATION FOR PERMIT TO DRILL, DEEPEN, OR PLUG BACK					
1a. Type of Work: DRILL <input checked="" type="checkbox"/> RE-ENTER <input type="checkbox"/> DEEPEN <input type="checkbox"/> PLUG BACK <input type="checkbox"/>				7. Lease Name or Unit Agreement Name	
b. Type of Well: OIL WELL <input type="checkbox"/> GAS WELL <input checked="" type="checkbox"/> OTHER <input type="checkbox"/>				San Juan 29-6 Unit	
2. Name of Operator Northwest Pipeline Corporation				8. Well No. 230	
3. Address of Operator 3539 East 30th St., Farmington, NM 87401				9. Pool name or Wildcat Basin Fruitland Coal Gas	
4. Well Location Unit Letter <u>A</u> : <u>855</u> Feet From The <u>North</u> Line and <u>1230</u> Feet From The <u>East</u> Line Section <u>35</u> Township <u>29N</u> Range <u>6W</u> NMPM Rio Arriba County					
10. Proposed Depth 3425' (+)		11. Formation Fruitland		12. Rotary or C.T. Rotary	
13. Elevations (Show whether DF, RT, GR, etc.) 6366' (GL Unprepared)		14. Kind & Status Plug. Bond Blanket		15. Drilling Contractor Advise Later	
16. Approx. Date Work will start Upon Approval					
17. PROPOSED CASING AND CEMENT PROGRAM <u>E/320</u>					
SIZE OF HOLE	SIZE OF CASING	WEIGHT PER FOOT	SETTING DEPTH	SACKS OF CEMENT	EST. TOP
12 1/4"	9-5/8"	36# K-55 ST&C	250'	150 Sxs	Circ to Surface
8 1/2"	7"	23# K-55 LT&C	3100'	380 Sxs	Circ to Surface
* 6-1/8"	5 1/2" Liner	15.5# or 23#	3425'		Top of Liner

*If the coal is cleated a 5 1/2", 23#, P-110 liner will be run in the opened hole without being cemented.

*If the coal is not cleated a 5 1/2", 15.5#, J-55 liner will be run cemented w/85 Sxs and the well will be fractured.

APPROVAL EXPIRES 6-16-90
UNLESS DRILLING IS COMMENCED.
SPUD DATE MUST BE SUBMITTED
WITHIN 10 DAYS.

RECEIVED
JAN 16 1990
OIL CON. DIV.
DIST. 3

Use mud additives as required for control.

BOP EQUIP: (See attached schematic - Fig. 7-9 or 7-10)

IN ABOVE SPACE DESCRIBE PROPOSED PROGRAM: IF PROPOSAL IS TO DEEPEN OR PLUG BACK, GIVE DATA ON PRESENT PRODUCTIVE ZONE AND PROPOSED NEW PRODUCTIVE ZONE. GIVE BLOWOUT PREVENTER PROGRAM, IF ANY.

I hereby certify that the information above is true and complete to the best of my knowledge and belief.

SIGNATURE Paul C. Thompson TITLE Manager Prod. & Drlg. DATE 1-12-90
TYPE OR PRINT NAME Paul Thompson TELEPHONE NO. 599-3400

(Sanders)

(This space for State Use)

APPROVED BY [Signature] TITLE SUPERVISOR DISTRICT # DATE JAN 16 1990
CONDITIONS OF APPROVAL, IF ANY:

Submit to Appropriate
District Office
State Lease - 4 copies
Fee Lease - 3 copies

State of New Mexico
Energy, Minerals and Natural Resources Department

Form C-102
Revised 1-1-89

OIL CONSERVATION DIVISION

P.O. Box 2088
Santa Fe, New Mexico 87504-2088

DISTRICT I
P.O. Box 1980, Hobbs, NM 88240

DISTRICT II
P.O. Drawer DD, Artesia, NM 88210

DISTRICT III
1000 Rio Brazos Rd., Aztec, NM 87410

WELL LOCATION AND ACREAGE DEDICATION PLAT

All Distances must be from the outer boundaries of the section

Operator NORTHWEST PIPELINE CORP.			Lease SAN JUAN 29-6 UNIT		Well No. 230
Unit Letter A	Section 35	Township 1.29 N.	Range R.6 W.	County RIO ARRIBA COUNTY	
Actual Footage Location of Well: 855 feet from the NORTH line and 1230 feet from the EAST line					
Ground level Elev. 6366	Producing Formation Fruitland		Pool Basin Fruitland Coal Gas		Dedicated Acreage: 320 Acres

- Outline the acreage dedicated to the subject well by colored pencil or hatchure marks on the plat below.
- If more than one lease is dedicated to the well, outline each and identify the ownership thereof (both as to working interest and royalty).
- If more than one lease of different ownership is dedicated to the well, have the interest of all owners been consolidated by communitization, unitization, force-pooling, etc.?
☒ Yes ☐ No If answer is "yes" type of consolidation Unitization
If answer is "no" list the owners and tract descriptions which have actually been consolidated. (Use reverse side of this form if necessary.)
No allowable will be assigned to the well until all interests have been consolidated (by communitization, unitization, forced-pooling, or otherwise) or until a non-standard unit, eliminating such interest, has been approved by the Division.

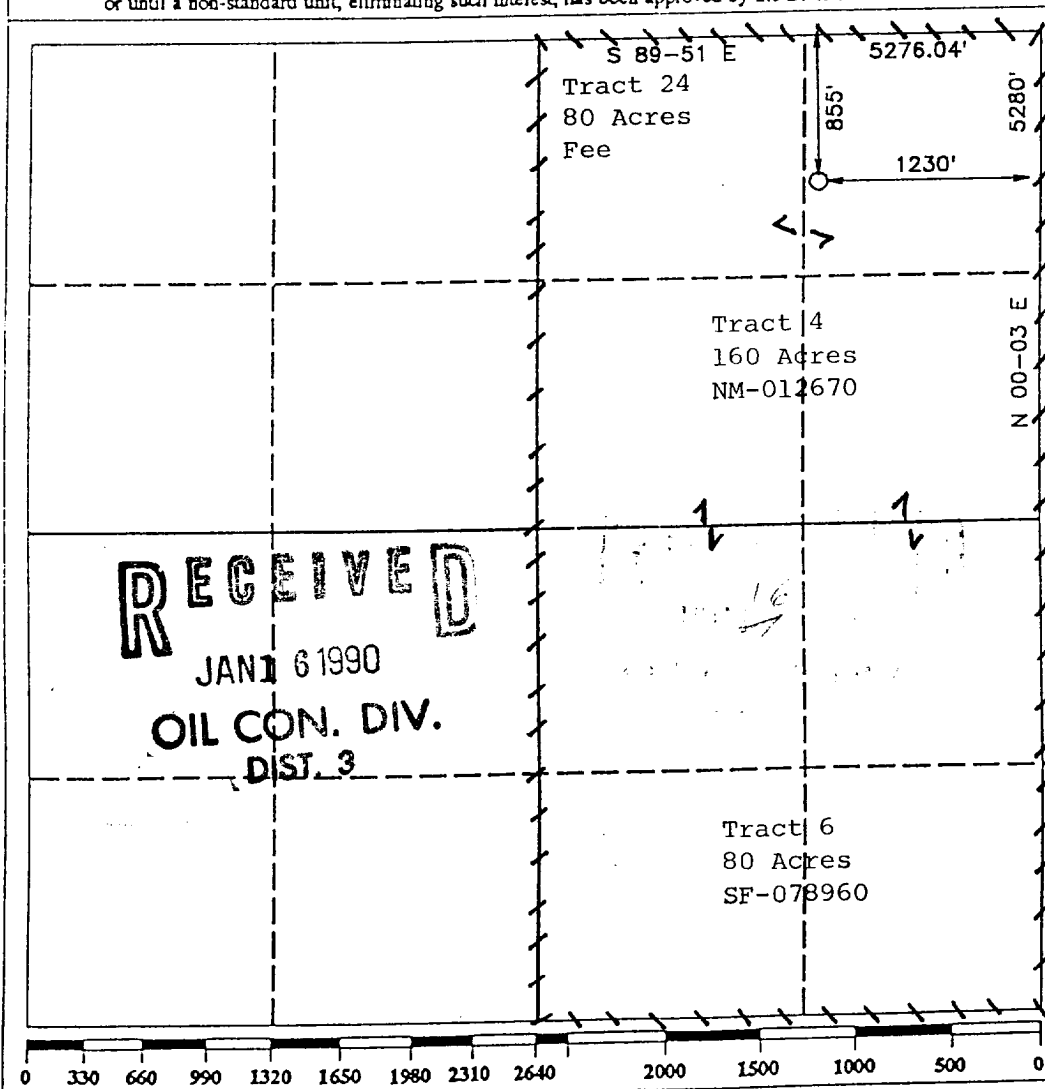

OPERATOR CERTIFICATION

I hereby certify that the information contained herein is true and complete to the best of my knowledge and belief.

Signature
Paul C. Thompson
Printed Name
Paul Thompson
Position
Manager Prod. & Drlg.
Company
Northwest Pipeline Corp.
Date
1-12-90

SURVEYOR CERTIFICATION

I hereby certify that the well location shown on this plat was plotted from field notes of actual surveys made by me or under my supervision, and that the same is true and correct to the best of my knowledge and belief.

Date Surveyed
DECEMBER 1989
Signature & Seal of Professional Surveyor
R. Howard Daggett
Certificate No. **9678**
Registered Professional
Land Surveyor

FIELD PRACTICES AND STANDARDS

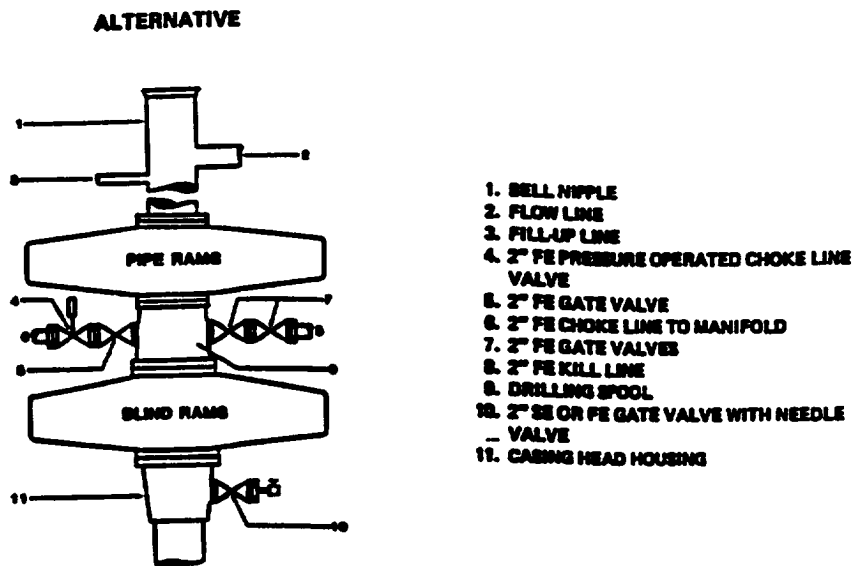

NOTE: THE DRILLING SPOOL MAY BE LOCATED BELOW BOTH SETS OF RAMS IF A DOUBLE PREVENTER IS USED AND IT DOES NOT HAVE SUITABLE OUTLETS BETWEEN RAMS

**Figure 7-9. Standard Hydraulic Blowout Preventer Assembly
3 M Working Pressure Alternative 1**

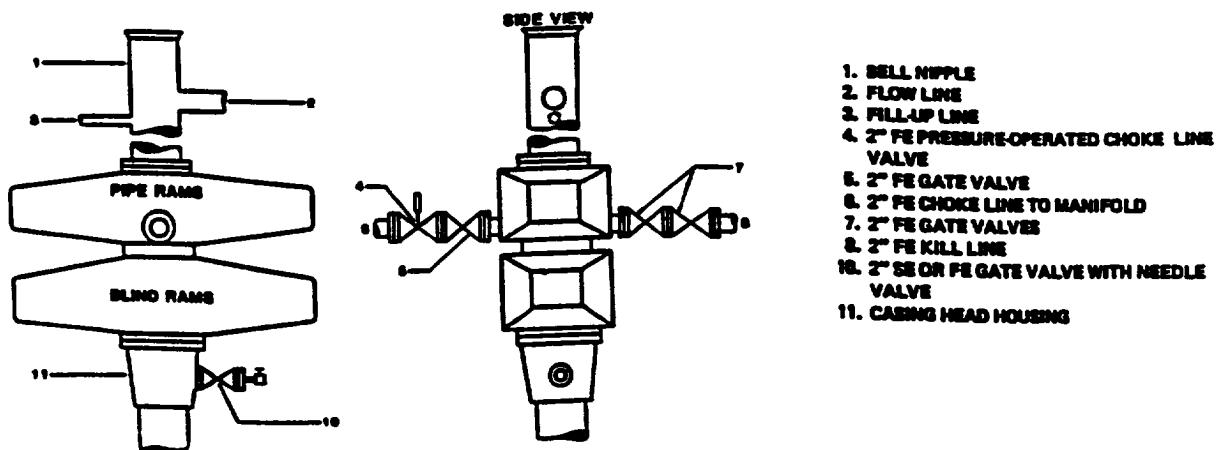

**Figure 7-10. Standard Hydraulic Blowout Preventer Assembly
3 M Working Pressure Alternative 3 (without Drilling Spool)**

