

UNITED STATES
DEPARTMENT OF THE INTERIOR
BUREAU OF LAND MANAGEMENT

APPLICATION FOR PERMIT TO DRILL, DEEPEN, OR PLUG BACK

1A. TYPE OF WORK

DRILL ☒

DEEPEN ☐

PLUG BACK ☐

b. TYPE OF WELL

OIL
WELL ☐

GAS
WELL ☒

OTHER

SINGLE
ZONE ☒

MULTIPLE
ZONE ☐

2. NAME OF OPERATOR

Richmond Petroleum, Inc.

(214) 720-7730

3. ADDRESS OF OPERATOR

2651 N. Harwood, Suite 360, Dallas, Texas 75201

4. LOCATION OF WELL (Report location clearly and in accordance with any State requirements.)

At surface

1,310' FNL & 1,843' FEL

At proposed prod. zone

14. DISTANCE IN MILES AND DIRECTION FROM NEAREST TOWN OR POST OFFICE*

8-1/2 air miles east of Gobernador, NM

15. DISTANCE FROM PROPOSED*
LOCATION TO NEAREST
PROPERTY OR LEASE LINE, FT.

(Also to nearest drilg. unit line, if any)

1,310'

18. DISTANCE FROM PROPOSED LOCATION*
TO NEAREST WELL, DRILLING, COMPLETED,
OR APPLIED FOR, ON THIS LEASE, FT.

100'

16. NO. OF ACRES

640

19. PROPOSED DEPTH

4,340'

17. NO. OF ACRES ASSIGNED
TO THIS WELL

320

20. ROTARY OR CABLE TOOLS

Rotary

21. ELEVATIONS (Show whether DF, RT, GR, etc.)

7,405 GR

22. APPROX. DATE WORK WILL START*

As soon as possible

23. PROPOSED CASING AND CEMENTING PROGRAM

SIZE OF HOLE	SIZE OF CASING	WEIGHT PER FOOT	SETTING DEPTH	QUANTITY OF CEMENT REQUIRED
12-1/4"	8-5/8"	24#	240'	140 sx or to surface
7-7/8"	5-1/2"	15.5#	4,340'	590 sx Surface

TIGHT HOLE. PLEASE KEEP CONFIDENTIAL.

1. Per NMOCD Rule 102(c), a copy of this APD has been mailed to Schalk Development Company, operator of a well in this (NWNE) quarter-quarter. Well site has been inspected by Schalk Development Company.

2. Drilling Technical Program attached.

3. Surface use and operations plan pursuant to NTL-6 is attached.

"Approval of this action does
not warrant that the applicant
holds legal or equitable rights

IN ABOVE SPACE DESCRIBE PROPOSED PROGRAM: If proposal is to deepen or plug back, give data on present productive zone and proposed new productive zone. If proposal is to drill or deepen directionally, give pertinent data on subsurface locations and measured and true vertical depths. Give blowout preventer program, if any.

SIGNED [Signature] TITLE Engineer DATE 9/26/89

(This space for Federal or State office use)

PERMIT NO. _____ APPROVAL DATE _____

APPROVED BY _____ TITLE _____

CONDITIONS OF APPROVAL, IF ANY:

APPROVED
AS AMENDED

JAN 08 1990

AREA MANAGER

*See Instructions On Reverse Side

All distances must be from the outer boundaries of the Section.

Operator Richmond Petroleum, Inc.		Lease Federal 29-4-26		Well No. 2
Unit Letter B	Section 26	Township T. 29N	Range R. 4W	County Rio Arriba County
Actual Footage Location of Well				
1310	feet from the	North	line and	1843
				feet from the East line
Ground Level Elev. 7405	Producing Formation Fruitland		Pool Basin	Dedicated Acreage 320 Acres

1. Outline the acreage dedicated to the subject well by colored pencil or hatchure marks on the plat below.
2. If more than one lease is dedicated to the well, outline each and identify the ownership thereof (both as to working interest and royalty).
3. If more than one lease of different ownership is dedicated to the well, have the interests of all owners been consolidated by communitization, unitization, force-pooling, etc?

☐ Yes ☒ No If answer is "yes," type of consolidation will be communitized

If answer is "no," list the owners and tract descriptions which have actually been consolidated. (Use reverse side of this form if necessary.)

No allowable will be assigned to the well until all interests have been consolidated (by communitization, unitization, forced-pooling, or otherwise) or until a non-standard unit, eliminating such interests, has been approved by the Division.

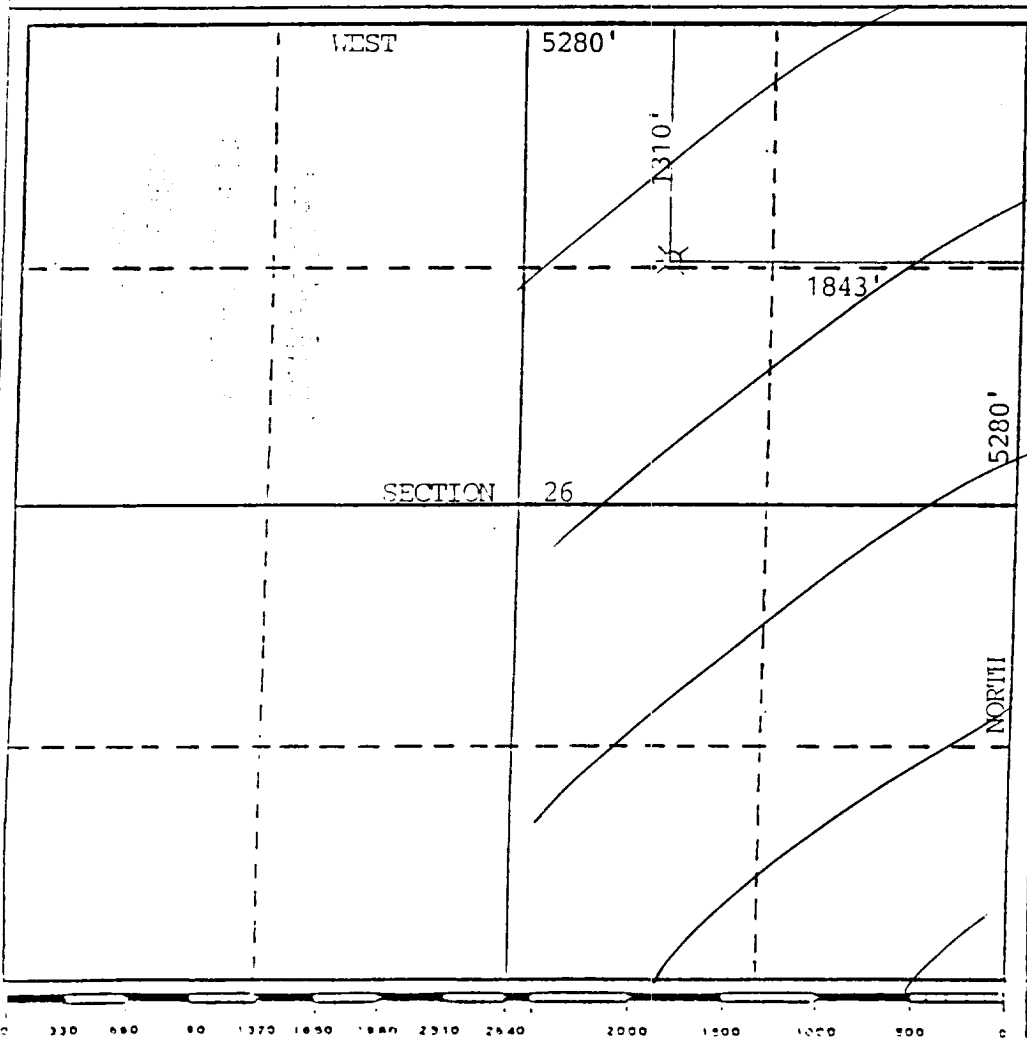

CERTIFICATION

I hereby certify that the information contained herein is true and complete to the best of my knowledge and belief.

Steven S. Dunn
Name
Steven S. Dunn

Position

Engineer

Company

Merrion Oil & Gas Corp.

Date
9/26/89

I hereby certify that the well location shown on this plat was plotted from field notes of actual surveys made by me or under my supervision, and that the same is true and correct to the best of my knowledge and belief.

Date Surveyed

Registered Land Surveyor

R. Howard Daggett

Certificate No.

9679

Registered Professional Land Surveyor

30-039-24615

01-22-90

F

F. Loc. 1310/N; 1843/E Elev. 7405 GL Spd. Cu. ft. ID Cu. ft. P
@ W' Sx. Int. @ W Sx. Pr. @ W Sx. T
Prod. Slim. Grav. 1st Del. Gas
T Gas
R
A
N
S

BO/D MCF/D After Hrs. SICP PSI After Days GOR
Grav. 1st Del. Oil

TOPS		Ni/D	X	Well Log	TEST DATA					D	Ref. No.
Ojo Alamo	C-103		X	Plot	Schd.	PC	Q	PW	PD		
Kirtland	C-104			Electric Log							
Fruitland				C-122							
Pictured Cliffs	Ditr			Dfo							
Chacra	Dair			Dac							
Cliff House											
Menefee											
Point Lookout											
Mancos											
Gallup											
Greenhorn											
Dakota											
Entrada											
				Acres E/320							

Federal 26 #2

B-26-29N-04W

RICHMOND PETROLEUM, INC.



United States Department of the Interior

BUREAU OF LAND MANAGEMENT
FARMINGTON RESOURCE AREA
1235 LAPLATA HIGHWAY
FARMINGTON, NEW MEXICO 87401



IN REPLY REFER TO:

NM-18322 et. al. (WC)
3162.3-1.0 (019)

CERTIFIED--RETURN RECEIPT REQUESTED
P 337 994 699

JAN. 18 1991

Richmond Petroleum
2651 N. Harwood
Dallas, TX 75201

Gentlemen:

Enclosed are your Applications for Permit to Drill (APD's) for the following wells:

1. No. 1 Federal 29-4-23, SW/4SW/4 sec. 23, T. 29 N., R. 4 W., Rio Arriba County, New Mexico, lease NM-18322.
2. No. 1 Federal 31-4-32, NE/4NE/4 sec. 32, T. 31 N., R. 4 W., Rio Arriba County, New Mexico, lease NM-23044.
3. No. 2 Federal 29-4-26, NW/4NE/4 sec. 26, T. 29 N., R. 4 W., Rio Arriba County, New Mexico, lease NM-18325.
4. No. 2 Federal 29-4-25, SW/4SW/4 sec. 25, T. 29 N., R. 4 W., Rio Arriba County, New Mexico, lease NM-18324.

As discussed with Dana Deventhal of your company on January 14, 1991, the subject APD's are rescinded and returned due to drilling not being commenced within one year of the approval date.

You are required to request surface rehabilitation instructions from this office if construction activities occurred on the referenced drill site. If this office does not receive comment within 30 days, it will presume that no construction occurred and proceed accordingly. Later discovery that construction activities have in fact occurred, may result in assessment of liquidated damages.

Sincerely,

Original Signed: STEPHEN MASON

For Ron Fellows
Area Manager

RECEIVED

JAN 22 1991

OIL CON. DIV.
DIST. 3

cc:
New Mexico Oil Conservation Division, 1000 Rio Brazos Road, Aztec, NM 87410
Carson National Forest, Gobernador Ranger Station, Gobernador Route, Blanco,
NM 87412

ABANDONED LOCATION