

Submit to Appropriate
District Office
State Lease -- 6 copies
Fee Lease -- 5 copies

State of New Mexico
Energy, Minerals and Natural Resources Department

Form C 101
Revised 1-1-89

OIL CONSERVATION DIVISION
P.O. Box 2088
Santa Fe, New Mexico 87504-2088

DISTRICT I
P.O. Box 1980, Hobbs, NM 88240

DISTRICT II
P.O. Drawer DD, Artesia, NM 88210

DISTRICT III
1000 Rio Brazos Rd., Aztec, NM 87410

API NO. (assigned by OCD on New Well)
30-039-24794
5. Indicate Type of Lease STATE <input type="checkbox"/> FEE <input checked="" type="checkbox"/>
6. State Oil & Gas Lease No.

APPLICATION FOR PERMIT TO DRILL, DEEPEN, OR PLUG BACK					
1a. Type of Work: DRILL <input checked="" type="checkbox"/> RE-ENTER <input type="checkbox"/> DEEPEN <input type="checkbox"/> PLUG BACK <input type="checkbox"/>					
b. Type of Well: OIL WELL <input type="checkbox"/> GAS WELL <input checked="" type="checkbox"/> OTHER <input type="checkbox"/> SINGLE ZONE <input checked="" type="checkbox"/> MULTIPLE ZONE <input type="checkbox"/>					
2. Name of Operator Phillips Petroleum Company					
3. Address of Operator 300 W. Arrington, Suite 200, Farmington, N.M. 87401					
4. Well Location Unit Letter H : 2336 Feet From The North Line and 806 Feet From The East Line Section 5 Township 29N Range 6W NMPM Rio Arriba County					
10. Proposed Depth 3420' (±)		11. Formation Fruitland		12. Rotary or C.T. Rotary	
13. Elevations (Show whether DF, RT, GR, etc.) 6505' (GL Unprepared) 6491		14. Kind & Status Plug. Bond Blanket		15. Drilling Contractor Advise Later	
16. Approx. Date Work will start Upon Approval					
17. PROPOSED CASING AND CEMENT PROGRAM					
SIZE OF HOLE	SIZE OF CASING	WEIGHT PER FOOT	SETTING DEPTH	SACKS OF CEMENT	EST. TOP
12-1/4"	9-5/8"	36#, K-55	250'	250 Sxs	Circ to Surface
8-3/4"	7"	23#, K-55	3200'	650 Sxs	Circ to Surface
6-1/8"	5-1/2"	15.5# or 23#	3100' - 3420'		*

*If the coal is cleated a 5-1/2", 23#, P-110 liner will be run in the open hole without being cemented.

*If the coal is not cleated the well will be stimulated and a 5-1/2", 15.5#, J-55 liner will be run without being cemented.

APPROVAL EXPIRES 12-15-90
UNLESS DRILLING IS COMMENCED.
SPUD NOTICE MUST BE SUBMITTED
WITHIN 10 DAYS

Use mud additives as required for control.

BOP Equipment: See attached schematic (Fig. 7-9 or 7-10)

RECEIVED
JUN 15 1990
OIL CON. DIV.
DIST. 3

IN ABOVE SPACE DESCRIBE PROPOSED PROGRAM: IF PROPOSAL IS TO DEEPEN OR PLUG BACK, GIVE DATA ON PRESENT PRODUCTIVE ZONE AND PROPOSED NEW PRODUCTIVE ZONE. GIVE BLOWOUT PREVENTER PROGRAM, IF ANY.

I hereby certify that the information above is true and complete to the best of my knowledge and belief.

SIGNATURE L. M. Sanders TITLE Supv. Regulatory Affairs DATE 6/15/90
(505)
TELEPHONE NO. 599-3431

TYPE OR PRINT NAME L. M. Sanders

(This space for State Use)

APPROVED BY Frank B. Buehler TITLE SUPERVISOR DISTRICT 3 DATE 6-15-90
CONDITIONS OF APPROVAL, IF ANY:

1971-72
OFFICE OF THE
GOVERNOR
STATE OF TEXAS
AUSTIN

1971-72
OFFICE OF THE
GOVERNOR
STATE OF TEXAS
AUSTIN

Submit to Appropriate
District Office
State Lease - 4 copies
Fee Lease - 3 copies

State of New Mexico
Energy, Minerals and Natural Resources Department

Form C-102
Revised 1-1-89

OIL CONSERVATION DIVISION

P.O. Box 2088
Santa Fe, New Mexico 87504-2088

DISTRICT I
P.O. Box 1980, Hobbs, NM 88240

DISTRICT II
P.O. Drawer DD, Artesia, NM 88210

DISTRICT III
1000 Rio Brazos Rd., Aztec, NM 87410

WELL LOCATION AND ACREAGE DEDICATION PLAT

All Distances must be from the outer boundaries of the section

Operator PHILLIPS PETROLEUM		Lease SAN JUAN 29-6 UNIT		Well No. 217
Unit Letter H	Section 5	Township T.29 N.	Range R.6 W.	County RIO ARRIBA COUNTY
Actual Footage Location of Well: 2336 feet from the NORTH line and 806 feet from the EAST line				
Ground level Elev. 6491	Producing Formation Fruitland		Pool Basin Fruitland Coal	Dedicated Acreage: 318.60 Acres

- Outline the acreage dedicated to the subject well by colored pencil or hachure marks on the plat below.
- If more than one lease is dedicated to the well, outline each and identify the ownership thereof (both as to working interest and royalty).
- If more than one lease of different ownership is dedicated to the well, have the interest of all owners been consolidated by communitization, unitization, force-pooling, etc?
☒ Yes ☐ No If answer is "yes" type of consolidation Unitization
If answer is "no" list the owners and tract descriptions which have actually been consolidated. (Use reverse side of this form if necessary.)
No allowable will be assigned to the well until all interests have been consolidated (by communitization, unitization, forced-pooling, or otherwise) or until a non-standard unit, eliminating such interest, has been approved by the Division.

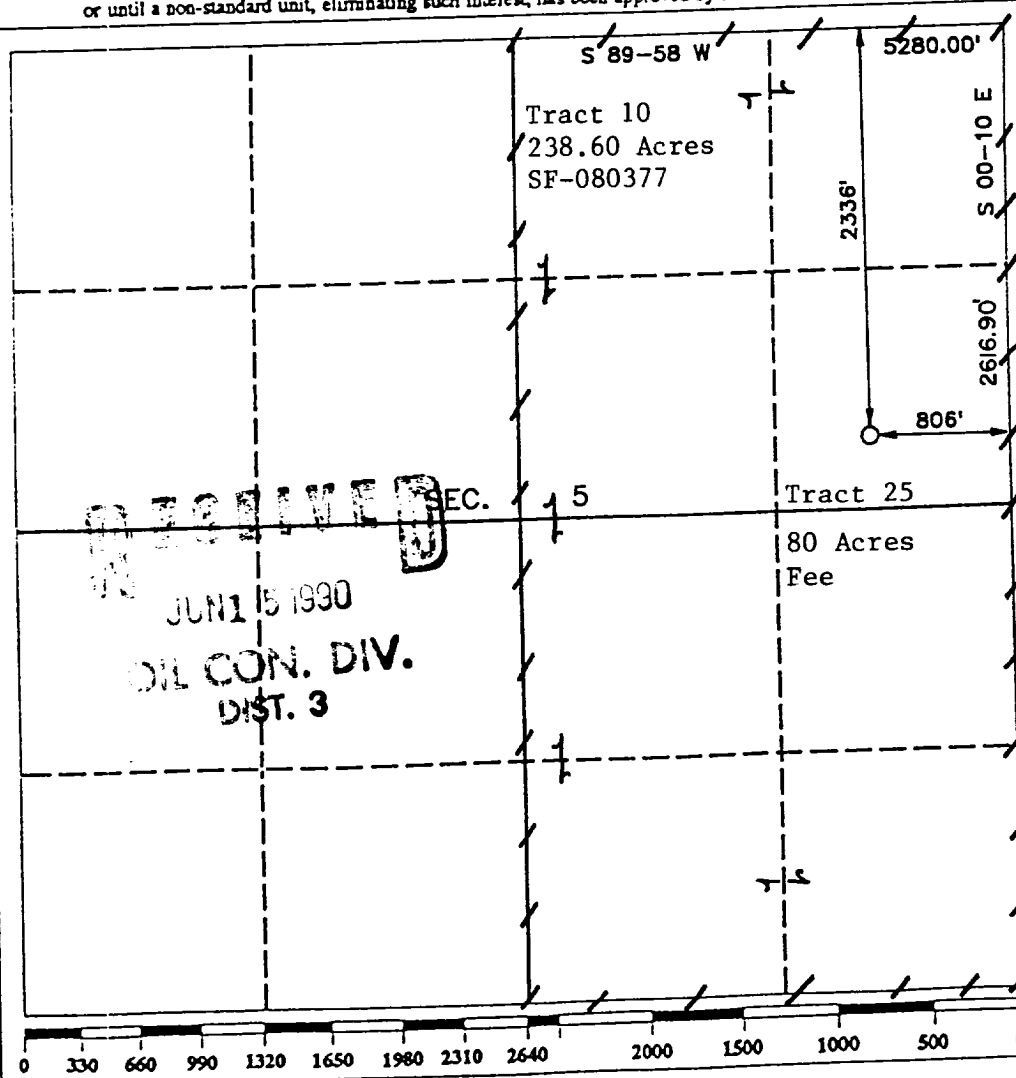

OPERATOR CERTIFICATION

I hereby certify that the information contained herein is true and complete to the best of my knowledge and belief.

Signature
L.M. Sanders
Printed Name
L.M. Sanders
Position
Supv. Regulatory Affairs
Company
Phillips Petroleum Company
Date
6/15/90

SURVEYOR CERTIFICATION

I hereby certify that the well location shown on this plat was plotted from field notes of actual surveys made by me or under my supervision, and that the same is true and correct to the best of my knowledge and belief.

Date Surveyed
JUNE 15 1990
Signature & Seal of Professional Surveyor
R. HOWARD DAGGETT
Certificate No.
9678
Registered Professional Land Surveyor

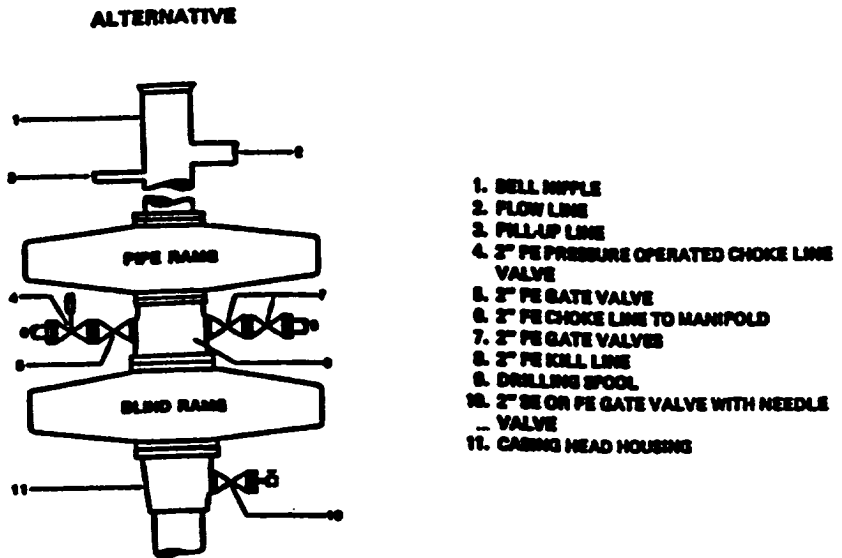

NOTE: THE DRILLING SPOOL MAY BE LOCATED BELOW BOTH SETS OF RAMS IF A DOUBLE PREVENTER IS USED AND IT DOES NOT HAVE SUITABLE OUTLETS BETWEEN RAMS

**Figure 7-9. Standard Hydraulic Blowout Preventer Assembly
3 M Working Pressure Alternative 1**

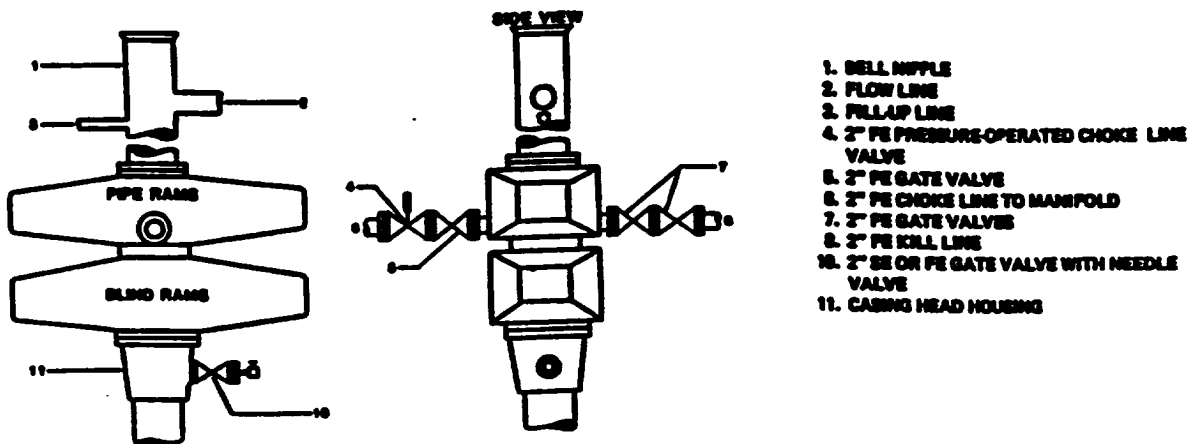

**Figure 7-10. Standard Hydraulic Blowout Preventer Assembly
3 M Working Pressure Alternative 3 (without Drilling Spool)**