

30-039-24914

UNITED STATES
DEPARTMENT OF THE INTERIOR
BUREAU OF LAND MANAGEMENT

APPLICATION FOR PERMIT TO DRILL, DEEPEN, OR PLUG BACK

<p>1a. TYPE OF WORK DRILL</p> <p>1b. TYPE OF WELL GAS</p> <hr/> <p>2. OPERATOR <u>14538</u> <u>EL PASO NATURAL GAS CO.</u> <u>W. J. Sullivan et al</u></p> <hr/> <p>3. ADDRESS & PHONE NO. OF OPERATOR P O BOX 4289 FARMINGTON, NM 87499</p> <hr/> <p>4. LOCATION OF WELL 1695' FSL 1595' FWL</p> <hr/> <p>14. DISTANCE IN MILES FROM NEAREST TOWN 5 miles s/e of navajo dam</p> <hr/> <p>15. DISTANCE FROM PROPOSED LOCATION TO NEAREST PROPERTY OR LEASE LINE. 1595'</p> <hr/> <p>18. DISTANCE FROM PROPOSED LOCATION TO NEAREST WELL DR. 100' COMPL., OR APPLIED FOR ON THIS LEASE.</p> <hr/> <p>21. ELEVATIONS (DF, FT, GR, ETC.) 6796' GL</p>	<p>5. LEASE NUMBER SF-078945</p> <p>6. IF INDIAN, ALL. OR TRIBE NAME</p> <hr/> <p>7. UNIT AGREEMENT NAME SAN JUAN 29-7 UNIT</p> <hr/> <p>8. FARM OR LEASE NAME <u>7465</u> SAN JUAN 29-7 UNIT</p> <p>9. WELL NO. 581</p> <hr/> <p>10. FIELD, POOL, OR WILDCAT <u>7429</u> BASIN FRUITLAND COAL</p> <p>11. SEC. T. R. M OR BLK. <u>K</u> SEC. 1 T29N R07W NMPM</p> <hr/> <p>12. COUNTY RIO ARRIBA</p> <p>13. STATE NM <u>W/318.56</u></p> <hr/> <p>16. ACRES IN LEASE 17. ACRES ASSIGNED TO WELL <u>2543.15</u> <u>320.00</u></p> <p><small>THIS ACRES IS SUBJECT TO FUTURE SURVEY AND REVISION. IT IS NOT TO BE USED FOR ANY OTHER PURPOSE.</small></p> <hr/> <p>19. PROPOSED DEPTH 20. ROTARY OR CABLE TOOLS 3681' ROTARY</p> <p><small>DRILLING OPERATIONS AUTHORIZED ARE SUBJECT TO COMPLIANCE WITH ATTACHED "GENERAL REQUIREMENTS".</small></p> <hr/> <p>22. APPROX. DATE WORK WILL START</p>
--	---

23. PROPOSED CASING AND CEMENTING PROGRAM

*SEE OPERATIONS PERMIT

RECEIVED

24. AUTHORIZED BY: [Signature] SEP 13 1990
REG. DRILLING ENGR. OIL CON. DIV. 7/18/90
DATE

PERMIT NO. _____ APPROVAL DATE _____

APPROVED BY _____ TITLE _____ DATE _____

NOTE: THIS FORMAT IS ISSUED IN LIEU OF US BLM FORM 3160-5.

[Signature]

Submit to Appropriate
District Office
State Lease - 4 copies
Fee Lease - 3 copies

State of New Mexico
Energy, Minerals and Natural Resources Department

Form C-102
Revised 1-1-89

OIL CONSERVATION DIVISION

P.O. Box 2088

Santa Fe, New Mexico 87504-2088

DISTRICT I

P.O. Box 1980, Hobbs, NM 88240

DISTRICT II

P.O. Drawer DD, Artesia, NM 88210

DISTRICT III

1000 Rio Brazos Rd., Aztec, NM 87410

WELL LOCATION AND ACREAGE DEDICATION PLAT

All Distances must be from the outer boundaries of the section

Operator <i>El Paso Natural Gas</i>			Lease (SF-078945) San Juan 29-7 Unit		Well No. 581
Unit Letter A	Section 1	Township 29 North	Range 7 West	County NMPM Rio Arriba	
Actual Footage Location of Well: 1695 feet from the South line and 1595 feet from the West line					
Ground level Elev. 6796'	Producing Formation Fruitland Coal		Pool Basin	Dedicated Acreage: 520 Acres	

- Outline the acreage dedicated to the subject well by colored pencil or hatchure marks on the plat below.
- If more than one lease is dedicated to the well, outline each and identify the ownership thereof (both as to working interest and royalty).
- If more than one lease of different ownership is dedicated to the well, have the interest of all owners been consolidated by communitization, unitization, force-pooling, etc.?
☒ Yes ☐ No If answer is "yes" type of consolidation unitization
If answer is "no" list the owners and tract descriptions which have actually been consolidated. (Use reverse side of this form if necessary.)
No allowable will be assigned to the well until all interests have been consolidated (by communitization, unitization, forced-pooling, or otherwise) or until a non-standard unit, eliminating such interest, has been approved by the Division.

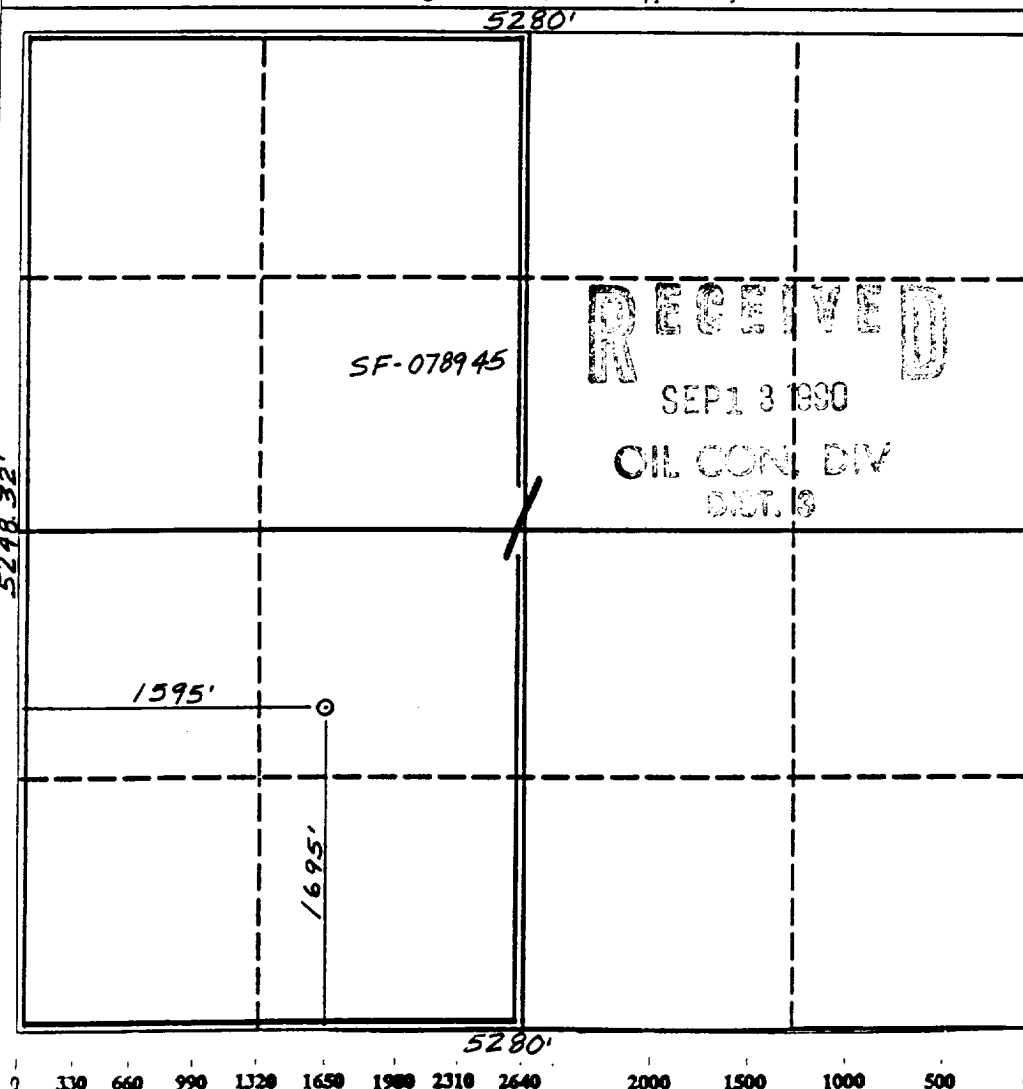

OPERATOR CERTIFICATION

I hereby certify that the information contained herein is true and complete to the best of my knowledge and belief.

Signature
Peggy Bradfield
Printed Name
Peggy Bradfield
Position
Regulatory Affairs
Company
El Paso Natural Gas
Date
7-18-90

SURVEYOR CERTIFICATION

I hereby certify that the well location shown on this plat was plotted from field notes of actual surveys made by me or under my supervision, and that the same is true and correct to the best of my knowledge and belief.

Date Surveyed
5-25-90
Signature
Neale C. Edwards
Professional Surveyor
NEW MEXICO
6857
6857
Certificate No.
Neale C. Edwards

Well Name: 581 SAN JUAN 29-7 UNIT 1695' FSL 1595' FWL
 Sec. 1 T29N R07W RIO ARRIBA NEW MEXICO
 BASIN FRUITLAND COAL Elevation 6796' GL

Formation tops: Surface- SAN JOSE
 Ojo Alamo- 2695
 Kirtland- 2910
 Fruitland- 3370
 Fruitland Coal Top- 3528 Intermediate TD- 3508
 Fruitland Coal Base- 3679 Total Depth- 3681
 Pictured Cliffs- 3687

Logging Program: Mud logs from intermediate to total depth.

Mud Program:	Interval	Type	Weight	Visc.	Fl. Loss
	0 - 400	Spud	8.4 - 8.9	40-50	no contro
	400 - 3508	Non-dispersed	8.4 - 9.1	30-60	no contro
	3508 - 3681	Formation Water	8.4		no contro

Casing Program:	Hole Size	Depth Interval	Csg. Size	Weight	Grade
	12 1/4"	0 - 400	9 5/8"	32.3#	H-40
	8 3/4"	0 - 3508	7"	20.0#	K-55
	6 1/4"	3458 - 3681	5 1/2"	15.5#	K-55
Tubing Program:		0 - 3681	2 7/8"	6.5#	J-55

Float Equipment: 9 5/8" surface casing - saw tooth guide shoe. Centralizers will be run in accordance with Onshore Order #2.

7" intermediate casing - guide shoe and self-fill insert float valve. Three centralizers run every other joint above shoe. Run insert float one joint above the guide shoe. Two turbolizing type centralizers - one below and one into the base of the Ojo Alamo @ 2910'. Standard centralizers thereafter every fourth joint up to the base of the surface pipe.

5 1/2" production casing - float shoe on bottom and a pre-drilled liner run to the 7" casing with a minimum 50' overlap. Liner hanger is a double slip grip type.

Wellhead Equipment: 9 5/8" x 7" x 2 7/8" x 11" 3000 psi xmas tree assembly.

Cementing:

9 5/8" surface casing - cement with 319 sacks of class "B" cement with 1/4# flocele/sack and 3% calcium chloride (376 cu ft. of slurry, 200% excess to circulate to surface). WOC 12 hours. Test casing to 600 psi for 30 minutes.

7" intermediate casing - lead with 523 sacks of 65/35 class "B" poz with 6% gel, 2% calcium chloride and 1/2 cu ft. Perlite/sack (10.3 gallons of water/sack) tail with 100 sacks of class "B" with 2% calcium chloride. 1128 cu ft. of slurry, 110% excess to circulate to surface. If hole conditions permit, a 600 ft spacer will be run ahead of the cement slurry to avoid mud contamination of the cement. WOC 12 hours. If cement does not circulate to surface, a temperature log will be run after 8 hours to determine TOC.

5 1/2" liner - do not cement.