



**NEW MEXICO ENERGY, MINERALS
& NATURAL RESOURCES DEPARTMENT**

OIL CONSERVATION DIVISION
2040 South Pacheco Street
Santa Fe, New Mexico 87505
(505) 827-7131

February 25, 1999

Burlington Resources Oil & Gas Company
P. O. Box 4289
Farmington, New Mexico 87499-4289
Attention: Peggy Bradfield

Telefax No. (505) 326-9833

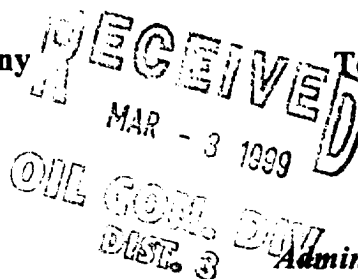

Administrative Order NSL-4220

Dear Ms. Bradfield:

Reference is made to your application dated February 23, 1999 for an exception to the well location requirements provided within the "*Special Rules for the Blanco-Mesaverde Pool*," as promulgated by New Mexico Oil Conservation Division ("Division") Order No. R-10987-A, issued in Case No. 12069 dated February 1, 1999, for a non-standard Blanco-Mesaverde infill gas well location in an existing standard 318.14-acre stand-up gas spacing and proration unit ("GPU") for the Blanco-Mesaverde Pool comprising Lots 5 and 6, the S/2 NE/4, and the SE/4 (E/2 equivalent) of Section 2, Township 29 North, Range 7 West, NMPM, Rio Arriba County, New Mexico.

This GPU is currently dedicated to Burlington Resources Oil & Gas Company's:

- (i) San Juan "29-7" Unit Well No. 47 (API No. 30-039-07709), located 890 feet from the North line and 1750 feet from the East line (Lot 6/Unit B) of Section 2;
- (ii) San Juan "29-7" Unit Well No. 47-A (API No. 30-039-21613), located 1160 feet from the South line and 1680 feet from the East line (Unit O) of Section 2; and
- (iii) San Juan "29-7" Unit Well No. 47-B (API No. 30-039-25622), located 2610 feet from the South line and 2200 feet from the East line (Unit J) of Section 2 (see Division Order No. R-10720, issued in Case No. 11625 dated January 9, 1997).

The locations of these three existing wells are considered to be standard pursuant to **Subparagraph I.B** of the current special rules governing the Blanco-Mesaverde Pool.

This application has been duly filed under the provisions of Division Rules 104.F and 605.B.

By the authority granted me under the provisions of Division Rule 104.F(2), the following described well to be drilled as the third infill well on this GPU at an unorthodox gas well location

Administrative Order NSL-4220
Burlington Resources Oil & Gas Company
February 25, 1999
Page 2

in Section 2 is hereby approved:

**San Juan "29-7" Unit Well No. 47-C
345' FNL & 490' FEL (Lot 5/Unit A)
(API No. 30-039-26074).**

Further, all four of the aforementioned San Juan "29-7" Unit Well Nos. 47, 47-A, 47-B, and 47-C and existing GPU will be subject to all existing rules, regulations, policies, and procedures applicable to prorated gas pools in Northwest, New Mexico and to the Blanco-Mesaverde Pool.

Sincerely,

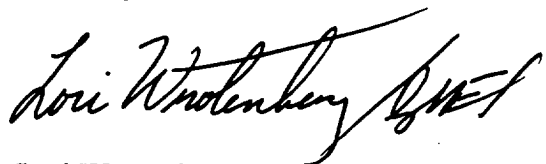
A handwritten signature in cursive script, appearing to read "Lori Wrotenbery".

Lori Wrotenbery
Director

LW/MES/kv

cc: New Mexico Oil Conservation Division - Aztec ✓
New Mexico State Land Office - Santa Fe

BURLINGTON RESOURCES

SAN JUAN DIVISION

February 23, 1999

Sent Federal Express

Mr. Michael Stogner
New Mexico Oil Conservation Division
2040 South Pacheco
Santa Fe, New Mexico 87505

RECEIVED
FEB 25 1999
OIL CON. DIV.
DIST. 3

Re: San Juan 29-7 Unit #47C
345'FNL, 490'FEL Section 2, T-29-N, R-7-W, Rio Arriba County
30-039-26074

Dear Mr. Stogner:

Burlington Resources is applying for administrative approval of an unorthodox gas well location for the Blanco Mesa Verde pool. This well is part of the increased density Mesa Verde program for Burlington Resources.

However, the referenced location was staked non-standard outside the parameters of the increased density order, R-10987A. This location is due to the drastic relief in topography at a standard location and for geological reasons as shown on the attached maps and narrative. The drastic topographic relief lends itself to both a poor site for a well location and steep access which is difficult to adequately maintain. Significant amounts of archaeology are also present in the northeast quarter of this section.

Production from the Blanco Mesa Verde pool is to be included in a 318.14 acre gas spacing and proration unit for the east half (E/2) in Section 2. Production from the Blanco Mesa Verde is to be dedicated to the San Juan 29-7 Unit #47 (30-039-07709) located at 890' FNL, 1750' FEL of Section 2, San Juan 29-7 Unit #47A (30-039-21613) located at 1160' FSL, 1680' FEL of Section 2, and San Juan 29-7 Unit #47B (30-039-25622) located at 2610' FSL, 2200' FEL of Section 2.

The following attachments are for your review:

- Application for Permit to Drill.
- Completed C-102 at referenced location.
- Offset operators/owners plat - Burlington is the offsetting operator.
- Geological narrative and maps
- 7.5 minute topographic map.

We appreciate your earliest consideration of this application.

Sincerely,



Peggy Bradfield
Regulatory/Compliance Administrator

xc: NMOCD - Aztec District Office
Bureau of Land Management

District I
PO Box 1980, Hobbs, NM 88241-1980
District II
811 South First, Artesia, NM 88210
District III
1000 Rio Brazos Rd., Aztec, NM 87410
District IV
2040 South Pacheco, Santa Fe, NM 87505

State of New Mexico
Energy, Minerals & Natural Resources Department

OIL CONSERVATION DIVISION
2040 South Pacheco
Santa Fe, NM 87505

RECEIVED
FEB 25 1999
OIL CON. DIV.
DIST. 3

Form C-101
Revised October 18, 1994
Instructions on back
Submit to Appropriate District Office
State Lease - 6 Copies
Fee Lease - 5 Copies

AMENDED REPORT

APPLICATION FOR PERMIT TO DRILL, RE-ENTER, DEEPEN, PLUGBACK, OR ADD A ZONE

Operator Name and Address. Burlington Resources Oil & Gas Company PO Box 4289, Farmington, NM 87499		OGRID Number 14538
Property Code 7465	Property Name San Juan 29-7 Unit	API Number 30 - 039-26074
		Well No. 47C

Surface Location

UL or lot no.	Section	Township	Range	Lot Idn	Feet from the	North/South line	Feet from the	East/West line	County
A	2	29N	7W		345'	North	490'	East	Rio Arriba

Proposed Bottom Hole Location If Different From Surface

UL or lot no.	Section	Township	Range	Lot Idn	Feet from the	North/South line	Feet from the	East/West line	County

Proposed Pool 1

Proposed Pool 2

Blanco Mesaverde

Work Type Code N	Well Type Code G	Cable/Rotary Rotary	Lease Type Code State	Ground Level Elevation 6823' GR
Multiple N	Proposed Depth 6300'	Formation Mesaverde	Contractor N/a	Spud Date N/a

Proposed Casing and Cement Program

Hole Size	Casing Size	Casing weight/foot	Setting Depth	Sacks of Cement	Estimated TOC
12 1/4"	9 5/8"	32.3#	320'	301 cu ft	Surface
8 3/4"	7"	20#	2950'	887 cu ft	Surface
6 1/4"	4 1/2"	10.5#	2850-6300'	531 cu ft	Surface

Describe the proposed program. If this application is to DEEPEN or PLUG BACK give the data on the present productive zone and proposed new productive zone. Describe the blowout prevention program, if any. Use additional sheets if necessary.

11" 2000 psi minimum double gate BOP

I hereby certify that the information given above is true and complete to the best of my knowledge and belief. Signature: <i>Peggy Bradfield</i>		OIL CONSERVATION DIVISION	
Printed name: Peggy Bradfield		Approved by: <i>James E. Smith</i>	
Title: Regulatory/Compliance Administrator		Title: DEPUTY OIL CON. DIV. DIST. 3	
Date: 1-18-99		Approval Date: _____	
Phone: 505-326-9700		Expiration Date: _____	
		Conditions of Approval: <i>HOLD C104 FOR 156</i>	

1st I
Box 1980, Hobbs, NM 88241-1980

State of New Mexico
Energy, Minerals & Natural Resources Department

Form
Revised February 2,
Instructions c
Submit to Appropriate District
State Lease - 4
Fee Lease - 3

District II
PO Drawer 00, Artesia, NM 88211-0719

District III
1000 Rio Brazos Rd., Aztec, NM 87410

District IV
PO Box 2088, Santa Fe, NM 87504-2088

OIL CONSERVATION DIVISION
PO Box 2088
Santa Fe, NM 87504-2088

☐ AMENDED RE

WELL LOCATION AND ACREAGE DEDICATION PLAT

'API Number' 30-039-26074	'Pool Code' 72319	'Pool Name' Blanco Mesaverde
'Property Code' 7465	'Property Name' SAN JUAN 29-7 UNIT	'Well Number' 47C
'GRID No. 14538	'Operator Name' BURLINGTON RESOURCES OIL & GAS COMPANY	'Elevation' 6823'



¹⁰ Surface Location

UL or lot no. A	Section 2	Township 29N	Range 7W	Lot Idn	Feet from the 345	North/South line NORTH	Feet from the 490	East/West line EAST	Cor RI ARR
--------------------	--------------	-----------------	-------------	---------	----------------------	---------------------------	----------------------	------------------------	------------------

¹¹ Bottom Hole Location If Different From Surface

UL or lot no.	Section	Township	Range	Lot Idn	Feet from the	North/South line	Feet from the	East/West line	Cor
'Dedicated Acres' E/318.14		'Joint or Infill'		'Consolidation Code'		'Order No.'			

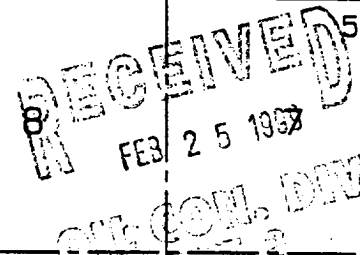
NO ALLOWABLE WILL BE ASSIGNED TO THIS COMPLETION UNTIL ALL INTERESTS HAVE BEEN CONSOLIDATED OR A NON-STANDARD UNIT HAS BEEN APPROVED BY THE DIVISION

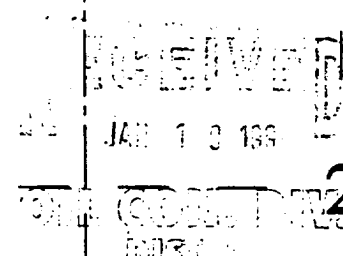
¹⁵ 5280.00' 5249.64' 5266.80'	 6 E-289-52	 5 490'	¹⁷ OPERATOR CERTIFICATE I hereby certify that the information contained is true and complete to the best of my knowledge and belief. Signature Peggy Bradfield Printed Name Regulatory Administrator Title 1-18-99 Date
	 E-5184-21		
	B-10037055	¹⁸ SURVEYOR CERTIFICATE I hereby certify that the well location shown on this plat was plotted from field notes of actual surveys made or under my supervision, and that the same is true and correct to the best of my belief. DECEMBER 3, 1998 Date of Survey Signature and Seal of Professional Surveyor NEALE C. EDWARDS NEW MEXICO Professional Surveyor Certificate Number 68570	

BURLINGTON RESOURCES OIL AND GAS COMPANY

**OFFSET OPERATOR \ OWNER PLAT
San Juan 29-7 Unit #47C**

Mesaverde Formation

Non-standard location

Township 29 North, Range 7 West

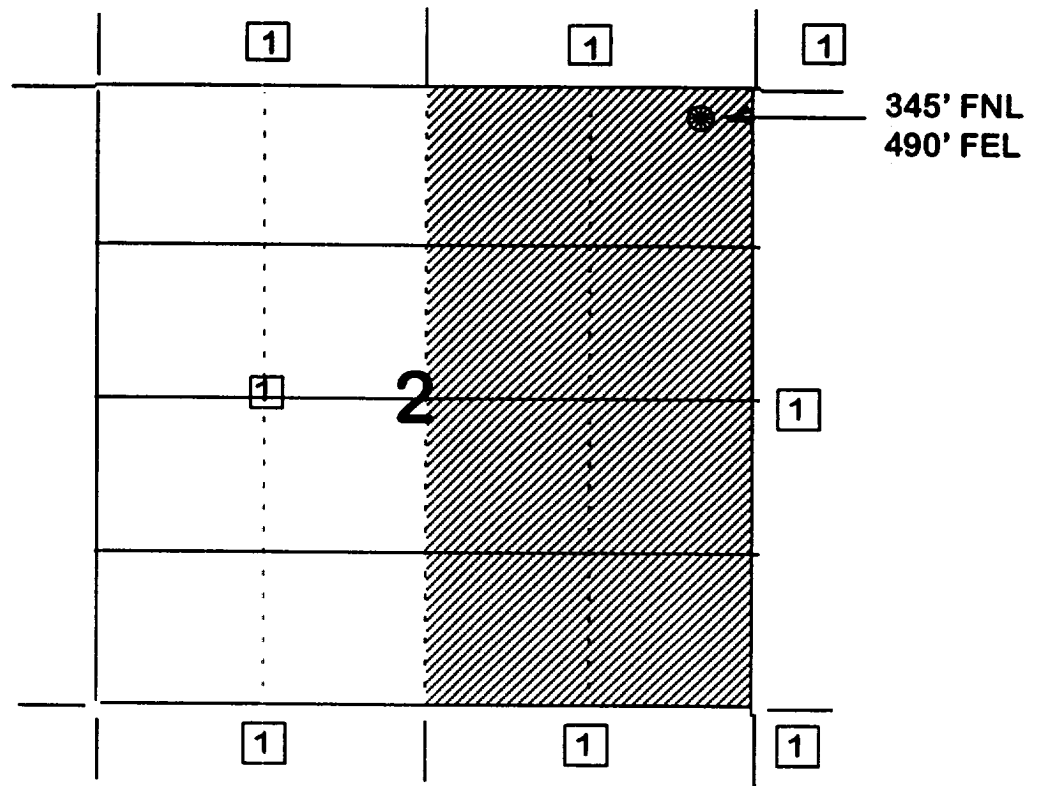

1) Burlington Resources

Proposed San Juan 29-7 Unit Well Number 47C
345' FNL & 490' FEL
Section 2, T29N, R7W
Rio Arriba County, New Mexico
Blanco Mesaverde Pool
Estimated TD 6300'

The location of the proposed test was selected to optimize recovery from the Mesaverde Group. The primary control on productivity in the Mesaverde is the density of natural fractures. Fracture orientation ranges from due north to north 30 degrees east. Gas drainage areas are elliptical in shape with the long axis parallel to the direction of fracture orientation. A drainage ellipse map of the project vicinity indicates that undeveloped gas reserves remain to be exploited in the E/2NE/4 of Section 2, T29N, R7W. The drainage ellipse map is based upon data derived from a larger study of the entire Blanco Mesaverde Pool (estimated ultimate recovery calculated for all wells in the Blanco Mesaverde Pool, original gas in place values calculated for entire Blanco Mesaverde Pool, etc.). Gross recoverable reserves of 1.718 BCFG are projected from the Mesaverde producing interval for the proposed test. Due to topographic and archeological restrictions, it is not possible to exploit the remaining gas reserves in the Mesaverde in E/2NE/4 of Section 2, T29N, R7W from a standard surface location.

Blanco Mesaverde

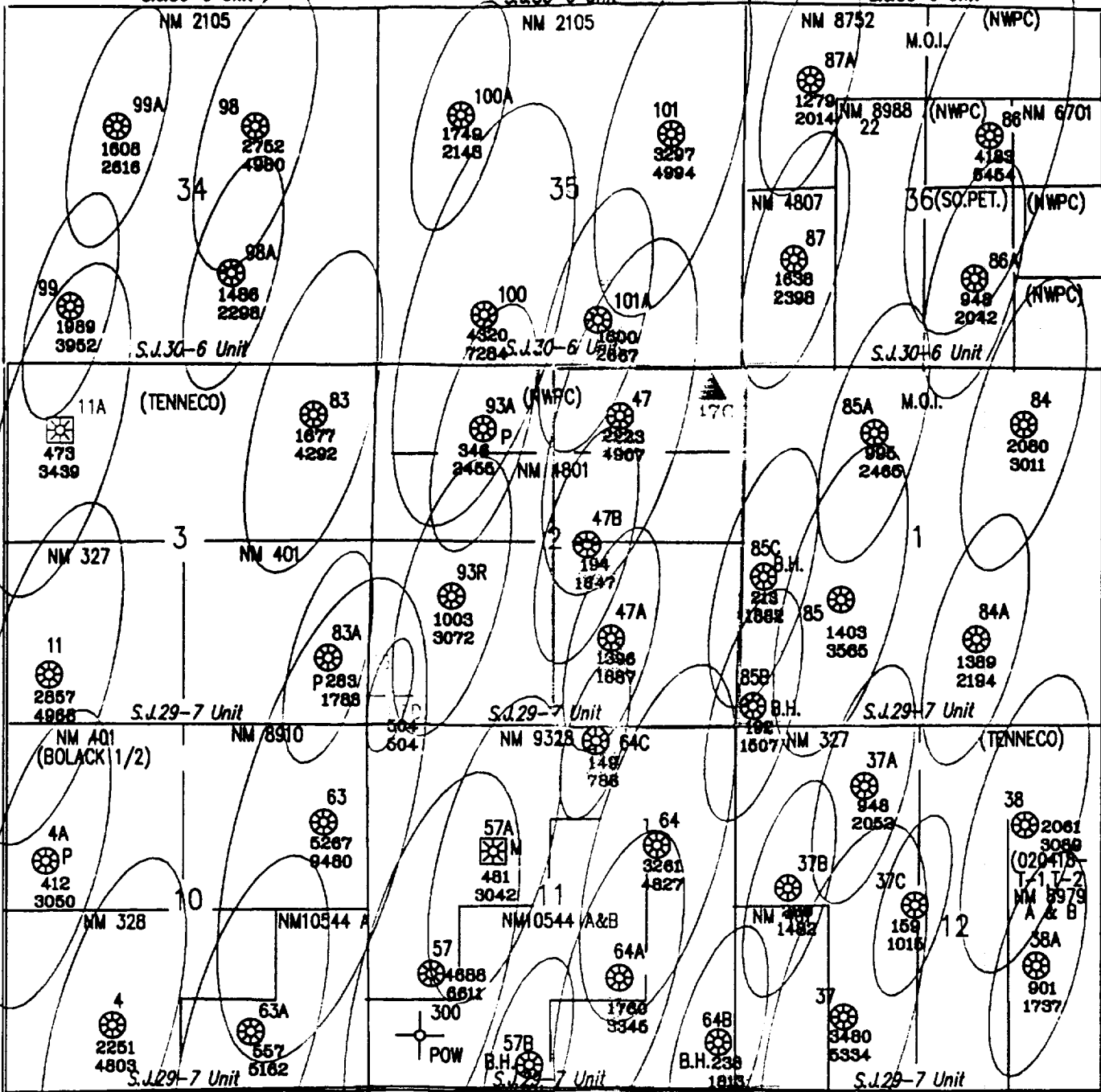

RIO ARRIBA COUNTY, NEW MEXICO

2400' NEW STATE CONSTRUCTION
1300' NW/NE SECTION 2, T29N, R7W
1100' NE/NE SECTION 2, T29N, R7W.

