

NEW MEXICO OIL CONSERVATION COMMISSION

NOTICE OF INTENTION TO DRILL

See Rules 101 and 1104.

If changes in the proposed plan are considered advisable, a copy of this notice showing such changes will be returned to the sender. Submit this notice in triplicate. One copy will be returned following approval.



Dallas, Texas
Place

April 22, 1952
Date

Notice hereby is given that it is our intention to commence the drilling of a well to be known as.....

Southern Union Gas Company **State-Hemp** well No. **2** in **St. Mar**
Company or Operator Lease
of Sec. **16**, T. **29-N**, R. **7-W**, N. M., P. M. **Blanco-LaPlata** Pool, **Rio Arriba** County.

The well is **660** feet from **(S.)** (S.) line and **1650** feet from **(W.)** (W.) line of the above section.

(Give location from section lines. Cross out wrong directions.)

If state land the oil and gas lease is No. Assignment No. **B-10037-40**

If patented land the owner is

Address

If government land the permittee is

Address

The lessee is

Address

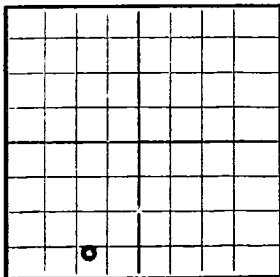

AREA 640 ACRES

LOCATE WELL CORRECTLY

We propose to drill well with drilling equipment as follows: **Rotary tools to top of Cliff House (approx. 5000'). Pay sands will be drilled with rotary using gas method.**

The status of a bond for this well in conformance with Rule 101 of the General Rules and Regulations of the Commission is as follows: **Company maintains a blanket bond**

We propose to use the following strings of casing and to land or cement them as indicated:

| Size of Hole | Size of Casing | Weight Per Foot | New or Second Hand | Depth | Landed or Cemented | Sacks Cement |
|--------------|---|-----------------|--------------------|---|-----------------------------|---------------------------------|
| | 10-3/4" 7" 2" tubing | | | 200' 5000' 5700' | Cemented " | 75 sacks 200 " |

If changes in the above plans become advisable we will notify you before cementing or landing casing. We estimate that the first productive oil or gas sand should occur at a depth of about **5000** feet.

Additional information:

The objective sands are the Cliff House and Point Lookout.

Well will be shot with approximately 1800 quarts of nitre glycerine from 5050' to total depth of approximately 5700 feet.

Approved **APR 24 1952**, 19.....

except as follows:

OIL CONSERVATION COMMISSION,
By **Al Gruer**
Title **Oil and Gas Inspector Dist. #3.**

SOUTHERN UNION GAS COMPANY
Company or Operator
By **Van Thompson**
Position **Manager Exploration Dept.**

Send communications regarding well to:

Name **Southern Union Gas Company**
Address **1104 Burt Bldg., Dallas 1, Texas**



Company Southern Union Gas Company
Lease State-Murphy Well No. 2
Sec. 16 T. 29 N. R. 7 W. N.M.P.M.
Location 660' from the South line and 1650' from
the West line.

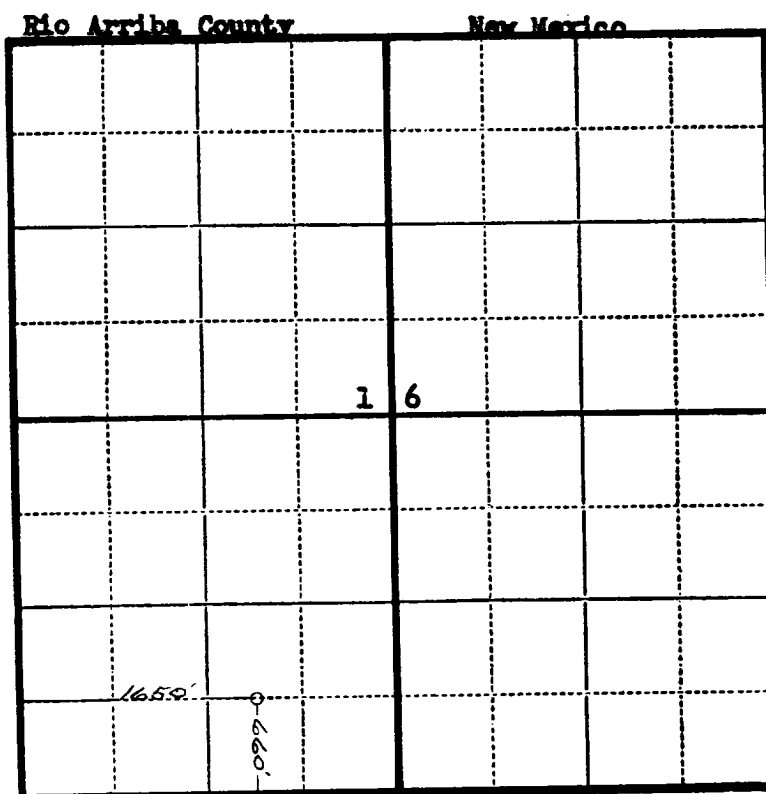

Scale—4 inches equals 1 mile.

This is to certify that the above plat was prepared from field notes of actual surveys made by me or under my supervision and that the same are true and correct to the best of my knowledge and belief.

Seal:

Charles J. Finkles
Registered Professional
Engineer and Land Surveyor.

Charles J. Finkles
N. Mex. Reg. No. 1302

Surveyed April 7, 19 52