

Form 9-331a
(Feb. 1931)

(SUBMIT IN TRIPLICATE)

UNITED STATES
DEPARTMENT OF THE INTERIOR
GEOLOGICAL SURVEY

Land Office Santa Fe
Lease No. 078423
Unit W $\frac{1}{2}$ Sec. 17, T-29-N,
R-7-W, N.M.P.M.

SUNDRY NOTICES AND REPORTS ON WELLS

NOTICE OF INTENTION TO DRILL	<input checked="" type="checkbox"/>	SUBSEQUENT REPORT OF WATER SHUT-OFF
NOTICE OF INTENTION TO CHANGE PLANS	<input type="checkbox"/>	SUBSEQUENT REPORT OF SHOOTING OR ACIDIZING
NOTICE OF INTENTION TO TEST WATER SHUT-OFF	<input type="checkbox"/>	SUBSEQUENT REPORT OF ALTERING CASING
NOTICE OF INTENTION TO RE-DRILL OR REPAIR WELL	<input type="checkbox"/>	SUBSEQUENT REPORT OF REDRILLING OR REPAIR
NOTICE OF INTENTION TO SHOOT OR ACIDIZE	<input type="checkbox"/>	SUBSEQUENT REPORT OF ABANDONMENT
NOTICE OF INTENTION TO PULL OR ALTER CASING	<input type="checkbox"/>	SUPPLEMENTARY WELL HISTORY
NOTICE OF INTENTION TO ABANDON WELL	<input type="checkbox"/>	

(INDICATE ABOVE BY CHECK MARK NATURE OF REPORT, NOTICE, OR OTHER DATA)

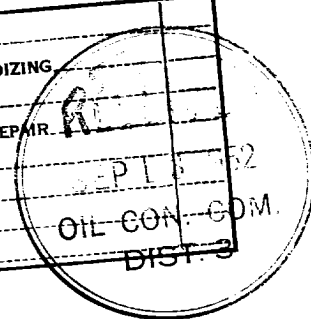

September 10, 1932

Well No. 1 Dawson is located 1850 ft. from S line and 905 ft. from W line of sec. 17

NW $\frac{1}{4}$ SW $\frac{1}{4}$ Sec. 17
($\frac{1}{4}$ Sec. and Sec. No.)

T-29-N, R-7-W
(Twp.) (Range)

N.M.P.M.
(Meridian)

Blanco
(Field)

Rio Arriba County
(County or Subdivision)

New Mexico
(State or Territory)

The elevation of the derrick floor above sea level is _____ ft. To be furnished

DETAILS OF WORK

(State names of and expected depths to objective sands; show sizes, weights, and lengths of proposed casings; indicate mudding jobs, cementing points, and all other important proposed work)

The objective sands are the Cliff House and the Point Lookout and their respective tops are expected at 4700' and 5300'. The casing program is as follows:

175' of 9-5/8" O.D. Casing cemented to top.
4700' of 5-1/2" O.D. Casing cemented with 200 sacks.

Well will be drilled with rotary tools to the top of the Cliff House at about 4700' and the Pay Sands will be drilled with rotary tools using natural gas method to a total depth of approximately 5500'. Well will then be shot with about 1800 quarts from 4750 to Total Depth.

I understand that this plan of work must receive approval in writing by the Geological Survey before operations may be commenced.

Company SOUTHERN UNION GAS COMPANY

Address 1009 Burt Building

Dallas, Texas

By A. M. Wiederkehr
Title Reservoir Engineer

Company Southern Union Gas Company
Lease Dawson Well No. 1
Sec. 17 T. 29 N. R. 7 W., N.M.P.M.
Location 1850' from the South line and 905' from
the West line.

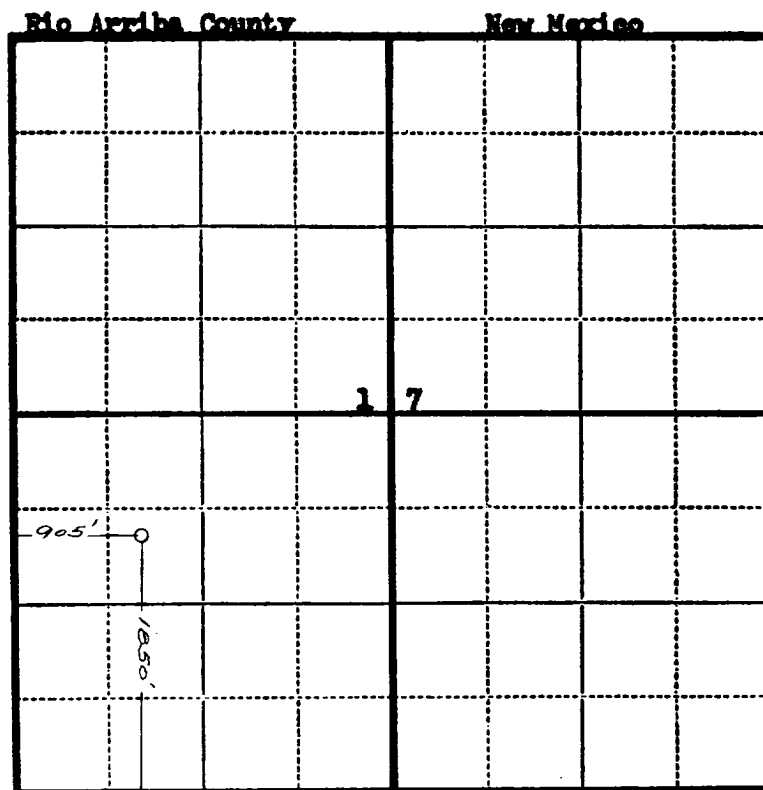
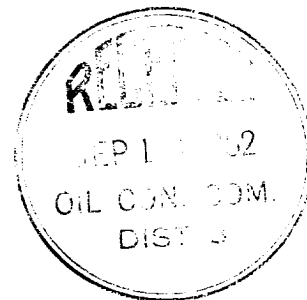

Scale—4 inches equals 1 mile.

This is to certify that the above plat was prepared from field notes of actual surveys made by me or under my supervision and that the same are true and correct to the best of my knowledge and belief.

Seal:

Registered Professional
Engineer and Land Surveyor.

Charles J. Finklea
N. Mex. Reg. No. 1302

Surveyed September 7, 19 52

OIL CONSERVATION COMMISSION

AZTEC DISTRICT OFFICE

No. Copies Received 1

DISTRIBUTION

	NO. FURNISHED	
Operator		
Santa Fe		
Proration Office		
State Land Office		
U. S. G. S.		
Transporter		
File	<u>1</u>	<input checked="" type="checkbox"/>