

UNITED STATES
DEPARTMENT OF THE INTERIOR
BUREAU OF LAND MANAGEMENT

30-039-25163

RECEIVED
BLM

92 FEB -4 AM 10:36

APPLICATION FOR PERMIT TO DRILL, DEEPEN, OR PLUG BACK

BLM FARMINGTON, N.M.

- 1a. TYPE OF WORK
DRILL
1b. TYPE OF WELL
GAS

RECEIVED
MAR 6 1992

5. LEASE NUMBER
SF-078424
6. IF INDIAN, ALL. OR TRIBE NAME

2. OPERATOR
MERIDIAN OIL INC.
14538

OIL CON. DIV.
DIST. 3

7. UNIT AGREEMENT NAME
SAN JUAN 29-7 UNIT

3. ADDRESS & PHONE NO. OF OPERATOR
P O BOX 4289
FARMINGTON, NM 87499

8. FARM OR LEASE NAME
SAN JUAN 29-7 UNIT 7465
9. WELL NO.
566

4. LOCATION OF WELL
1590' FNL 955' FEL

10. FIELD, POOL, OR WILDCAT
BASIN 71629 FRUITLAND COAL
11. SEC. T. R. M OR BLK.
H SEC. 27 T29N R07W NMPM

14. DISTANCE IN MILES FROM NEAREST TOWN
5 MILES FROM NAVAJO CITY

12. COUNTY
RIO ARriba
13. STATE
NM

15. DISTANCE FROM
PROPOSED LOCATION 955'
TO NEAREST PROPERTY
OR LEASE LINE.

16. ACRES IN LEASE 17. ACRES ASSIGNED TO WELL
2160 E/320.00

This action is subject to technical and
procedural review pursuant to 43 CFR 3165.3
and appeal pursuant to 43 CFR 3165.4.

18. DISTANCE FROM
PROPOSED LOCATION
TO NEAREST WELL DR. 160'
COMPL., OR APPLIED
FOR ON THIS LEASE.

19. PROPOSED DEPTH 20. ROTARY OR CABLE TOOLS
3293' ROTARY

DEPT. OF THE INTERIOR AUTHORIZED ARE
SUBJECT TO COMPLIANCE WITH ATTACHED
"GENERAL REQUIREMENTS".

21. ELEVATIONS (DF, FT, GR, ETC.)
6382' GL

22. APPROX. DATE WORK WILL START

23. PROPOSED CASING AND CEMENTING PROGRAM

*SEE OPERATIONS PLAN

24. AUTHORIZED BY: McAlister
REG. DRILLING ENGR.

1/30/92
DATE

PERMIT NO. _____ APPROVAL DATE _____

APPROVED
AS AMENDED

APPROVED BY _____ TITLE _____ DATE _____

MAR 05 1992

NOTE: THIS FORMAT IS ISSUED IN LIEU OF US BLM FORM 3160-3 AREA MANAGER

ARCH REPORT SUBMITTED 07/18/90

NMOCD

Submit to Appropriate
District Office
State Lease - 4 copies
Fee Lease - 3 copies

State of New Mexico
Energy, Minerals and Natural Resources Department

RECEIVED
Form C-102
Revised 1-1-89
OLN

OIL CONSERVATION DIVISION

DISTRICT I
P.O. Box 1980, Hobbs, NM 88240

P.O. Box 2088
Santa Fe, New Mexico 87504-2088

92 FEB -4 AM 10:36

019 FARMINGTON, N.M.

DISTRICT II
P.O. Drawer DD, Artesia, NM 88210

DISTRICT III
1000 Rio Brazos Rd., Aztec, NM 87410

WELL LOCATION AND ACREAGE DEDICATION PLAT

All Distances must be from the outer boundaries of the section

Operator Meridian Oil Inc.			Lease San Juan 29-7 Unit		Well No. 566
Unit Letter H	Section 27	Township 29 North	Range 7 West	County NMPM Rio Arriba	
Actual Footage Location of Well: 1590 feet from the North line and 955 feet from the East line					
Ground level Elev. 6382'		Producing Formation Fruitland Coal	Pool Basin	Dedicated Acreage: 320 Acres	

- Outline the acreage dedicated to the subject well by colored pencil or hatchure marks on the plat below.
- If more than one lease is dedicated to the well, outline each and identify the ownership thereof (both as to working interest and royalty).
- If more than one lease of different ownership is dedicated to the well, have the interest of all owners been consolidated by communitization, unitization, force-pooling, etc.?
☒ Yes ☐ No If answer is "yes" type of consolidation unitization
If answer is "no" list the owners and tract descriptions which have actually been consolidated. (Use reverse side of this form if necessary.)
No allowable will be assigned to the well until all interests have been consolidated (by communitization, unitization, forced-pooling, or otherwise) or until a non-standard unit, eliminating such interest, has been approved by the Division.

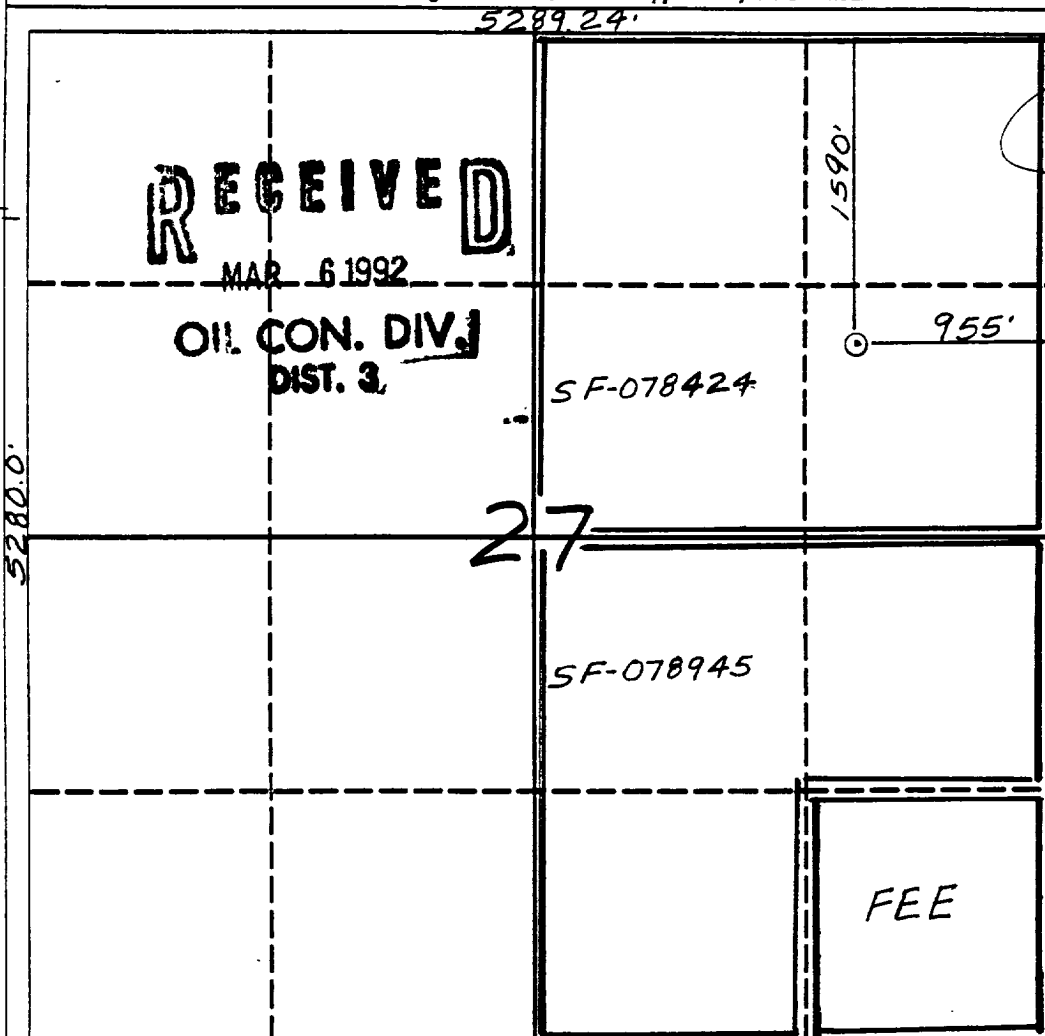

OPERATOR CERTIFICATION

I hereby certify that the information contained herein is true and complete to the best of my knowledge and belief.

Signature
Peggy Bradfield

Printed Name
Regulatory Affairs

Position
Meridian Oil Inc.

Company
1-23-92

Date

SURVEYOR CERTIFICATION

I hereby certify that the well location shown on this plat was plotted from field notes of actual surveys made by me or under my supervision, and that the same is true and correct to the best of my knowledge and belief.

6-27-90

Date Surveyed

Signature
Professional Surveyor

NEALE C. EDWARDS
6857
6857
REGISTERED LAND SURVEYOR

Certificate No.
Neale C. Edwards

Well Name: San Juan 29-7 Unit No. 566
Section 27, T-29-N, R-7-W
Basin-Fruitland Coal

1590' FNL - 955' FEL
Rio Arriba New Mexico
Elevation 6382'

Formation Tops: Surface- San Jose
 Ojo Alamo- 2301
 Kirtland- 2396
 Fruitland- 2926
 Fruitland Coal Top- 2988
 Fruitland Coal Base- 3183
 Pictured Cliffs- 3187

Total Depth- 3293

Logging Program: Mud logs from 2926 to total depth.

Mud Program:	Interval	Type	Weight	Visc.	Fl. Loss
	0 - 200	Spud	8.4 - 8.9	40-50	no control
	200 - 3293	Non-dispersed	8.4 - 9.5	30-60	no control

Casing Program:	Hole Size	Depth Interval	Csg. Size	Weight	Grade
	12 1/4"	0 - 200	8 5/8"	24.0#	K-40
	7 7/8"	0 - 3293	4 1/2"	10.5#	K-55
Tubing Program:		0 - 3293	2 3/8"	4.7#	J-55

Float Equipment: 8 5/8" surface casing - saw tooth guide shoe. Centralizers will be run in accordance with Onshore Order #2.

4 1/2" production casing - float shoe on bottom. Three centralizers run every other joint above shoe. Two turbolizing type centralizers - one below and one into the base of the Ojo Alamo @ 2301'. Standard centralizers thereafter every fourth joint up to the base of the surface pipe.

Wellhead Equipment: 8 5/8" x 4 1/2" x 2 3/8" x 11" 3000 psi xmas tree assembly.

Cementing:

8 5/8" surface casing - cement with 210 sacks of class "B" cement with 1/4# flocele/sack and 3% calcium chloride (250 cu ft. of slurry, 200% excess to circulate to surface). WOC 12 hours. Test casing to 600 psi for 30 minutes.

4 1/2" production casing - lead with 780 sacks of 65/35 class "B" poz with 6% gel, 2% calcium chloride and 1/2 cu.ft. Perlite/sack (10.3 gallons of water/sack) tail with 100 sacks of class "B" with 2% calcium chloride. 1500 cu.ft. of slurry, 100% excess to circulate to surface. If hole conditions permit, a 600 ft. spacer will be run ahead of the cement slurry to avoid mud contamination of the cement. WOC 12 hours. If cement doesnot circulate to surface, a temperature log will be run after 8 hours to determine TOC.

San Juan 29-7 Unit #566

T 29 N, R 07 W

75' New Construction

Section 27: SENE 600'
NENE 400'

MERIDIAN OIL INC

FEE
LANDS
NEW BLM
R-O-W