

(SUBMIT IN TRIPLICATE)

UNITED STATES
DEPARTMENT OF THE INTERIOR
GEOLOGICAL SURVEY

Land Office Santa Fe
Lease No. 073437
Unit E₂ Sec. 10
T-29-N, R-3-W, N.M.P.M.
Commenced Unit
E₂ Section 10
NE-A.G. Hill-SF073437

SUNDRY NOTICES AND REPORTS ON WELLS

SE-E.P.M.C.-SF073415

NOTICE OF INTENTION TO DRILL <input checked="" type="checkbox"/>	SUBSEQUENT REPORT OF WATER SHUT-OFF
NOTICE OF INTENTION TO CHANGE PLANS	SUBSEQUENT REPORT OF SHOOTING OR ACIDIZING
NOTICE OF INTENTION TO TEST WATER SHUT-OFF	SUBSEQUENT REPORT OF ALTERING CASING
NOTICE OF INTENTION TO RE-DRILL OR REPAIR WELL	SUBSEQUENT REPORT OF RE-DRILLING OR REPAIR
NOTICE OF INTENTION TO SHOOT OR ACIDIZE	SUBSEQUENT REPORT OF ABANDONMENT
NOTICE OF INTENTION TO PULL OR ALTER CASING	SUPPLEMENTARY WELL HISTORY
NOTICE OF INTENTION TO ABANDON WELL	

(INDICATE ABOVE BY CHECK MARK NATURE OF REPORT, NOTICE, OR OTHER DATA)

RECEIVED
MAY 7 1953
U. S. GEOLOGICAL SURVEY
FARMINGTON N. M.

May 5, 1953

Well No. 3 Hill is located 990 ft. from N line and 1650 ft. from E line of sec. 10

NE Section 10 T-29-N, R-3-W N. M. P. M.
($\frac{1}{4}$ Sec. and Sec. No.) (Twp.) (Range) (Meridian)
Blanco San Juan County New Mexico
(Field) (County or Subdivision) (State or Territory)

The elevation of the derrick floor above sea level is _____ ft. **To be furnished**

DETAILS OF WORK

(State names of and expected depths to objective sands; show sizes, weights, and lengths of proposed casings; indicate mudding jobs, cementing points, and all other important proposed work)

The objective sands are the Cliff House and the Point Lookout and their respective tops are expected at 4750' and 5225'.

Approximate Casing Program:
175' - 10 3/4" O. D. Casing cemented to top.
4750' - 7" O. D. Casing cemented with 200 sacks.

Well will be drilled with rotary tools to top of Cliff House sand at about 4750 and the pay sands will be drilled with rotary tools using natural gas method to a total depth of approximately 5475'. Well will then be shot with approximately 1300 quarts of nitro glycerine from 4300' to total depth.

I understand that this plan of work must receive approval in writing by the Geological Survey before operations are commenced.

Company SOUTHERN UNION GAS COMPANY

Address 1104 Hurt Building

Dallas, Texas

By Van Thompson
Title Manager, Exploration Dept.

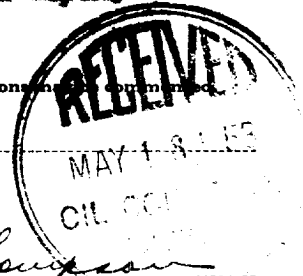

RECEIVED

MAY 7 1953

U. S. GEOLOGICAL SURVEY
FARMINGTON, N. M.

Company..... Southern Union Gas Company.....

Lease..... Hill..... Well No..... 3.....

Sec..... 10....., T..... 29 N....., R..... 8 W....., N.M.P.M.....

Location..... 990' from the North line and 1650' from the East line.

San Juan County

New Mexico

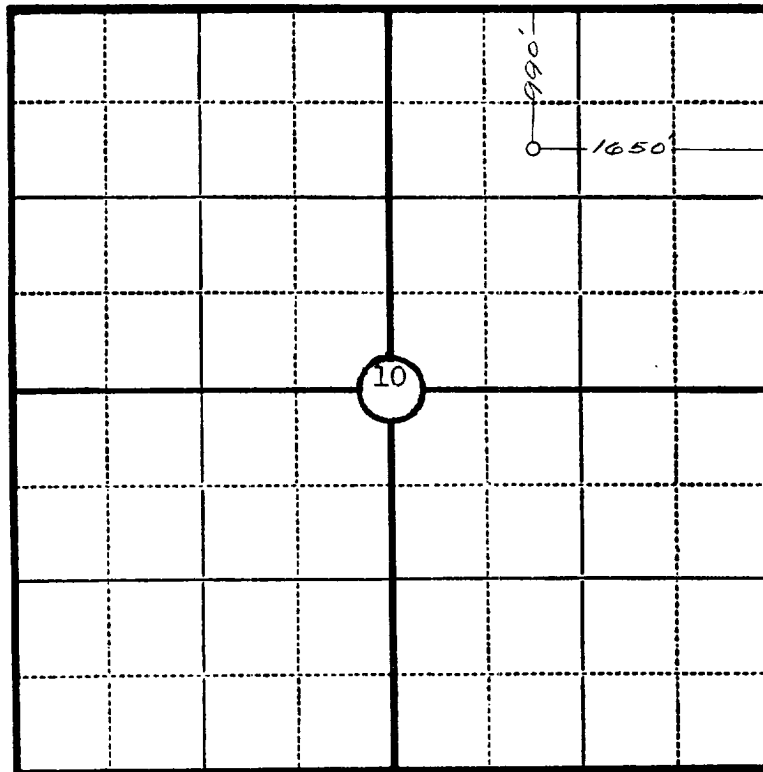

Scale—4 inches equal 1 mile.

This is to certify that the above plat was prepared from field notes of actual surveys made by me or under my supervision and that the same are true and correct to the best of my knowledge and belief.

Seal:

James P. Leese
Registered Professional
Engineer and Land Surveyor.

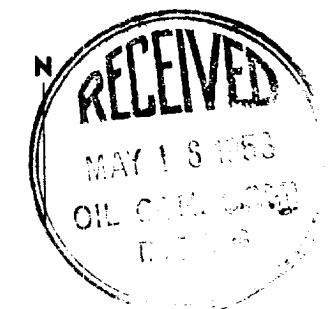

James P. Leese
N. Mex. Reg. No. 1463

Surveyed..... March 16....., 19 53.