

Company Dalhi Oil Corporation

~~SP-078595-A~~

Lease Florence Well No. 2-30

Sec. 1, T. 29 N., R. 8 W., N.M.P.M.

Location 870' from the South line and 830' from
the West line.

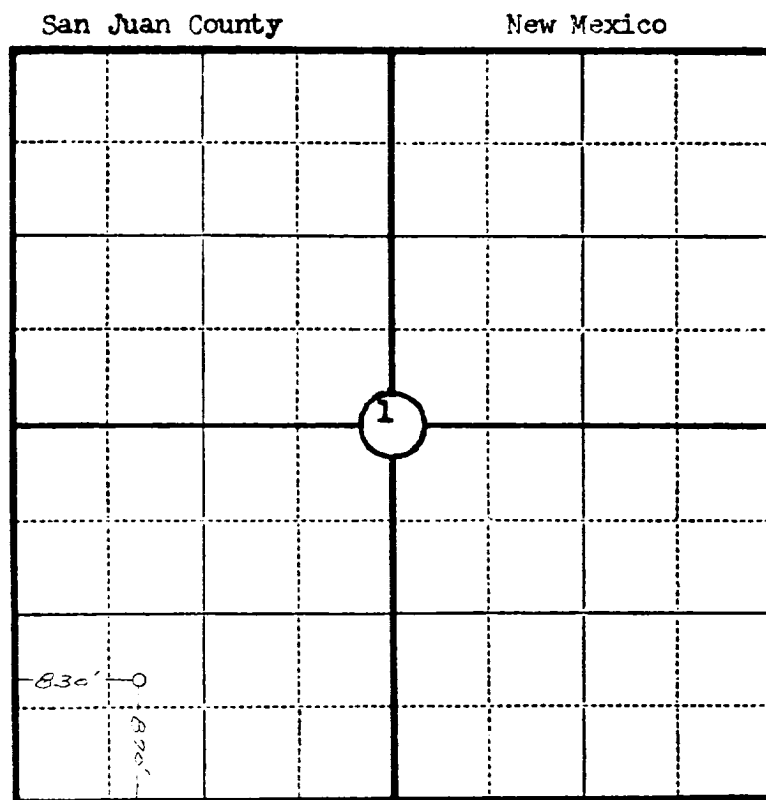

Scale—4 inches equal 1 mile.

This is to certify that the above plat was prepared from field notes of actual surveys made by me or under my supervision and that the same are true and correct to the best of my knowledge and belief.

Seal:

Registered Professional
Engineer and Land Surveyor.

Ernest V. Echohawk
N. Mex. Reg. No. 1545

Surveyed March 14, 1953