

NO. OF COPIES RECEIVED	b
DISTRIBUTION	
SANTA FE	1
FILE	1
U.S.G.S.	2
LAND OFFICE	1
OPERATOR	1

NEW MEXICO OIL CONSERVATION COMMISSION

30 ~~247~~ - 20382
Form C-101
Revised 1-1-65

5A. Indicate Type of Lease STATE <input checked="" type="checkbox"/> FEE <input type="checkbox"/>
5. State Oil & Gas Lease No. B-10405-36
7. Unit Agreement Name
8. Farm or Lease Name State Com. "C"
9. Well No. 5
10. Field and Pool, or Wildcat Blanco Pictured Cliffs
12. County San Juan
19. Proposed Depth 2350
19A. Formation Pictured Cliffs
20. Rotary or C.T. Rotary
21. Elevations (Show whether DF, RT, etc.) 5789 GR
21A. Kind & Status Plug. Bond In effect
21B. Drilling Contractor Howard Young Drlg. Co.
22. Approx. Date Work will start Upon Approval

APPLICATION FOR PERMIT TO DRILL, DEEPEN, OR PLUG BACK

1a. Type of Work b. Type of Well OIL WELL <input type="checkbox"/> GAS WELL <input checked="" type="checkbox"/> OTHER <input type="checkbox"/> DRILL <input checked="" type="checkbox"/> DEEPEN <input type="checkbox"/> PLUG BACK <input type="checkbox"/> SINGLE ZONE <input checked="" type="checkbox"/> MULTIPLE ZONE <input type="checkbox"/>	2. Name of Operator Tenneco Oil Company	3. Address of Operator Suite 1200 Lincoln Tower Bldg., Denver, Colorado 80203
4. Location of Well UNIT LETTER D LOCATED 790 FEET FROM THE North LINE AND 790 FEET FROM THE West LINE OF SEC. 32 TWP. 29N RGE. 9W NMPM		
23.		

PROPOSED CASING AND CEMENT PROGRAM

SIZE OF HOLE	SIZE OF CASING	WEIGHT PER FOOT	SETTING DEPTH	SACKS OF CEMENT	EST. TOP
12½"	8-5/8"	24#	150	130	Surface
7-7/8"	3½"	7.7#	2350	Suff. to circulate	Surface

Above well will be a 2350' Pictured Cliffs test. If production is indicated 3½" casing will be set at T.D. Well will be perforated and treated as necessary to establish commercial production.

APPROVAL VALID
FOR 90 DAYS UNLESS
DRILLING COMMENCED,

EXPIRES March 21, 1968



IN ABOVE SPACE DESCRIBE PROPOSED PROGRAM: IF PROPOSAL IS TO DEEPEN OR PLUG BACK, GIVE DATA ON PRESENT PRODUCTIVE ZONE AND PROPOSED NEW PRODUCTIVE ZONE. GIVE BLOWOUT PREVENTER PROGRAM, IF ANY.

I hereby certify that the information above is true and complete to the best of my knowledge and belief.

Signed Darryl M. Riggs Title District Office Supervisor Date 12-17-68

(This space for State Use)

APPROVED BY Ernest C. Clark TITLE Sup. Dist. III DATE 12-20-68

CONDITIONS OF APPROVAL, IF ANY:

**NEW MEXICO OIL CONSERVATION COMMISSION
WELL LOCATION AND ACERAGE DEDICATION PLAT**

All distances must be from the outer boundaries of the Section

Operator TEINCO OIL COMPANY				Lease STATE COM. C		Well No 5	
Unit Letter D	Section 32	Township 29 North	Range 9 West	County San Juan			
Actual Footage Location of Well: 790 feet from the North line and 790 feet from the West line Ground Level Elev. _____ Producing Formation _____ Pool _____ Dedicated Average _____ 5789 ungraded Pictured Cliffs Blanco Pictured Cliffs 160 Acres							

1. Outline the acreage dedicated to the subject well by colored pencil or hachure marks on the plat below.
2. If more than one lease is dedicated to the well, outline each and identify the ownership thereof (both as to working interest and royalty).
3. If more than one lease of different ownership is dedicated to the well, have the interests of all owners been consolidated by communitization, unitization, force-pooling, etc?

☒ Yes ☐ No If answer is "yes," type of consolidation **Communitized**

If answer is "no," list the owners and tract descriptions which have actually consolidated (Use reverse side of this form if necessary)

No allowable will be assigned to the well until all interests have been consolidated (by communitization, unitization, forced-pooling, or otherwise) or until a non standard unit, eliminating such interests, has been approved by the Commission

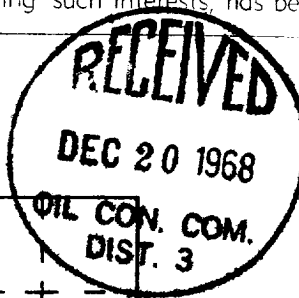
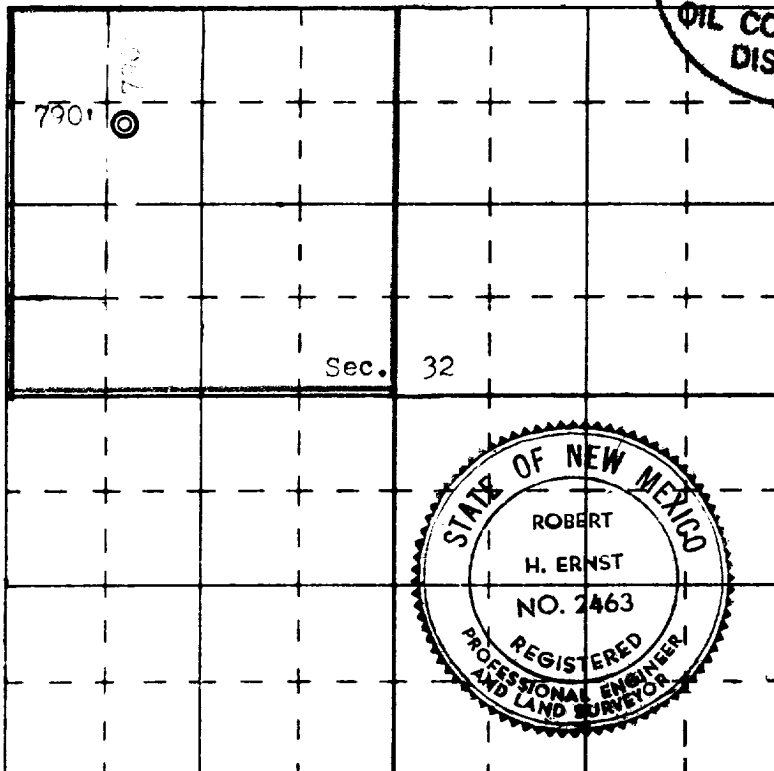

CERTIFICATION

I hereby certify that the information contained herein is true and complete to the best of my knowledge and belief.

Name Larry M. Riggs

Position **Larry M. Riggs**

District Office Supervisor
Company

Tenneco Oil Company
Date

December 17, 1968

I hereby certify that the well location shown on this plat was plotted from field notes of actual surveys made by me or under my supervision, and that the same is true and correct to the best of my knowledge and belief.

18 November 1968
Date Surveyed

Robert H. Ernst
Registered Professional Engineer
and/or Land Surveyor

Robert H. Ernst
N. Mex. PE & LS 2463

Certificate No. _____

