

EL PASO FIELD SERVICES PRODUCTION PIT CLOSURE

RIS
ET

Vandewart "A" #1
Meter/Line ID - 70219

SITE DETAILS

Legals - Twn: 29N	Rng: 8W	Sec: 11	Unit: A
NMOCD Hazard Ranking: 20		Land Type: BLM	
Operator: Amoco		Pit Closure Date: 06/01/94	

RATIONALE FOR RISK-BASED CLOSURE

The pit noted above was assessed and ranked according to the criteria in the New Mexico Oil Conservation Division's (NMOCD) Unlined Surface Impoundment Closure Guidelines.

A test pit was excavated to 12 feet below ground surface and a soil sample was collected for field headspace analysis and laboratory analysis for TPH. Groundwater was not encountered in the test pit. The pit was backfilled and graded in a manner to direct surface runoff away from the pit area. Headspace analysis indicated an organic vapor content of 291 ppm; laboratory analysis indicated a TPH concentration of 120 mg/kg.

El Paso Field Services Company (EPFS) requests closure of the above mentioned production pit location for the following reasons:

- The primary source, discharge to the pit, has been removed for almost six years.
- The test pit was backfilled and the former pit area graded to direct surface runoff away from the former pit.
- Groundwater was not encountered in the test excavation. In addition, the estimated depth to groundwater is greater than 100 feet; therefore, impact to groundwater is unlikely.
- Residual hydrocarbons in the soil will degrade naturally with minimal risk to the environment.

ATTACHMENT

Field Pit Assessment Form

Field Pit Remediation/Closure Form

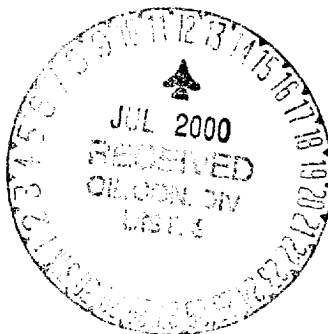

Laboratory Analytical Results

FIELD PIT SITE ASSESSMENT FORM

GENERAL	<p>Meter: <u>70219</u> Location: <u>VANDE WART "A" #1</u></p> <p>Operator #: <u>0203</u> Operator Name: <u>AMOCO</u> P/L District: <u>BLOOMFIELD</u></p> <p>Coordinates: Letter: <u>A</u> Section <u>11</u> Township: <u>29N</u> Range: <u>8W</u></p> <p>Or Latitude _____ Longitude _____</p> <p>Pit Type: Dehydrator <input checked="" type="checkbox"/> Location Drip: _____ Line Drip: _____ Other: _____</p> <p>Site Assessment Date: <u>5-10-94</u> Area: <u>10</u> Run: <u>72</u></p>
SITE ASSESSMENT	<p>NMOCD Zone: (From NMOCD Maps)</p> <p>Inside <input type="checkbox"/> (1) Outside <input checked="" type="checkbox"/> (2)</p> <p>Land Type: BLM <input checked="" type="checkbox"/> (1) State <input type="checkbox"/> (2) Fee <input type="checkbox"/> (3) Indian _____</p> <p>Depth to Groundwater Less Than 50 Feet (20 points) <input type="checkbox"/> (1) 50 Ft to 99 Ft (10 points) <input type="checkbox"/> (2) Greater Than 100 Ft (0 points) <input checked="" type="checkbox"/> (3)</p> <p>Wellhead Protection Area : Is it less than 1000 ft from wells, springs, or other sources of fresh water extraction? , or ; Is it less than 200 ft from a private domestic water source? <input checked="" type="checkbox"/> (1) YES (20 points) <input type="checkbox"/> (2) NO (0 points)</p> <p>Horizontal Distance to Surface Water Body Less Than 200 Ft (20 points) <input type="checkbox"/> (1) 200 Ft to 1000 Ft (10 points) <input type="checkbox"/> (2) Greater Than 1000 Ft (0 points) <input checked="" type="checkbox"/> (3)</p> <p>Name of Surface Water Body _____</p> <p>(Surface Water Body : Perennial Rivers, Major Wash, Streams, Creeks, Irrigation Canals, Ditches, Lakes, Ponds)</p> <p>Distance to Nearest Ephemeral Stream <input type="checkbox"/> (1) < 100' (Navajo Pits Only) <input type="checkbox"/> (2) > 100'</p> <p>TOTAL HAZARD RANKING SCORE: <u>20</u> POINTS</p>
REMARKS	<p>Remarks : <u>FOUR PITS ON LOCATION. WILL CLOSE ONLY ONE. PIT IS DRY.</u> <u>LOCATION IS ON MANZANARES MESA. REDLINE AND TOPO CONFIRMED LOCATION</u> <u>TO BE OUTSIDE THE V.R.</u></p> <p style="text-align: right;"><u>PUSH IN</u></p>

ORIGINAL PIT LOCATION

ORIGINAL PIT LOCATION

Original Pit : a) Degrees from North 116° Footage from Wellhead 54
b) Length : 36 Width : 24 Depth : 2

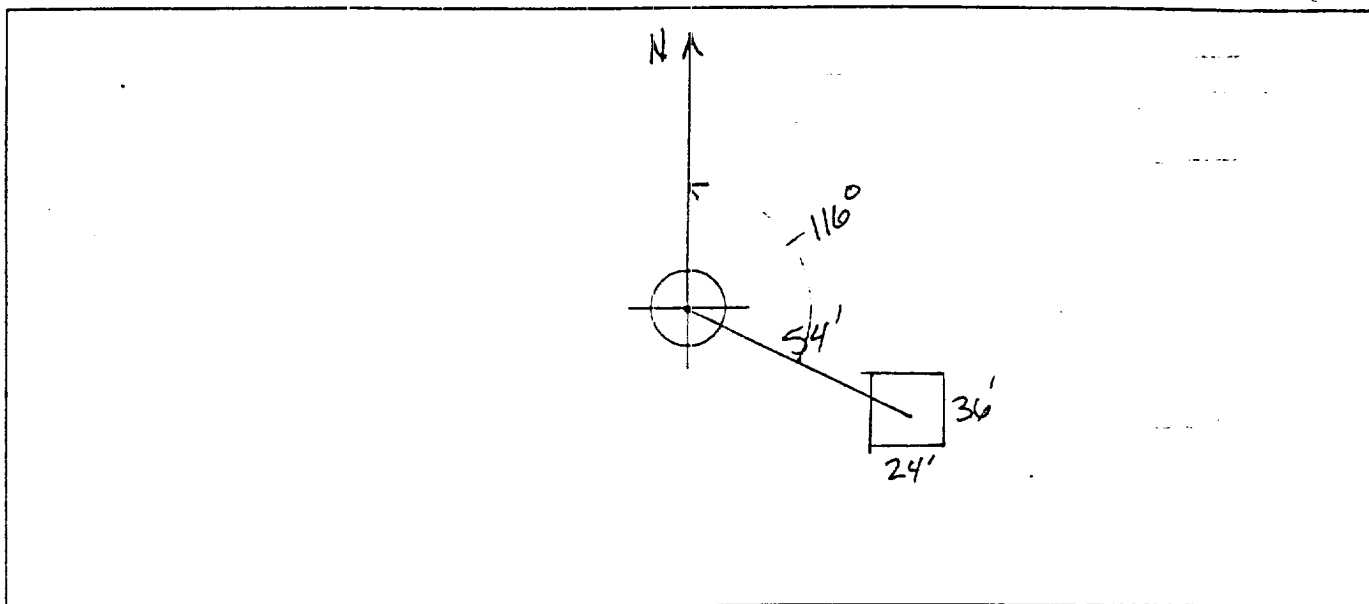

REMARKS

Remarks :

TOOK PICTURES AT 11:20 A.M.

END DUMP

Completed By:

Pat Thompson

Signature

5.10.94

Date

GENERAL	Meter: <u>70214</u> Location: <u>Vandewater "A" #1</u>
	Coordinates: Letter: <u>A</u> Section <u>11</u> Township: <u>29N</u> Range: <u>8W</u> Or Latitude _____ Longitude _____ Date Started : <u>6-1-94</u> Area: <u>10</u> Run: <u>22</u>
FIELD OBSERVATIONS	Sample Number(s): <u>VW 162</u>
	Sample Depth: <u>12'</u> Feet Final PID Reading <u>291</u> PID Reading Depth <u>12'</u> Feet Yes No Groundwater Encountered <input type="checkbox"/> (1) <input checked="" type="checkbox"/> (2) Approximate Depth _____ Feet
CLOSURE	Remediation Method : Excavation <input type="checkbox"/> (1) Approx. Cubic Yards _____ Onsite Bioremediation <input type="checkbox"/> (2) Backfill Pit Without Excavation <input checked="" type="checkbox"/> (3) Soil Disposition: Envirotech <input type="checkbox"/> (1) <input type="checkbox"/> (3) Tierra Other Facility <input type="checkbox"/> (2) Name: _____ Pit Closure Date: <u>6-1-94</u> Pit Closed By: <u>BEI</u>
	REMARKS : <u>Line markers</u>
Signature of Specialist: <u>Wale Wilson</u>	



Page _____ of _____

White Testing Laboratory Canary - EPNG Lab Pink - Field Sampler



FIELD SERVICES LABORATORY
ANALYTICAL REPORT
PIT CLOSURE PROJECT - Soil

SAMPLE IDENTIFICATION

	Field ID	Lab ID
SAMPLE NUMBER:	VW 142	945319
MTR CODE SITE NAME:	70219	N/A
SAMPLE DATE TIME (Hrs):	6-1-94	1145
SAMPLED BY:	N/A	
DATE OF TPH EXT. ANAL.:	6/10/94	6/10/94
DATE OF BTEX EXT. ANAL.:	N/A	N/A
TYPE DESCRIPTION:	VG	Gray Sand + Clay

REMARKS: ~~X-TPH RUN~~ TPH

RESULTS

PARAMETER	RESULT	UNITS	QUALIFIERS			
			DF	Q	M(g)	V(ml)
BENZENE		MG/KG				
TOLUENE		MG/KG				
ETHYL BENZENE		MG/KG				
TOTAL XYLENES		MG/KG				
TOTAL BTEX		MG/KG				
TPH (418.1)	120	MG/KG			2.15	28
HEADSPACE PID	291	PPM				
PERCENT SOLIDS	89.6	%				

— TPH is by EPA Method 418.1 and BTEX is by EPA Method 8020 —

Surrogate Recovery was at N/A % for this sample All QA/QC was acceptable.
Narrative:

DF = Dilution Factor Used

Approved By:

John Lanza

Date:

6/16/94



FIELD SERVICES LABORATORY

ANALYTICAL REPORT

PIT CLOSURE PROJECT - Soil

SAMPLE IDENTIFICATION

	Field ID	Lab ID
SAMPLE NUMBER:	VW142	945319
MTR CODE SITE NAME:	70219	N/A
SAMPLE DATE TIME (Hrs):	6-1-94	1145
SAMPLED BY:	N/A	
DATE OF TPH EXT. ANAL.:	6-3-94	6/3/94
DATE OF BTEX EXT. ANAL.:	N/A	N/A
TYPE DESCRIPTION:	VG	GRAY SAND & CLAY

REMARKS:

RESULTS

PARAMETER	RESULT	UNITS	QUALIFIERS			
			DF	Q	M(g)	V(ml)
BENZENE		MG/KG				
TOLUENE		MG/KG				
ETHYL BENZENE		MG/KG				
TOTAL XYLENES		MG/KG				
TOTAL BTEX		MG/KG				
TPH (418.1)	170	MG/KG			202	28
HEADSPACE PID	291	PPM				
PERCENT SOLIDS	89.6	%				

- TPH is by EPA Method 418.1 and BTEX is by EPA Method 8020 -

The Surrogate Recovery was at _____ % for this sample All QA/QC was acceptable.

Narrative:

TPH QC outside limits - need rerun

DF = Dilution Factor Used

Approved By: _____

Date: _____