

UNITED STATES
DEPARTMENT OF THE INTERIOR
GEOLOGICAL SURVEY

APPLICATION FOR PERMIT TO DRILL, DEEPEN, OR PLUG BACK

1a. TYPE OF WORK

DRILL ☒DEEPEN ☐PLUG BACK ☐

b. TYPE OF WELL

OIL
WELL ☐GAS
WELL ☒

OTHER

SINGLE
ZONE ☒MULTIPLE
ZONE ☐

2. NAME OF OPERATOR

Tenneco Oil Company

3. ADDRESS OF OPERATOR

P. O. Box 3249, Englewood, CO 80155

4. LOCATION OF WELL (Report location clearly and in accordance with any State requirements.)*

At surface

1700' FSL 900' FEL

At proposed prod. zone

14. DISTANCE IN MILES AND DIRECTION FROM NEAREST TOWN OR POST OFFICE*

12.5 miles ESE of Blanco, New Mexico

15. DISTANCE FROM PROPOSED*

LOCATION TO NEAREST

PROPERTY OR LEASE LINE, FT.

(Also to nearest drilg. unit line, if any)

900'

18. DISTANCE FROM PROPOSED LOCATION*

TO NEAREST WELL, DRILLING COMPLETED,

OR APPLIED FOR, ON THIS LEASE, FT.

16. NO. OF ACRES IN LEASE

1600

19. PROPOSED DEPTH

7580'

17. NO. OF ACRES ASSIGNED
TO THIS WELL

E 320

20. ROTARY OR CABLE TOOLS

Rotary

21. ELEVATIONS (Show whether DF, RT, GR, etc.)

6375

22. APPROX. DATE WORK WILL START*

January 1982

23. PROPOSED CASING AND CEMENTING PROGRAM

SIZE OF HOLE	SIZE OF CASING	WEIGHT PER FOOT	SETTING DEPTH	QUANTITY OF CEMENT
12-1/4"	9-5/8"	36# new	+ 250'	Circ cmt to surface
8-3/4"	7"	23# new	+ 3750'	Circ cmt to surface
6-1/4"	4-1/2"	10.5#, 11.6# new	+ 7580'	Circ cmt to liner top

Gas is dedicated

See attached drilling procedure

IN ABOVE SPACE DESCRIBE PROPOSED PROGRAM: If proposal is to deepen or plug back, give data on present productive zone and proposed new productive zone. If proposal is to drill or deepen directionally, give pertinent data on subsurface locations and measured and true vertical depths. Give blowout preventer program, if any.

24.

SIGNED

Donal Harrison

TITLE

Production Analyst

DATE

11/20/81

(This space for Federal or State office use)

PERMIT NO.

APPROVAL DATE

APPROVED BY

Dean Elliott

TITLE

James F. Sims
District Supervisor

DATE

DE

CONDITIONS OF APPROVAL, IF ANY:

*See Instructions On Reverse Side

NMOCC

All distances must be from the outer boundaries of the Section.

Operator TENNECO OIL COMPANY			Lease WILCH		Well No. 3E
Unit Letter I	Section 23	Township 29N	Range 8W	County San Juan	
Actual Footage Location of Well: 1770 feet from the South line and 900 feet from the East line					
Ground Level Elev. 6375	Producing Formation Dakota		Pool Basin Dakota		Dedicated Acreage: ± 320 Acres

1. Outline the acreage dedicated to the subject well by colored pencil or hachure marks on the plat below.
2. If more than one lease is dedicated to the well, outline each and identify the ownership thereof (both as to working interest and royalty).
3. If more than one lease of different ownership is dedicated to the well, have the interests of all owners been consolidated by communitization, unitization, force-pooling, etc?

☐ Yes ☐ No If answer is "yes," type of consolidation _____

If answer is "no," list the owners and tract descriptions which have actually been consolidated. (Use reverse side of this form if necessary.) _____

No allowable will be assigned to the well until all interests have been consolidated (by communitization, unitization, forced-pooling, or otherwise) or until a non-standard unit, eliminating such interests, has been approved by the Commission.

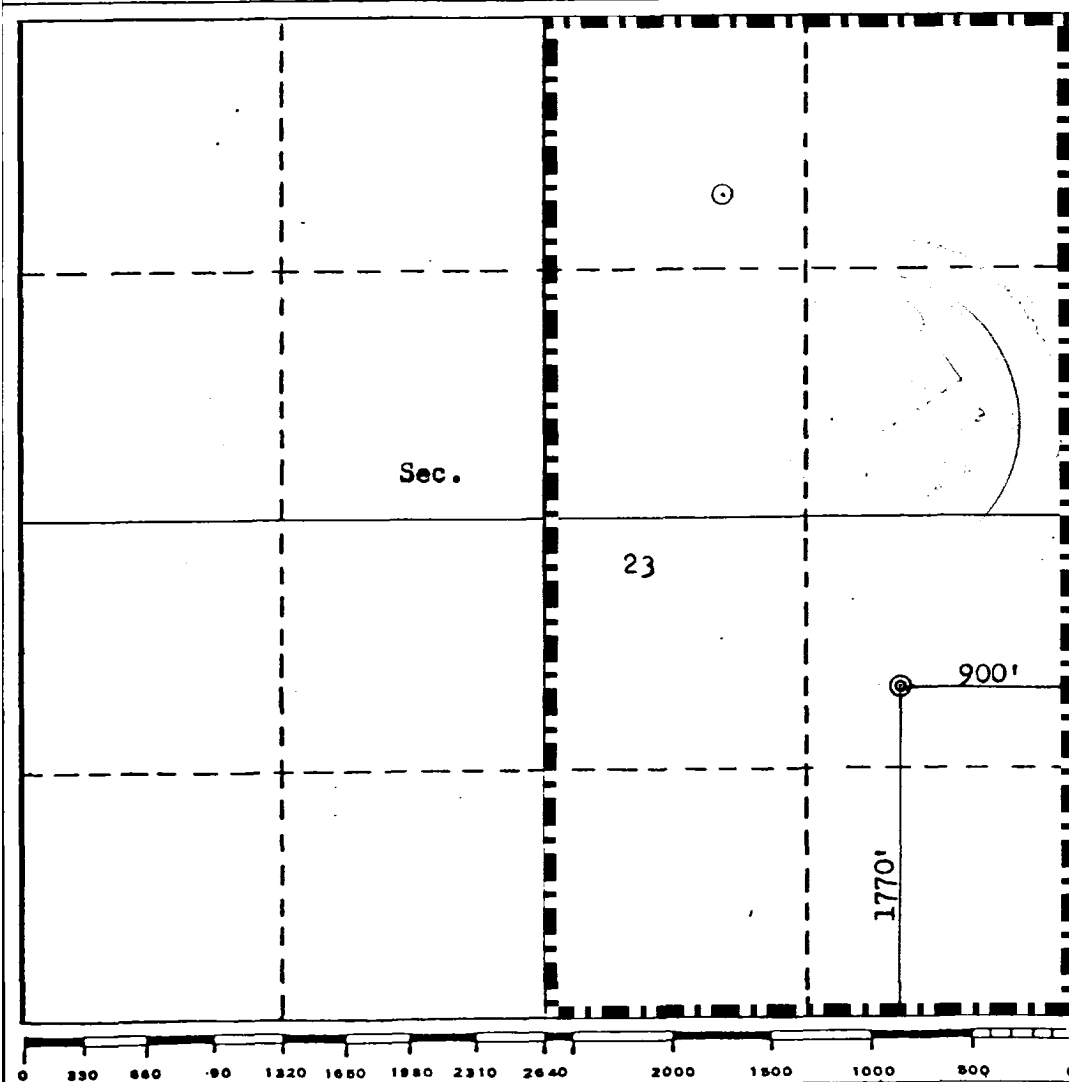

CERTIFICATION

I hereby certify that the information contained herein is true and complete to the best of my knowledge and belief.

Don H. Morrison
Name

Don H. Morrison

Position

Production Analyst

Company

Tenneco Oil Company

Date

November 18, 1981

I hereby certify that the well location shown on this plat was plotted from field notes of actual surveys made by me or under my supervision, and that the same is true and correct to the best of my knowledge and belief.

Date Surveyed

August 24, 1980

Registered Professional Engineer and/or Land Surveyor

Fred B. Kerr, Jr.
Fred B. Kerr, Jr.

Certificate No. **3950**

#6A PCHM

#20A

NWSE 3-28-5

#33A NWSE 13-28

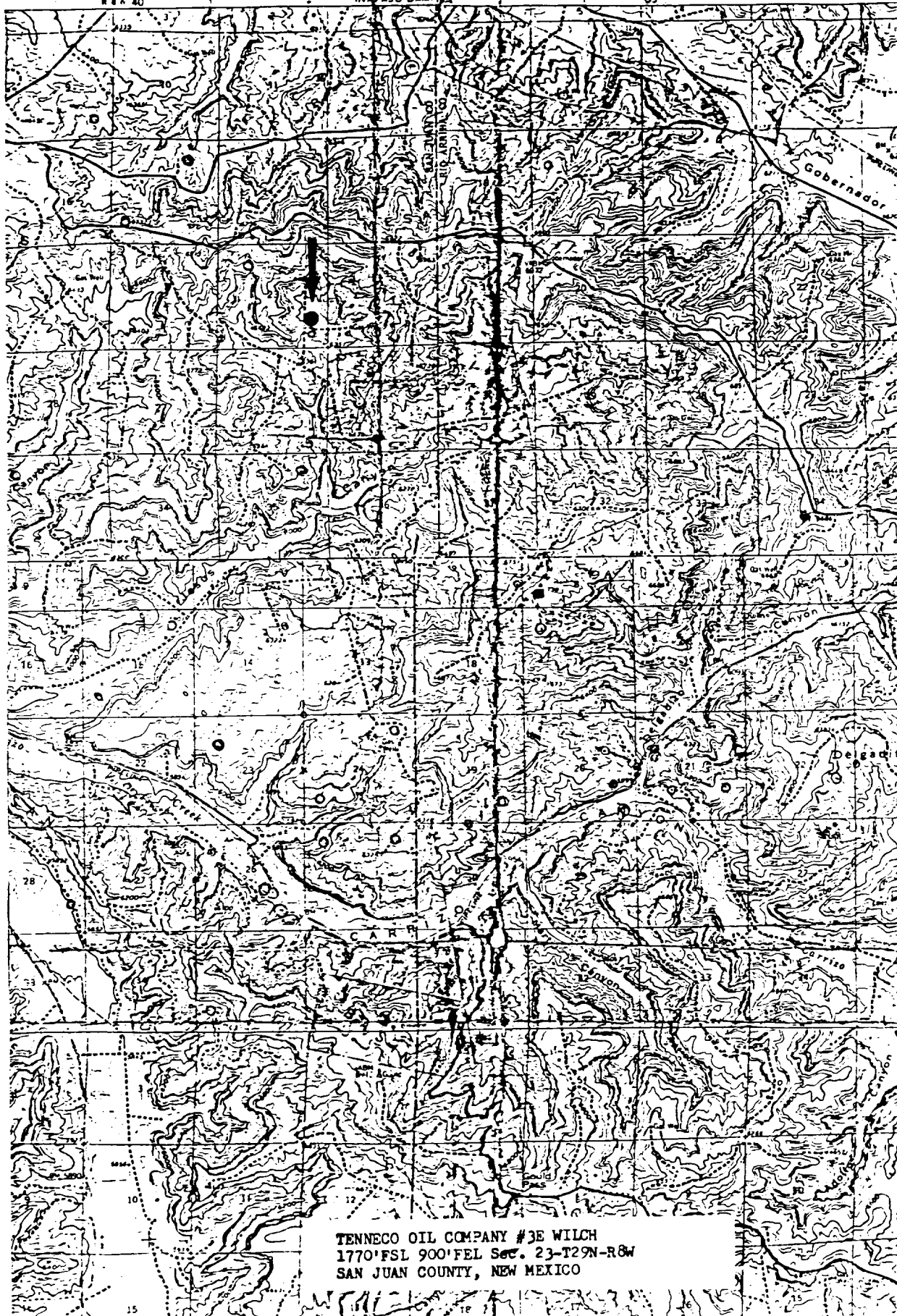

TENNECO OIL COMPANY #3E WILCH
1770' FSL 900' FEL Sec. 23-T29N-R8W
SAN JUAN COUNTY, NEW MEXICO