

UNITED STATES
DEPARTMENT OF THE INTERIOR
GEOLOGICAL SURVEY30-045-26959
5. LEASE DESIGNATION AND SERIAL NO.
SF-078414

6. IF INDIAN, ALLOTTEE OR TRIBE NAME

7. UNIT AGREEMENT NAME

8. FARM OR LEASE NAME

Day + L

9. WELL NO.

A-LS-38

10. FIELD AND POOL, OR WILDCAT

Blanco Mesaverde

11. SEC., T., R., M., OR BLK.
AND SURVEY OR AREA

Sec. 8, T29N, R8W

12. COUNTY OR PARISH

San Juan

13. STATE

NM

APPLICATION FOR PERMIT TO DRILL, DEEPEN, OR PLUG BACK

1a. TYPE OF WORK

DRILL ☒DEEPEN ☐PLUG BACK ☐

b. TYPE OF WELL

OIL
WELL ☐GAS
WELL ☒

OTHER

SINGLE
ZONE ☒MULTIPLE
ZONE ☐

2. NAME OF OPERATOR

Tenneco Oil Company

3. ADDRESS OF OPERATOR

P.O. Box 3249, Englewood, CO 80155

4. LOCATION OF WELL (Report location clearly and in accordance with any State requirements.)*

At surface
790 FNL, 1800' FEL

At proposed prod. zone

Same as above

14. DISTANCE IN MILES AND DIRECTION FROM NEAREST TOWN OR POST OFFICE*

8 Miles East of Blanco, N.M.

15. DISTANCE FROM PROPOSED*

LOCATION TO NEAREST

PROPERTY OR LEASE LINE, FT.

(Also to nearest drlg. unit line, if any)

790'

16. NO. OF ACRES IN LEASE

1692.62

17. NO. OF ACRES ASSIGNED

TO THIS WELL

320

18. DISTANCE FROM PROPOSED LOCATION*

TO NEAREST WELL, DRILLING, COMPLETED,
OR APPLIED FOR, ON THIS LEASE, FT.

248'

19. PROPOSED DEPTH

5802'

20. ROTARY OR CABLE TOOLS

Rotary

21. ELEVATIONS (Show whether DF, RT, GR, etc.)

6467' GL

22. APPROX. DATE WORK WILL START*

June 15, 1988

23.

PROPOSED CASING AND CEMENTING PROGRAM

This action is subject to technical and
procedural review pursuant to 43 CFR 3185.3
and appeal pursuant to 43 CFR 3185.4.

SIZE OF HOLE	SIZE OF CASING	WEIGHT PER FOOT	SETTING DEPTH	QUANTITY OF CEMENT
12 1/4"	9 5/8"	36#	250'	175 sx (206cu.ft.) Cl.B+2%CaCl ₂
8 1/4"	7"	23#	3565'	1st stage 75 sx (131cu.ft.) 65/35/6 POZ
			Tail	100 sx (118cu.ft.) Cl.B
			2nd stage	275 sx (480cu.ft.) 65/35/6 POZ +
				2% CaCl ₂
			Tail	75 sx (89cu.ft.) Cl.B
				215 sx (376cu.ft.) 65/35/6 POZ
			Tail	125 sx (148cu.ft.) Cl.B

64'

4 1/2"

10.5#

5802'

See Attached Drilling Program.

The gas is dedicated.

RECEIVED

JUN 27 1988

OIL CON. DIV.
DIST. 3

IN ABOVE SPACE DESCRIBE PROPOSED PROGRAM: If proposal is to deepen or plug back, give data on present productive zone and proposed new productive zone. If proposal is to drill or deepen directionally, give pertinent data on subsurface locations and measured and true vertical depths. Give blowout preventer program, if any.

24.

SIGNER

Niles V. Jokela

TITLE Staff Analyst

DATE 5/5/88

(This space for Federal or State office use)

PERMIT NO.

APPROVAL DATE

APPROVED BY

TITLE

DATE

CONDITIONS OF APPROVAL, IF ANY:

NEW MEXICO OIL CONSERVATION COMMISSION
WELL LOCATION AND ACREAGE DEDICATION PLAT

Form C-102
Supersedes C-128
Effective 1-4-65

All distances must be from the outer boundaries of the Section.

Operator TENNECO OIL COMPANY		Lease PAY A LS		Well No. 3B /C
Unit Letter B	Section 8	Township 29 N	Range 8 W	County SAN JUAN
Actual Footage 790		Location of Well: North line and 1800 feet from the East line		Dedicated Acreage: 320 Acres
Ground Level Elev. 6467	Producing Formation Blanco Mesaverde		Pool Mesaverde	

1. Outline the acreage dedicated to the subject well by colored pencil or hachure marks on the plat below.
2. If more than one lease is dedicated to the well, outline each and identify the ownership thereof (both as to working interest and royalty).
3. If more than one lease of different ownership is dedicated to the well, have the interests of all owners been consolidated by communitization, unitization, force-pooling, etc?

☐ Yes ☐ No If answer is "yes," type of consolidation _____

If answer is "no," list the owners and tract descriptions which have actually been consolidated. (Use reverse side of this form if necessary.) _____

No allowable will be assigned to the well until all interests have been consolidated (by communitization, unitization, forced-pooling, or otherwise) or until a non-standard unit, eliminating such interests, has been approved by the Commission.

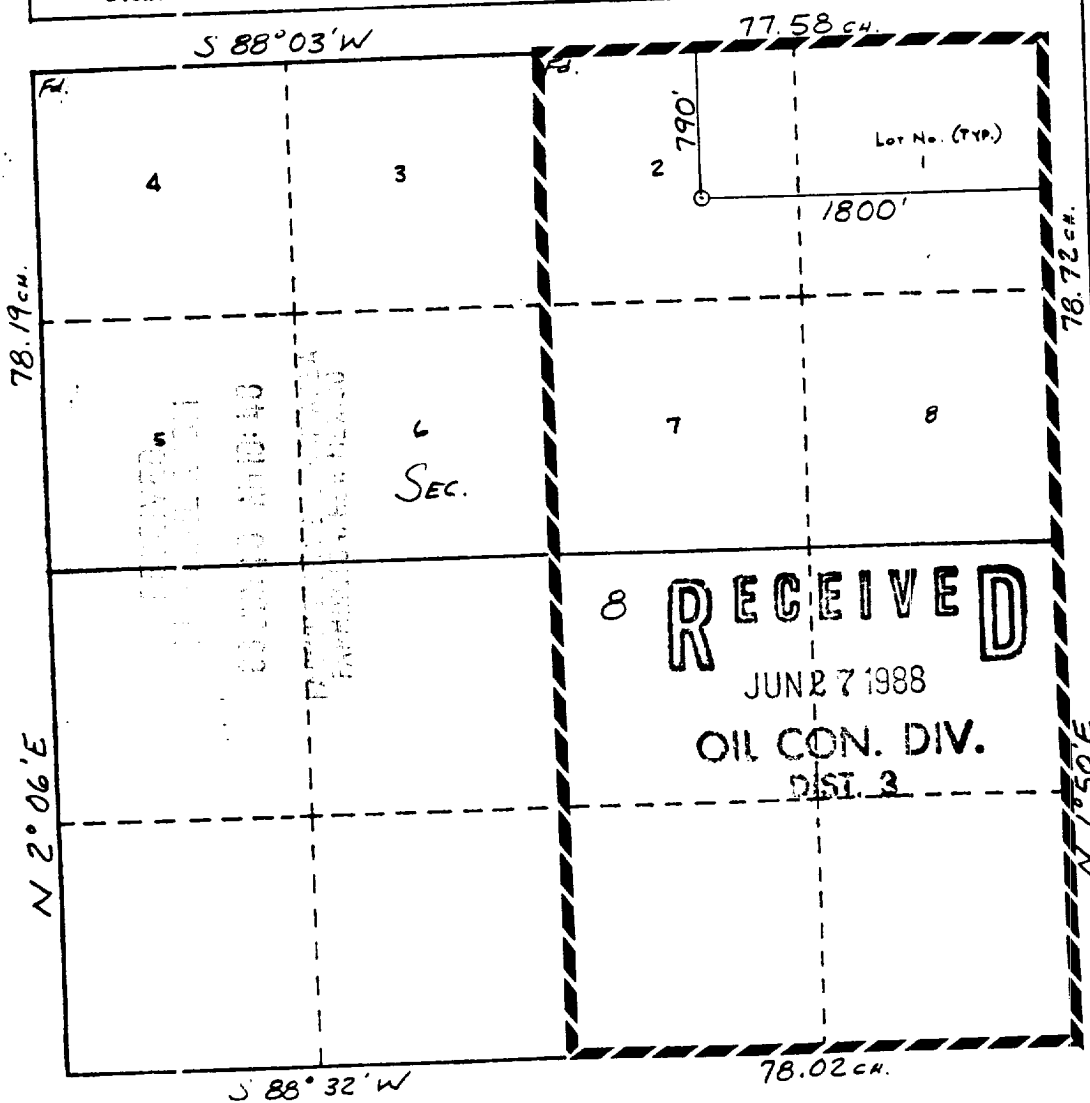

CERTIFICATION

I hereby certify that the information contained herein is true and complete to the best of my knowledge and belief.

Niles V. Jokela

Name **Niles V. Jokela**

Position

Staff Analyst

Company

Tenneco Oil Company

Date

5/5/88

I hereby certify that the well location shown on this plat was plotted from field notes of actual surveys made by me or under my supervision, and that the same is true and correct to the best of my knowledge and belief.

Date Surveyed

WILLIAM E. MAHNE

Registered Professional Engineer and Land Surveyor

Certificate No.

8466

