

UNITED STATES
DEPARTMENT OF THE INTERIOR
GEOLOGICAL SURVEY

30-045-21178

5. LEASE DESIGNATION AND SERIAL NO.

SF 078049

6. IF INDIAN, ALLOTTEE OR TRIBE NAME

7. UNIT AGREEMENT NAME

8. FARM OR LEASE NAME

Hughes A

9. WELL NO.

9

10. FIELD AND POOL, OR WILDCAT

Blanco Pictured Cliffs
Ext.11. SEC., T., R., M., OR BLK.
AND SURVEY OR AREASec. 33, T-29-N, R-8-
NMPM

12. COUNTY OR PARISH

San Juan

13. STATE

New Mexico

APPLICATION FOR PERMIT TO DRILL, DEEPEN, OR PLUG BACK

1a. TYPE OF WORK

DRILL ☒DEEPEN ☐PLUG BACK ☐

b. TYPE OF WELL

OIL
WELL ☐GAS
WELL ☒

OTHER

SINGLE
ZONE ☒MULTIPLE
ZONE ☐

2. NAME OF OPERATOR

El Paso Natural Gas Company

3. ADDRESS OF OPERATOR

PO Box 990, Farmington, NM 87401

4. LOCATION OF WELL (Report location clearly and in accordance with any State requirements.)*
At surface

1580'N, 2207'W

At proposed prod. zone

14. DISTANCE IN MILES AND DIRECTION FROM NEAREST TOWN OR POST OFFICE*

15. DISTANCE FROM PROPOSED*

LOCATION TO NEAREST
PROPERTY OR LEASE LINE, FT.
(Also to nearest drlg. unit line, if any)

16. NO. OF ACRES IN LEASE

17. NO. OF ACRES ASSIGNED
TO THIS WELL

160

18. DISTANCE FROM PROPOSED LOCATION*
TO NEAREST WELL, DRILLING, COMPLETED,
OR APPLIED FOR, ON THIS LEASE, FT.

19. PROPOSED DEPTH

3000'

20. ROTARY OR CABLE TOOLS

Rotary

21. ELEVATIONS (Show whether DF, RT, GR, etc.)

6322'GR

22. APPROX. DATE WORK WILL START*

23.

PROPOSED CASING AND CEMENTING PROGRAM

SIZE OF HOLE	SIZE OF CASING	WEIGHT PER FOOT	SETTING DEPTH	QUANTITY OF CEMENT
12 1/4"	8 5/8"	24.0#	300'	261 cu. ft. to circulate
6 3/4"	2 7/8"	6.4#	3000'	351 cu. ft. to cover the Ojo

Selectively perforate and sandwater fracture the Pictured Cliffs formation.

The NW/4 Section 33 is dedicated to this well.

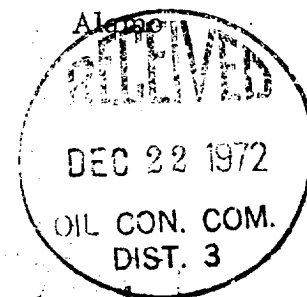

DEC 21 1972

U. S. GEOLOGICAL SURVEY
FARMINGTON, N.M.

IN ABOVE SPACE DESCRIBE PROPOSED PROGRAM: If proposal is to deepen or plug back, give data on present productive zone and proposed new productive zone. If proposal is to drill or deepen directionally, give pertinent data on subsurface locations and measured and true vertical depths. Give blowout preventer program, if any.

24. SIGNED [Signature] TITLE Petroleum Engineer DATE December 20, 1972

(This space for Federal or State office use)

PERMIT NO.

APPROVAL DATE

APPROVED BY [Signature]

TITLE

DATE

CONDITIONS OF APPROVAL, IF ANY:

Hold @ 100 for NSC

*See Instructions On Reverse Side

NEW MEXICO OIL CONSERVATION COMMISSION
WELL LOCATION AND ACREAGE DEDICATION PLAT

Form O-102
Supersedes O-128
Effective 1-1-65

All distances must be from the outer boundaries of the Section

Operator EL PASO NATURAL GAS COMPANY		Lease HUGHES A		(SF-078049)		Well No. 9
Unit Letter F	Section 33	Township 29-N	Range 8-W	County SAN JUAN		
Actual Well Location of Well:						
1530		feet from the NORTH line and		2207		feet from the WEST line
Ground Level Elev. 6322	Firm Name of Owner PICTURED CLIFFS		Pool BLANCO PICTURED CLIFFS EXT.		Dedicated Acreage 160.00	

1. Outline the acreage dedicated to the subject well by colored pencil or hachure marks on the plat below.
2. If more than one lease is dedicated to the well, outline each and identify the ownership thereof (working interest and royalty).
3. If more than one lease of different ownership is dedicated to the well, have the interests of all owners been consolidated by communitization, unitization, force-pooling, etc?

☐ Yes ☐ No If answer is "yes," type of consolidation _____

If answer is "no," list the owners and tract descriptions which have actually been consolidated. (Use reverse side of this form if necessary.) _____

No allowable will be assigned to the well until all interests have been consolidated (by communitization, unitization, forced-pooling, or otherwise) or until a non-standard unit, eliminating such interests, has been approved by the Commission.

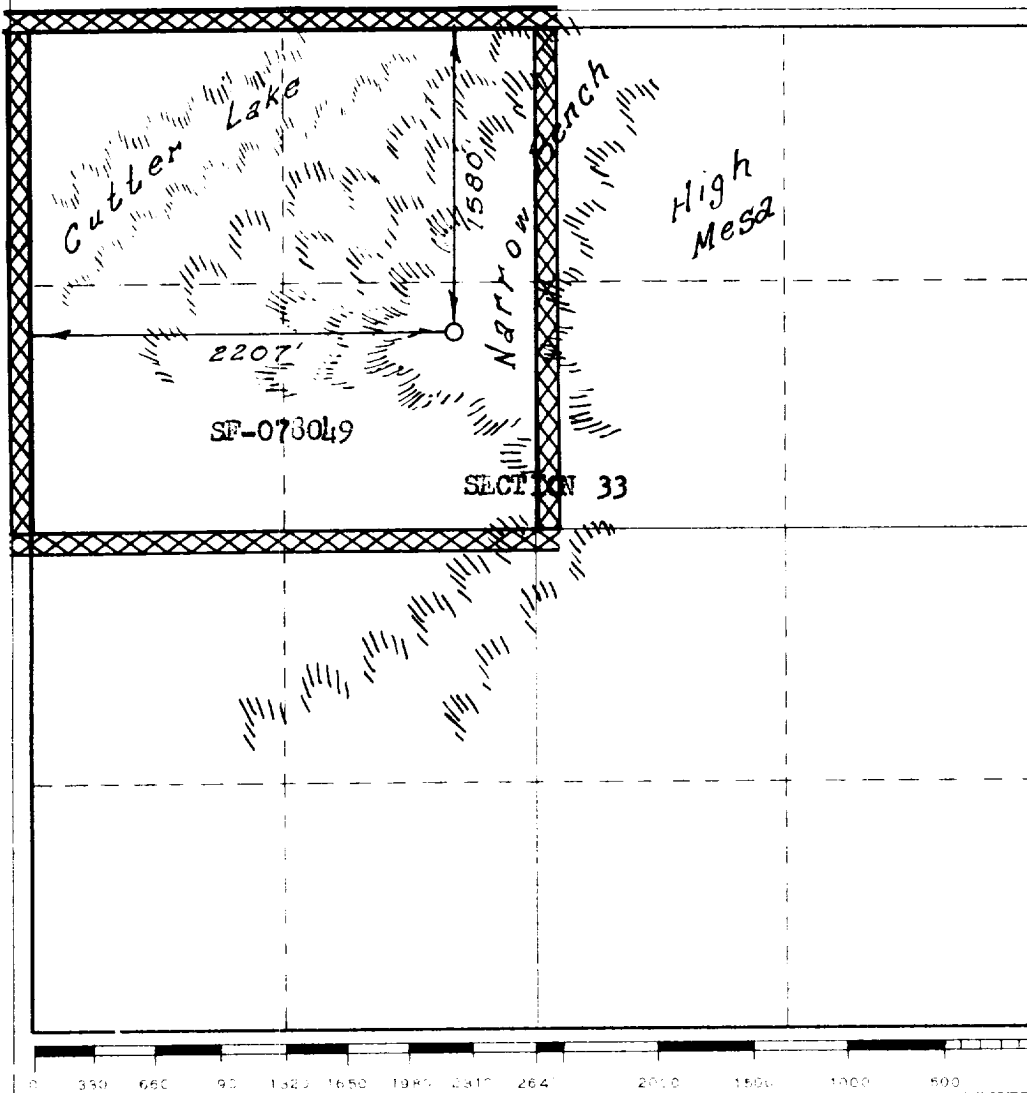

CERTIFICATION

I hereby certify that the information contained herein is true and complete to the best of my knowledge and belief.

Original Signed By:

Name **L. O. Van Ryan**
Petroleum Engineer

Position
El Paso Natural Gas Company

Company
December 20, 1972

Date

I hereby certify that the well location shown on this plat was plotted from field notes of actual surveys made by me or under my supervision, and that the same is true and correct to the best of my knowledge and belief.

Date
DECEMBER 6, 1972

Signature of Surveyor

Well No. **1760**

R 8 W

EL PASO NATURAL GAS

EL PASO NATURAL GAS

PUBCO PETR.

EL PASO NATURAL GAS

T
29
N

3 (PC)

2207'

(PC)

1580'

9

33

DEC 21 1972

U. S. GEOLOGICAL SURVEY
FARMINGTON, N.M.

PICTURED CLIFFS OWNERSHIP

Offsetting E.P.N.G. # 9 HUGHES 'A' 33-29N-8W
San Juan Co., New Mexico

SCALE : 3" = 1 mile

DATE: 12/19/72

DRAWN BY: J.L.H.