

OIL CONSERVATION COMMISSION
Aztec DISTRICT

OIL CONSERVATION COMMISSION
BOX 2088
SANTA FE, NEW MEXICO

DATE 12/22/72

Re: Proposed NSP _____

Proposed NWU _____

Proposed NSL XXX

Proposed NFO _____

Proposed MC _____

Gentlemen:

I have examined the application dated December 19, 1972

for the El Paso Natural Gas Co. Hughes A #9 F-33-29N-8W
Operator Lease and Well No. S-T-R

and my recommendations are as follows:

Approve

Yours very truly,

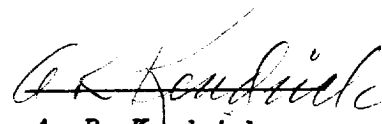
A. R. Kendrick

El Paso Natural Gas Company

El Paso, Texas 79999

December 19, 1972

ADDRESS REPLY TO
POST OFFICE BOX 990
FARMINGTON, NEW MEXICO 87401

Mr. A. L. Porter, Secretary & Director
New Mexico Oil Conservation Commission
Post Office Box 2088
Santa Fe, New Mexico 87501



Dear Mr. Porter:

This is a request for administrative approval for an unorthodox gas well in the Blanco Pictured Cliffs pool.

It is intended to locate the El Paso Natural Gas Company Hughes A #9 1580' from the North line and 2207' from the West line of Section 33, T-29-N, R-8-W, NMPM, San Juan County, New Mexico. The Northwest quarter of Section 33 is dedicated to this well.

A portion of the Northwest quarter of Section 33 is below the high water level of Cutter Lake, making an orthodox well location impossible.

All operators of proration units offsetting the proposed unorthodox location have been notified of this application by certified mail.

Plats showing the proposed well location with terrain features and ownership of offset leases are attached.

Yours truly,

A handwritten signature in cursive script that reads "L. O. Van Ryan".

L. O. Van Ryan
Senior Petroleum Engineer

LOVR:pb

cc: Emery Arnold w/attachments ←

J. Permenter w/attachments

P. T. McGrath w/attachments

UNITED STATES
DEPARTMENT OF THE INTERIOR
GEOLOGICAL SURVEY

APPLICATION FOR PERMIT TO DRILL, DEEPEN, OR PLUG BACK

1a. TYPE OF WORK DRILL <input checked="" type="checkbox"/> DEEPEN <input type="checkbox"/> PLUG BACK <input type="checkbox"/>		5. LEASE DESIGNATION AND SERIAL NO. SF 078049
b. TYPE OF WELL OIL WELL <input type="checkbox"/> GAS WELL <input checked="" type="checkbox"/> OTHER <input type="checkbox"/> SINGLE ZONE <input checked="" type="checkbox"/> MULTIPLE ZONE <input type="checkbox"/>		6. IF INDIAN, ALLOTTEE OR TRIBE NAME
2. NAME OF OPERATOR El Paso Natural Gas Company		7. UNIT AGREEMENT NAME
3. ADDRESS OF OPERATOR PO Box 990, Farmington, NM 87401		8. FARM OR LEASE NAME Hughes A
4. LOCATION OF WELL (Report location clearly and in accordance with any State requirements.)* At surface 1580'N, 2207'W At proposed prod. zone		9. WELL NO. 9
14. DISTANCE IN MILES AND DIRECTION FROM NEAREST TOWN OR POST OFFICE*		10. FIELD AND POOL, OR WILDCAT Blanco Pictured Cliffs Ext.
15. DISTANCE FROM PROPOSED* LOCATION TO NEAREST PROPERTY OR LEASE LINE, FT. (Also to nearest drilg. unit line, if any)		11. SEC., T., R., M., OR BLK. AND SURVEY OR AREA Sec. 33, T-29-N, R-8-W NMPM
16. NO. OF ACRES IN LEASE		12. COUNTY OR PARISH San Juan
17. NO. OF ACRES ASSIGNED TO THIS WELL 160		13. STATE New Mexico
18. DISTANCE FROM PROPOSED LOCATION* TO NEAREST WELL, DRILLING, COMPLETED, OR APPLIED FOR, ON THIS LEASE, FT.		20. ROTARY OR CABLE TOOLS Rotary
19. PROPOSED DEPTH 3000'		22. APPROX. DATE WORK WILL START*
21. ELEVATIONS (Show whether DF, RT, GR, etc.) 6322'GR		

23. PROPOSED CASING AND CEMENTING PROGRAM

SIZE OF HOLE	SIZE OF CASING	WEIGHT PER FOOT	SETTING DEPTH	QUANTITY OF CEMENT
12 1/4"	8 5/8"	24.0#	300'	261 cu.ft. to circulate
6 3/4"	2 7/8"	6.4#	3000'	351 cu.ft. to cover the Ojo
				Alamo

Selectively perforate and sandwater fracture the Pictured Cliffs formation.

The NW/4 Section 33 is dedicated to this well.

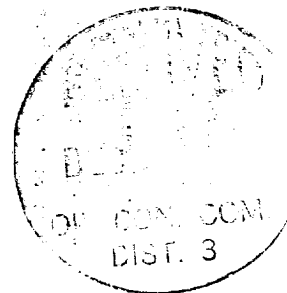

IN ABOVE SPACE DESCRIBE PROPOSED PROGRAM: If proposal is to deepen or plug back, give data on present productive zone and proposed new productive zone. If proposal is to drill or deepen directionally, give pertinent data on subsurface locations and measured and true vertical depths. Give blowout preventer program, if any.

24. SIGNED [Signature] TITLE Petroleum Engineer DATE December 20, 1972
(This space for Federal or State office use)

PERMIT NO. _____ APPROVAL DATE _____

APPROVED BY _____ TITLE _____ DATE _____
CONDITIONS OF APPROVAL, IF ANY:

**NEW MEXICO OIL CONSERVATION COMMISSION
WELL LOCATION AND ACREAGE DEDICATION PLAT**

Form C-102
Supersedes C-128
Effective 1-1-65

All distances must be from the outer boundaries of the Section

PASO NATURAL GAS COMPANY		HUGHES A		(SF-073049)		Well No. 9	
Section 33		T. and R. 29-N		Range 8-W		County SAN JUAN	
The Location of Well: 1530 feet from the NORTH line and 2207 feet from the WEST line. Section Elev. 6322 Producers PICTURED CLIFFS Pool BLANCO PICTURED CLIFFS EXT. Deductible Acreage: 160.00 Acres							

1. Outline the acreage dedicated to the subject well by colored pencil or hachure marks on the plat below.
2. If more than one lease is dedicated to the well, outline each and identify the ownership thereof (both as to working interest and royalty).
3. If more than one lease of different ownership is dedicated to the well, have the interests of all owners been consolidated by communitization, unitization, force-pooling, etc?

☐ Yes ☐ No If answer is "yes," type of consolidation _____

If answer is "no," list the owners and tract descriptions which have actually been consolidated. (Use reverse side of this form if necessary.) _____

No allowable will be assigned to the well until all interests have been consolidated (by communitization, unitization, forced-pooling, or otherwise) or until a non-standard unit, eliminating such interests, has been approved by the Commission.

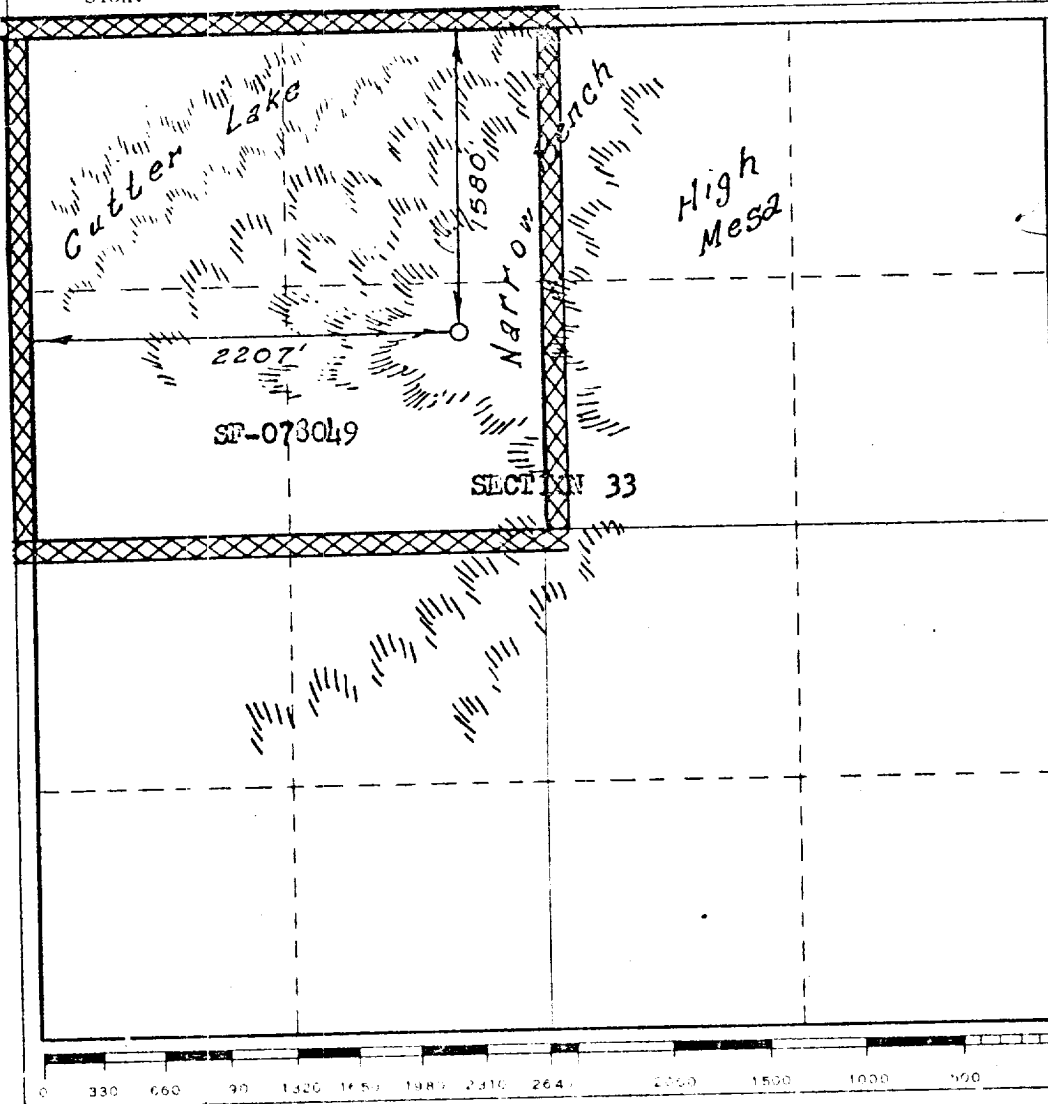
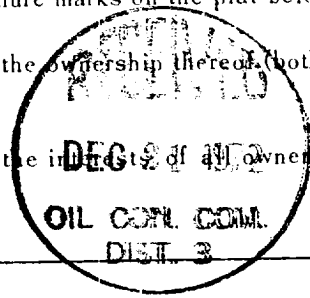

CERTIFICATION

I hereby certify that the information contained herein is true and complete to the best of my knowledge and belief.

Name _____
 Position **Petroleum Engineer**
 Company **El Paso Natural Gas Co.**
 Date **December 20, 1972**

I hereby certify that the well location shown on this plat was plotted from field notes of actual surveys made by me or under my supervision, and that the same is true and correct to the best of my knowledge and belief.

Date of Survey **DECEMBER 6, 1972**

Surveyed by _____
 and _____
 Licensed Surveyors

Plat No. **1760**

R 8 W

EL PASO NATURAL GAS

EL PASO NATURAL GAS

PUBCO PETR.

EL PASO NATURAL GAS

T
29
N

☼ 3 (PC)

2207'

(PC) 9

1580'

33

PICTURED CLIFFS OWNERSHIP

Offsetting E.P.N.G. #9 HUGHES 'A' 33-29N-8W
San Juan Co., New Mexico

SCALE: 3" = 1 mile

DATE: 12/19/72

DRAWN BY J.L.H.