

UNITED STATES  
DEPARTMENT OF THE INTERIOR  
BUREAU OF LAND MANAGEMENT

APPLICATION FOR PERMIT TO DRILL, DEEPEN, OR PLUG BACK

1a. TYPE OF WORK  
DRILL ☒ DEEPEN ☐ PLUG BACK ☐  
b. TYPE OF WELL  
OIL WELL ☐ GAS WELL ☒ OTHER ☐ SINGLE ZONE ☒ MULTIPLE ZONE ☐  
2. NAME OF OPERATOR  
Robert L. Bayless  
3. ADDRESS OF OPERATOR  
P.O. Box 168, Farmington, NM 87499  
4. LOCATION OF WELL (Report location clearly and in accordance with any State requirements.\*)  
At surface  
1775' FSL & 1290' FWL  
At proposed prod. zone  
Same  
14. DISTANCE IN MILES AND DIRECTION FROM NEAREST TOWN OR POST OFFICE\*

5. LEASE DESIGNATION AND SERIAL NO.  
SF - 076337  
6. IF INDIAN, ALLOTTEE OR TRIBE NAME  
7. UNIT AGREEMENT NAME  
8. FARM OR LEASE NAME  
Santa Rosa 17  
9. WELL NO.  
XP-2  
10. FIELD AND POOL, OR WILDCAT  
Basin Fruitland Coal  
11. SEC., T., R., M., OR BLK.  
AND SURVEY OR AREA  
Section 17, T29 N, R9 W  
12. COUNTY OR PARISH  
San Juan  
13. STATE  
NM

15. DISTANCE FROM PROPOSED\*  
LOCATION TO NEAREST  
PROPERTY OR LEASE LINE, FT.  
(Also to nearest drlg. unit line, if any)  
16. NO. OF ACRES IN LEASE  
2449.35  
17. NO. OF ACRES ASSIGNED  
TO THIS WELL  
5/320  
18. DISTANCE FROM PROPOSED LOCATION\*  
TO NEAREST WELL, DRILLING, COMPLETED,  
OR APPLIED FOR, ON THIS LEASE, FT.  
19. PROPOSED DEPTH  
2190'  
20. ROTARY OR CABLE TOOLS  
0 - TD  
21. ELEVATIONS (Show whether DF, RT, GR, etc.)  
5648' GL 5658' RKB  
22. APPROX. DATE WORK WILL START\*  
ASAP  
This action is subject to technical and  
procedural review pursuant to 43 CFR 3165.3  
and appeal pursuant to 43 CFR 3165.4.

23. PROPOSED CASING AND CEMENTING PROGRAM

SIZE OF HOLE	SIZE OF CASING	WEIGHT PER FOOT	SETTING DEPTH
12-1/4"	8-5/8"	24.0#	120'
7-7/8"	4-1/2"	10.5#	2190'

DRILLING OPERATIONS AUTHORIZED ARE  
SUBJECT TO COMPLIANCE WITH ATTACHED  
"GENERAL REQUIREMENTS"  
90 sx Class B (106 ft<sup>3</sup>)  
500 sx assorted cements-see long-  
string cementing guidelines for  
details

Will drill 12-1/4" hole to 120' and set 120' of 8-5/8" 24.0 #/ft J-55 used casing, cementing with 106 ft<sup>3</sup> Class B cement, circulated to surface. Will drill 7-7/8" hole to 2190' and run 2190' of 4-1/2" 10.5 #/ft J-55 new casing and cement as per attached longstring cementing guidelines. Circulating medium while drilling will be clear water, natural mud and waterloss control additives. No abnormal pressures or temperatures are anticipated. Will run Induction and Density Logs. Blowout preventer and safety equipment schematics are attached. The gas from this formation is not dedicated to a gas contract.

ESTIMATED TIPS: Ojo Alamo - 925'  
Kirtland - 1073'  
Fruitland - 1740'  
Pictured Cliffs - 2108'  
Total Depth - 2190'

RECEIVED  
JUL 2 1990

"Approved for lease by BLM" (Stamp)  
NOT WORKING (Stamp)  
holds lease (Stamp)  
IN ABOVE SPACE DESCRIBE PROPOSED PROGRAM: If proposal is to deepen or plug back, give data on present productive zone. If proposal is to drill or deepen directionally, give pertinent data on subsurface locations and measured and true vertical depths. Give blowout preventer program, if any.

OIL CON. DIV.  
DIST. 3

24. SIGNED Kevin H. McCord TITLE Petroleum Engineer DATE 6-1-90  
(This space for Federal or State office use)

PERMIT NO. \_\_\_\_\_ APPROVAL DATE \_\_\_\_\_  
APPROVED BY \_\_\_\_\_ TITLE \_\_\_\_\_  
CONDITIONS OF APPROVAL, IF ANY:

APPROVED  
AS AMENDED  
DATE

JUN 27 1990

Ken Townsend

NMOCD

\*See Instructions On Reverse Side

FOR AREA MANAGER

Title 18 U.S.C. Section 1001, makes it a crime for any person knowingly and willfully to make to any department or agency of the United States any false, fictitious or fraudulent statements or representations as to any matter within its jurisdiction.

Submit to Appropriate  
District Office  
State Lease - 4 copies  
Fee Lease - 3 copies

State of New Mexico  
Energy, Minerals and Natural Resources Department

Form C-182  
Revised 1-1-89

OIL CONSERVATION DIVISION

P.O. Box 2088  
Santa Fe, New Mexico 87504-2088

DISTRICT I  
P.O. Box 1980, Hobbs, NM 88240

DISTRICT II  
P.O. Drawer DD, Artesia, NM 88210

DISTRICT III  
1000 Rio Brazos Rd., Aztec, NM 87410

WELL LOCATION AND ACREAGE DEDICATION PLAT

All Distances must be from the outer boundaries of the section

Operator BAYLESS MINERALS, INC.			Lease SANTA ROSA 17		Well No. 17-2
Unit Letter L	Section 17	Township 28 N	Range 9 W	County San Juan	
Actual Footage Location of Well: 1775 feet from the South line and 1290 feet from the West line					
Ground level Elev. 5648	Producing Formation Fruitland Coal		Pool Basin Fruitland Coal	Dedicated Acreage: 320 Acres	

- Outline the acreage dedicated to the subject well by colored pencil or hatchure marks on the plat below.
- If more than one lease is dedicated to the well, outline each and identify the ownership thereof (both as to working interest and royalty).
- If more than one lease of different ownership is dedicated to the well, have the interest of all owners been consolidated by communitization, unitization, force-pooling, etc.?  
☐ Yes ☐ No If answer is "yes" type of consolidation \_\_\_\_\_  
If answer is "no" list the owners and tract descriptions which have actually been consolidated. (Use reverse side of this form if necessary.) \_\_\_\_\_  
No allowable will be assigned to the well until all interests have been consolidated (by communitization, unitization, forced-pooling, or otherwise) or until a non-standard unit, eliminating such interest, has been approved by the Division.

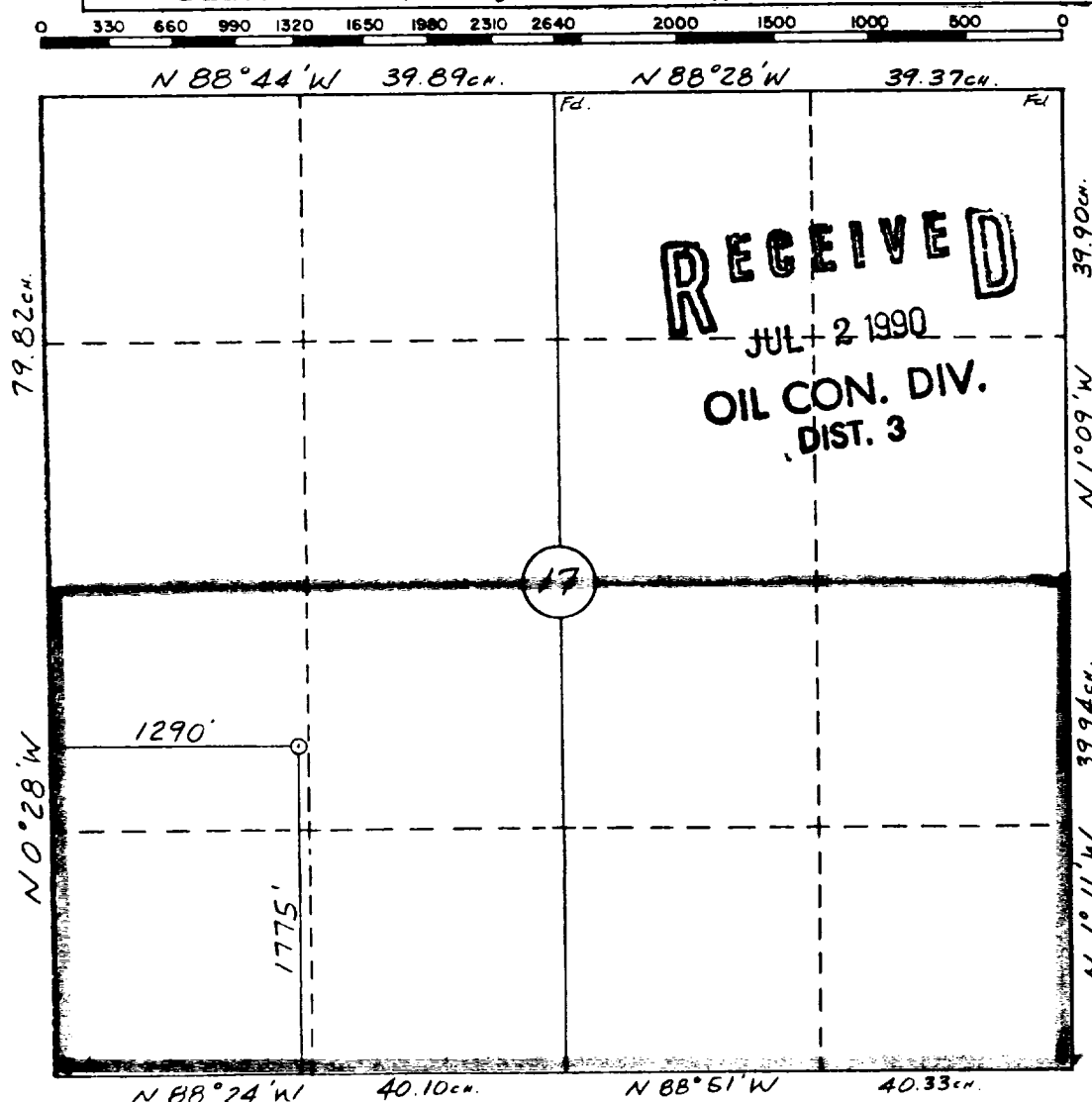

OPERATOR CERTIFICATION

I hereby certify that the information contained herein is true and complete to the best of my knowledge and belief.

Signature  
Kevin H. McCord  
Printed Name  
Kevin H. McCord  
Position  
Petroleum Engineer  
Company  
Bayless Minerals, Inc.  
Date

SURVEYOR CERTIFICATION

I hereby certify that the well location shown on this plat was plotted from field notes of actual surveys made by me or under my supervision, and that the same is true and correct to the best of my knowledge and belief.

5-7-90

Date Surveyed  
William E. Mahnke II

Signature & Seal of  
Professional Surveyor

WILLIAM E. MAHNKE II  
NEW MEXICO  
#8466  
REGISTERED PROFESSIONAL LAND SURVEYOR

Certificate No.  
8466

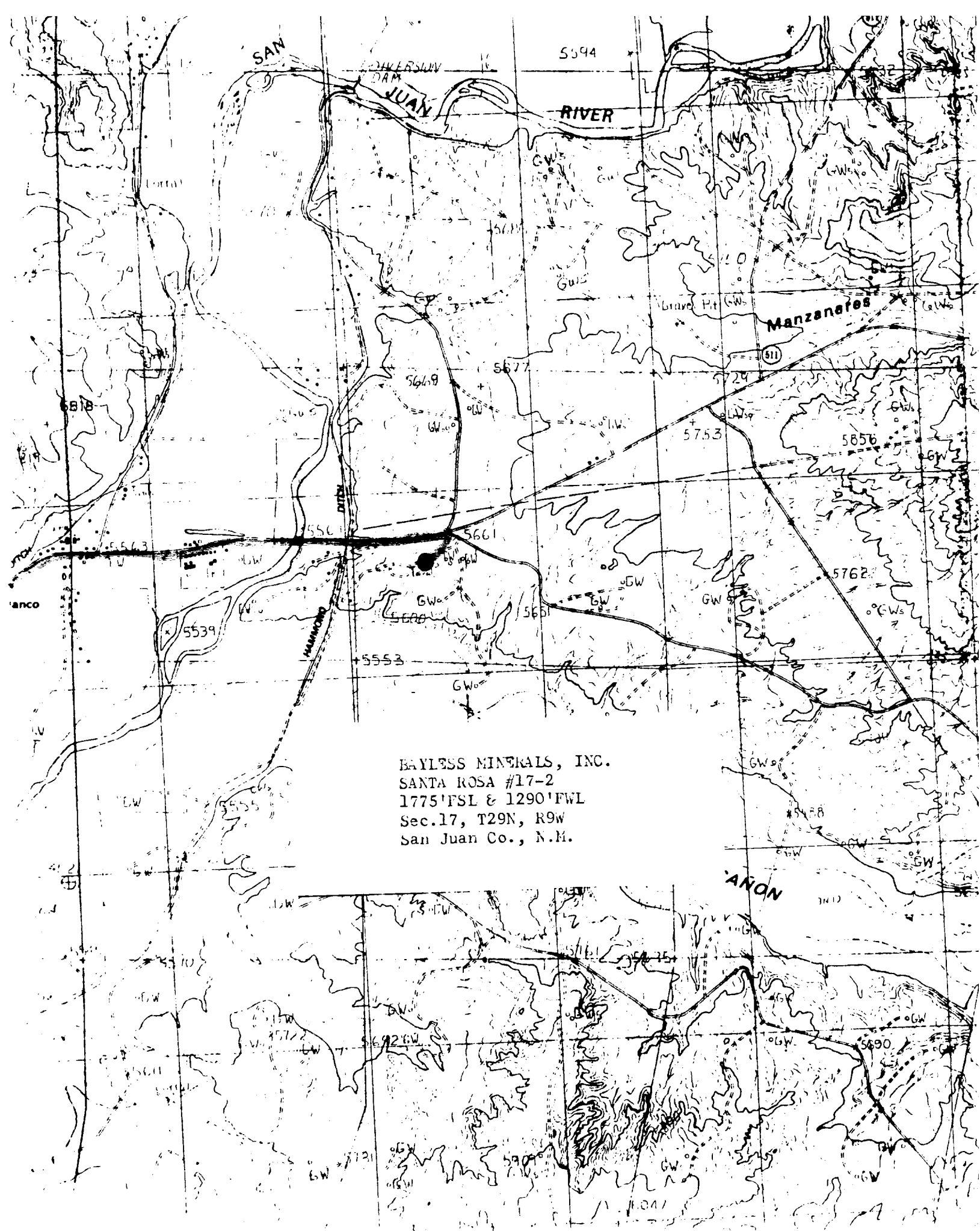

BAYLESS MINERALS, INC.  
SANTA ROSA #17-2  
1775' FSL & 1290' FWL  
Sec. 17, T29N, R9W  
San Juan Co., N.M.