

COPY TO O. C. C.

(SUBMIT IN TRIPLICATE)

UNITED STATES  
DEPARTMENT OF THE INTERIOR  
GEOLOGICAL SURVEY

Land Office Santa Fe

Lease No. 24139

Unit San Juan Unit 30-6

SUNDRY NOTICES AND REPORTS ON WELLS

NOTICE OF INTENTION TO DRILL.....	<input checked="" type="checkbox"/>	SUBSEQUENT REPORT OF WATER SHUT-OFF.....	
NOTICE OF INTENTION TO CHANGE PLANS.....		SUBSEQUENT REPORT OF SHOOTING OR ACIDIZING.....	
NOTICE OF INTENTION TO TEST WATER SHUT-OFF.....		SUBSEQUENT REPORT OF ALTERING CASING.....	
NOTICE OF INTENTION TO RE-DRILL OR REPAIR WELL.....		SUBSEQUENT REPORT OF REDRILLING OR REPAIR.....	
NOTICE OF INTENTION TO SHOOT OR ACIDIZE.....		SUBSEQUENT REPORT OF ABANDONMENT.....	
NOTICE OF INTENTION TO PULL OR ALTER CASING.....		SUPPLEMENTARY WELL HISTORY.....	
NOTICE OF INTENTION TO ABANDON WELL.....			

(INDICATE ABOVE BY CHECK MARK NATURE OF REPORT, NOTICE, OR OTHER DATA)

January 13, 1953

Well No. 5-35 is located 990 ft. from [S] line and 1650 ft. from [W] line of sec. \_\_\_\_\_

SE/4 SE/4 Sec. 35 30N 6E N. M. P. M.  
(1/4 Sec. and Sec. No.) (Twp.) (Range) (Meridian)  
Blanco Albarras County New Mexico  
(Field) (County or Subdivision) (State or Territory)

The elevation of the derrick floor above sea level is \_\_\_\_\_ ft.

DETAILS OF WORK

(State names of and expected depths to objective sands; show sizes, weights, and lengths of proposed casings; indicate mudding jobs, cementing points, and all other important proposed work)

Propose to drill to approximately 5000' using mud. Set casing at top of pay. Mesa Verde will be drilled with gas and cleaned out with gas after shot. Rotary tools will be used to TD.

Proposed Casings:

Set 10-3/4" casing at 150' and cement to surface with approximately 200 sacks.  
Set 7" casing at top of pay and cement with approximately 200 sacks.

Location plat attached.

I understand that this plan of work must receive approval in writing by the Geological Survey before operations may be commenced.

Company Phillips Petroleum Company

Address P.O. Box 939

Agua, New Mexico

By Carl Stume

Title District Superintendent



Company Phillips Petroleum Company

Lease Mesa Unit 30-6 Well No. 5-35

Sec. 35, T. 30 N., R. 6 W., N.M.P.M.

Location 990' from the South line and 1650' from the West line.

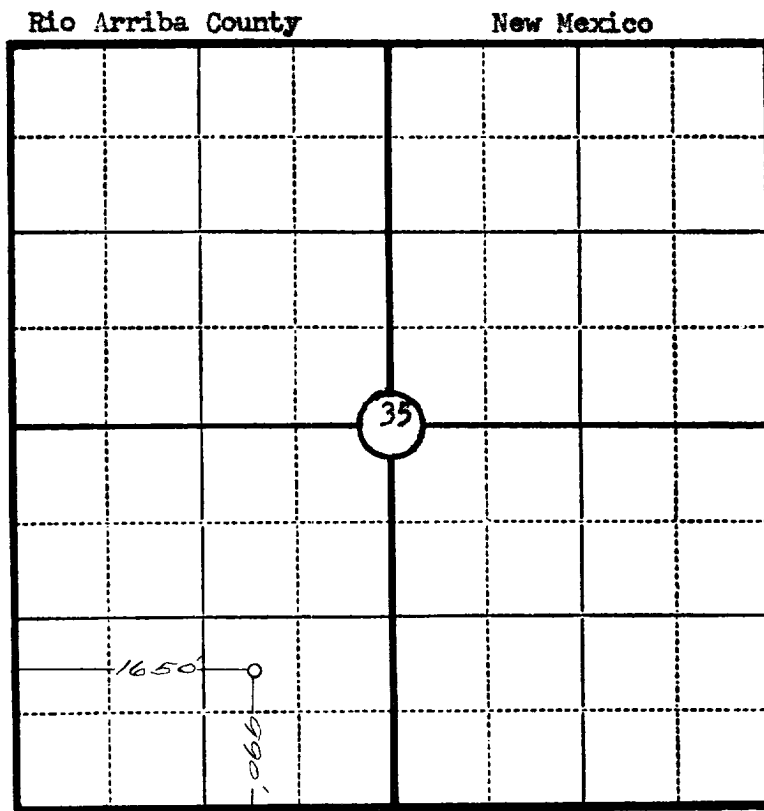

Scale—4 inches equal 1 mile.

This is to certify that the above plat was prepared from field notes of actual surveys made by me or under my supervision and that the same are true and correct to the best of my knowledge and belief.

Seal:

Registered Professional  
Engineer and Land Surveyor.

Charles J. Finklea  
N. Mex. Reg. No. 1302

Surveyed January 17, 1953