

(SUBMIT IN TRIPLICATE)

Land Office Santa Fe

Lease No. 080712-A

UNITED STATES
DEPARTMENT OF THE INTERIOR
GEOLOGICAL SURVEY

Unit W 1/2 Sec. 29

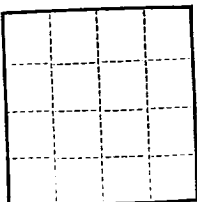

SUNDRY NOTICES AND REPORTS ON WELLS

MAY 11 1953

NOTICE OF INTENTION TO DRILL	<input checked="" type="checkbox"/>	SUBSEQUENT REPORT OF WATER SHUT-OFF	
NOTICE OF INTENTION TO CHANGE PLANS		SUBSEQUENT REPORT OF SHOOTING OR ACIDIZING	
NOTICE OF INTENTION TO TEST WATER SHUT-OFF		SUBSEQUENT REPORT OF ALTERING CASING	
NOTICE OF INTENTION TO RE-DRILL OR REPAIR WELL		SUBSEQUENT REPORT OF RE-DRILLING OR REPAIR	
NOTICE OF INTENTION TO SHOOT OR ACIDIZE		SUBSEQUENT REPORT OF ABANDONMENT	
NOTICE OF INTENTION TO PULL OR ALTER CASING		SUPPLEMENTARY WELL HISTORY	
NOTICE OF INTENTION TO ABANDON WELL			

(INDICATE ABOVE BY CHECK MARK NATURE OF REPORT, NOTICE, OR OTHER DATA)

May 8, 1953

Well No. 8 is located 715 ft. from INT line and 715 ft. from E line of sec. 29

SW 1/4 of Sec. 29 (1/4 Sec. and Sec. No.) 30N (Twp.) 6W (Range) N 1/2 P M (Meridian)
Blanco (Field) Rio Arriba (County or Subdivision) New Mexico (State or Territory)

The elevation of the G.L. derrick floor above sea level is 6850.3 ft.

DETAILS OF WORK

(State names of and expected depths to objective sands; show sizes, weights, and lengths of proposed casings; indicate mudding jobs, cementing points, and all other important proposed work)

Set 13 3.8" 48# casing at 260' - will circulate cement. Set 7" 20# casing at 5000', cement with 200 sax. Will drill Mesa Verde with gas. Total Depth ~~5100'~~ will be approximately 5700'. Top of Mesa Verde expected at approximately 5100'. Schlumberger to be run before setting 7" casing.

I understand that this plan of work must receive approval in writing by the Geological Survey before operations may be commenced.

Company Barron Kidd
Address 306 First National Bk. Bldg.
Midland, Texas

By Emory T. Carberry
Title Agent

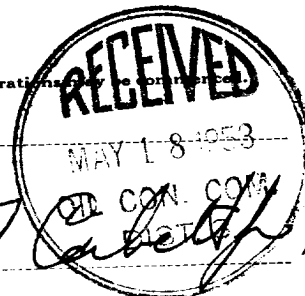

Company Baron Kidd

Lease _____ Well No. 8

Sec. 29 T. 30 N., R. 6 W., N.M.L.M.

Location 715' from the South line and 715' from
the West line.

RECEIVED

MAY 11 1953

U. S. GEOLOGICAL SURVEY
FARMINGTON, N. M.

Bio Arriba County

New Mexico

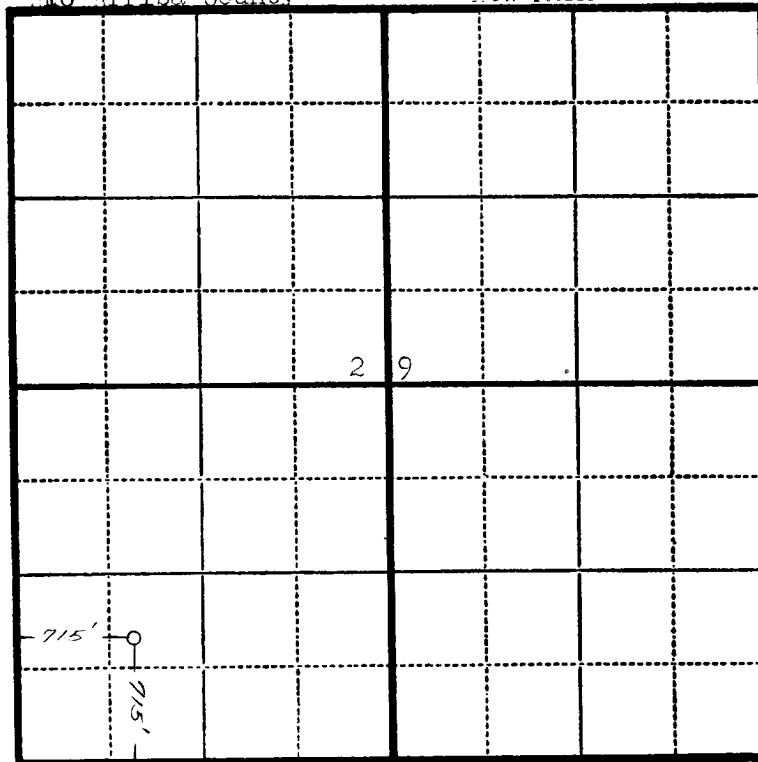

Scale—4 inches equals 1 mile.

This is to certify that the above plat was prepared from field notes of actual surveys made by me or under my supervision and that the same are true and correct to the best of my knowledge and belief.

Charles J. Finklee

Seal:

Registered Professional
Engineer and Land Surveyor.

Charles J. Finklee
N. Mex. Reg. No. 1302

Surveyed May 19, 1952

