

U. S. G. S. - 4
Styl Prod. - 1
Region - 1
District - 2

(SUBMIT IN TRIPLICATE)

Budget Bureau 42-R358.2
Approval expires 12-31-52.

Land Office Santa Fe

Lease No. 078740

Unit San Juan Unit 30-5

UNITED STATES
DEPARTMENT OF THE INTERIOR
GEOLOGICAL SURVEY

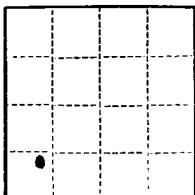

SUNDRY NOTICES AND REPORTS ON WELLS

NOTICE OF INTENTION TO DRILL	<input checked="" type="checkbox"/>	SUBSEQUENT REPORT OF WATER SHUT-OFF	
NOTICE OF INTENTION TO CHANGE PLANS		SUBSEQUENT REPORT OF SHOOTING OR ACIDIZING	
NOTICE OF INTENTION TO TEST WATER SHUT-OFF		SUBSEQUENT REPORT OF ALTERING CASING	
NOTICE OF INTENTION TO RE-DRILL OR REPAIR WELL		SUBSEQUENT REPORT OF RE-DRILLING OR REPAIR	
NOTICE OF INTENTION TO SHOOT OR ACIDIZE		SUBSEQUENT REPORT OF ABANDONMENT	
NOTICE OF INTENTION TO PULL OR ALTER CASING		SUPPLEMENTARY WELL HISTORY	
NOTICE OF INTENTION TO ABANDON WELL			

(INDICATE ABOVE BY CHECK MARK NATURE OF REPORT, NOTICE, OR OTHER DATA)

June 15, 1953

Well No. 30-5 7-29 is located 990 ft. from IN line and 990 ft. from E line of sec. _____

SW/4 Sec. 29 30N 5W N.M.P.M.
(1/4 Sec. and Sec. No.) (Twp.) (Range) (Meridian)

Wildcat Rio Arriba New Mexico
(Field) (County or Subdivision) (State or Territory)

The elevation of the ~~derick floor~~ ground above sea level is 6253 ft.

DETAILS OF WORK

(State names of and expected depths to objective sands; show sizes, weights, and lengths of proposed casings; indicate mudding jobs, cementing points, and all other important proposed work)

Propose to drill to approximately 5000' using mud. Set casing at top of pay. Mesa Verde will be drilled with gas and cleaned out with gas after shot. Rotary tools will be used to TD.

Proposed Casing

Set 10-3/4" casing at 150, cement with approximately 200 sax.
Set 7" casing at top of pay, cement with approximately 200 sax.

Location plat attached.



I understand that this plan of work must receive approval in writing by the Geological Survey before operations may be commenced.

Company Phillips Petroleum Company

Address P.O. Box 939
Astec, New Mexico

By _____

Title District Superintendent

Company.....Phillips Petroleum Company.....

Lease.....Unit 30-5.....Well No. 7-29.....

Sec. 29....., T. 30 N., R. 5 W., N.M.P.M.....

Location.....990' from the South line and 990' from the West line.

Elevation.....6253 Ungraded ground.....

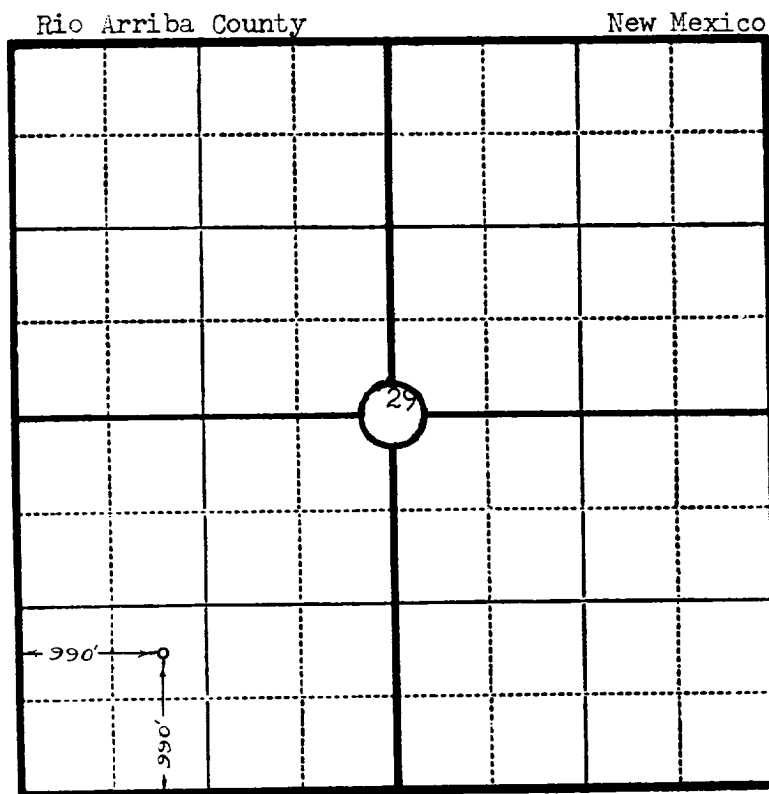

Scale—4 inches equal 1 mile.

This is to certify that the above plat was prepared from field notes of actual surveys made by me or under my supervision and that the same are true and correct to the best of my knowledge and belief.

Seal:

James P. Leese
Registered Professional
Engineer and Land Surveyor.

James P. Leese
N. Mex. Reg. No. 1463

Surveyed June 12, 1953