

(SUBMIT IN TRIPLICATE)

UNITED STATES
DEPARTMENT OF THE INTERIOR
GEOLOGICAL SURVEY

Land Office Santa Fe

Lease No. 000537

Unit San Juan 30-5 Unit

RECEIVED

SUNDRY NOTICES AND REPORTS ON WELLS

NOTICE OF INTENTION TO DRILL.....	<input checked="" type="checkbox"/>	SUBSEQUENT REPORT OF WATER SHUT-OFF.....	
NOTICE OF INTENTION TO CHANGE PLANS.....		SUBSEQUENT REPORT OF SHOOTING OR ACIDIZING.....	
NOTICE OF INTENTION TO TEST WATER SHUT-OFF.....		SUBSEQUENT REPORT OF ALTERING CASING.....	
NOTICE OF INTENTION TO RE-DRILL OR REPAIR WELL.....		SUBSEQUENT REPORT OF RE-DRILLING OR REPAIR.....	
NOTICE OF INTENTION TO SHOOT OR ACIDIZE.....		SUBSEQUENT REPORT OF ABANDONMENT.....	
NOTICE OF INTENTION TO PULL OR ALTER CASING.....		SUPPLEMENTARY WELL HISTORY.....	
NOTICE OF INTENTION TO ABANDON WELL.....			

(INDICATE ABOVE BY CHECK MARK NATURE OF REPORT, NOTICE, OR OTHER DATA)

June 20, 1950

Well No. 21-24 is located 1650 ft. from S line and 1700 ft. from W line of sec. 24

SW Sec. 24 30N 7W N.M.P.M.
(1/4 Sec. and Sec. No.) (Twp.) (Range) (Meridian)
Blanco M. V. Rio Arriba New Mexico
(Field) (County or Subdivision) (State or Territory)

The elevation of the derrick floor above sea level is 7040 ft.

DETAILS OF WORK

(State names of and expected depths to objective sands; show sizes, weights, and lengths of proposed casings; indicate mudding jobs, cementing points, and all other important proposed work)

It is intended to drill a well in the Mesa Verde formation. Mud circulation will be used thru the Pictured Cliffs formation & set intermediate casing. Gas circulation will be used thru the Mesa Verde & a production liner will be set. Possible productive intervals will be perforated & fractured. Estimated Total Depth 6334'.

Casing Program:

- 10 3/4" at 170' with 150 sacks cement circulated to the surface.
- 7 5/8" at 410' with 250 sacks cement.
- 5 1/2" Liner at 4060-6334' with 300 sacks cement.

The W/2 of section 24 is dedicated to this well.
W/2: SP 000537

I understand that this plan of work must receive approval in writing by the Geological Survey before operations may be commenced.

Company El Paso Natural Gas Company

Address Box 957
Farmington, New Mexico

Original Signed D. C. Johnston

By _____

Title Petroleum Engineer

NEW MEXICO OIL CONSERVATION COMMISSION

Well Location and Acreage Declaration Plat

Section A.

Date **JUNE 19, 1958**

Operator **EL PASO NATURAL GAS COMPANY** Lease **SAN JUAN 30-5 UNIT** SF **080537**
 Well No. **21-24** Unit Letter **K** Section **24** Township **30-N** Range **5-W** NMPM
 Located **1650** Feet From **SOUTH** Line, **1700** Feet From **WEST** Line
 County **RIO ARriba** G. L. Elevation **7030** Dedicated Acreage **320** Acres
 Name of Producing Formation **MESA VERDE** Pool **BLANCO MESA VERDE**

1. Is the Operator the only owner in the dedicated acreage outlined on the plat below?
 Yes ☒ No ☐
2. If the answer to question one is "No", have the interests of all the owners been consolidated by communitization agreement or otherwise? Yes ☐ No ☐ If answer is "Yes", Type of Consolidation:
3. If the answer to question two is "No", list all the owners and their respective interests below:
- | Owner | Land Description |
|-------|------------------|
|-------|------------------|

Section B.

This is to certify that the information in Section A above is true and complete to the best of my knowledge and belief.

El Paso Natural Gas Company

(Operator)

Original Signed **D. C. Johnston**

(Representative)

Box 997

(Address)

Farmington, New Mexico

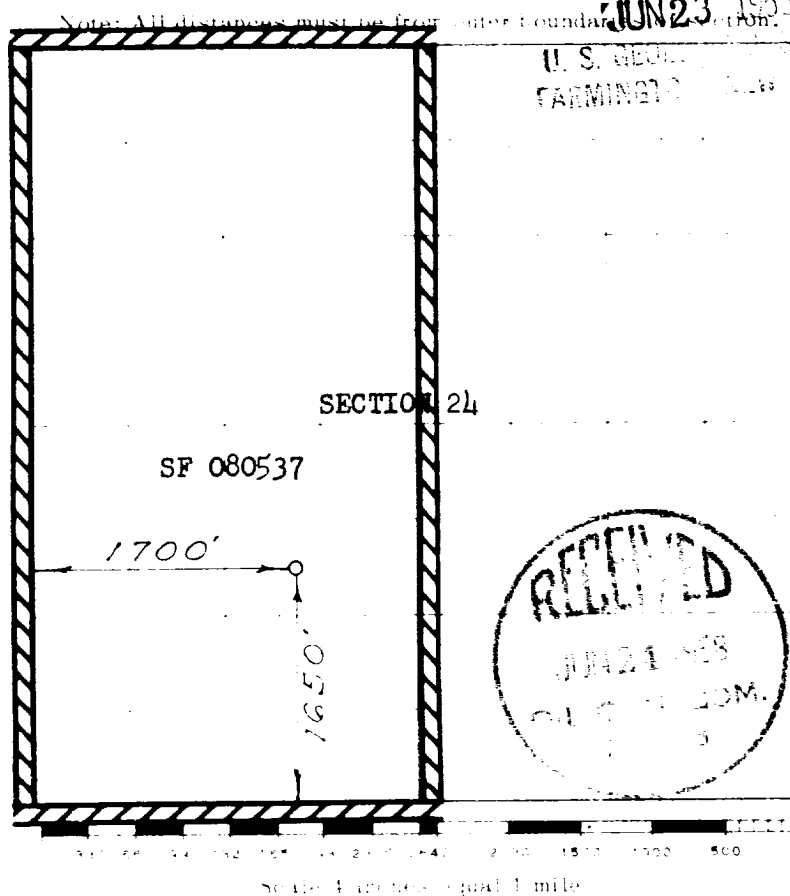

This is to certify that the above plat was prepared from field notes of actual survey, made by me or under my supervision and that the same are true and correct to the best of my knowledge and belief.

Seal

Dated Surveyed

JUNE 2, 1958

David O. Kilven
 Registered Professional Engineer and/or Land Surveyor

Farmington, New Mexico