

## Well Location and Acreage Dedication Plat

Section A.

Date **JULY 10, 1957**

Operator **EL PASO NATURAL GAS COMPANY** Lease **SAN JUAN 30-6 UNIT** NM **03385**  
 Well No. **17** Unit Letter **N** Section **18** Township **30 N** Range **6 W** NMPM  
 Located **800** Feet From **SOUTH** Line, **1500** Feet From **WEST** Line  
 County **RIO ARriba** G. L. Elevation **6630** Dedicated Acreage **320** Acres  
 Name of Producing Formation **MESA VERDE** Pool **BLANCO**

1. Is the Operator the only owner in the dedicated acreage outlined on the plat below?  
 Yes ☐ No ☒ —
2. If the answer to question one is "no", have the interests of all the owners been consolidated by communitization agreement or otherwise? Yes ☒ No ☐ If answer is "yes", Type of Consolidation,

**Unit Agreement**

3. If the answer to question two is "no", list all the owners and their respective interests below

Owner

Land Description

**RECEIVED****AUG 9 1957****U. S. GEOLOGICAL SURVEY  
FARMINGTON, NEW MEXICO**

Section B.

This is to certify that the information in Section A above is true and complete to the best of my knowledge and belief.

**El Paso Natural Gas Company**  
 (Operator)  
**Original Signed D. C. Johnston**  
 (Representative)

**Box 997**

(Address)

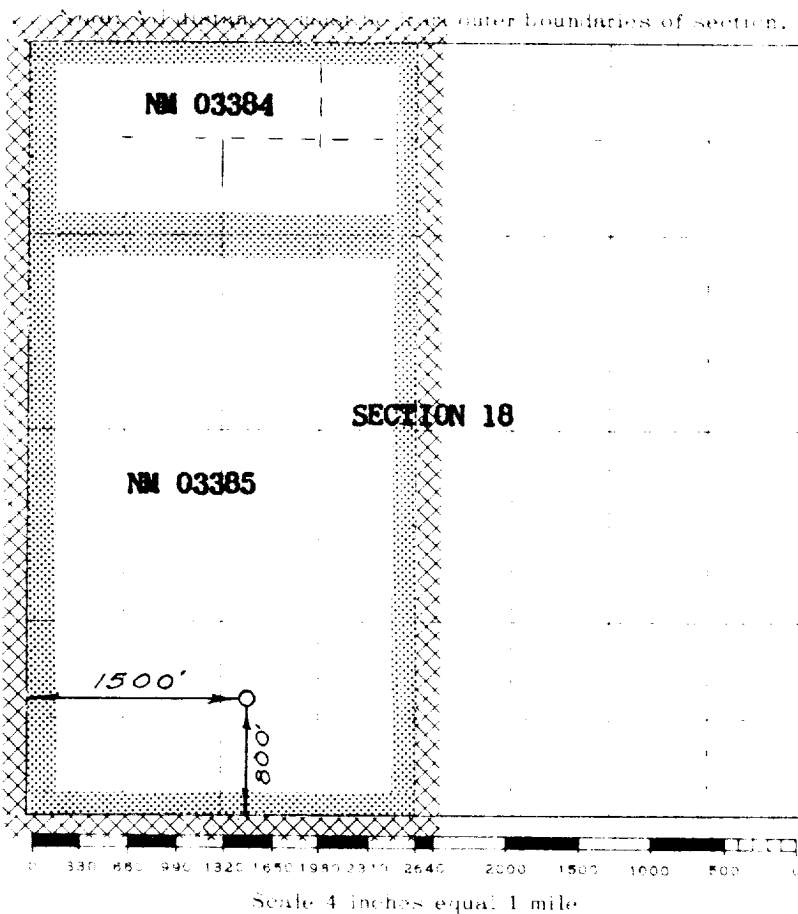
**Farmington, New Mexico**

This is to certify that the above plat was prepared from field notes of actual surveys made by me or under my supervision and that the same are true and correct to the best of my knowledge and belief.

(Seal)

Date Surveyed

**JUNE 13, 1957**

Farmington, New Mexico

Registered Professional Engineer and/or Land Surveyor

**NOTE: THIS PLAT IS RE-ISSUED TO SHOW CORRECTED LOCATION.**

7 31 57