

NO. OF COPIES RECEIVED	6
DISTRIBUTION	
SANTA FE	1
FILE	1
U.S.G.S.	2
LAND OFFICE	1
OPERATOR	1

NEW MEXICO OIL CONSERVATION COMMISSION

30-039-21144

Form C-101
Revised 1-1-65

5A. Indicate Type of Lease	
STATE <input checked="" type="checkbox"/>	FEE <input type="checkbox"/>
5. State Oil & Gas Lease No.	
E 347-26	

APPLICATION FOR PERMIT TO DRILL, DEEPEN, OR PLUG BACK

1a. Type of Work		7. Unit Agreement Name	
b. Type of Well DRILL <input checked="" type="checkbox"/> DEEPEN <input type="checkbox"/> PLUG BACK <input type="checkbox"/> OIL WELL <input type="checkbox"/> GAS WELL <input checked="" type="checkbox"/> OTHER <input type="checkbox"/> SINGLE ZONE <input checked="" type="checkbox"/> MULTIPLE ZONE <input type="checkbox"/>		San Juan 30-5 Unit	
2. Name of Operator		8. Farm or Lease Name	
Northwest Pipeline Corporation		San Juan 30-5 Unit	
3. Address of Operator		9. Well No.	
P. O. Box 90 Farmington, New Mexico 87401		46	
4. Location of Well UNIT LETTER <u>G</u> LOCATED <u>1770</u> FEET FROM THE <u>North</u> LINE AND <u>900</u> FEET FROM THE <u>East</u> LINE OF SEC. <u>36</u> TWP. <u>30N</u> RGE <u>5W</u> NMPM		10. Field and Pool, or Wildcat	
		Blanco Mesa Verde	
		12. County	
		Rio Arriba	
		19. Proposed Depth	
		6950'	
		19A. Formation	
		Mesa Verde	
		20. Rotary or C.T.	
		Rotary	
21. Elevations (Show whether DF, RT, etc.)		22. Approx. Date Work will start	
7364'		Sept. 10, 1975	
21A. Kind & Status Plug. Bond		21B. Drilling Contractor	
Blanker			

23.

PROPOSED CASING AND CEMENT PROGRAM

SIZE OF HOLE	SIZE OF CASING	WEIGHT PER FOOT	SETTING DEPTH	SACKS OF CEMENT	EST. TOP
13 3/4"	9 5/8"	36	200'	180	circ. to surface
8 3/4"	7"	20	4500'	160	2900'
6 1/4"	4 1/2" liner	10.5	4350' to 6950'	215	4350'

Selectively perforate and stimulate the Mesa Verde formation.

A BOP will be installed when the surface casing has been set and cemented.
All subsequent work will be performed through the BOP.

The E/2 of Section 36 is dedicated to this well.

APPROVAL VALID
FOR 90 DAYS UNLESS
DRILLING COMMENCED.

EXPIRES 12-4-75

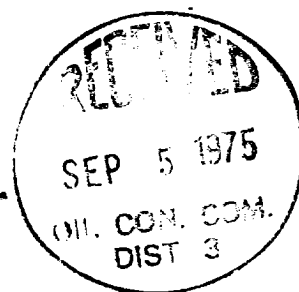

IN ABOVE SPACE DESCRIBE PROPOSED PROGRAM: IF PROPOSAL IS TO DEEPEN OR PLUG BACK, GIVE DATA ON PRESENT PRODUCTIVE ZONE AND PROPOSED NEW PRODUCTIVE ZONE, GIVE BLOWOUT PREVENTER PROGRAM, IF ANY.

I hereby certify that the information above is true and complete to the best of my knowledge and belief.

Signed D. H. Maroncelli Title Petroleum Engineer Date August 28, 1975
D. H. Maroncelli
(This space for State Use)

APPROVED BY AR Kendrick TITLE PETROLEUM ENGINEER DIST. NO. 3 DATE SEP 5 1975

CONDITIONS OF APPROVAL, IF ANY:

**NEW MEXICO OIL CONSERVATION COMMISSION
WELL LOCATION AND ACREAGE DEDICATION PLAT**

Form C-102
Supersedes C-128
Effective 1-1-65

All distances must be from the outer boundaries of the Section.

Operator Northwest Pipeline Corporation			Lease San Juan 30-5 Unit		Well No. 46
Unit Letter G	Section 36	Township 30N	Range 5W	County Rio Arriba	
Actual Footage Location of Well:					
1770 feet from the North line and		900 feet from the East line			
Ground Level Elev. 7364	Producing Formation Mesa Verde	Pool Blanco Mesa Verde		Dedicated Acreage: 243.15 220.76 Acres	

1. Outline the acreage dedicated to the subject well by colored pencil or hachure marks on the plat below.
2. If more than one lease is dedicated to the well, outline each and identify the ownership thereof (both as to working interest and royalty).
3. If more than one lease of different ownership is dedicated to the well, have the interests of all owners been consolidated by communitization, unitization, force-pooling, etc?

☐ Yes ☐ No If answer is "yes," type of consolidation _____

If answer is "no," list the owners and tract descriptions which have actually been consolidated. (Use reverse side of this form if necessary.) _____

No allowable will be assigned to the well until all interests have been consolidated (by communitization, unitization, forced-pooling, or otherwise) or until a non-standard unit, eliminating such interests, has been approved by the Commission.

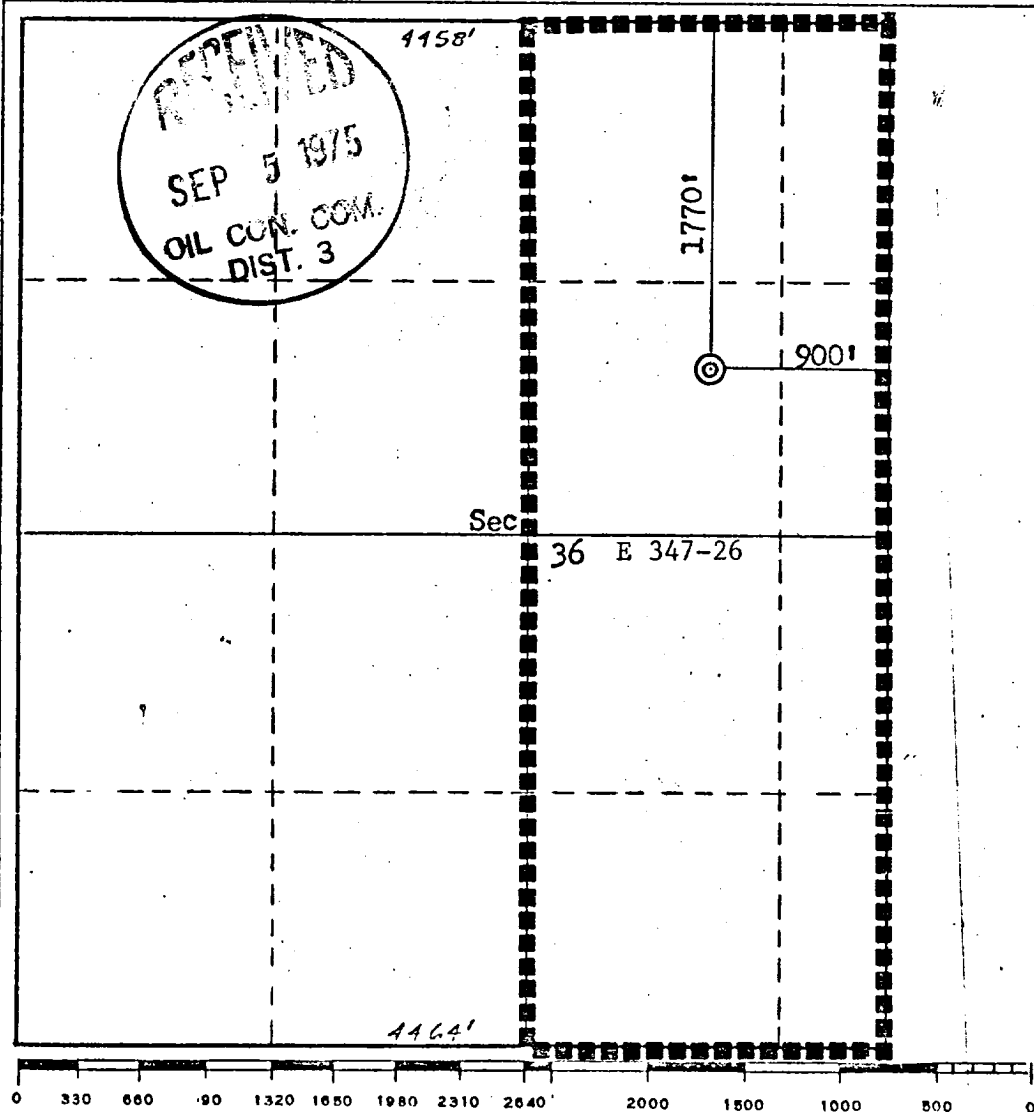

CERTIFICATION

I hereby certify that the information contained herein is true and complete to the best of my knowledge and belief.

D. H. Maroncelli
 Name **D. H. Maroncelli**
 Position **Petroleum Engineer**
 Company **Northwest Pipeline Corp.**
 Date **August 25, 1975**

I hereby certify that the well location shown on this plat was plotted from field notes of actual surveys made by me or under my supervision, and that the same is true and correct to the best of my knowledge and belief.

Date Surveyed **August 9, 1975**
 Registered Professional Engineer and/or Land Surveyor
Pred B. Kerr Jr.
 Certificate No. **3950**