

NO. OF COPIES RECEIVED	6
DISTRIBUTION	
SANITARY	1
FILE	1
U.S.G.S.	2
LAND OFFICE	
OPERATOR	2

NEW MEXICO OIL CONSERVATION COMMISSION

30-039-21276

Form C-101
Revised 1-1-65

5A. Indicate Type of Lease	
STATE <input type="checkbox"/>	FEL <input checked="" type="checkbox"/>

5. State Oil & Gas Lease No.

APPLICATION FOR PERMIT TO DRILL, DEEPEN, OR PLUG BACK

1a. Type of Work		7. Unit Agreement Name	
b. Type of Well DRILL <input checked="" type="checkbox"/> DEEPEN <input type="checkbox"/> PLUG BACK <input type="checkbox"/> OIL WELL <input type="checkbox"/> GAS WELL <input checked="" type="checkbox"/> OTHER <input type="checkbox"/> SINGLE ZONE <input type="checkbox"/> MULTIPLE ZONE <input type="checkbox"/>		San Juan 30-5 Unit	
2. Name of Operator		8. Firm or Lease Name	
Northwest Pipeline Corporation		San Juan 30-5 Unit	
3. Address of Operator		9. Well No.	
P.O. Box 90, Farmington, New Mexico 87401		57	
4. Location of Well UNIT LETTER <u>A</u> LOCATED <u>1190</u> FEET FROM THE <u>North</u> LINE AND <u>1040</u> FEET FROM THE <u>East</u> LINE OF SEC. <u>28</u> TWP. <u>30N</u> RGE. <u>5W</u> NMPM		10. Field and Pool, or Wildcat	
		Blanco Mesa Verde	
		11. County	
		Rio Arriba	
		12. Proposed Depth	
		5907'	
		13A. Formation	
		Mesa Verde	
		13B. Rotary or C.T.	
		Rotary	
21. Elevation: (Show whether DR, RL, etc.)		21B. Drilling Contractor	
6487' GR			
21A. Kind & Status Plug, Bond		22. Approx. Date Work will start	
		Sept. 1, 1976	

23.

PROPOSED CASING AND CEMENT PROGRAM

SIZE OF HOLE	SIZE OF CASING	WEIGHT PER FOOT	SETTING DEPTH	SACKS OF CEMENT	EST. TOP
13-3/4"	9-5/8"	36	200'	180	
8-3/4"	7"	20	3753'	160	
6-1/4"	4-1/2" Liner	10.5	3603'-5907'	215	

Selectively perforate and stimulate the Mesa Verde formation.

A BOP will be installed after the surface casing has been run and cemented. All subsequent operations will be conducted through the the BOP.

The East/2 of section 28 is dedicated to the well.

Gas is dedicated.

IN ABOVE SPACE DESCRIBE PROPOSED PROGRAM: IF PROPOSAL IS TO DEEPEN OR PLUG BACK, GIVE DATA ON PRESENT PRODUCTIVE ZONE AND PROPOSED NEW PRODUCTIVE ZONE. GIVE BLOWOUT PREVENTER PROGRAM, IF ANY.

I hereby certify that the information above is true and complete to the best of my knowledge and belief.

Signed D. H. Maroncelli Title Production Engineer Date 8-18-76

(This space for State Use)

APPROVED BY AK Kendrick TITLE DATE AUG 18 1976

CONDITIONS OF APPROVAL, IF ANY:

DIIM/ks

NEW MEXICO OIL CONSERVATION COMMISSION
WELL LOCATION AND ACREAGE DEDICATION PLAT

Form C-102
Supersedes C-128
Effective 1-1-65

All distances must be from the outer boundaries of the Section.

Owner Northwest Pipeline Corporation			Lease San Juan 30-5 Unit		Well No. 57
Unit Letter A	Section 28	Township 30N	Range 5W	County Rio Arriba	
Actual True Location of Well:					
1190 feet from the North		1040 feet from the East			
Ground Level Elev. 6487	Producing Formation Mesa Verde	Pool Blanco	Dedicated Acreage 320 ✓ Acres		

1. Outline the acreage dedicated to the subject well by colored pencil or hachure marks on the plat below.
2. If more than one lease is dedicated to the well, outline each and identify the ownership thereof (both as to working interest and royalty).
3. If more than one lease of different ownership is dedicated to the well, have the interests of all owners been consolidated by communitization, unitization, force-pooling, etc?

☐ Yes ☐ No If answer is "yes," type of consolidation **AUG 18 1976**

If answer is "no," list the owners and tract descriptions which have actually been consolidated. (Use reverse side of this form if necessary.)

No allowable will be assigned to the well until all interests have been consolidated (by communitization, unitization, forced-pooling, or otherwise) or until a non-standard unit, eliminating such interests, has been approved by the Commission.

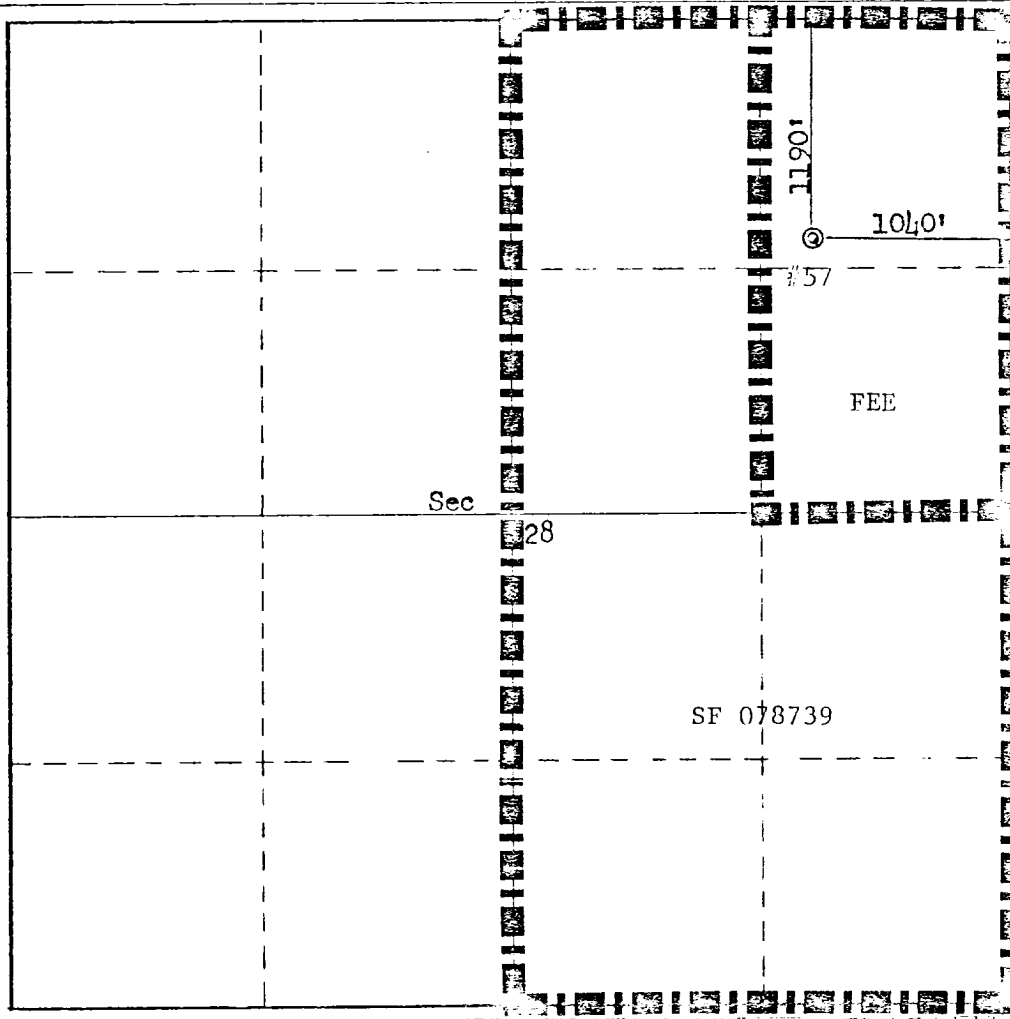

CERTIFICATION

I hereby certify that the information contained herein is true and complete to the best of my knowledge and belief.

D.H. Maroncelli
Name

D.H. Maroncelli

Position

Production Engineer

Company

Northwest Pipeline Corp.

Date

August 2, 1976

I hereby certify that the well location shown on this plat was plotted from field notes of actual surveys made by me or under my supervision, and that the same is true and correct to the best of my knowledge and belief.

Date Surveyed

July 30, 1976

Registered Professional Engineer and/or Land Surveyor

Fred B. Kerr Jr.
Fred B. Kerr Jr.

Certificate No.

3950

0 330 660 990 1320 1650 1980 2310 2640 2970 3300 3630 3960 4290 4620 4950 5280 5610 5940 6270 6600