

STATE OF NEW MEXICO
ENERGY AND MINERALS DEPARTMENT

OIL CONSERVATION DIVISION

P. O. BOX 2088

SANTA FE, NEW MEXICO 87501

Form C-101
Revised 10-1-73

NO. OF COPIES RECEIVED	
DISTRIBUTION	
SANTA FE	
FILE	
U.S.G.S.	
LAND OFFICE	
OPERATOR	

1A. Indicate Type of Lease
STATE ☒ FEDERAL ☐

5. State Oil & Gas Lease No.
F-289-9

APPLICATION FOR PERMIT TO DRILL, DEEPEN, OR PLUG BACK

1a. Type of Work b. Type of Well OIL WELL <input type="checkbox"/> GAS WELL <input checked="" type="checkbox"/> OTHER <input type="checkbox"/> SINGLE ZONE <input checked="" type="checkbox"/> MULTIPLE ZONE <input type="checkbox"/>		DRILL <input checked="" type="checkbox"/> DEEPEN <input type="checkbox"/> PLUG BACK <input type="checkbox"/>	
2. Name of Operator Blackwood & Nichols Co., Ltd.		7. Unit Agreement Name NEBU Agreement #1, Sec. 929	
3. Address of Operator P. O. Box 1237, Durango, CO 81302		8. Farm or Lease Name Northeast Blanco Unit	
4. Location of Well UNIT LETTER <u>D</u> LOCATED <u>1190</u> FEET FROM THE <u>N</u> LINE AND <u>790</u> FEET FROM THE <u>W</u> LINE OF SEC. <u>2</u> TWP. <u>30N</u> RGE. <u>7W</u> NEPM		9. Well No. 15A	
10. Field and Pool, or Wildcat Blanco Mesaverde		12. County Rio Arriba	
11. Proposed Depth 5968'		13A. Formation Mesaverde	
13B. Drilling Contractor Unknown		13C. Rotary or C.T. Rotary	
14. Elevations (Show whether DE, RL, etc.) 6373' U.G.		21A. Kind & Status Plug. Bond	
21B. Approx. Date Work will start May 15, 1985		22. Approval	

23. PROPOSED CASING AND CEMENT PROGRAM

SIZE OF HOLE	SIZE OF CASING	WEIGHT PER FOOT	SETTING DEPTH	SACKS OF CEMENT	EST. TOP
12 1/4"	9 5/8"	32.3# H-40	200'	200 (236 cf)	Circulate
8 3/4"	7"	23.0# K-55	3688'	650 (877 cf)	Circulate
6 1/4"	4 1/2" liner	10.5# K-55	5968'	300 (400 cf)	Top liner

We propose to drill an infield Blanco Mesaverde well to further develop the Northeast Blanco Unit. A low solid mud system with sufficient weight to control the Fruitland formation will be used to the 7" casing point. Then the hole will be drilled with gas to the total depth. Well control will be a 10" Series 900 blow out preventer, drilling head and sufficient kill and bleed lines.

This gas is dedicated to El Paso Natural Gas Company.

Attached you will find:

1. C-102
2. Proposed Access Map
3. Drilling Pad Layout

APPROVAL EXPIRES 10-17-85
UNLESS DRILLING IS COMMENCED.
SPUD NOTICE MUST BE SUBMITTED
WITHIN 10 DAYS.

RECEIVED
APR 17 1985
OIL CON. DIV.
DIST. 3

IN ABOVE SPACE DESCRIBE PROPOSED PROGRAM IF PROPOSAL IS TO DEEPEN OR PLUG BACK, GIVE DATA ON PRESENT PRODUCTIVE ZONE AND PROPOSED NEW PRODU-
TIVE ZONE. GIVE BLOWOUT PREVENTER PROGRAM, IF ANY.

I hereby certify that the information above is true and complete to the best of my knowledge and belief.

Signed William F. Clark Title Petroleum Engineer Date 4-16-85

(This space for State Use)

APPROVED BY Wm. F. Clark TITLE SUPERVISOR DISTRICT # 3 DATE APR 17 1985

CONDITIONS OF APPROVAL, IF ANY:

NEW MEXICO OIL CONSERVATION COMMISSION
WELL LOCATION AND ACREAGE DEDICATION PLAT

Form C-102
Supersedes C-128
Effective 1-1-65

All distances must be from the outer boundaries of the Section.

Operator BLACKWOOD & NICHOLS CO., LTD.		Lease NORTHEAST BLANCO UNIT		Well No. 15A
Unit Letter D	Section 2	Township 30 N.	Range 7W., N.M.P.M.	County RIO ARriba
Actual Footage Location of Well: 1190 feet from the north line and 790 feet from the west line				
Ground Level Elev: 6373 (U.G.)	Producing Formation Mesaverde	Pool Blanco Mesaverde	Dedicated Acreage: 318.62 Acres	

1. Outline the acreage dedicated to the subject well by colored pencil or hatchure marks on the plat below.
2. If more than one lease is dedicated to the well, outline each and identify the ownership thereof (both as to working interest and royalty).
3. If more than one lease of different ownership is dedicated to the well, have the interests of all owners been consolidated by communitization, unitization, force-pooling, etc?

☒ Yes ☐ No If answer is "yes," type of consolidation Unitized

If answer is "no," list the owners and tract descriptions which have actually been consolidated. (Use reverse side of this form if necessary.) _____

No allowable will be assigned to the well until all interests have been consolidated (by communitization, unitization, forced-pooling, or otherwise) or until a non-standard unit, eliminating such interests, has been approved by the Commission.

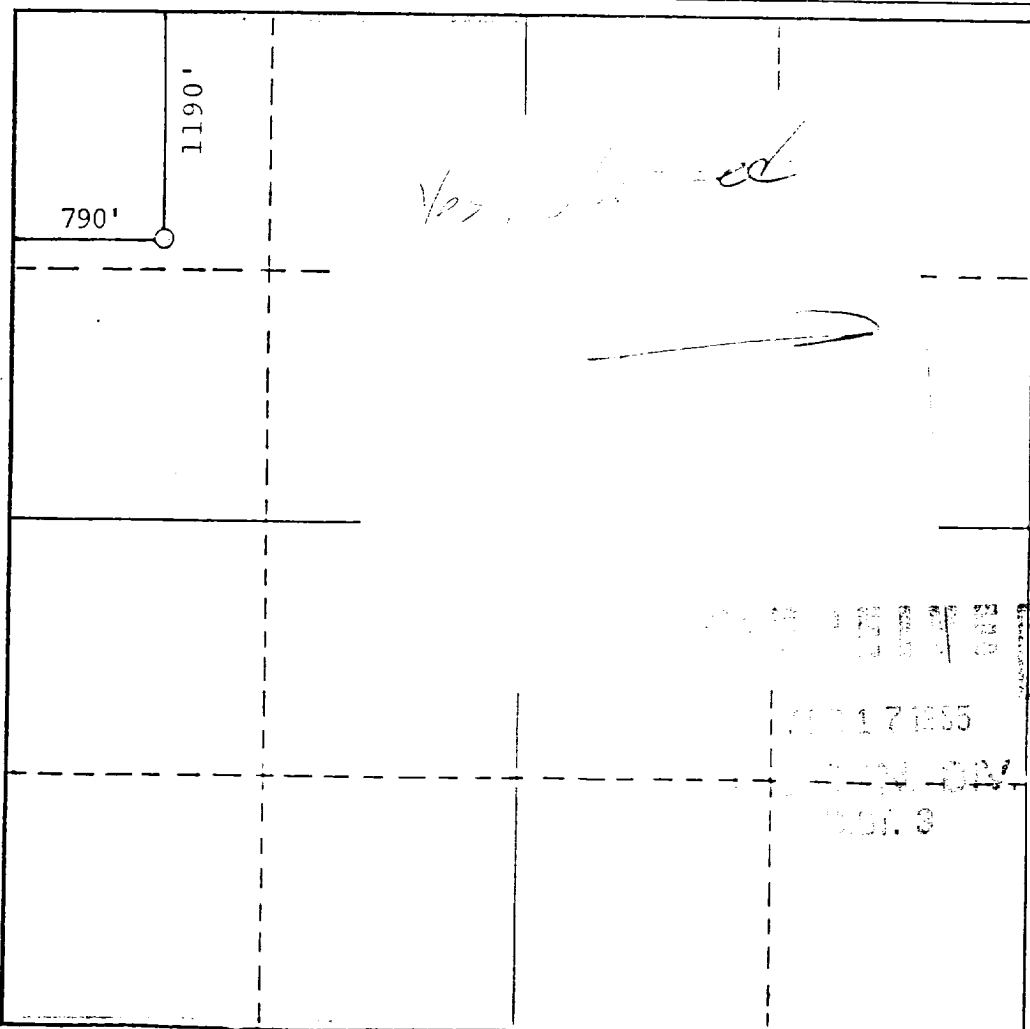

CERTIFICATION

I hereby certify that the information contained herein is true and complete to the best of my knowledge and belief.

Name
William F. Clark
Position
Petroleum Engineer
Company
Blackwood & Nichols Co., Ltd
Date
April 16, 1985

I hereby certify that the well location shown on this plat was plotted from field notes of actual surveys made by me or under my supervision, and that the same is true and correct to the best of my knowledge and belief.

Date Surveyed
April 12, 1985
Registered Professional Engineer and/or Land Surveyor
Allison L. Kroeger
Allison L. Kroeger

Certificate No.
7922