

UNITED STATES
DEPARTMENT OF THE INTERIOR
GEOLOGICAL SURVEY

APPLICATION FOR PERMIT TO DRILL, DEEPEN, OR PLUG BACK

1a. TYPE OF WORK

DRILL ☒DEEPEN ☐ PLUG BACK ☐

b. TYPE OF WELL

OIL
WELL ☐GAS
WELL ☒OTHER ☐FARMINGTON REVENUE AREA
FARMINGTON, NEW MEXICOMULTIPLE
ZONE ☐

2. NAME OF OPERATOR

Blackwood & Nichols Co., Ltd

3. ADDRESS OF OPERATOR

P.O. Box 1237, Durango, Colorado 81302-1237

4. LOCATION OF WELL (Report location clearly and in accordance with any State requirements.)*
At surface

795' FSL-1825' FEL

At proposed prod. zone
Same

14. DISTANCE IN MILES AND DIRECTION FROM NEAREST TOWN OR POST OFFICE*

14 miles NE of Blanco, New Mexico

15. DISTANCE FROM PROPOSED*

LOCATION TO NEAREST
PROPERTY OR LEASE LINE, FT.
(Also to nearest drlg. unit line, if any)

500'

18. DISTANCE FROM PROPOSED LOCATION*
TO NEAREST WELL, DRILLING, COMPLETED,
OR APPLIED FOR, ON THIS LEASE, FT.

500'

16. NO. OF ACRES IN LEASE

133.12

19. PROPOSED DEPTH

3190'

17. NO. OF ACRES ASSIGNED
TO THIS WELL

320

20. ROTARY OR CABLE TOOLS

Rotary

21. ELEVATIONS (Show whether DF, RT, GR, etc.)

6292' GLS
DRILLING OPERATIONS ARE
CONDUCTED IN ACCORDANCE WITH ATTACHED

22. APPROX. DATE WORK WILL START*

November 15, 1988

23.

PROPOSED CASING AND CEMENTING PROGRAM

SIZE OF HOLE	SIZE OF CASING	WEIGHT PER FOOT	SETTING DEPTH	QUANTITY OF CEMENT
12 1/4"	9 5/8"	36#	300"	207 cuft to circulate
8 3/4"	7"	23#	2990"	781 cuft to circulate
6 1/4"	5 1/2"	17#	2890'-3190'	39 cuft to circulate

Propose to spud in San Jose formation. Will drill 12 1/4" surface hole to a TD of 300: Surface casing will be run and cemented with cement returns to surface. WOC 12 hours. Test to 600psi. Drill 8 3/4" hole with fresh water mud to intermediate TD. No abnormal pressures or poisonous gases are anticipated. Casing will be run and cemented with cement returns to surface. WOC 12 hours. Test to 1500 psi. Drill 6 1/4" hole through Fruitland Coals with water. A liner may be run if hole conditions dictate. The liner may or may not be cemented, depending on the wells natural producing ability.

RECEIVED
NOV 21 1988

IN ABOVE SPACE DESCRIBE PROPOSED PROGRAM: If proposal is to deepen or plug back, give data on present productive zone and proposed new productive zone. If proposal is to drill or deepen directionally, give pertinent data on subsurface locations and measured and true vertical depths. Give blowout preventer program, if any.

24.

SIGNED

William F. Clark

TITLE Operations Manager

DATE

Oct 18, 1988

(This space for Federal or State office use)

PERMIT NO.

APPROVAL DATE

APPROVED BY

TITLE

CONDITIONS OF APPROVAL, IF ANY:

APPROVED
AS AMENDED

NOV 14 1988

AREA MANAGER

*See Instructions On Reverse Side

11/30/88

All distances must be from the outer boundaries of the Section.

Operator Blackwood & Nichols Co., LTD.		Lease Northeast Blanco Unit		Well No. 431
Unit Letter 0	Section 17	Township 30 North	Range 7 West	County Rio Arriba
Actual Footage Location of Wells 795 feet from the South line and 1825 feet from the East line				
Ground Level Elev. 6292'	Producing Formation Fruitland Coal	Pool Basin Fruitland Coal	Dedicated Acreage 320 Acres	

1. Outline the acreage dedicated to the subject well by colored pencil or hatchure marks on the plat below.
2. If more than one lease is dedicated to the well, outline each and identify the ownership thereof (both as to working interest and royalty).
3. If more than one lease of different ownership is dedicated to the well, have the interests of all owners been consolidated by communitization, unitization, force-pooling, etc?

☒ Yes ☐ No If answer is "yes," type of consolidation Unitization

If answer is "no," list the owners and tract descriptions which have actually been consolidated. (Use reverse side of this form if necessary.)

No allowable will be assigned to the well until all interests have been consolidated (by communitization, unitization, forced-pooling, or otherwise) or until a non-standard unit, eliminating such interests, has been approved by the Division

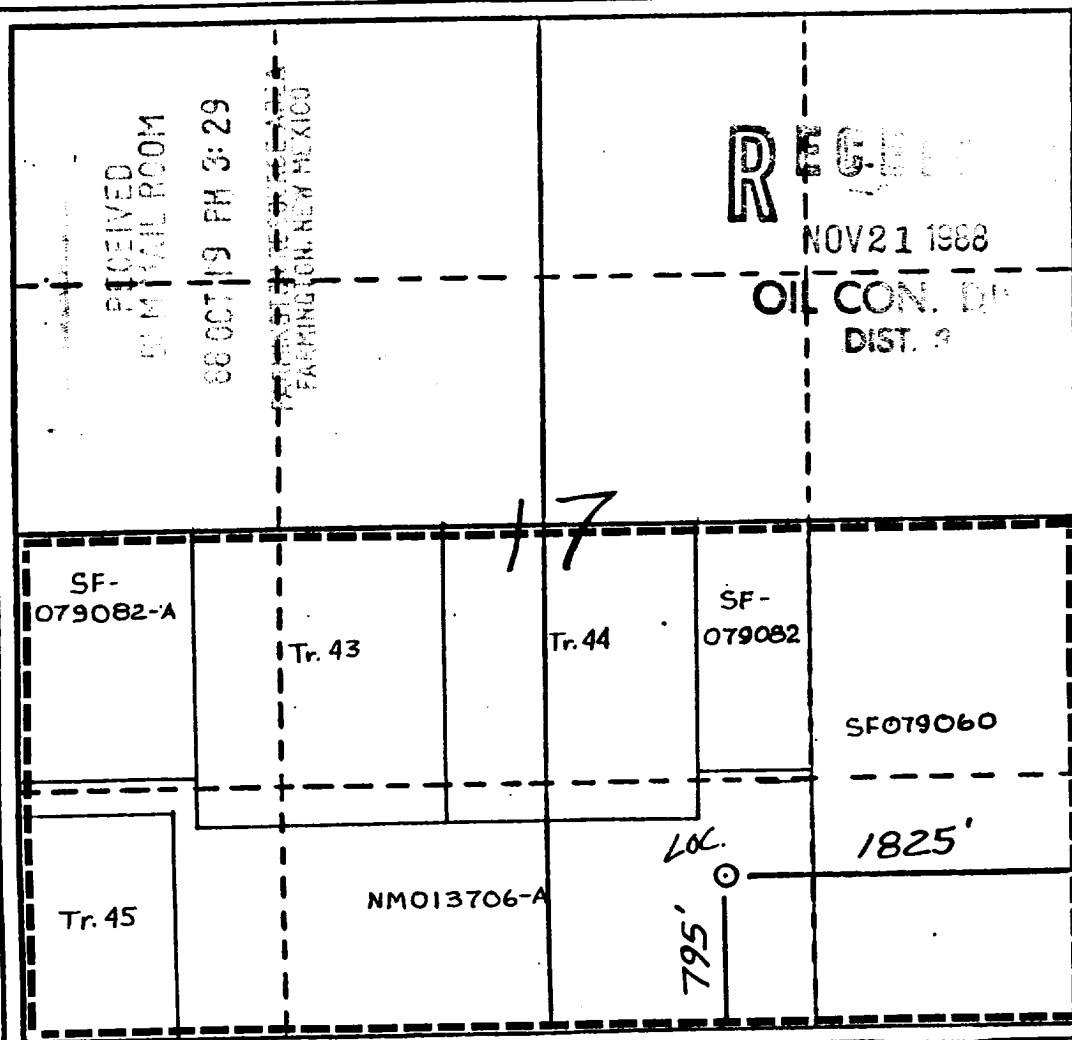

CERTIFICATION

I hereby certify that the information contained herein is true and complete to the best of my knowledge and belief.

William F. Clark
Name

Position
Operations Manager

Company
Blackwood & Nichols Co., Ltd

Date
Oct 18, 1988

I hereby certify that the location shown on this plat was plotted from field notes of actual surveys made by me or under my supervision, and that the same is true and correct to the best of my knowledge and belief.

Neale C. Edwards
Date Surveyed

9-11-88

Registered Professional Engineer
and/or Land Surveyor

Neale C. Edwards

Certificate No. 6857

Vicinity Map
Blackwood & Nichols Co., Ltd.
Northeast Blanco Unit No. 431
795' FSL - 1825' FEL
Section 17, T30N, R7W, NMPM
Rio Arriba Co., New Mexico

