

UNITED STATES  
DEPARTMENT OF THE INTERIOR  
GEOLOGICAL SURVEY

30-039-24345

## APPLICATION FOR PERMIT TO DRILL, DEEPEN, OR PLUG BACK

## 1a. TYPE OF WORK

DRILL ☒DEEPEEN ☐PLUG BACK ☐

## b. TYPE OF WELL

OIL  
WELL ☐GAS  
WELL ☒OTHER ☐

OCT 19 PM 3:32

SINGLE  
ZONE ☒MULTIPLE  
ZONE ☐

## 2. NAME OF OPERATOR

2505

Blackwood & Nichols Co. FARMINGTON RESOURCE AREA  
FARMINGTON, NEW MEXICO

## 3. ADDRESS OF OPERATOR

P.O. Box 1237, Durango, Colorado 81302-1237

4. LOCATION OF WELL (Report location clearly and in accordance with any State requirements.)\*  
At surface

215' FSL - 740' FEL

At proposed prod. zone

Same

## 14. DISTANCE IN MILES AND DIRECTION FROM NEAREST TOWN OR POST OFFICE\*

18 miles NE of Blanco, New Mexico

## 15. DISTANCE FROM PROPOSED\*

LOCATION TO NEAREST  
PROPERTY OR LEASE LINE, FT.  
(Also to nearest drlg. unit line, if any)

740'

## 18. DISTANCE FROM PROPOSED LOCATION\*

TO NEAREST WELL, DRILLING, COMPLETED,  
OR APPLIED FOR, ON THIS LEASE, FT.

200'

## 16. NO. OF ACRES IN LEASE

2314.56

## 19. PROPOSED DEPTH

3120'

17. NO. OF ACRES ASSIGNED  
TO THIS WELL.

319.34

## 20. ROTARY OR CABLE TOOLS

Rotary

## 21. ELEVATIONS (Show whether DF, RT, GR. etc.)

6211' GL

DRILLING OPERATIONS AUTHORIZED ARE  
SUBJECT TO COMPLY WITH ATTACHED  
"GENERAL REQUIREMENTS"

## 22. APPROX. DATE WORK WILL START\*

October 15, 1988

## 23.

## PROPOSED CASING AND CEMENTING PROGRAM

SIZE OF HOLE	SIZE OF CASING	WEIGHT PER FOOT	SETTING DEPTH	QUANTITY OF CEMENT
12 1/4"	9 5/8"	36#	300'	207 cuft to circulate
8 3/4"	7"	23#	2900'	781 cuft to circulate
6 1/4"	5 1/2"	17#	2800'-3120'	39 cuft to circulate

Propose to spud in San Jose formation. Will drill 12 1/4" surface hole to a TD of 300: Surface casing will be run and cemented with cement returns to surface. WOC 12 hours. Test to 600 psi. Drill 8 3/4" hole with fresh water mud to intermediate TD. No abnormal pressures or poisonous gases are anticipated. Casing will be run and cemented with cement returns to surface. WOC 12 hours. Test to 1500 psi. Drill 6 1/4" hole through Fruitland Coals with water. A liner may be run if hole conditions dictate. The liner may or may not be cemented, depending on the wells natural producing ability.

RECEIVED

NOV21 1988

OIL CON. DIV  
DIST. 9

IN ABOVE SPACE DESCRIBE PROPOSED PROGRAM: If proposal is to deepen or plug back, give data on present productive zone and proposed new productive zone. If proposal is to drill or deepen directionally, give pertinent data on subsurface conditions and measured and true vertical depths. Give blowout preventer program, if any.

## 24.

SIGNED

William F. Clark

TITLE

Operations Manager

DATE

Oct 18, 88

(This space for Federal or State office use)

PERMIT NO.

APPROVAL DATE

APPROVED BY

CONDITIONS OF APPROVAL, IF ANY:

TITLE

DATE

NSL-2599

\*See Instructions On Reverse Side

All distances must be from the outer boundaries of the Section.

Operator <b>Blackwood &amp; Nichols Co., LTD.</b>			Lease <b>Northeast Blanco Unit</b>		Well No. <b>421</b>
Unit Letter <b>P</b>	Section <b>4</b>	Township <b>30 North</b>	Range <b>7 West</b>	County <b>Rio Arriba</b>	
Actual Footage Location of Well: <b>215</b> feet from the <b>South</b> line and <b>740</b> feet from the <b>East</b> line					
Ground Level Elev. <b>6211'</b>	Producing Formation <b>Fruitland Coal</b>		Pool <b>Basin Fruitland Coal</b>		Dedicated Acreage <b>319.34</b> Acres

1. Outline the acreage dedicated to the subject well by colored pencil or hachure marks on the plat below.
2. If more than one lease is dedicated to the well, outline each and identify the ownership thereof (both as to working interest and royalty).
3. If more than one lease of different ownership is dedicated to the well, have the interests of all owners been consolidated by communitization, unitization, force-pooling, etc?

☐ Yes ☐ No If answer is "yes," type of consolidation NA

If answer is "no," list the owners and tract descriptions which have actually been consolidated. (Use reverse side of this form if necessary.)

No allowable will be assigned to the well until all interests have been consolidated (by communitization, unitization, forced-pooling, or otherwise) or until a non-standard unit, eliminating such interests, has been approved by the Division

\*Note: Non-standard due to terrain.

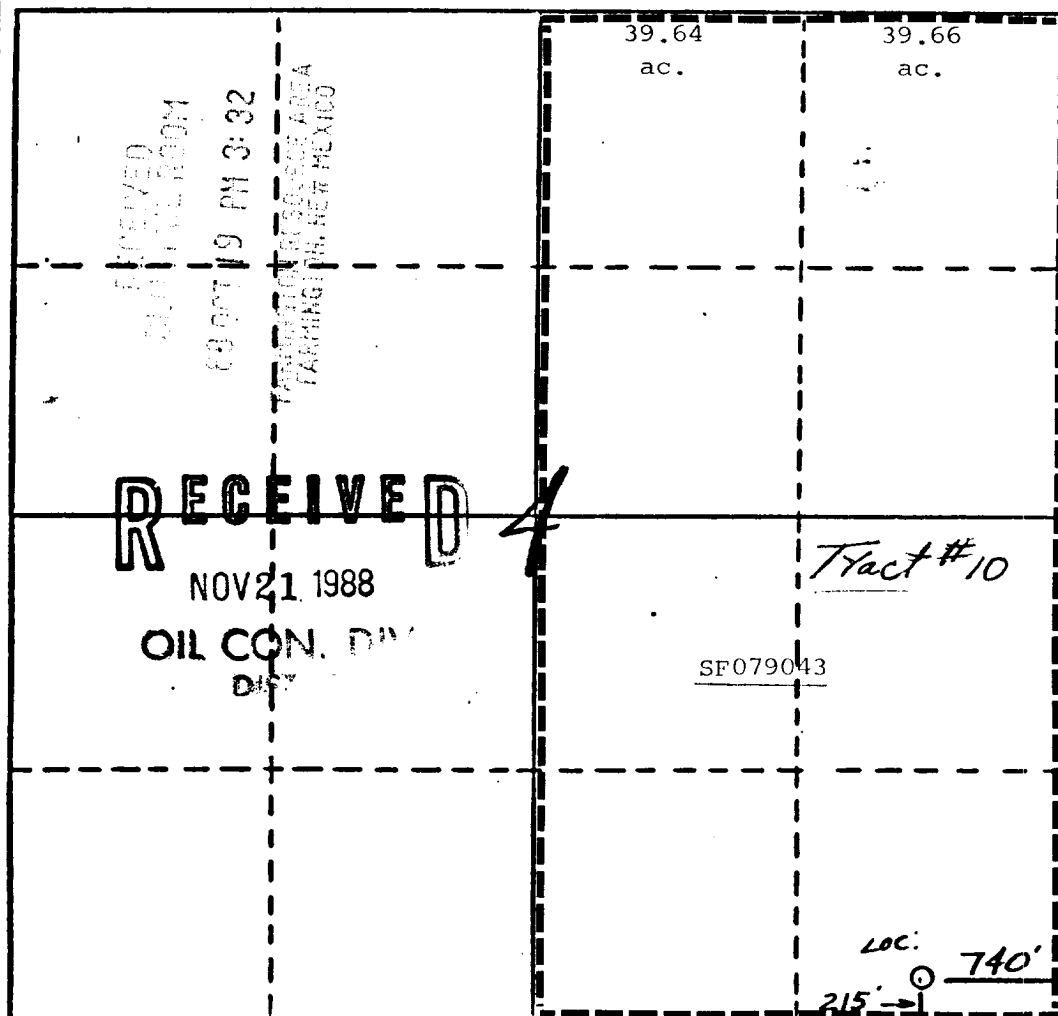

CERTIFICATION

I hereby certify that the information contained herein is true and complete to the best of my knowledge and belief.

William F. Clark  
Name

Position  
Operations Manager  
Company  
Blackwood & Nichols Co., Ltd

Date  
Oct 18 1988

I hereby certify that the location shown on this plat was obtained from field notes of actual surveys made by me or under my supervision, and that the same is true and correct to the best of my knowledge.

Neale C. Edwards

Date Surveyed  
9-8-88

Registered Professional Engineer and/or Land Surveyor

Neale C. Edwards

Certificate No.  
6857

