

UNITED STATES  
DEPARTMENT OF THE INTERIOR  
BUREAU OF LAND MANAGEMENT

APPLICATION FOR PERMIT TO DRILL, DEEPEN, OR PLUG BACK

1a. TYPE OF WORK

DRILL ☒

DEEPEN ☐

PLUG BACK ☐

b. TYPE OF WELL

OIL  
WELL ☐

GAS  
WELL ☒

OTHER ☐

SINGLE ZONE ☐ MULTIPLE ZONE ☐

2. NAME OF OPERATOR

Meridian Oil Inc. *EPN to Meridian Oil Inc.*

3. ADDRESS OF OPERATOR

PO Box 4289, Farmington, NM 87499

4. LOCATION OF WELL (Report location clearly and in accordance with any State requirements.)\*

At surface: 1840' N, 1843' E 790' N x 850' E  
At proposed prod. zone

14. DISTANCE IN MILES AND DIRECTION FROM NEAREST TOWN OR POST OFFICE\*

12 miles from Gobernador, NM

15. DISTANCE FROM PROPOSED\*  
LOCATION TO NEAREST  
PROPERTY OR LEASE LINE, FT.  
(Also to nearest drig. unit line, if any.)

1840'

16. NO. OF ACRES IN LEASE

1040

17. NO. OF ACRES ASSIGNED  
TO THIS WELL

320.00

18. DISTANCE FROM PROPOSED LOCATION\*  
TO NEAREST WELL, DRILLING, COMPLETED,  
OR APPLIED FOR, ON THIS LEASE, FT.

800'

19. PROPOSED DEPTH

2946'

20. ROTARY OR CABLE TOOLS

Rotary

21. ELEVATIONS (Show whether DF, RT, GR, etc.)

6141' GL This action is subject to technical and  
6349 procedural review pursuant to 43 CFR 3165.3

22. APPROX. DATE WORK WILL START\*

23. DRILLING OPERATIONS AUTHORIZED ARE  
AND CEMENTING PROGRAM SUBJECT TO COMPLIANCE WITH ATTACHED  
GENERAL REQUIREMENTS

SIZE OF HOLE	SIZE OF CASING	WEIGHT PER FOOT	SETTING DEPTH	QUANTITY OF CEMENT
12 1/4"	9 5/8"	32.3#	200'	25 cf. circulated
8 3/4"	7"	20.0#	2770'	199 cf. circ. surface
6 1/4"	5 1/2" liner	15.5#	2946'	do not cement

The Fruitland coal formation will be completed.

A 3000 psi WP and 6000 psi test double gate preventer equipped with  
blind and pipe rams will be used for blow out prevention.

This gas is dedicated.

The E/2 of Section 14 is dedicated to this well.

RECEIVED

JUN 08 1989

OIL CON. DIV.  
DIST. 3

IN ABOVE SPACE DESCRIBE PROPOSED PROGRAM: If proposal is to deepen or plug back, give data on present productive zone and proposed new productive zone. If proposal is to drill or deepen directionally, give pertinent data on subsurface locations and measured and true vertical depths. Give blowout preventer program, if any.

24.

SIGNED

*[Signature]*

TITLE

Regulatory Affairs

DATE

12-12-88

(This space for Federal or State office use)

PERMIT NO.

APPROVAL DATE

APPROVED  
AS AMENDED

APPROVED BY

TITLE

CONDITIONS OF APPROVAL, IF ANY:

NMOCC

for AREA MANAGER

\*See Instructions On Reverse Side

Unit Letter <b>A</b>		Section <b>14</b>	Township <b>30 North</b>	Range <b>6 West</b>	County <b>Rio Arriba</b>
Actual Postage Location of Wells <b>790</b> feet from the <b>North</b> line and <b>850</b> feet from the <b>East</b> line					
Ground Level Elev. <b>6349'</b>	Producing Formation <b>Fruitland Coal</b>		Pool <b>Basin</b>		Dedicated Acreage <b>320</b> Acres

1. Outline the acreage dedicated to the subject well by colored pencil or hatchure marks on the plat below.
2. If more than one lease is dedicated to the well, outline each and identify the ownership thereof (both as to working interest and royalty).
3. If more than one lease of different ownership is dedicated to the well, have the interests of all owners been consolidated by communitization, unitization, force-pooling, etc?

☒ Yes    ☐ No    If answer is "yes," type of consolidation unitization

If answer is "no," list the owners and tract descriptions which have actually been consolidated. (Use reverse side of this form if necessary.)

No allowable will be assigned to the well until all interests have been consolidated (by communitization, unitization, forced-pooling, or otherwise) or until a non-standard unit, eliminating such interests, has been approved by the Division.

Reissued to show moved location

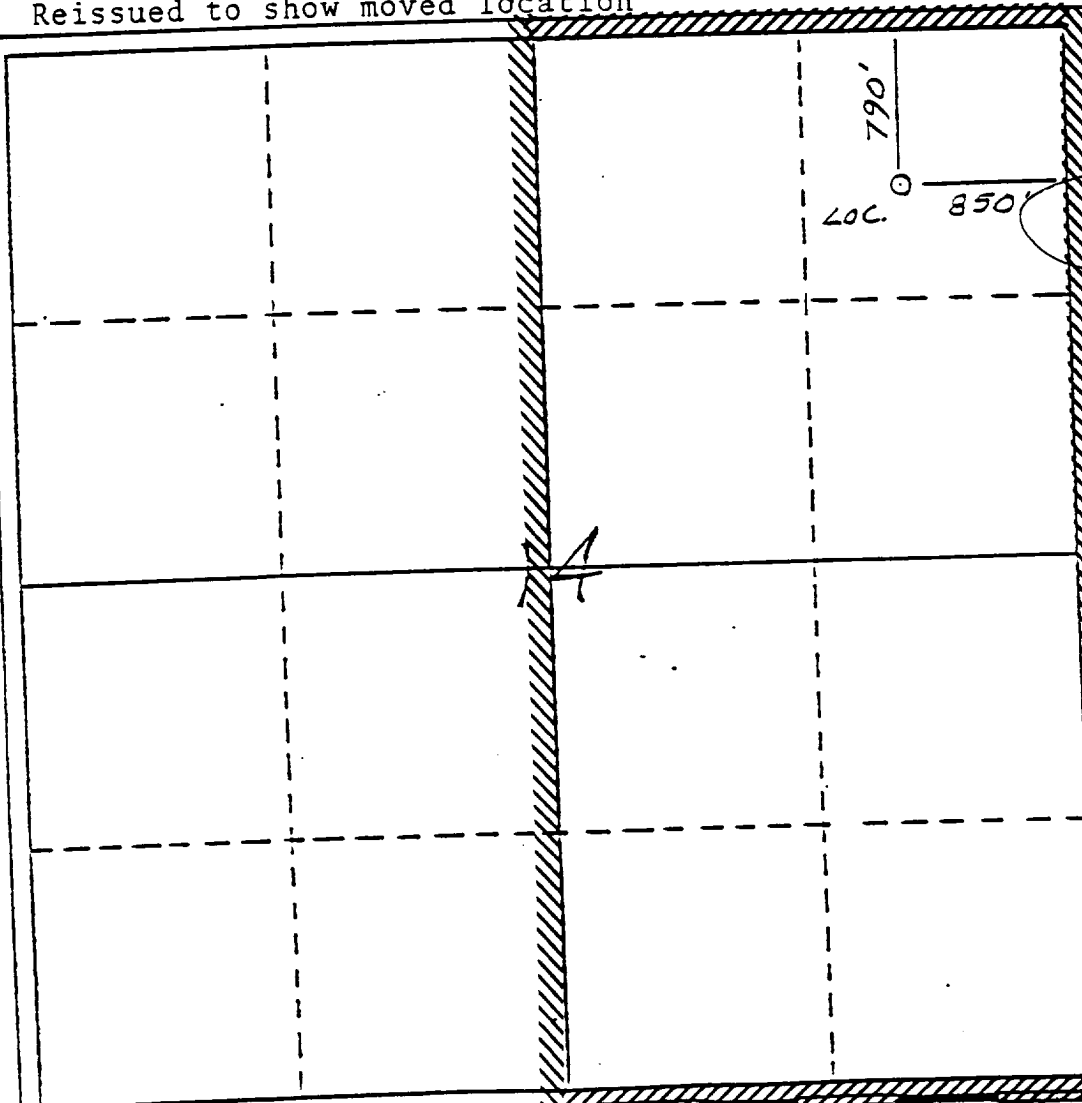

#### CERTIFICATION

I hereby certify that the information contained herein is true and complete to the best of my knowledge and belief.

Name Neale C. Edwards  
 Position Regulatory Affairs

Company El Paso Natural Gas

Date 12-21-88

I hereby certify that the location shown on this plat was plotted from the notes of actual surveys made by me under my supervision, and that the same is true and correct to the best of my knowledge and belief.

Date Surveyed 12-16-88

Registered Professional Engineer and/or Land Surveyor

Neale C. Edwards

Certificate No.

6857

0 330 660 990 1320 1650 1980 2310 2640 2970 3300 3630 3960 4290 4620 4950 5280 5610 5940 6270 6600 6930 7260 7590 7920 8250 8580 8910 9240 9570 9900

T-30-IV  
R-6-W  
SAN JUAN 30-6  
ENIT 442

