

30-037-24869

UNITED STATES
DEPARTMENT OF THE INTERIOR
BUREAU OF LAND MANAGEMENT

APPLICATION FOR PERMIT TO DRILL, DEEPEN, OR PLUG BACK

| | |
|--|---|
| 1a. TYPE OF WORK DRILL | 5. LEASE NUMBER SF-078741 |
| 1b. TYPE OF WELL GAS | 6. IF INDIAN, ALL. OR TRIBE NAME |
| 2. OPERATOR Meridian Oil Inc. EL PASO NATURAL GAS CO. | 7. UNIT AGREEMENT NAME SAN JUAN 30-6 UNIT |
| 3. ADDRESS & PHONE NO. OF OPERATOR P O BOX 4289 FARMINGTON, NM 87499 | 8. FARM OR LEASE NAME SAN JUAN 30-6 UNIT |
| 4. LOCATION OF WELL 1020' FSL 1230' FWL | 9. WELL NO. 491 |
| 14. DISTANCE IN MILES FROM NEAREST TOWN 6 MILES OF GOVERNADOR | 10. FIELD, POOL, OR WILDCAT BASIN FRUITLAND COAL |
| 15. DISTANCE FROM PROPOSED LOCATION TO NEAREST PROPERTY OR LEASE LINE. 1020' | 11. SEC. T. R. M OR BLK. SEC. 25 T30N R06W NMPM |
| 16. ACRES IN LEASE 320.00 | 12. COUNTY RIO ARRIBA |
| 17. ACRES ASSIGNED TO WELL 320.00 | 13. STATE NM |
| 18. DISTANCE FROM PROPOSED LOCATION TO NEAREST WELL DR. COMPL., OR APPLIED FOR ON THIS LEASE. 300' | 19. PROPOSED DEPTH 3685' |
| 20. ROTARY OR CABLE TOOLS ROTARY | 21. ELEVATIONS (DF, FT, GR, ETC.) 6763' GL |
| 22. APPROX. DATE WORK WILL START | |

23. PROPOSED CASING AND CEMENTING PROGRAM

*SEE OPERATIONS PLAN

RECEIVED

24. AUTHORIZED BY: [Signature] AUG 13 1990
REG. DRILLING ENGR. OIL CON. DIV. 7/27/90
DIST. 3 DATE

PERMIT NO. _____ APPROVAL DATE _____
APPROVED BY _____ TITLE _____ DATE _____

NOTE: THIS FORMAT IS ISSUED IN LIEU OF US BLM FORM 3160-3.

[Signature]

OIL CONSERVATION DIVISION

P.O. Box 2088

Santa Fe, New Mexico 87504-2088

DISTRICT I
P.O. Box 1980, Hobbs, NM 88240

DISTRICT II
P.O. Drawer 00, Artesia, NM 88210

DISTRICT III
1000 Rio Brazos Rd., Aztec, NM 87410

WELL LOCATION AND ACREAGE DEDICATION PLAT

All Distances must be from the outer boundaries of the section

| | | | | |
|--|--|--|--|----------------------------------|
| Operator <u>El Paso Natural Gas</u> | | Lease <u>San Juan 30-0 Unit</u> (SF-078741) | | Well No. <u>491</u> |
| Unit Letter <u>M</u> | Section <u>25</u> | Township <u>30 North</u> | Range <u>6 West</u> | County <u>NMPM Rio Arriba</u> |
| Actual Footage Location of Well: <u>1020</u> feet from the <u>South</u> line and <u>1230</u> feet from the <u>West</u> line | | | | |
| Ground level Elev. <u>6763'</u> | Producing Formation <u>Fruitland Coal</u> | Pool <u>Basin</u> | Dedicated Acreage: <u>320</u> Acres | |

1. Outline the acreage dedicated to the subject well by colored pencil or hectare marks on the plat below.

2. If more than one lease is dedicated to the well, outline each and identify the ownership thereof (both as to working interest and royalty).

3. If more than one lease of different ownership is dedicated to the well, have the interest of all owners been consolidated by communitization, unitization, force-pooling, etc.?

☒ Yes ☐ No If answer is "yes" type of consolidation unitization

If answer is "no" list the owners and tract descriptions which have actually been consolidated. (Use reverse side of this form if necessary.)

No allowable will be assigned to the well until all interests have been consolidated (by communitization, unitization, force-pooling, or otherwise) or until a non-standard unit, eliminating such interest, has been approved by the Division.

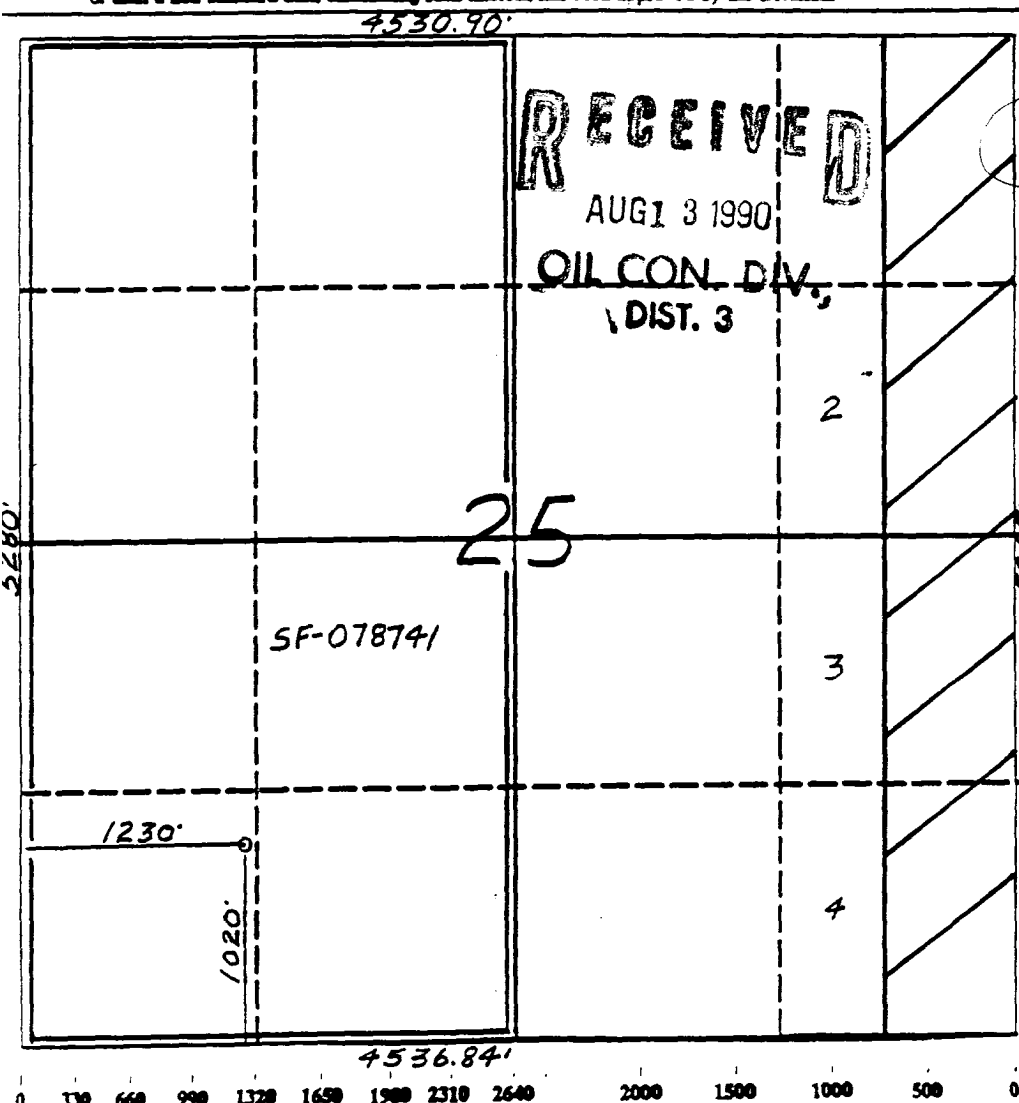

OPERATOR CERTIFICATION

I hereby certify that the information contained herein is true and complete to the best of my knowledge and belief.

Peggy Bradfield
Signature

Peggy Bradfield
Printed Name

Regulatory Affairs
Position

El Paso Natural Gas
Company

7-27-90
Date

SURVEYOR CERTIFICATION

I hereby certify that the well location shown on this plat was plotted from field notes or actual surveys made by me or under my supervision, and that the same is true and correct to the best of my knowledge and belief.

5-25-90

Date Surveyed

Neale C. Edwards
Signature

NEALE C. EDWARDS
Professional Surveyor
6857
6857
REGISTERED LAND SURVEYOR

Neale C. Edwards
Certificate No.

Well Name: 491 SAN JUAN 30-6 UNIT 1020'FSL 1230'FWL
 Sec. 25 T30N R06W RIO ARRIBA NEW MEXICO
 BASIN FRUITLAND COAL Elevation 6763'GL

Formation tops: Surface- San Jose
 Ojo Alamo- 2860
 Kirtland- 2970
 Fruitland- 3380
 Fruitland Coal Top- 3509 Intermediate TD- 3500
 Fruitland Coal Base- 3597 Total Depth- 3685
 Pictured Cliffs- 3703

Logging Program: Mud logs from intermediate to total depth.

| Mud Program: | Interval | Type | Weight | Visc. | Fl. Loss |
|--------------|-------------|-----------------|-----------|-------|------------|
| | 0 - 200 | Spud | 8.4 - 8.9 | 40-50 | no control |
| | 200 - 3500 | Non-dispersed | 8.4 - 9.1 | 30-60 | no control |
| | 3500 - 3685 | Formation Water | 8.4 | | no control |

| Casing Program: | Hole Size | Depth Interval | Csg. Size | Weight | Grade |
|-----------------|-----------|----------------|-----------|--------|-------|
| | 12 1/4" | 0 - 200 | 9 5/8" | 32.3# | H-40 |
| | 8 3/4" | 0 - 3500 | 7" | 20.0# | K-55 |
| | 6 1/4" | 3450 - 3685 | 5 1/2" | 15.5# | K-55 |
| Tubing Program: | | 0 - 3685 | 2 7/8" | 6.5# | J-55 |

Float Equipment: 9 5/8" surface casing - saw tooth guide shoe. Centralizers will be run in accordance with Onshore Order #2.

7" intermediate casing - guide shoe and self-fill insert float valve. Three centralizers run every other joint above shoe. Run insert float one joint above the guide shoe. Two turbolizing type centralizers - one below and one into the base of the Ojo Alamo @ 2970'. Standard centralizers thereafter every fourth joint up to the base of the surface pipe.

5 1/2" production casing - float shoe on bottom and a pre-drilled liner run to the 7" casing with a minimum 50' overlap. Liner hanger is a double slip grip type.

Wellhead Equipment: 9 5/8" x 7" x 2 7/8" x 11" 3000 psi xmas tree assembly.

Cementing:

9 5/8" surface casing - cement with 160 sacks of class "B" cement with 1/4# flocele/sack and 3% calcium chloride (189 cu ft. of slurry, 200% excess to circulate to surface). WOC 12 hours. Test casing to 600 psi for 30 minutes.

7" intermediate casing - lead with 516 sacks of 65/35 class "B" poz with 6% gel, 2% calcium chloride and 1/2 cu ft. Perlite/sack (10.3 gallons of water/sack) tail with 100 sacks of class "B" with 2% calcium chloride. 1115 cu ft. of slurry, 110% excess to circulate to surface. If hole conditions permit, a 600 ft spacer will be run ahead of the cement slurry to avoid mud contamination of the cement. WOC 12 hours. If cement does not circulate to surface, a temperature log will be run after 8 hours to determine TOC.

5 1/2" liner - do not cement.

San Juan 30-6 Unit #491.
T30N, R6W

250' New Construction
6,500' existing BLM roads
located within Unit
boundaries
MAP 1A

