

UNITED STATES
DEPARTMENT OF THE INTERIOR

BUREAU OF LAND MANAGEMENT *30-039-25202*

APPLICATION FOR PERMIT TO DRILL, DEEPEN, OR PLUG BACK

A. TYPE OF WORK
DRILL ☒ DEEPEN ☐ PLUG BACK ☐

B. TYPE OF WELL
OIL WELL ☐ GAS WELL ☒ OTHER ☐ SINGLE ZONE ☒ MULTIPLE ZONE ☐

NAME OF OPERATOR
Phillips Petroleum Company 017654

ADDRESS OF OPERATOR
5525 Hwy 64 NBU 3004, Farmington, NM 87401

LOCATION OF WELL (Report location clearly and in accordance with any State requirements.)*
At surface Unit H, 1403' FNL & 1165' FEL

At proposed prod. zone Same as above

C. DISTANCE IN MILES AND DIRECTION FROM NEAREST TOWN OR POST OFFICE*
30 Miles East from Blanco

D. DISTANCE FROM PROPOSED*
LOCATION TO NEAREST
PROPERTY OR LEASE LINE, FT.
(Also to nearest drig. unit line, if any)

E. DISTANCE FROM PROPOSED LOCATION*
TO NEAREST WELL, DRILLING, COMPLETED,
OR APPLIED FOR, ON THIS LEASE, FT.

F. ELEVATIONS (Show whether DF, RT, GR, etc.)
6663' (GL Unprepared)

G. PROPOSED CASING AND CEMENTING PROGRAM

SIZE OF HOLE	SIZE OF CASING	WEIGHT PER FOOT	SETTING DEPTH
12-1/4"	9-5/8"	36#, K-55	250'
8-3/4"	7"	23#, K-55	3280'
6-1/8"	5-1/2"	15.5#, or 23#	3180'-3430'

5. LEASE DESIGNATION AND SERIAL NO.

SF-078739

6. IF INDIAN, ALLOTTEE OR TRIBE NAME

7. UNIT AGREEMENT NAME

San Juan 30-5 Unit *9258*

8. FARM OR LEASE NAME

9. WELL NO.

240

10. FIELD AND POOL, OR WILDCAT

Basin Fruitland Coal *71629*

11. SEC., T., R., M., OR BLK.
AND SURVEY OR AREA

11 Sec. 22, T-30-N, R- 5-W

12. COUNTY OR PARISH

13. STATE

Rio Arriba

NM

17. NO. OF ACRES ASSIGNED
TO THIS WELL

320 E/2

20. ROTARY OR CABLE TOOLS

Rotary

22. APPROX. DATE WORK WILL START*

Upon Approval

*If the coal is cleated a 5-1/2", 23#, P110 liner will be run in the open hole without being cemented.

*If the coal is not cleated a 5-1/2", 15.5#, K-55 liner will be run, cemented with 100 sx cement and the well fractured.

RECEIVED

JUL 24 1992

OIL CON. DIV.

DIST. 3

Program and BOP Equipment: See Attached

ABOVE SPACE DESCRIBE PROPOSED PROGRAM: If proposal is to deepen or plug back, give data on present productive zone and proposed new productive zone. If proposal is to drill or deepen directionally, give pertinent data on subsurface locations and measured and true vertical depths. Give blowout venter program, if any.

SIGNED *L. E. Robinson* TITLE Sr. Drlg. & Prod. Engr. DATE 1-10-92

(This space for Federal or State office use)

PERMIT NO. APPROVAL DATE

APPROVED BY TITLE

CONDITIONS OF APPROVAL, IF ANY:

APPROVED
AS AMENDED

23 1992
AREA MANAGER

*See Instructions On Reverse Side

Submit to Appropriate
District Office
State Lease - 4 copies
Fee Lease - 3 copies

State of New Mexico
Energy, Minerals and Natural Resources Department

Form C-102
Revised 1-1-89

OIL CONSERVATION DIVISION

P.O. Box 2088
Santa Fe, New Mexico 87504-2088

DISTRICT I
P.O. Box 1980, Hobbs, NM 88240

DISTRICT II
P.O. Drawer DD, Artesia, NM 88210

DISTRICT III
1000 Rio Brazos Rd., Aztec, NM 87410

WELL LOCATION AND ACREAGE DEDICATION PLAT

All Distances must be from the outer boundaries of the section

Operator PHILLIPS PETROLEUM			Lease SAN JUAN 30-5 UNIT		Well No. 240
Unit Letter H	Section 22	Township T.30 N.	Range R.5 W.	County RIO ARRIBA	
Actual Footage Location of Well: 1403 feet from the NORTH line and 1165 feet from the EAST line					
Ground level Elev. 6663	Producing Formation FRUITLAND		Pool BASIN FRUITLAND COAL		Dedicated Acreage: 320 E/2 Acres

1. Outline the acreage dedicated to the subject well by colored pencil or hatchure marks on the plat below.

2. If more than one lease is dedicated to the well, outline each and identify the ownership thereof (both as to working interest and royalty).

3. If more than one lease of different ownership is dedicated to the well, have the interest of all owners been consolidated by communitization, unitization, force-pooling, etc.?

☐ Yes ☐ No If answer is "yes" type of consolidation _____
If answer is "no" list the owners and tract descriptions which have actually been consolidated. (Use reverse side of this form if necessary.)

No allowable will be assigned to the well until all interests have been consolidated (by communitization, unitization, forced-pooling, or otherwise) or until a non-standard unit, eliminating such interest, has been approved by the Division.

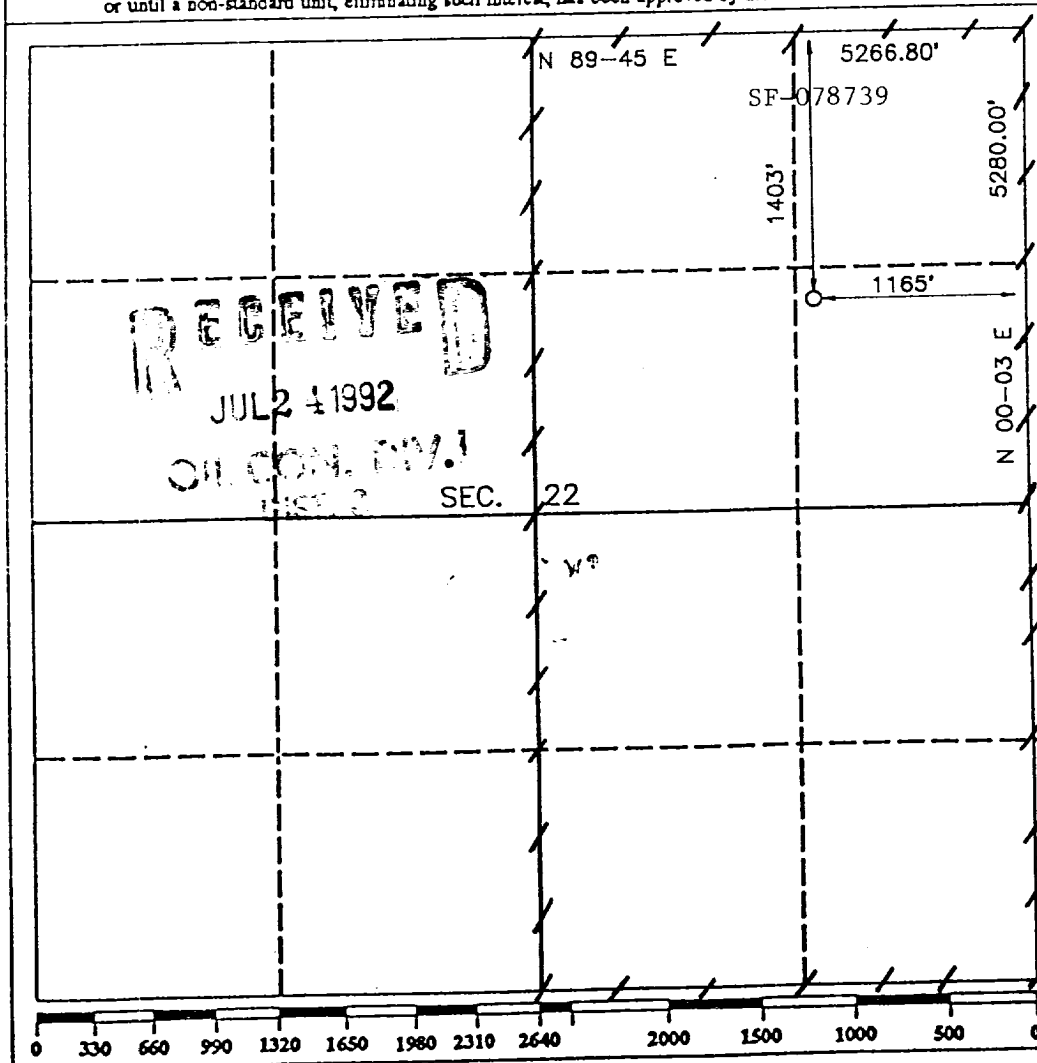

OPERATOR CERTIFICATION

I hereby certify that the information contained herein is true and complete to the best of my knowledge and belief.

Signature

L. E. Robinson

Printed Name

L. E. Robinson

Position

Sr. Drlg. & Prod. Engr.

Company

Phillips Petroleum Co.

Date

January 10, 1992

SURVEYOR CERTIFICATION

I hereby certify that the well location shown on this plat was plotted from field notes of actual surveys made by me or under my supervision, and that the same is true and correct to the best of my knowledge and belief.

Date Surveyed

NOVEMBER 13, 1991

Signature & Seal of
Professional Surveyor

ROY A. BRUSH
ROY A. BRUSH
NEW MEXICO
8894

Certificate No.

