

UNITED STATES
DEPARTMENT OF THE INTERIOR
BUREAU OF LAND MANAGEMENT

APPLICATION FOR PERMIT TO DRILL, DEEPEN, OR PLUG BACK

1a. Type of Work DRILL	5. Lease Number SF-080713
1b. Type of Well GAS	Unit Reporting Number 8910005380
2. Operator BURLINGTON RESOURCES Oil & Gas Company 14538	6. If Indian, All. or Tribe
3. Address & Phone No. of Operator PO Box 4289, Farmington, NM 87499 (505) 326-9700	7. Unit Agreement Name San Juan 30-6 Unit
4. Location of Well 1930' FNL, 910' FWL Latitude 36° 25.3, Longitude 107° 49.8	8. Farm or Lease Name 7469 San Juan 30-6 Unit
	9. Well Number 40A
	10. Field, Pool, Wildcat 72319 Blanco Mesa Verde
	11. Sec., Twn, Rge, Mer. (NMPM) Sec 12, T-30-N, R-6-W API # 30-039-25835
14. Distance in Miles from Nearest Town 8 miles to Gobernador	12. County Rio Arriba
	13. State NM
15. Distance from Proposed Location to Nearest Property or Lease Line 910'	
16. Acres in Lease	17. Acres Assigned to Well 320 W/2 320 W/2
18. Distance from Proposed Location to Nearest Well, Drlg, Compl, or Applied for on this Lease 1800'	
19. Proposed Depth 5951' 7846	20. Rotary or Cable Tools Rotary
21. Elevations (DF, FT, GR, Etc.) 6359' GR	22. Approx. Date Work will Start
23. Proposed Casing and Cementing Program See Operations Plan attached	
24. Authorized by: <i>[Signature]</i> Regulatory/Compliance Administrator	Date 8-22-97

PERMIT NO. _____ APPROVAL DATE APR 15

APPROVED BY _____ TITLE _____ DATE _____

Archaeological Report to be submitted
Threatened and Endangered Species Report to be submitted

HOLD C104 FOR NSL @ NMCOG

District I
PO Box 1980, Hobbs, NM 88241-1980

District II
PO Drawer 00, Artesia, NM 88211-0719

District III
1000 Rio Brazos Rd., Aztec, NM 87410

District IV
PO Box 2088, Santa Fe, NM 87504-2088

State of New Mexico
Energy, Minerals & Natural Resources Department

Form C-
Revised February 21, 1998
Instructions on t
Submit to Appropriate District Of
State Lease - 4 Cc
Fee Lease - 3 Cc

OIL CONSERVATION DIVISION
PO Box 2088
Santa Fe, NM 87504-2088

RECEIVED
BLM

☐ AMENDED REPO

98 FEB 12 PM 3:50

WELL LOCATION AND ACREAGE DEDICATION PLAN

'API Number 30-039-25835	'Pool Code 72319/71599	'Pool Name Blanco Mesaverde/Basin Dakota
'Property Code 7469	'Property Name SAN JUAN 30-6 UNIT	'Well Number 40A
'OGRID No. 14538	'Operator Name BURLINGTON RESOURCES OIL & GAS COMPANY	'Elevation 6359'

¹⁰ Surface Location

UL or lot no.	Section	Township	Range	Lot Idn	Feet from the	North/South line	Feet from the	East/West line	County
E	12	30N	6W		1930	North	910	West	RIO ARRI.

¹¹ Bottom Hole Location If Different From Surface

UL or lot no.	Section	Township	Range	Lot Idn	Feet from the	North/South line	Feet from the	East/West line	County

¹² Dedicated Acres 297.64 W/320 & W/320	¹³ Joint or Infill	¹⁴ Consolidation Code	¹⁵ Order No.
--	-------------------------------	----------------------------------	-------------------------

NO ALLOWABLE WILL BE ASSIGNED TO THIS COMPLETION UNTIL ALL INTERESTS HAVE BEEN CONSOLIDATED OR A NON-STANDARD UNIT HAS BEEN APPROVED BY THE DIVISION

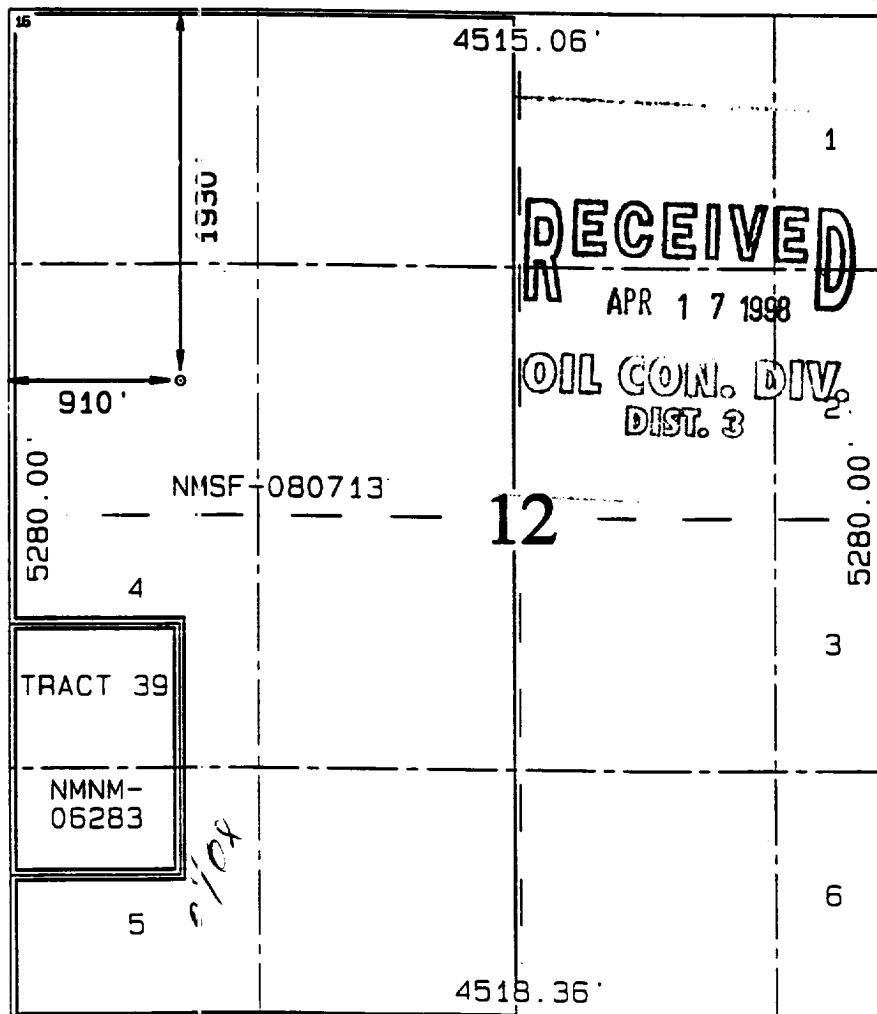

¹⁷ OPERATOR CERTIFICATION

I hereby certify that the information contained herein is true and complete to the best of my knowledge and belief.

Signature

Peggy Bradfield

Printed Name

Regulatory Administrator

Title

Date

¹⁸ SURVEYOR CERTIFICATION

I hereby certify that the well location shown on this map was plotted from field notes of actual surveys made in or under my supervision and that the same is true and correct to the best of my belief.

AUGUST 5 1997
Date of Survey

Signature

NEALE C. EDWARDS
NEW MEXICO
6857
Certificate Number

RECEIVED
JAN 10 1964
U.S. DEPARTMENT OF AGRICULTURE
WASHINGTON, D.C.

UNITED STATES
DEPARTMENT OF THE INTERIOR
BUREAU OF LAND MANAGEMENT

RECEIVED

Sundry Notices and Reports on Wells BLM

1. Type of Well
GAS

RECEIVED
APR 17 1998

98 FEB 12 PM 3:58

070 FARMINGTON, NM

Lease Number
SF-080713
If Indian, All. or
Tribe Name

2. Name of Operator

**BURLINGTON
RESOURCES**

OIL CON. DIV.
DIST. 3
OIL & GAS COMPANY

7. Unit Agreement Name

3. Address & Phone No. of Operator

PO Box 4289, Farmington, NM 87499 (505) 326-9700

8. Well Name & Number
San Juan 30-6 U #40A

9. API Well No.
30-039-

4. Location of Well, Footage, Sec., T, R, M

1930' FNL, 910' FWL, Sec. 12, T-30-N, R-6-W, NMPM

10. Field and Pool
Blanco MV/Basin DK
11. County and State
Rio Arriba Co, NM

12. CHECK APPROPRIATE BOX TO INDICATE NATURE OF NOTICE, REPORT, OTHER DATA

Type of Submission

Type of Action

☒ Notice of Intent

☐ Abandonment

☒ Change of Plans

☐ Subsequent Report

☐ Recompletion

☐ New Construction

☐ Final Abandonment

☐ Plugging Back

☐ Non-Routine Fracturing

☐ Casing Repair

☐ Water Shut off

☐ Altering Casing

☐ Conversion to Injection

☒ Other -

13. Describe Proposed or Completed Operations

An application for permit to drill has been submitted for the subject well as a single Mesaverde. It is now intended to drill and complete the well as a Mesaverde Dakota dual. A revised C-102 well location plat is attached. The new proposed total depth is now 7846'. The revised casing and cementing program is as follows: a 5 1/2" 15.5# K-55 flushjoint liner will be run from 3428-7846'. The 5 1/2" production liner will be cemented as follows: cement to cover a minimum of 100' of 5 1/2" x 7" overlap with 224 sx Class "B" 50/50 poz w/2% gel, 5 pps Gilsonite, 0.25 pps Cellophane, 0.4% fluid loss additive (298 cu.ft., 40% excess cement). WOC a minimum of 18 hours prior to completion. A cement float shoe will be run on bottom with float collar on top of the shoe joint. Note: to facilitate higher hydraulic stimulation, no liner hanger will be used. Instead, a longstring of 5 1/2" casing will be run and cemented with a minimum of 100' of cement overlap between the 5 1/2" and 7" casing strings. After completion of the well, a 5 1/2" CIBP will be set above the last fracturing job to cut and pull the 5 1/2" casing above the 7" casing shoe. The 5 1/2" bridge plug will then be milled and two strings of tubing with a packer will be run for a dual completion.

A variance is requested from Onshore Order #2, III, B. The casing collar clearance in the 5 1/2" flushjoint/6 1/4" hole will be 0.375", a 0.047" variance.

14. I hereby certify that the foregoing is true and correct.

Signed [Signature] (KASPUD) Title Regulatory Administrator Date 2/12/98

(This space for Federal or State Office use)

APPROVED BY /s/ Duane W. Spencer Title _____

Date APR 15 1998

CONDITION OF APPROVAL, if any:

NMOCD

OPERATIONS PLAN

Well Name: San Juan 30-6 Unit #40A
Location: 1930' FNL, 910' FWL Section 12, T-30-N, R-6-W
Rio Arriba County, New Mexico
Latitude 36° 25.3, Longitude 107° 49.8
Formation: Blanco Mesa Verde
Elevation: 6359' GL

<u>Formation Tops:</u>	<u>Top</u>	<u>Bottom</u>	<u>Contents</u>
Surface	San Jose	2411'	aquifer
Ojo Alamo	2411'	2846'	aquifer
Fruitland	2846'	3293'	
Pictured Cliffs	3293'	3428'	gas
Lewis	3428'	4036'	gas
Intermediate TD	3528'		
Mesa Verde	4036'	5266'	gas
Massive Cliff House	5266'	5311'	gas
Menefee	5311'	5551'	gas
Massive Point Lookout	5551'		gas
Total Depth	5951'		
<i>DRCTP</i>	<i>7846</i>		

Logging Program:

Cased hole logging - Gamma Ray Neutron
Coring/DST - none

Mud Program:

<u>Interval</u>	<u>Type</u>	<u>Weight</u>	<u>Vis.</u>	<u>Fluid Loss</u>
0- 200'	Spud	8.4-9.0	40-50	no control
200-3528'	LSND	8.4-9.0	30-60	no control
3528-5951'	Gas/Mist	n/a	n/a	n/a

Pit levels will be visually monitored to detect gain or loss of fluid control.

Casing Program (as listed, the equivalent, or better):

<u>Hole Size</u>	<u>Depth Interval</u>	<u>Csq. Size</u>	<u>Wt.</u>	<u>Grade</u>
12 1/4"	0' - 200'	9 5/8"	32.3#	H-40
8 3/4"	0' - 3528'	7"	20.0#	J-55
6 1/4"	3428' - 5951'	4 1/2"	10.5#	J-55

Tubing Program:

0' - 5951' 2 3/8" 4.7# J-55

BOP Specifications, Wellhead and Tests:

Surface to Intermediate TD -

11" 2000 psi minimum double gate BOP stack (Reference Figure #1).
After nipple-up prior to drilling out surface casing, rams and casing will be tested to 600 psi for 30 minutes.

EXISTING
R-O-W

S. J.
30-6
#40A
FEE
LANDS

**BURLINGTON
RESOURCES**

San Juan 30-6 Unit 40A
T30N, R6W

2000' FEE New Construction
T30N, R6W

Section 12: SWNW 1100'
Section 11: SENE 900'

APD MAP #1