

District I
PO Box 1980, Hobbs, NM 88241-1980
District II
811 South First, Artesia, NM 88210
District III
1000 Rio Brazos Rd., Aztec, NM 87410
District IV
2040 South Pacheco, Santa Fe, NM 87505

State of New Mexico
Energy, Minerals & Natural Resources Department

OIL CONSERVATION DIVISION
2040 South Pacheco
Santa Fe, NM 87505

Form C-101
Revised October 18, 1994
Instructions on back
Submit to Appropriate District Office
State Lease - 6 Copies
Fee Lease - 5 Copies

AMENDED REPORT

APPLICATION FOR PERMIT TO DRILL, RE-ENTER, DEEPEN, PLUGBACK, OR ADD A ZONE

¹ Operator Name and Address. Merrion Oil & Gas Corporation 610 Reilly Avenue Farmington, New Mexico 87401		² OGRID Number 4634
⁴ Property Code 14133	⁵ Property Name IREL State	³ API Number 30 - 039 - 26160

⁷ Surface Location

UL or lot no.	Section	Township	Range	Lot Idn	Feet from the	North/South line	Feet from the	East/West line	County
K	32	T30N	R7W		1950	South	1950	West	Rio Arriba

⁸ Proposed Bottom Hole Location If Different From Surface

UL or lot no.	Section	Township	Range	Lot Idn	Feet from the	North/South line	Feet from the	East/West line	County
⁹ Proposed Pool 1 Blanco Mesaverde (72319)					¹⁰ Proposed Pool 2				

¹¹ Work Type Code N	¹² Well Type Code G	¹³ Cable/Rotary R	¹⁴ Lease Type Code S	¹⁵ Ground Level Elevation 6210'
¹⁶ Multiple N	¹⁷ Proposed Depth 5500' RKB	¹⁸ Formation Mancos	¹⁹ Contractor Not Chosen	²⁰ Spud Date May 1999

²¹ Proposed Casing and Cement Program

Hole Size	Casing Size	Casing weight/foot	Setting Depth	Sacks of Cement	Estimated TOC
12 1/4"	9 5/8"	36 lb.	~240' RKB	150 sx	Surface
8 3/4"	7"	23 lb.	~3300' RKB	425 sx	Surface
6 1/2"	4 1/2"	10.5 lb.	~5500' RKB	325 sx	Liner top @ 3200'

²² Describe the proposed program. If this application is to DEEPEN or PLUG BACK give the data on the present productive zone and proposed new productive zone. Describe the blowout prevention program, if any. Use additional sheets if necessary.

Merrion will conduct the well drilling phase by drilling a 12 1/4" hole with spud mud to a depth of approximately 240 feet. After setting 9 5/8" surface casing will install blowout preventers, wait on cement and pressure test surface shoe to 600 psi prior to drill out. Will drill an 8 3/4" hole with conventional mud into the Lewis shale to a depth of approximately 3300 feet. After setting 7" intermediate casing, we will drill a 6 1/2" hole with air through the Lewis and Mesaverde formations into the Mancos shale to a total depth (td) of 5500 feet kb. After drilling to td, we will run logs. Finally, we will run a 4 1/2" liner and cement it in place to maintain wellbore integrity. Blowout preventers will be double ram, 3000 psi working pressure. (Wellbore schematic attached)

Formation tops: Ojo Alamo 2005', Kirtland 2205', Fruitland 2775', Pictured Cliffs 3085', Lewis 3275', Cliffhouse 4825', Menefee 4945', Point Lookout 5267', Total Depth 5500'.

²³ I hereby certify that the information given above is true and complete to the best of my knowledge and belief.

Signature:

Printed name: Steven S. Dunn

Title: Drilling & Production Manager

Date: March 31, 1999

Phone: 327-9801

OIL CONSERVATION DIVISION

Approved by:

Title:

Approval Date:

Expiration Date:

Conditions of Approval:
Attached ☐

HOLD C104 FOR NSI

District I
P.O. Box 1988, Hobbs, NM 88240-1988
District II
P.O. Drawer 111, Artesia, NM 88211-4719
District III
1009 Rio Grande Blvd., Aztec, NM 87410
District IV
P.O. Box 2088, Santa Fe, NM 87504-2088

State of New Mexico
Energy, Minerals & Natural Resources Department

OIL CONSERVATION DIVISION
PO Box 2088
Santa Fe, NM 87504-2088

Form C-102
Revised February 21, 1994
Instructions on back
Submit to Appropriate District Office
State Lease - 4 Copies
Fee Lease - 3 Copies

☐ AMENDED REPORT

WELL LOCATION AND ACREAGE DEDICATION PLAT

* AP# Number 30-03926160		* Pool Code 72319	* Pool Name Blanco Mesaverde
* Property Code 14133	* Property Name IRED State		* Well Number 1A
* OCKED No. 014634	* Operator Name Merrion Oil & Gas Corporation		* Depth 6210'

" Surface Location

UL or lot no.	Section	Township	Range	Lot No.	Feet from the	North/South line	Feet from the	East/West line	County
K	32	30 N	7 W		1995'	South	1945'	West	Rio Arriba

" Bottom Hole Location If Different From Surface

UL or lot no.	Section	Township	Range	Lot No.	Feet from the	North/South line	Feet from the	East/West line	County

* Dedicated Acre 160	* Joint or Indiv Y	* Consolidation Code	* Order No. Applying for NSL NISP-R-8320
-------------------------	-----------------------	----------------------	---

NO ALLOWABLE WILL BE ASSIGNED TO THIS COMPLETION UNTIL ALL INTERESTS HAVE BEEN CONSOLIDATED
OR A NON-STANDARD UNIT HAS BEEN APPROVED BY THE DIVISION

<div data-bbox="557 1095 889 1336" data-label="Text"> <p>RECEIVED APR - 2 1999 OIL CON. DIV. DIST. 3</p> </div>	<div data-bbox="1091 1025 1560 1064" data-label="Section-Header"> <p>17 OPERATOR CERTIFICATION</p> </div> <div data-bbox="1091 1068 1560 1119" data-label="Text"> <p>I hereby certify that the information contained herein is true and complete to the best of my knowledge and belief</p> </div> <div data-bbox="1091 1157 1560 1474" data-label="Text"> <p><i>Steven S. Dunn</i> Signature Steven S. Dunn Printed Name Drilling & Production Manager Title March 31, 1999 Date</p> </div>	
	<div data-bbox="1091 1502 1560 1538" data-label="Section-Header"> <p>18 SURVEYOR CERTIFICATION</p> </div> <div data-bbox="1091 1547 1560 1647" data-label="Text"> <p>I hereby certify that the well location shown on this plat was plotted from field notes of actual surveys made by me or under my supervision and that the same is true and correct to the best of my knowledge and belief</p> </div> <div data-bbox="1091 1689 1560 1959" data-label="Text"> <p>Date of Survey Signature and Seal of Professional Surveyor 6844 REGISTERED LAND SURVEYOR 6844 Certificate Number</p> </div>	

red State # 1 A
well pad & section

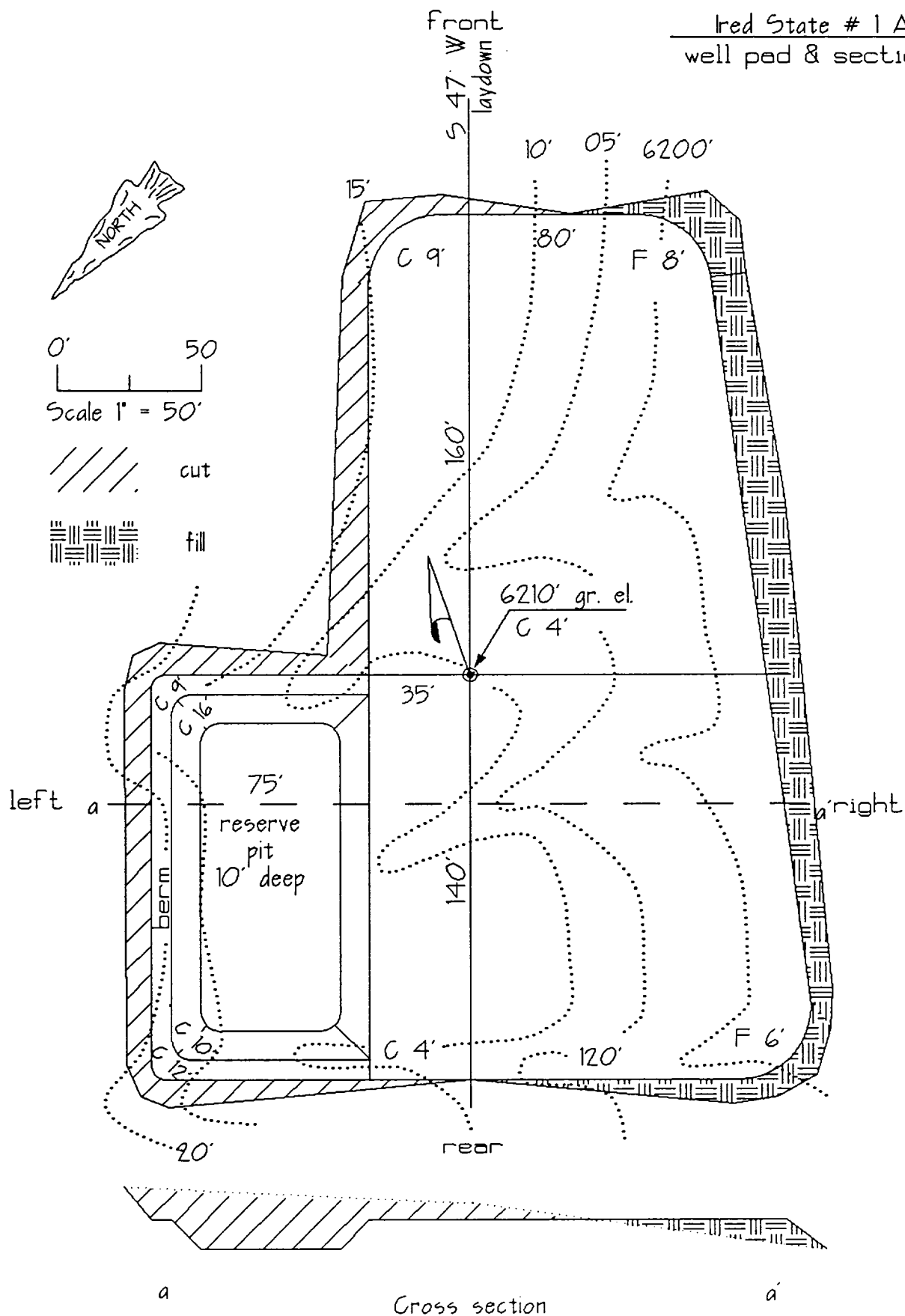

Merrion Oil & Gas Corporation

Wellbore Schematic

Ired No. 1A

Proposed Wellbore Configuration

Location: 1950' fsl & 1950' fwl (ne sw)
Sec 32, T30N, R7W, NMPM
Rio Arriba Co, New Mexico

Prepared: 03/19/99

Elevation: 6,235' GL
6,248' RKB

By: Steven Dunn

