

NEW MEXICO OIL CONSERVATION COMMISSION
Well Location and Acreage Dedication Plat

Section A.

AMENDED

Date 11-3-60

Operator Sunray Mid-Continent Oil Company Lease N. M. Federal "I"
Well No. 2 Unit Letter A Section 1 Township 29 N Range 11 W NMPM
Located 790' Feet From North Line, 900' Feet From East Line
County San Juan G. L. Elevation 5552' Dedicated Acreage 320 E 319 Acres
Name of Producing Formation Dakota Sandstone Pool Undesignated

1. Is the Operator the only owner* in the dedicated acreage outlined on the plat below?
Yes X No .
2. If the answer to question one is "no," have the interests of all the owners been consolidated by communitization agreement or otherwise? Yes No . If answer is "yes," Type of Consolidation
3. If the answer to question two is "no," list all the owners and their respective interests below:

Owner

Land Description

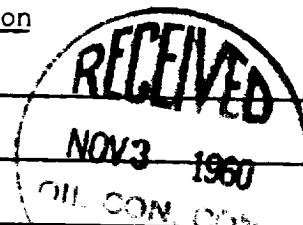

Section B

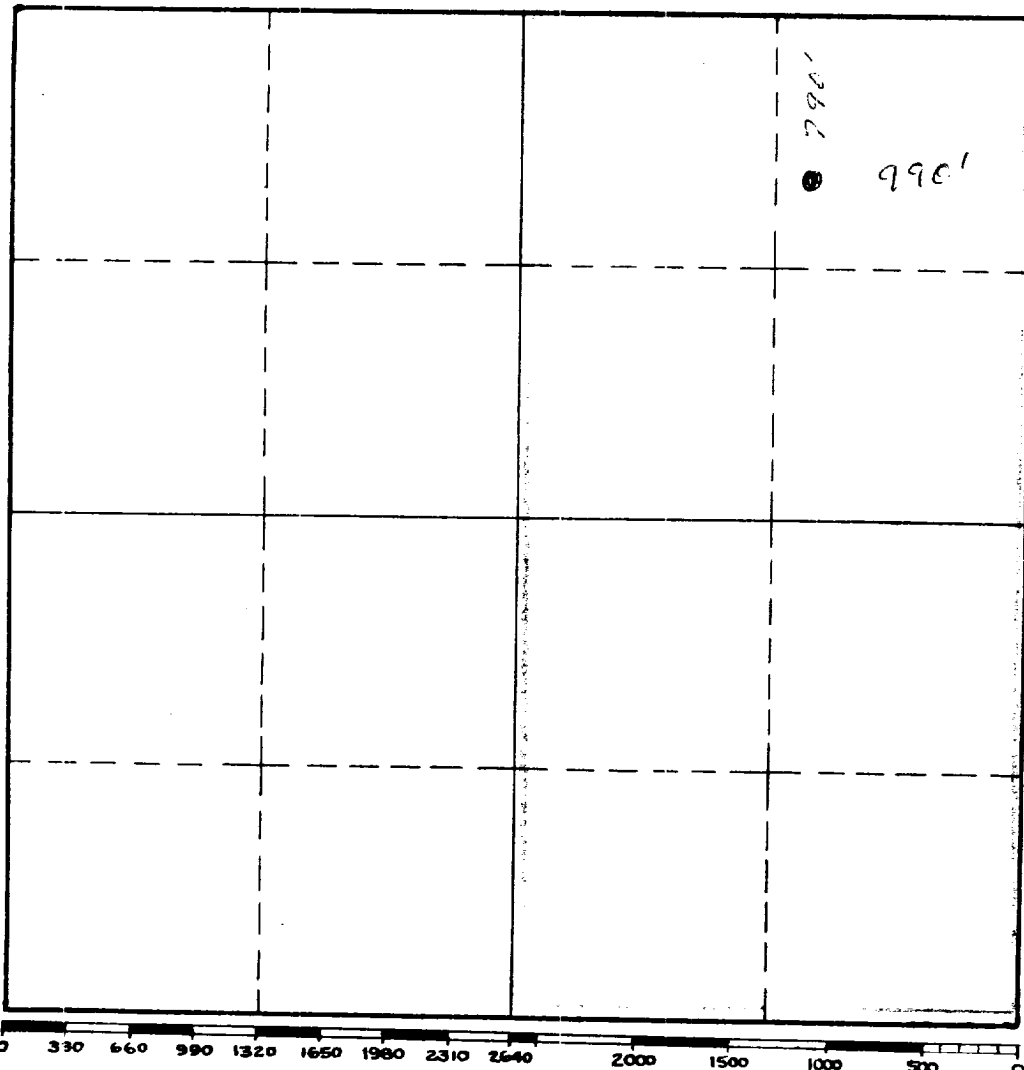

This is to certify that the information in Section A above is true and complete to the best of my knowledge and belief.

Sunray Mid-Continent Oil Co.
(Operator)
Hal M. Stierwalt
Hal M. Stierwalt
(Representative)

166 Petroleum Center Bldg.
Address
Farmington, New Mexico

This is to certify that the well location shown on the plat in Section B was plotted from field notes of actual surveys made by me or under my supervision and that the same is true and correct to the best of my knowledge and belief.

Date Surveyed

Registered Professional
Engineer and/or Land Surveyor.

Certificate No.
(See instructions for completing this form on the reverse side)

INSTRUCTIONS FOR COMPLETION:

1. Operator shall furnish and certify to the information called for in Section A.
2. Operator shall outline the dedicated acreage for both oil and gas wells on the plat in Section B.
3. A registered professional engineer or land surveyor registered in the State of New Mexico or approved by the Commission shall show on the plat the location of the well and certify this information in the space provided.
4. All distances shown on the plat must be from the outer boundaries of Section.
5. If additional space is needed for listing owners and their respective interests as required in question 3, Section A, please use space below

STATE OF NEW MEXICO	
OIL CONSERVATION COMMISSION	
ALBUQUERQUE DISTRICT OFFICE	
NUMBER OF COPIES RECEIVED	
DATE	
SANTA FE	
FILE	
U.S.G.S.	
LAND OFFICE	
TRANSPORTER	OIL
	GAS
PRORATION OFFICE	
OPERATOR	

* "Owner" means the person who has the right to drill into and to produce from any pool and to appropriate the production either for himself or for himself and another. (65-3-29 (e) NMSA 1953 Comp.)

NEW MEXICO OIL CONSERVATION COMMISSION
Well Location and Acreage Dedication Plat

Section A.

Date December 21, 1959

Operator Sunray Mid-Continent Oil Company Lease New Mexico Federal "I"
Well No. 2 Unit Letter A Section 1 Township 19N Range 11W NMPM
Located 790' Feet From North Line, 990' Feet From East Line
County _____ G. L. Elevation 5521' Dedicated Acreage 380' Acres
Name of Producing Formation Dakota Pool Undesignated

1. Is the Operator the only owner* in the dedicated acreage outlined on the plat below?
Yes X No _____.
2. If the answer to question one is "no," have the interests of all the owners been consolidated by communitization agreement or otherwise? Yes _____ No _____. If answer is "yes," Type of Consolidation _____
3. If the answer to question two is "no," list all the owners and their respective interests below:

Owner

Land Description

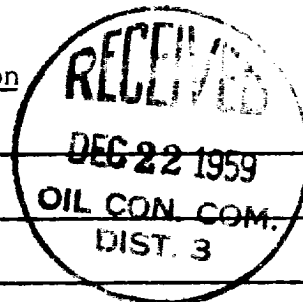

Section B

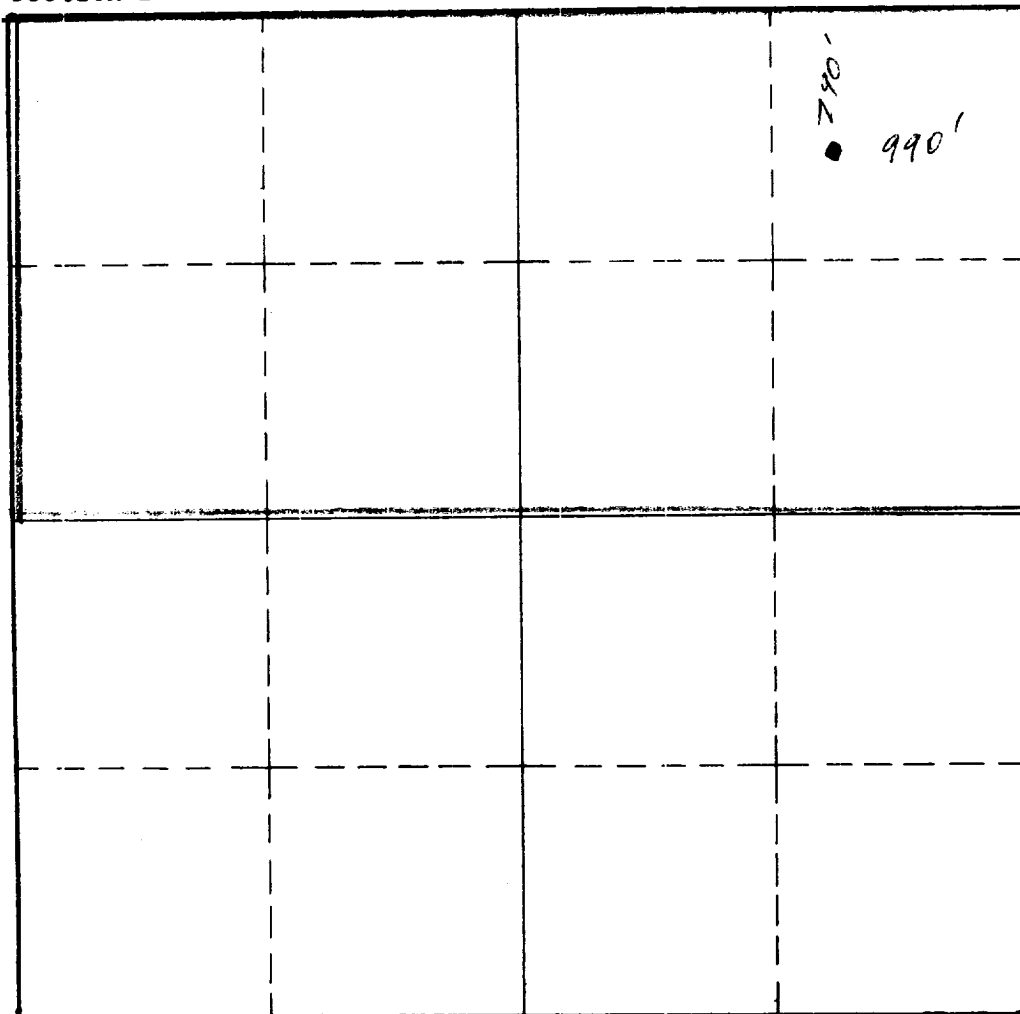

This is to certify that the information in Section A above is true and complete to the best of my knowledge and belief.

Sunray Mid-Continent Oil Co.
(Operator)

Hal M. Stenwalt
(Representative)

166 Petroleum Center Building
Address

This is to certify that the well location shown on the plat in Section B was plotted from field notes of actual surveys made by me or under my supervision and that the same is true and correct to the best of my knowledge and belief.

Date Surveyed _____

Registered Professional
Engineer and/or Land Surveyor.

Certificate No. _____

(See instructions for completing this form on the reverse side)

INSTRUCTIONS FOR COMPLETION:

1. Operator shall furnish and certify to the information called for in Section A.
2. Operator shall outline the dedicated acreage for both oil and gas wells on the plat in Section B.
3. A registered professional engineer or land surveyor registered in the State of New Mexico or approved by the Commission shall show on the plat the location of the well and certify this information in the space provided.
4. All distances shown on the plat must be from the outer boundaries of Section.
5. If additional space is needed for listing owners and their respective interests as required in question 3, Section A, please use space below

OIL CONSERVATION COMMISSION		
DISTRICT OFFICE		
Copies Received <u>4</u>		
DISTRIBUTION		
	NO. FURNISHED	
Operator	<u>2</u>	
County Clerk	<u>1</u>	
Notary Public		
Recorder		
Deputy Recorder		
County Engineer		
County Assessor		
County Auditor		
County Treasurer		
County Clerk	<u>1</u>	<input checked="" type="checkbox"/>
County Engineer		
County Assessor		
County Auditor		
County Treasurer		

* "Owner" means the person who has the right to drill into and to produce from any pool and to appropriate the production either for himself or for himself and another. (65-3-29 (e) NMSA 1953 Comp.)

3-25-68

TOM DUGAN

WELLS REQUIRING FILE CORRECTION ONLY

LEASE NAME & WELL NUMBER	LOCATION	POOL	PRESENT ACREAGE	CORRECT ACREAGE
NCRA #1	A-3-26N-7W	Basin Dak.	N 320	N 320.24 ✓
Moonlight Mesa #1	C-7-29N-12W	Undes Fruit.	160	158.32 ✓
Moonlight Mesa #1	C-7-29N-12W	Fulcher Kutz PC	160	158.32 ✓
Federal 1 #2	A-1-29N-14W	Basin Dak.	E 320	E 319 ✓
Federal 1 #3	D-1-29N-14W	Basin Dak.	W 320	W 317 ✓
Com #1	J-2-29N-14W	Basin Dak.	E 315	E 316.65 ✓