

NEW MEXICO OIL CONSERVATION COMMISSION

Well Location and Acreage Dedication Plat

Section A.

Date January 16, 1961

Operator Astec Oil and Gas Company Lease Hagood  
Well No. 15-0 Unit Letter H Section 34 Township 29N Range 13W NMPM  
Located 510 Feet From South Line, 2035 Feet From West Line  
County San Juan G. L. Elevation 5879 Dedicated Acreage 40 Acres  
Name of Producing Formation Gallup Pool Totah

1. Is the Operator the only owner\* in the dedicated acreage outlined on the plat below?  
Yes XX No
2. If the answer to question one is "no," have the interests of all the owners been consolidated by communitization agreement or otherwise? Yes        No       . If answer is "yes,"  
Type of Consolidation
3. If the answer to question two is "no," list all the owners and their respective interests below:

Owner

Land Description

Section B

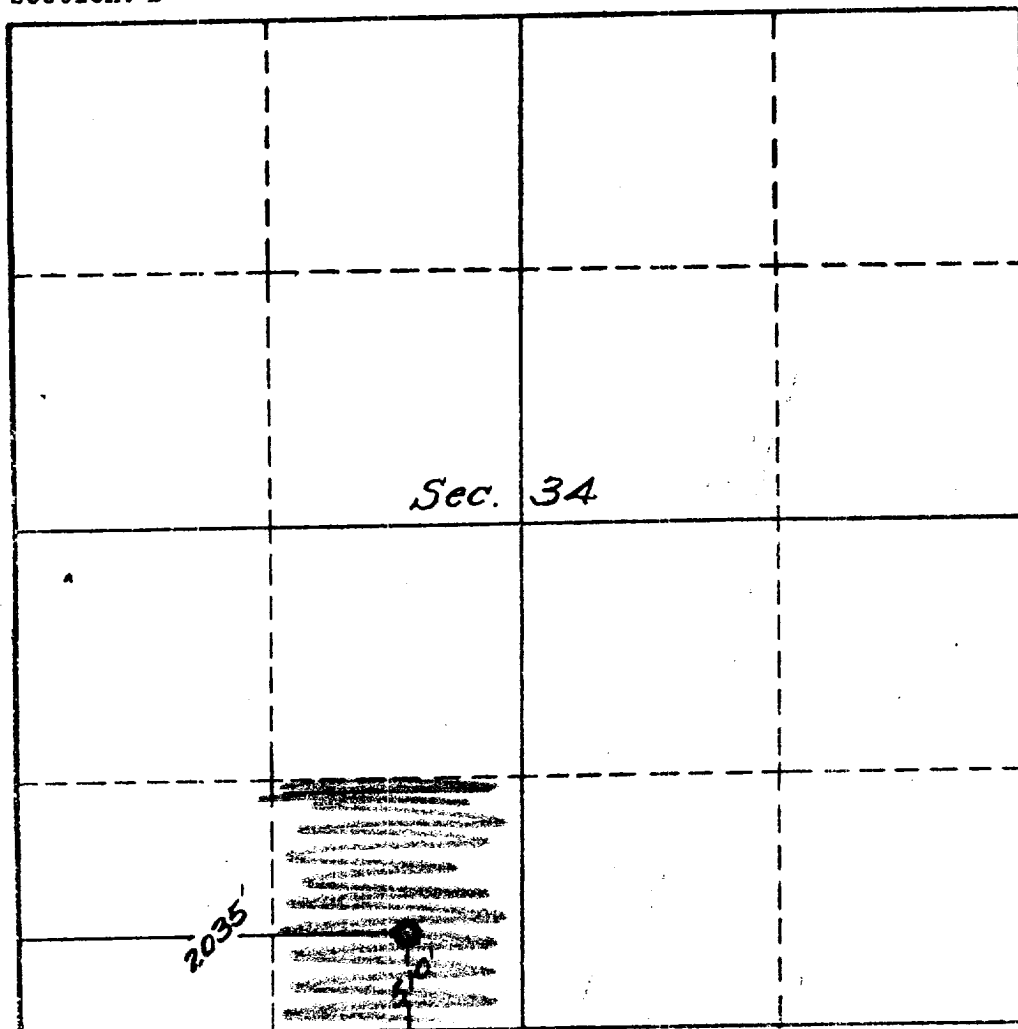

This is to certify that the information in Section A above is true and complete to the best of my knowledge and belief.

Astec Oil and Gas Company  
(Operator)

ORIGINAL SIGNED BY JOE C. SALMON  
(Representative)

Drawer 570, Farmington, N.M.  
Address

This is to certify that the well location shown on the plat in Section B was plotted from field notes of actual surveys made by me or under my supervision and that the same is true and correct to the best of my knowledge and belief.

Date Surveyed 12-12-60

E. V. Echohawk  
12-12-60

Ernest V. Echohawk  
Registered Land Surveyor.

Certificate No. 1545

