

5-MOCC  
1-Redfern  
1-Aztec  
1-Summit  
1-File

NEW MEXICO OIL CONSERVATION COMMISSION  
Santa Fe, New Mexico

Form C-101  
Revised (12/1/55)

30-045-07621

## NOTICE OF INTENTION TO DRILL

Notice must be given to the District Office of the Oil Conservation Commission and approval obtained before drilling or recompletion begins. If changes in the proposed plan are considered advisable, a copy of this notice showing such changes will be returned to the sender. Submit this notice in QUINTUPLICATE. One copy will be returned following approval. See additional instructions in Rules and Regulations of the Commission. If State Land submit 6 Copies Attach Form C- 128 in triplicate to first 3 copies of form C-101

**Farmington, New Mexico**  
(Place)

**November 27, 1959**  
(Date)

OIL CONSERVATION COMMISSION  
SANTA FE, NEW MEXICO

Gentlemen:

You are hereby notified that it is our intention to commence the Drilling of a well to be known as

**Redfern & Herd**

(Company or Operator)

**Whitt**

(Lease)

Well No. **1**, in **N** The well is

(Unit)

located **860** feet from the **South** line and **1840** feet from the

**West**

line of Section **33**, T. **29N**, R. **11W**, NMPM.

(GIVE LOCATION FROM SECTION LINE)

**Fuleher Kuts**

Pool, **San Juan** County

If State Land the Oil and Gas Lease is No. ....

If patented land the owner is **Mr. Whitt**

Address. ....

We propose to drill well with drilling equipment as follows: ....

**Rotary from surface to TD**

The status of plugging bond is **State Wide**

Drilling Contractor **Star Drlg. Co.**

We intend to complete this well in the **Pictured Cliff**

formation at an approximate depth of **1590** feet.

### CASING PROGRAM

We propose to use the following strings of Casing and to cement them as indicated:

Size of Hole	Size of Casing	Weight per Foot	New or Second Hand	Depth	Sacks Cement
<b>11"</b>	<b>7-5/8</b>	<b>26.40</b>	<b>Second Hand</b>	<b>100</b>	<b>75</b>
<b>6-3/4"</b>	<b>4 1/2</b>	<b>9.5</b>	<b>New</b>	<b>1590</b>	<b>100</b>

If changes in the above plans become advisable we will notify you immediately.

ADDITIONAL INFORMATION (If recompletion give full details of proposed plan of work.)

**Perf & Sand water Frac**

Approved....., 19.....  
Except as follows:

OIL CONSERVATION COMMISSION

By.....

Sincerely yours,

**Redfern & Herd**

Original signed by **T. A. Dugan**  
(Company or Operator)

Position **Consulting Engineer**

Send Communications regarding well to

Name.....

Address.....

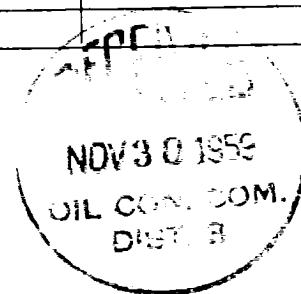

OIL CONSERVATION COMMISSION		
AZTEC DISTRICT OFFICE		
No. Copies Received 5		
DISTRIBUTION		
Mr. Tolson	1	
Mr. E. A. Tamm	1	
Mr. Clegg	1	
Mr. Glavin	1	
Mr. Ladd	1	
Mr. Nichols	1	
Mr. Rosen	1	
Mr. Tracy	1	
Mr. Carson	1	
Mr. Egan	1	
Mr. Gurnea	1	
Mr. Harbo	1	
Mr. Hendon	1	
Mr. Jones	1	
Mr. Quinn	1	
Mr. Nease	1	
Mr. Gandy	1	
U.S. S. S.	1	
Transporter	1	
File	1	✓

NEW MEXICO OIL CONSERVATION COMMISSION

Well Location and Acreage Dedication Plat

Section A.

Date 11-20-59

Operator Redfern and Ward Lease W100  
Well No. 2 Unit Letter B Section 33 Township 29 North Range 11 West NMPN  
Located 860 Feet From South Line, 1840 Feet From West Line  
County San Juan G. L. Elevation 5476 Dedicated Acreage 100 Acres  
Name of Producing Formation Pictured Cliffs Pool Palenque-100

1. Is the Operator the only owner\* in the dedicated acreage outlined on the plat below?  
Yes    No
2. If the answer to question one is "no," have the interests of all the owners been consolidated by communitization agreement or otherwise? Yes    No   . If answer is "yes,"  
Type of Consolidation
3. If the answer to question two is "no," list all the owners and their respective interests below:

Owner

Land Description

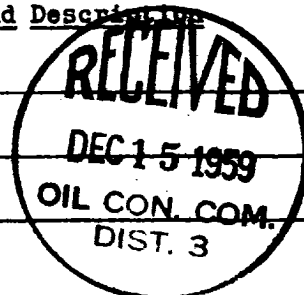

Section B

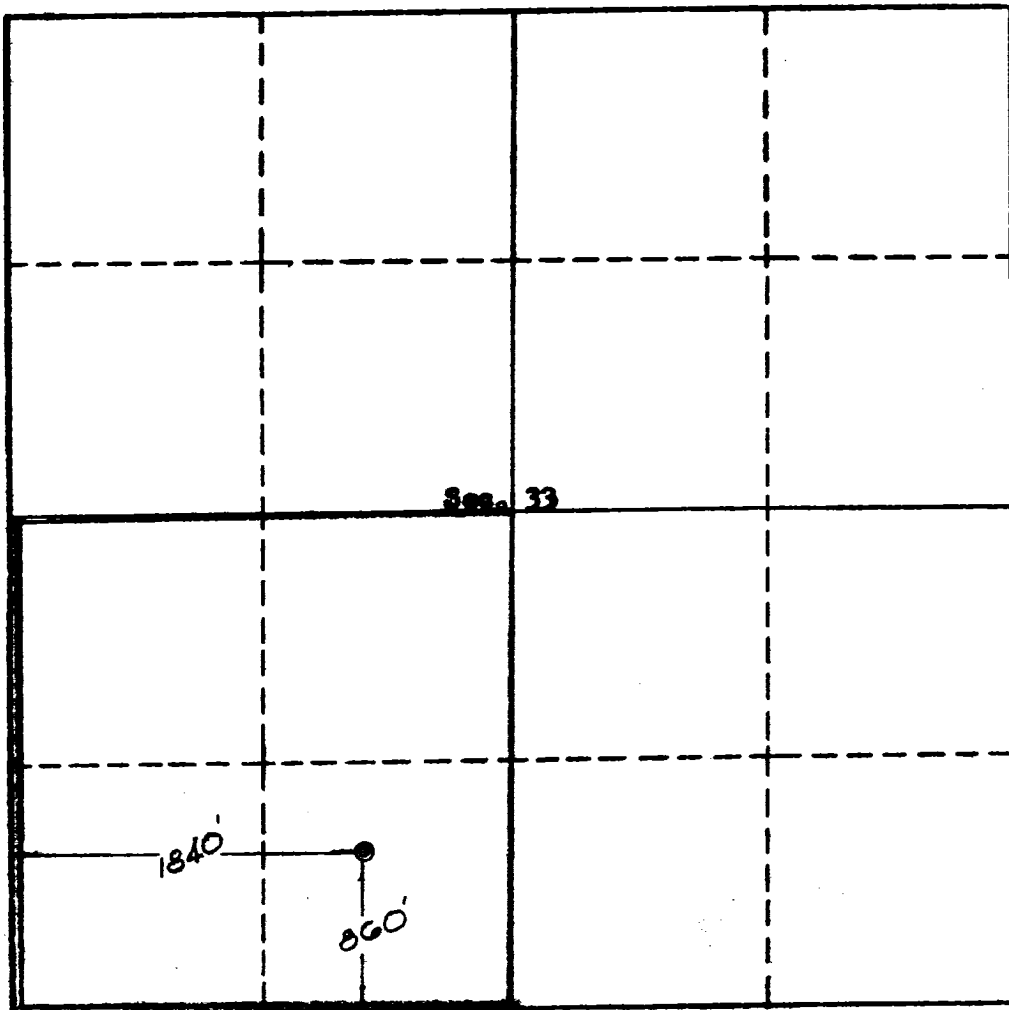

This is to certify that the information in Section A above is true and complete to the best of my knowledge and belief.

Redfern & Ward

(Operator)

Original signed by T. A. Dudañ

(Representative)

Box 1747, Midland, Texas

Address

This is to certify that the well location on the plat is correct as determined from field notes of actual survey made by me under my supervision and to the best of my knowledge and belief.

Date Surveyed Nov. 24, 1959

Ernest V. Echshaw  
Ernest V. Echshaw  
Registered Land Surveyor.

Certificate No. 1545